



GREEN LION



Green Lion

Vintage Citrus Juicer

SKU: GNVCTJUR400CM

Model No: GL-JU14

Table of Contents

Schematic View	2
Safety Instructions	2
Electric Safety Guide	3
Precautions	4
Instructions for Use	4
Cleaning Instructions	5
Specifications	6
Statement	6
Disposal	6
Warranty	7
Contact Us	7

Schematic View

1. Press Cone Cover
2. Bigger Juice Cone
3. Smaller Juice Cone
4. Stainless Steel Filter
5. 400 ml Juice Tank
6. Body
7. Main Housing
8. Anti-Slip Base
9. Pressing Lever

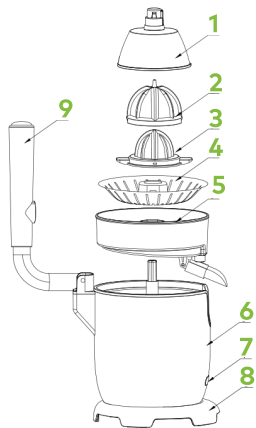

Safety Instructions

Read these instructions carefully before switching on the appliance and retain them for future reference. Failure to follow these instructions may result in an accident.

1. Clean all parts of the appliance that will come into contact with food as specified in the cleaning section before use.
2. This appliance is not intended for use by individuals (including children) with reduced physical, sensory, or mental capabilities, or by those lacking experience and knowledge, unless they have been properly supervised or instructed by a responsible person regarding the safe use of the appliance.
3. This appliance can be used by individuals unfamiliar with its operation disabled persons, or children aged 8 years and older, provided they have been properly supervised or instructed on safe usage and understand the associated hazards.
4. Cleaning and user maintenance must not be performed by children unless they are over 8 years of age and under supervision.
5. This appliance is not a toy. Children must be supervised to ensure they

do not play with the appliance. Keep the appliance and its cable out of the reach of children under the age of eight.

Electric Safety Guide

1. Do not use the appliance if the cable or plug is damaged.
2. Ensure the voltage indicated on the nameplate matches the mains voltage before plugging in the appliance.
3. The appliance plug must fit properly into the main socket. Do not modify the plug or use plug adapters.
4. Use and store the appliance on a flat, stable surface.
5. Keep the working area clean and well-lit, as cluttered and dark areas increase the risk of accidents.
6. Do not use or store the appliance outdoors.
7. Do not use the appliance if it has fallen, shows visible signs of damage or has a leak.
8. Avoid straining the electrical cord. Do not use the cord to lift, carry or unplug the appliance.
9. Ensure the electric cable does not become trapped or tangled.
10. Regularly inspect the power cord for signs of damage. If damaged do not use the appliance.
11. If the appliance casing is damaged, immediately disconnect the appliance from the mains to avoid the risk of electric shock.
12. Do not touch the plug with wet hands.
13. Disconnect the appliance and unplug it if you leave it unattended and before changing accessories, assembling, dismantling, or cleaning.
14. If the electrical connection is damaged, it must be replaced. Take the appliance to an authorized technical assistance service. Do not attempt to dismantle or repair the appliance without professional assistance, as this may be dangerous.

Precautions

1. Fully unroll the appliance's power cable before each use.
2. Do not use the appliance if its accessories are not properly fitted.
3. Do not move the appliance while it is in use.
4. Do not use the appliance if it is tipped over or turn it over while in use.
5. Do not turn the appliance over while it is in use or connected to the mains.
6. Disconnect the appliance from the mains when not in use and before undertaking any cleaning tasks.
7. This appliance is intended for household use only and is not suitable for professional or industrial purposes.
8. This appliance is for adult use. Ensure it is not used by disabled individuals, children, or people unfamiliar with its operation.
9. Store the appliance out of reach of children and/or disabled individuals.
10. Store the appliance in a dry, dust-free location, away from direct sunlight.
11. Never leave the appliance unattended while it is in use.

Instructions for Use

[A] Before First Use

1. Ensure all packaging materials have been removed from the product.
2. Before using the product for the first time, clean all parts that will come into contact with food as described in the cleaning section.

[B] Using the Appliance

1. Completely unroll the cord before plugging in the appliance.
2. Connect the appliance to the mains.
3. Cut the citrus fruits to be squeezed in half.
4. Place a glass under the anti-drip valve.
5. Turn on the appliance by pressing down with the handle on the piece of

citrus fruit, once it has been placed on the juicing cone.

6. To stop the appliance, simply release the pressure on the cone.

[C] Notice

1. Use the larger cone for bigger fruits like oranges, and press using the lever. Use the smaller cone for smaller fruits like lemons, and press using your hand.

2. Follow the correct operation timing: run the appliance for 15 seconds then turn it off for 15 seconds as one working cycle. After completing 10 cycles stop the operation and let the appliance rest for 30 minutes.

3. When processing a large quantity of fruits, periodically clean the filter and tank to remove pulp residue.

[D] After Use

1. Unplug the appliance from the mains.

2. Clean the appliance as described in the cleaning section.

Cleaning Instructions

1. Unplug the appliance from the mains.

2. Clean the appliance using a damp cloth with a few drops of washing-up liquid, then dry thoroughly.

3. Avoid using solvents, acidic or alkaline products such as bleach, or abrasive cleaners for cleaning the appliance.

4. Do not submerge the appliance in water or any other liquid, nor place it under a running tap.

5. Regularly clean the appliance and remove any food residues.

6. The following parts are dishwasher-safe: the press cone cover, larger cone smaller cone, SSL filter, juice tank, plastic filter, and plastic adjust filter.

7. Ensure all parts are completely dry before reassembling and storing the appliance.

Specifications

Model No.	GL-JU14
Material	Aluminum+SS+AS+PP+ABS
Rated Voltage	220-240V, 50/60Hz
Rated Power	170W
Capacity	400 ml
Function Speed	125 RPM
Noise Level	80 dB
Power Cord	BS Plug 1.1 m
Product Weight	1.6 kg
Product Dimensionst	245×180×310 mm

Statement

This symbol indicates that when the product reaches the end of its useful life, it should be taken to an authorized waste disposal agent for the selective collection of waste electrical and electronic equipment (WEEE). This appliance complies with the following directives: Directive 2014/35/EU on Low Voltage. Directive 2014/30/EU on Electromagnetic Compatibility. Directive 2011/65 /EU on the restriction of the use of certain hazardous substances in electrical and electronic equipment (RoHS). Directive 2009/125/EC on the ecodesign requirements for energy-related products.

Disposal

This product must not be disposed of as unsorted household waste. It is important to separate such waste for proper treatment and recycling, in compliance with local waste management regulations.

Warranty

Products that you buy directly from our **Green Lion** website or shop come with a 24-month warranty.

When you buy **Green Lion** products from any of our approved sellers, you only get a 12-month warranty. If you want to extend this warranty, go to our website at <https://www.greenlion.net/warranty> and fill out the form with your information. Don't forget to upload a picture of the product too. After we've checked and accepted your request, we'll send you an email to confirm that your product's warranty has been extended.

For more info, please check:

<https://www.greenlion.net/warranty>

Contact Us

If you have any questions about this Privacy Policy, please contact us at:

Website: <https://www.greenlion.net/>

Sales: sales@greenlion.net

Service Support: Support@greenlion.net

Telegram: [@greenlion_global](https://t.me/greenlion_global)

Instagram: [@greenlion_global](https://www.instagram.com/greenlion_global)