



**GREEN LION**



**Green Lion**

## **ALPS PRO WIRELESS SPEAKER**

SKU: GNALSPKR8WBK

Model No: GL-SP25

## Table of Contents

Product Overview	2
Specifications	2
Product Design	3
Buttons and functions	3
Package Contents	5
Product Components	5
Indicator Light Description	8
Bluetooth Connection	9
TWS Connection and Disconnection	10
Reset Function	10
Troubleshooting	10
Safety Precautions	11
Disposal	13
Warranty	13
Contact Us	13

## Product Overview

The Green Lion ALPS PRO Wireless Speaker delivers powerful sound in a lightweight and portable design, perfect for outdoor activities like cycling, trekking, and travel. With an IPX7 water resistance rating, it's built to withstand the elements. Enjoy up to 5.5 hours of battery life, true stereo sound, and easy controls with an adjustable strap for convenience. It also features a boost mode for enhanced sound and USB-C charging for fast recharging, making it a smart choice for your adventures.

## Specifications

Model No	GL-SP25
Material	ABS + Fabric
Battery	1800mAh
Power	8W
Voltage	3.7V
Bluetooth	V5.3
Transmission Distance	10m
Speaker	45mm
Waterproof	IPX7
Charging Port	USB-C
Charging Time	3 hrs
Playtime	5.5 hrs
Product Weight	256g
Product Dimensions	109*94*51.5 mm

## Package Contents

Wireless Speaker x1

Type-C USB cable x1

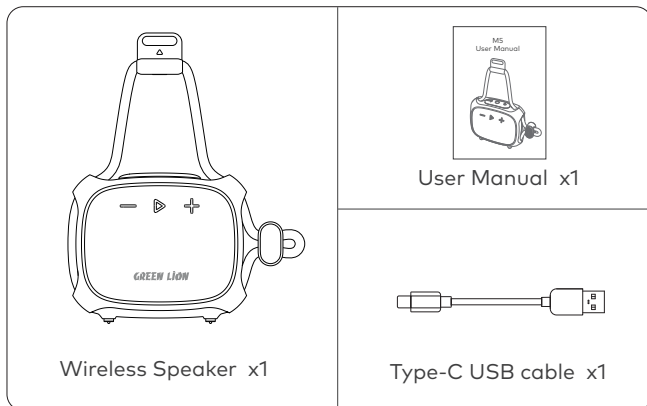

## Product Components

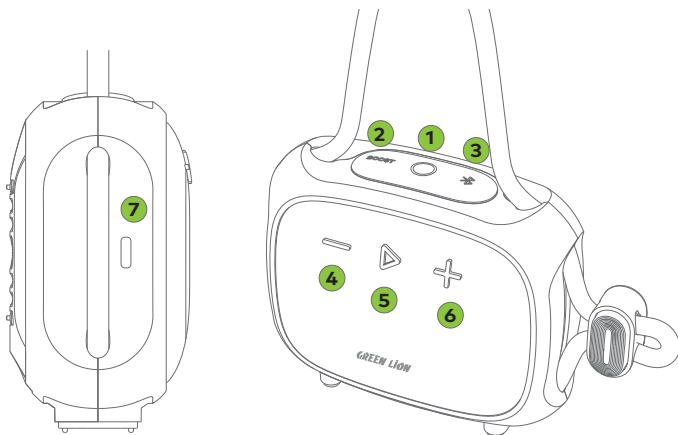

## **1. Power On/Off**

Long Press: Press and hold for 8 seconds to turn on or off the speaker. If the speaker crashes, press and hold for 8 seconds to reset it.

## **2. EQ Switch**

Short Press: Switch the equalizer (EQ) settings to adjust sound output.

## **3. Bluetooth Functions**

Long Press (Connected State): Press and hold for 2 seconds to disconnect from the current device.

Long Press (Disconnected State): When Bluetooth is disconnected, press and hold for 2 seconds to reconnect to the last paired device.

## **4. Volume Control**

Short Press: Decrease volume.

Long Press: Skip to the previous song.

## **5. Playback & Call Management**

Short Press: Play or pause the current song.

Long Press: Press and hold for 2 seconds to reject an incoming call.

Press and hold for 2 seconds to enable True Wireless Stereo (TWS) connection. To disconnect, press and hold again.

Press and hold for 5 seconds to clear pairing information and restore default volume. This will also trigger a prompt sound and automatically shut down the speaker.

Double Click: Double-click the button when the Bluetooth is connected to the phone to call back the last dialed number.

## **6. Volume Up**





Short Press: Increase the volume.



Long Press: Skip to the next song.

## **7. Charging**

Type-C Charging Port: Use this port to charge the speaker.

## Indicator Light Description

Bluetooth Indicator	
<b>Trun on</b>  light on	<b>Bluetooth Connecting</b>  Flashing light
<b>Playing music Audio</b>  Light off	<b>Connection successfully</b>  Light stays on

Charging Indicator	
<b>Charging</b>  Power button flashing light	<b>Fully charged</b>  Power button light off

## Bluetooth Connection

### 1. Bluetooth Connection:

When you power on the speaker, it will automatically enter Bluetooth pairing mode, allowing it to connect seamlessly with your device. Simply enable Bluetooth on your device to pair with the speaker and enjoy your audio.

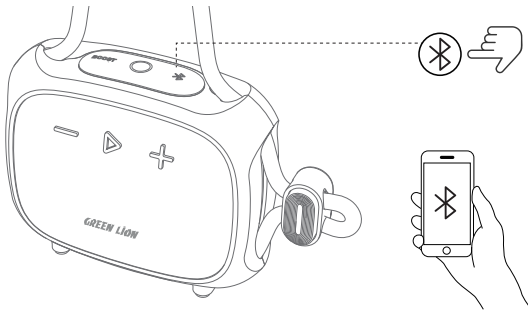

## 2. Disconnecting the Speaker:

To disconnect the speaker from your device, press the Bluetooth button twice in quick succession. This will safely disconnect the Bluetooth connection, allowing you to easily reconnect or switch to a different device.

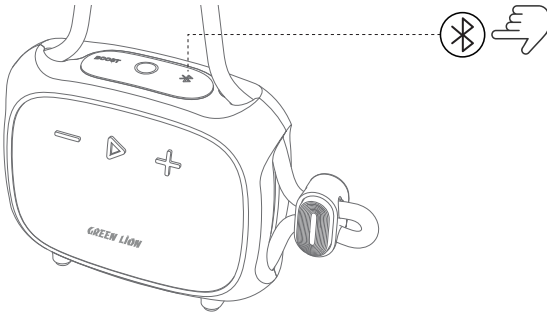

## 3. Reconnecting the Speaker

Some Bluetooth devices automatically reconnect when powered on. If the speaker does not automatically reconnect, press and hold the Power Button to connect it to the last paired device.

## 4. Hands-Free Function:

The hands-free function allows you to manage calls directly from the speaker.

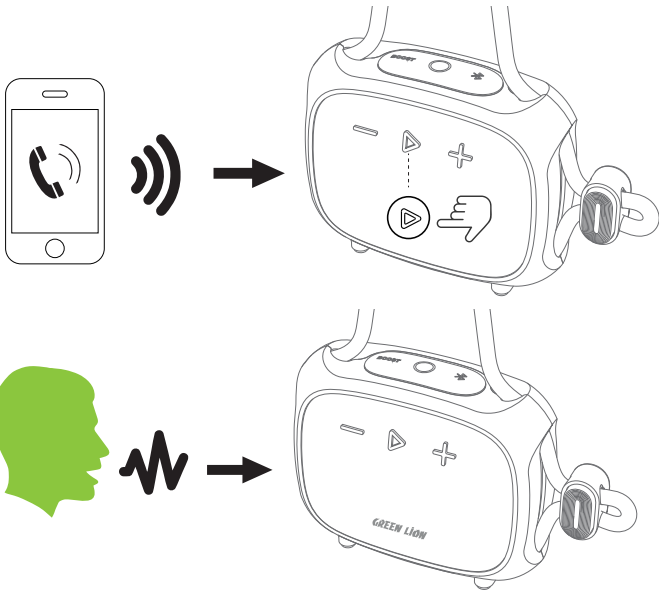

1. Short press to answer an incoming call.
2. Short press again to hang up the call.
3. Long press to reject an incoming call.
4. Double press to redial the last number.

## 5. Music Control:

Control your music playback directly from the speaker with the following:

Short press to play or pause the music.

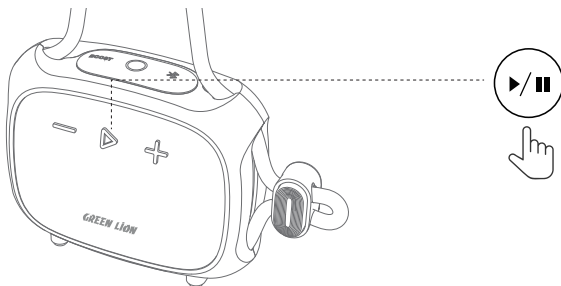

# TWS Connection and Disconnection

## 1. Turning on Two Speakers:

Press and hold the power button on both speakers for approximately 3 seconds to power them on and initiate pairing.

Primary Speaker: The main speaker where the connection starts.

Secondary Speaker: The additional speaker that pairs with the primary speaker.

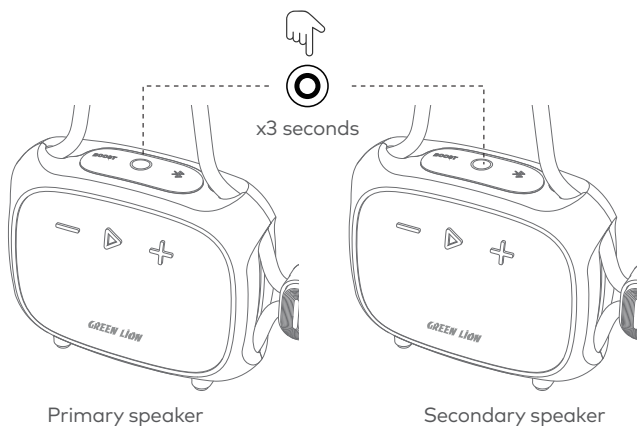

## 2. Pairing the Speakers:

After both speakers are turned on, press and hold the Play/Pause button on one of the speakers for about 2 seconds until you hear a "beep" sound. This indicates the speakers are pairing.

Primary Speaker: The speaker you press and hold to begin the pairing process.

Secondary Speaker: The other speaker that connects automatically once the pairing process starts.

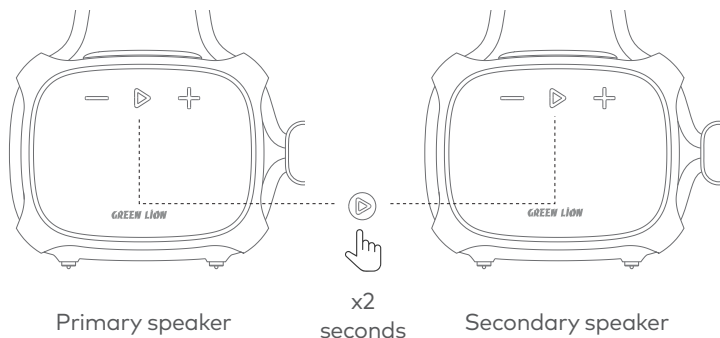

### 3. Connect via Bluetooth:

Open your device's Bluetooth settings and find the Bluetooth name of the paired speakers. There will only be one Bluetooth name visible when both speakers are successfully connected. Select it to connect.

(Note: The Bluetooth name will appear as "V5.3" for both speakers when connected.)

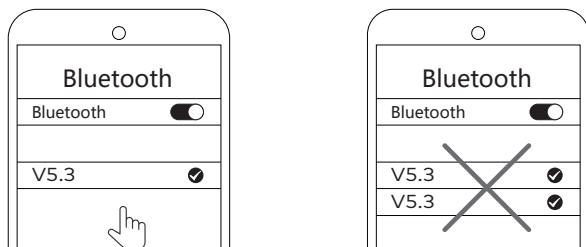

To disconnect the speakers, press and hold the Play/Pause button on one of the speakers for 2 seconds. You will hear a prompt sound to confirm the disconnection.

## Reset Function

To clear the pairing information and return the speaker to its default volume after a prompt tone, press and hold the Play/Pause button for 5 seconds. The speaker will automatically turn off once the reset is complete.

## Troubleshooting

### **1. The Speaker Does Not Turn On**

**Solution:** Ensure that the speaker is charged. If it is low on battery, recharge it and try turning it on again.

### **2. The Speaker Does Not Turn Off or Respond**

**Solution:** If the speaker is unresponsive, press and hold the Power button for 10 seconds to reset it. This will force the speaker to shut down.

### **3. No Sound Output**

**Solution:** Check the volume and ensure the speaker is connected to the device. Make sure the Bluetooth device is within range and there are no obstacles blocking the signal.

### **4. Poor Sound Quality**

**Solution:** Move the device closer to the speaker or remove any obstructions that may be interfering with the sound quality.

### **5. Unable to Connect the Device to the Speaker**

**Solution:** Disconnect any currently connected devices and forget the pairing. Then, re-pair your speaker with the device. Alternatively, press and hold the Power button for 10 seconds to reset the connection, allowing you to re-pair the speaker.

**Note:** Ensure that the speaker is within Bluetooth range (within 10 meters) and powered on when trying to pair it again.

## Safety Precautions

### A. Warning

#### 1. Ensure Waterproof Performance

To maintain the waterproof functionality of your Bluetooth speaker, please disconnect all cables and securely close the USB port. This will prevent water from entering the device and protect its internal components.

#### 2. Avoid Water Exposure During Charging

Exposing the speaker to water while charging can cause permanent damage. Ensure the speaker is fully dry before charging it, as water exposure during charging can compromise the speaker and power supply.

#### 3. IPX7 Waterproof Rating

The speaker's IPX7 rating means it can be submerged in water for up to 30 minutes at a depth of 1 meter. However, if the speaker is not in use for an extended period, it is advisable to recharge it at least once every three months to maintain its battery health.

#### 4. Battery Life Considerations

The speaker's battery life is affected by usage patterns and environmental conditions. For optimal performance, keep the speaker in suitable conditions and avoid exposure to extreme temperatures or humidity.

## B. Cautions

1. Ensure the speaker is placed in a stable location to avoid any risk of it falling.
2. Do not attempt to disassemble, repair, or modify the speaker yourself, as this may lead to damage or void the warranty.
3. Keep the speaker away from extreme temperatures to prevent overheating or freezing, which could harm its internal components.
4. Avoid using the speaker outdoors during thunderstorms to prevent damage from electrical surges or water exposure.
5. Never use corrosive cleaners to clean the speaker, as they could damage the surface or internal parts. Clean with a soft, dry cloth instead.



## Disposal

This product must not be disposed of as unsorted household waste. It is important to separate such waste for proper treatment and recycling, in compliance with local waste management regulations.

## Warranty

Products that you buy directly from our **Green Lion** website or shop come with a 24-month warranty.

When you buy **Green Lion** products from any of our approved sellers, you only get a 12-month warranty. If you want to extend this warranty, go to our website at <https://www.greenlion.net/warranty> and fill out the form with your information. Don't forget to upload a picture of the product too. After we've checked and accepted your request, we'll send you an email to confirm that your product's warranty has been extended.

For more info, please check:  
<https://www.greenlion.net/warranty>

## Contact Us

If you have any questions about this Privacy Policy, please contact us at:

Website: <https://www.greenlion.net/>

Sales: [sales@greenlion.net](mailto:sales@greenlion.net)

Service Support: [Support@greenlion.net](mailto:Support@greenlion.net)

Telegram: [@greenlion\\_global](https://www.instagram.com/greenlion_global)

Instagram: [@greenlion\\_global](https://www.instagram.com/greenlion_global)