

PORODO
LIFESTYLE



Porodo Lifestyle

**2-IN-1 SPLIT END TRIMMER &
HAIR STRAIGHTENER**

SKU: PDLFSTHSETWH

Table of Contents

Product Overview	2
Specifications	2
Product Design	3
Safety Precautions	3
Preparation Before Use	3
Usage Instructions	4
Adding Blade Oil	5
Safety Guidelines	5
Disposal	6
Warranty	6
Contact Us	6

Product Overview

The Porodo 2-in-1 Split End Trimmer & Hair Straightener is designed to give your hair a smooth, salon-quality finish while eliminating split ends in one easy step. Combining advanced trimming and straightening technology, this cordless device ensures effortless styling and healthier-looking hair. It features a visible hair-cutting system that allows you to see the split ends being removed, ensuring precise results without affecting the hair length. The blue light hair repair function helps restore hair vitality and shine, minimizing damage during use. Type-C charging offers fast and convenient recharging for styling. Whether you're straightening your hair or trimming away split ends, the Porodo Split End Trimmer & Hair Straightener delivers smooth, glossy, and revitalized hair every time

Specifications

Input	5V/1A
Rated Power	15W Max
Battery Capacity	500mAh
Charging Port	Type-C
Net Weight	266g
Product Size	30 x 50 × 260mm
Model Number	PDLFSTHSET

Product Design

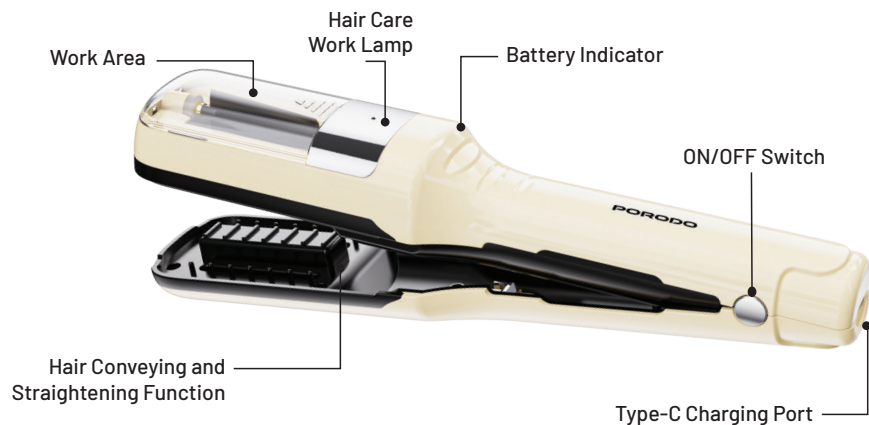

Safety Precautions

1. Read the guide thoroughly before use.
2. This device is not suitable for children.
3. Always cover the transparent blade guard during operation. Never touch the blade with your hand.
4. Avoid contact with water to prevent electric shock.
5. Please do not drop the machine, as it may cause damage.
6. Grease the blade with oil before use.
7. Clean the hair storage compartment after each use.
8. The machine can be used while charging.

Preparation Before Use

1. Wash and thoroughly dry your hair before use. Comb your hair to avoid tangling.
2. Ensure your hair is clean. Dirty hair may cause strands to stick together, resulting in uneven trimming. This device is designed to trim the ends of your hair, not adjust the length.

Usage Instructions

1. Before Use:

- a. Charge the machine fully before using it.
- b. When charging, the red indicator light will turn on, and when fully charged, the green indicator light will turn on.

2. Power On:

- a. Press the ON/OFF button on the back of the machine to open it.
- b. The blue light indicates the hair care function is active, and the lithium battery power indicator will be on at the same time.
- c. The green light means the battery is sufficient, the blue light indicates insufficient power, and the red light flashes when the device needs charging.

3. Using the Machine:

- a. Straighten the hair and place a pinch of hair into the machine.
- b. Close the machine and start the hair care and hair trimming (shaving) function.
- c. Slide down the machine to cut and straighten the hair, removing bad ends.

4. Repeat if Needed:

- a. Continue until all hair is treated and trimmed (shaved).
- b. If too much hair accumulates in the hair storage during the process, open the transparent cover to pour out the trimmed hair (refer to step 6).

5. After Use:

- a. Once finished, close the machine and press the ON/OFF button to turn it off.
- b. Open the transparent cover and clean the trimmed hair with a brush.
- c. Reinstall the transparent cover and store the machine.

6. Emptying the Hair Storage:

Open the transparent cover as shown in the figure to empty the accumulated hair.

Pull in the arrow direction

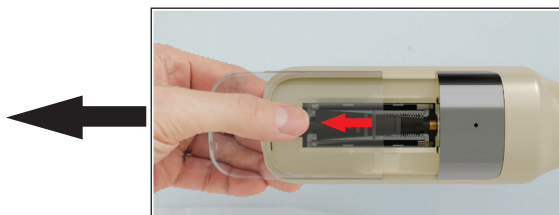

Adding Blade Oil

1. Refer to Step 6 in the usage instructions and remove the transparent cover.
2. Move the Sweep: Use your hand to move the sweep as shown on the right.
3. Apply Blade Oil: Remove the blade oil container, point the nozzle at the end of the blade, and gently pinch the tubing to slide the oil along the blade to the other end, as demonstrated below.

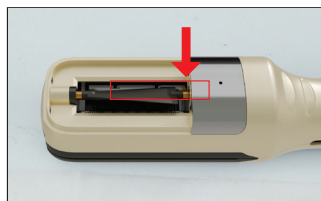

Safety Guidelines

1. Avoid using the trimmer continuously on one fixed area to prevent uneven hair trimming. It is recommended to treat the client's hair in sections. It is recommended to treat each section 3 times. Additional treatment may be required to address hair breakage.
2. For optimal results, maintain a hair treatment routine 5 times a week. If the client's hair is severely damaged, more frequent treatments may be necessary.
3. Straighten the hair properly. If the hair is not straightened as desired, you may have used too much hair at once. Remove some hair, comb it, and focus on the smallest and thinnest sections for better results.
4. Best suited for straight hair. For those with curly hair, straighten it first for the best outcome before using the trimmer.
5. Keep out of reach of children.

Disposal

This product must not be disposed of as unsorted household waste. It is important to separate such waste for proper treatment and recycling, in compliance with local waste management regulations.

Warranty

Products that you buy directly from our **Porodo** website or shop come with a 24-month warranty.

When you buy **Porodo** products from any of our approved sellers, you only get a 12-month warranty. If you want to extend this warranty, go to our website at **porodo.net/warranty** and fill out the form with your information. Don't forget to upload a picture of the product too. After we've checked and accepted your request, we'll send you an email to confirm that your product's warranty has been extended.

For more info, please check:
porodo.net/warranty

Contact Us

If you have any questions about this Privacy Policy, please contact us at:
info@porodo.net

Website: **porodo.net**

Service Support: **support@porodo.net**

Instagram: **[porodo](https://www.instagram.com/porodo)**