



Green Lion

Portable Lunch Box

SKU: GNGLB30LNCBK

Model No: GLB-30

Table of Contents

Product Overview	2
Specifications	2
Safety Instructions	3
Usage Guide	4
Scheduled Heating Guide	4
Heating Procedure	5
Keeping Warm Function	5
Product Components and Accessories	6
Internal Battery Precautions	6
Control Panel Functions	7
Cleaning and Maintenance	9
Disposal	10
Warranty	10
Contact Us	10

Product Overview

The Green Lion Portable Lunch Box is a versatile and convenient solution for heating meals on the go. With a 1-liter capacity, it features a built-in 8000mAh battery and electric heating functionality, allowing for rapid heating with 5 preset modes. The lunch box has a leakproof lid, ensuring secure transport, and is equipped with a steam release valve for safe heating. The digital touch display makes operation simple, while the USB-C charging port enables quick recharging of the device. Additionally, the lunch box is dishwasher safe for easy cleaning and includes a phone holder and power bank function, making it perfect for those who need a portable, multifunctional lunch solution.

Specifications

Model No.	GLB-30
Material	PP + 304 Stainless Steel
Voltage	7.4V
Power	60W
Battery	8000mAh
Charging Port	USB-C
Charging Time	3.5 Hours

Operating Time	70 Minutes
Capacity	1000 mL
Product Weight	1.47 Kg
Dimensions	220*154*126 mm

Safety Instructions

1. This product complies with the relevant safety regulations for electrical products.
2. Before use, verify that the voltage rating on the product's nameplate matches the voltage you intend to use.
3. When in use, place the product on a stable surface and keep it out of the reach of children.
4. Ensure that both the inner and outer surfaces of the product remain clean. Clean them promptly after use to maintain the product's performance.
5. Never immerse the product in water or allow liquids to enter it, as this can cause safety hazards.
6. If the product is not moist, do not attempt to dry it artificially, as this could damage the product and reduce its lifespan.
7. Do not attempt to disassemble, repair, or modify the machine unless done by a certified technician, as improper handling can result in fire hazards or leakage.
8. The equipment should never be immersed in water.

Usage Guide



1

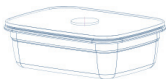

2



3

1. Pull out the pressure relief valve.
2. Close the pressure recovery valve.
3. Place the container in insulation container and close it.



Note: Do not fill the main unit with water or food.

Scheduled Heating Guide

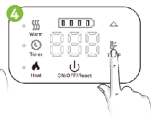
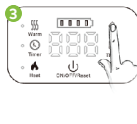

1. Press and hold the power button for 3 seconds to turn on the device.
2. Press the "Timer" button to enable the heating schedule function.
3. Use the up and down arrows to adjust the time before heating starts.
4. Press the "TEMP" button to set the desired heating temperature.

Heating Procedure

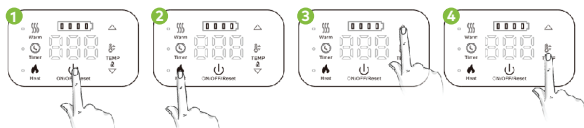

1. Press and hold the power button for 3 seconds to turn on the device.
2. Press the "Heat" button to enable the heating function.
3. Use the up and down arrows to adjust the time before heating begins.
4. Press the "TEMP" button to set the desired heating temperature.

Keeping Warm Function

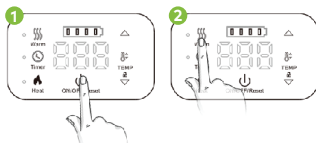

1. Press and hold the power button for 3 seconds to turn on the device.
2. Press the "Warm" button to activate the heating schedule function.

Product Components and Accessories

1. Rechargeable insulated lunch box
2. Stainless steel container (1 set)
3. Smart lunch box
4. Charging cable
5. Power adapter



Internal Battery Precautions

1. How to Remove the Built-In Battery:
 - a. Remove the bottom anti-skid pad.
 - b. Loosen the four screws.
 - c. Remove the host liner.

- d. Disconnect the battery terminal.
 - e. Take out the built-in battery.
2. Battery Disposal Precautions:
- a. The battery must be removed before discarding the appliance.
 - b. Ensure the appliance is powered off before removing the battery.
 - c. Dispose of the battery safely.

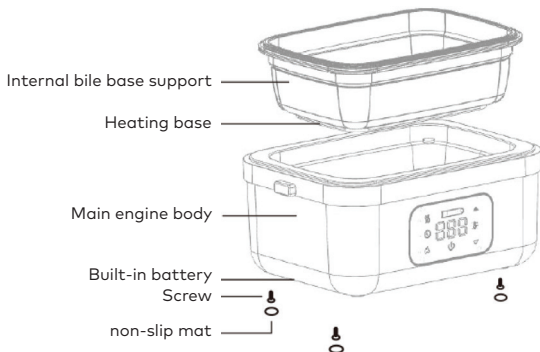

Control Panel Functions

Thermal Insulation Mode Function Button: Press once to enter thermal insulation mode. The display shows the graphic type – cycle, and the machine can work for about 15-20 hours once the battery is fully charged.

Appointment Function Button: Set the device start time from 30/60/90/120/150/180/210/240 minutes. For example, set it to start at 8:00 AM, and the display will show a 210-minute countdown. Once complete, the machine will enter standby mode for 2 minutes and then turn off. The default heating time in reservation mode is 30 minutes.



Heating Function Button: Set heating time for 20/30/40/50/60 minutes. For instance, to heat food for lunch at 12 o'clock, set the heating time to 30 minutes. The default setting is 30 minutes.



Battery Power Display: The 4-segment power display shows the remaining power. If the display shows only one segment, it indicates low power, and the battery indicator will flash. Charge the device to ensure normal operation.



Time and Temperature Display: Displays both time and temperature. The icon indicates the temperature, and when the temperature indicator is off, the display shows the device's time value.



Power On/Off and Reset Buttons: Press and hold for 1.5 seconds to turn on/off the device. Press again to reset the settings. If the mode button is locked, press the power button to restore the settings.



Up and Down Key Function: Use the up (Δ) and down (▽) arrows to adjust the time and temperature. To reduce time, use



the ▼ key to increase time or temperature. Press the reservation button to set the reservation time, and the indicator light will flash while setting.



Lock Key: Press the lock key to lock the mode settings. When locked, the indicator light will stay on. To unlock, press and hold the lock key for 3 seconds. For example, to change the heating time after 10 minutes, unlock the device, and the settings will be reset.



Cleaning and Maintenance

1. Stainless Steel Container:

After each use, remove any food residue. Add a little water and wipe it with a cloth or sponge using soft water. Then rinse it with water 2-3 times.

2. Product Cleaning:

Do not immerse the device in water. Instead, use a damp cloth with an appropriate detergent to wipe the outer surface of the product. Ensure the power supply is completely disconnected before cleaning.

3. Cleaning Tips:

After use, unplug the power and allow the device to cool. Avoid using excessive water or corrosive cleaning agents. Use a soft detergent, and avoid harsh materials like banana water, gasoline detergent, or steel wire brushes. When the product is not in use, clean it and store it in its original packing box in a dry, ventilated place to avoid moisture damage.

Disposal

This product must not be disposed of as unsorted household waste. It is important to separate such waste for proper treatment and recycling, in compliance with local waste management regulations.

Warranty

Products that you buy directly from our **Green Lion** website or shop come with a 24-month warranty.

When you buy **Green Lion** products from any of our approved sellers, you only get a 12-month warranty. If you want to extend this warranty, go to our website at <https://www.greenlion.net/warranty> and fill out the form with your information. Don't forget to upload a picture of the product too. After we've checked and accepted your request, we'll send you an email to confirm that your product's warranty has been extended.

For more info, please check:
<https://www.greenlion.net/warranty>

Contact Us

If you have any questions about this Privacy Policy, please contact us at:

Website: <https://www.greenlion.net/>

Sales: sales@greenlion.net

Service Support: Support@greenlion.net

Telegram: [@greenlion_global](https://www.instagram.com/greenlion_global)

Instagram: [@greenlion_global](https://www.instagram.com/greenlion_global)