

PORODO
LIFESTYLE



Porodo Lifestyle
OASIS MIST
Electronic Bakhour Burner

SKU: PDLFST201BK

Table of Contents

Product Overview	2
Specifications	2
Product Features	3
Product Design	3
Operating Instructions	4
Incense Replacement	4
Charging Instructions	5
Power Button Operations	5
Frequently Asked Questions	6
Safety Precautions	7
Disposal	7
Warranty	8
Contact Us	8

Product Overview

The Oasis Mist Electronic Bakhour Burner by Porodo is a sophisticated device designed to enhance your environment with every scent. Featuring wide diffusion coverage of up to 100m², it ensures a full burning session with ease. This burner operates with both automatic and manual modes, providing flexibility based on user preference. With Type-C charging, it offers convenient and fast power-ups. Its sleek, modern design, coupled with its high-performance features, makes it an ideal addition to any space, particularly for those who appreciate a pleasant, aromatic atmosphere.

Specifications

Input	DC 5V/2A
Battery Capacity	3600mAh
Area Coverage	80-100 m ²
Rated Power	10W
Fan Speed	6000RPM
Charging Port	Type-C
Material	Aluminum
Net Weight	418g
Product Size	70 x 70 x 150mm
Charging Time	3H
Working Time	54 Minutes (Operates for 120 seconds per session, automatically shuts off after each)

Product Features

1. Wide diffusion coverage of up to 100m², ensuring that the scent fills a large area.
2. Full burning session for an extended, consistent aroma experience.
3. Type-C charging for fast and convenient power replenishment.
4. Dual operation modes: automatic and manual, allowing for customized control.
5. Sleek, modern design with a gold-accented top, adding elegance to any space.
6. Compact and portable, perfect for use in cars, homes, or offices.

Product Design

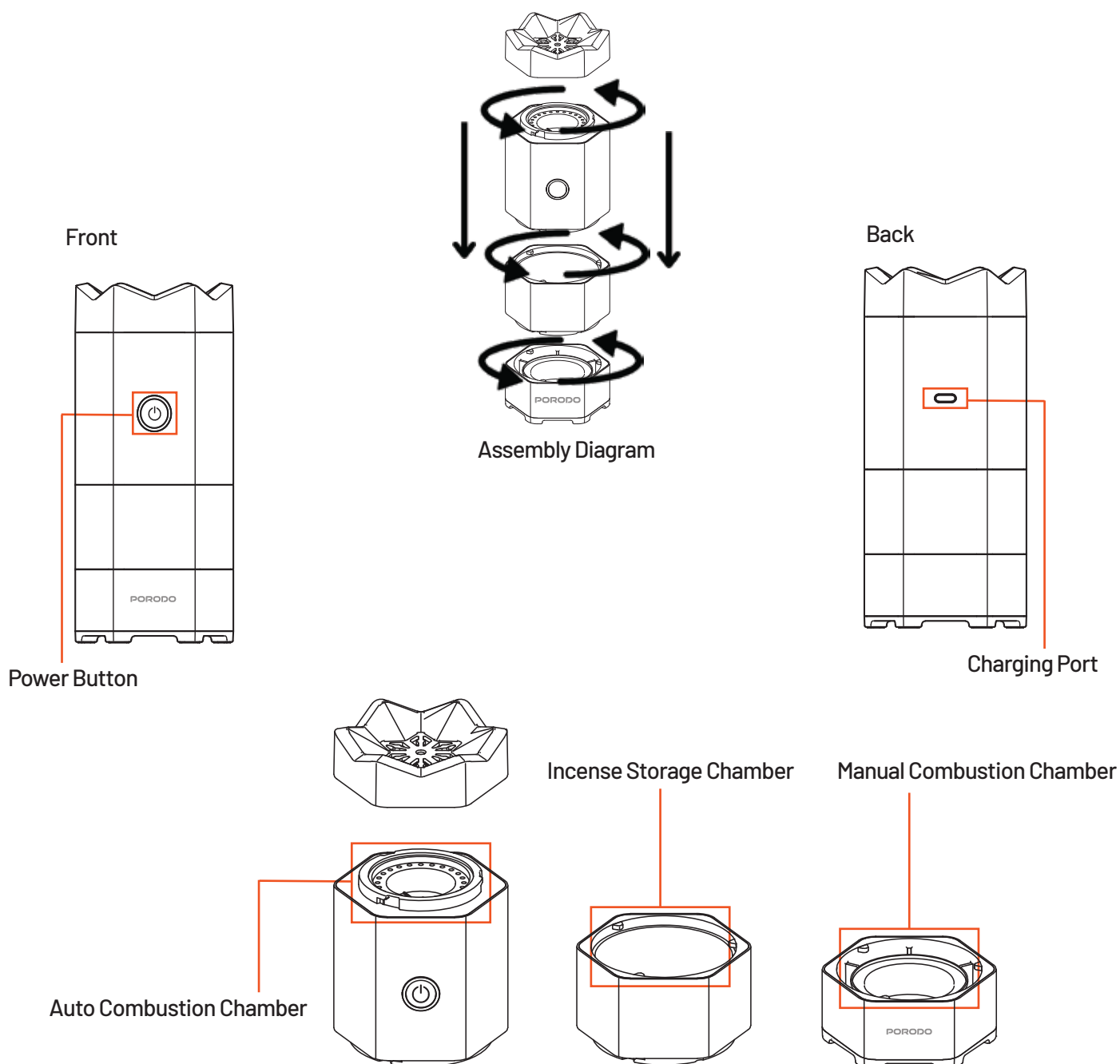

Operating Instructions

1. Mode 1: Automatic Combustion (Recommended)

a. Opening Procedure:

As shown in Figure A, hold the edge of the top cover, rotate counterclockwise to release the buckle, and gently lift the cover.

b. Incense Placement:

Use the provided tweezers to place incense in the automatic combustion chamber (Figure B).

c. Reassembly:

Align the top cover with the main body and rotate clockwise until fully secured (Figure C).

d. Activation:

Press and hold the power button for 1.5 seconds to start.

2. Manual Combustion

a. Chamber Removal

Rotate the manual combustion chamber at the base counterclockwise. Gently remove the combustion chamber assembly.

b. Independent Operation

Ignite the incense using an open flame. Carefully place the lit incense into the chamber with the provided tweezers.

Incense Replacement

1. Refer to the diagram: It is important to use the diagram as a reference for correctly positioning the incense during the replacement process, especially the first time or when the incense has been fully used.

2. Cool the combustion tray: After each use, the combustion tray may remain hot. Ensure the tray has completely cooled before attempting to replace the incense. This precaution helps avoid burns or damage to the tray or incense.

3. Cooling time: Allow the combustion tray to cool for at least 30 minutes before replacing the incense. This is the recommended cooling time to ensure safe handling and preserve the integrity of the unit.

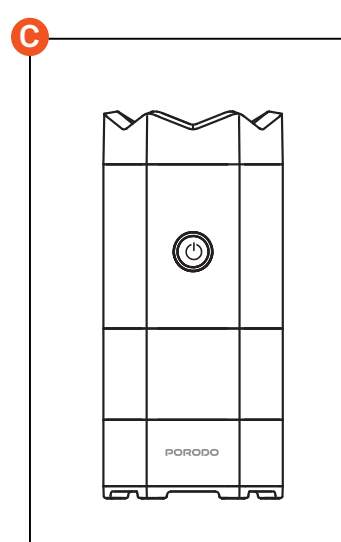
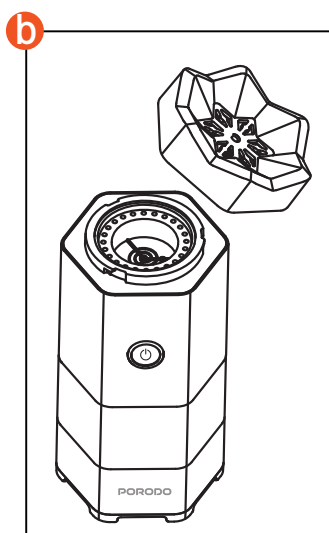
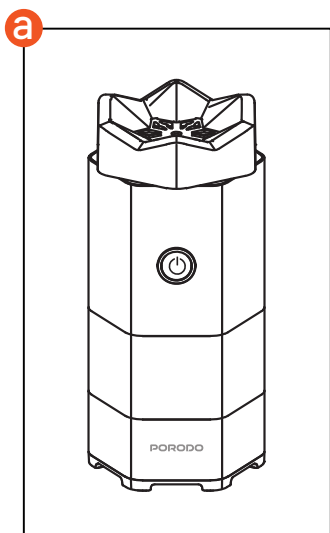

Charging Instructions

1. Power Requirements: Use a DC 5V \geq 2A power adapter.
2. Certification: Only use CCC-certified adapters from reputable brands.
3. Charging Indicators:
 - a. Charging: Red LED indicator at the power button.
 - b. Fully Charged: Green LED indicator at the power button.

Power Button Operations

1. Power On

To turn on, press and hold the power button for 1.5 seconds. The power indicator will illuminate.

Note: The device automatically shuts down after 2 minutes with all indicators off.

2. Power Off

To turn off, press and hold the power button for 3 seconds during operation.

3. Important Notes

- a. Cooling Protection: After powering off, the fan may continue to operate briefly. This is normal.
- b. Restart Interval: Wait 30 seconds after automatic shutdown before restarting the device.
- c. Protection Alert: If restarted within 30 seconds, the indicator will flash purple three times as a

Frequently Asked Questions

1.

a. How long does it take to fully charge the battery?

b. It takes 3-6 hours to fully charge the battery.

2.

a. What should you pay attention to when choosing spices?

b. Smaller wood particles will shorten the heating time. The type and quality of incense will affect the amount of spray and fragrance duration.

3.

a. Can the product be turned on while charging?

b. The combustion function cannot be activated while the product is charging.



to prevent spices or ashes from spilling when the machine accidentally tips over, the machine will automatically stop when it tilts more than 45 degrees.



when the machine is put back on its original position and reset, it will resume working after 5 seconds.

Safety Precautions

1. Keep the product upright after loading incense; do not tilt or invert.
2. Any disassembly or modification is strictly prohibited.
3. Clean the ceramic tray and store it properly when not in use for extended periods.
4. Recommended ambient temperature: 10°C–50°C.
5. Keep out of reach of children and pets.
6. Built-in anti-tilt protection will deactivate the unit when tilted (normal function).
7. Variations in fragrance diffusion area may occur with different incense types (normal).
8. Not for consumption; seek immediate medical attention if ingested.
9. Maintain a safe distance during use; avoid direct inhalation.
10. Use with caution for fragrance-sensitive individuals.
11. Intended for air freshening purposes only.



Disposal

This product must not be disposed of as unsorted household waste. It is important to separate such waste for proper treatment and recycling, in compliance with local waste management regulations.



Warranty

Products that you buy directly from our **Porodo** website or shop come with a 24-month warranty.

When you buy **Porodo** products from any of our approved sellers, you only get a 12-month warranty. If you want to extend this warranty, go to our website at **porodo.net/warranty** and fill out the form with your information. Don't forget to upload a picture of the product too. After we've checked and accepted your request, we'll send you an email to confirm that your product's warranty has been extended.

For more info, please check:
porodo.net/warranty

Contact Us

If you have any questions about this Privacy Policy, please contact us at:
info@porodo.net

Website: **porodo.net**

Service Support: **support@porodo.net**

Instagram: **porodo**