



GREEN LION

User Manual



JX66 JUMP STARTER

TYRE INFLATOR | FLASHLIGHT | POWER BANK

Safety Informations

Please read the following instructions carefully before using the multi-function vehicle emergency starter (hereinafter referred to as the jump starter):

1. Please strictly follow the instruction manual to operate. If used improperly, or against the instructions, it may cause a serious safety incident;
2. Only for starting 12V engine and can not start vehicles exceeding specified displacement or voltage;
3. If you start to pump up your tires without setting a target tire pressure value, the air inflator will not automatically stop pumping and instead you will need to manually stop it. There's risk of over-inflated tires or a blowout condition if the tire pressure is not kept under observation in real time;
4. The air inflator generates heat when used, especially at the air nozzle. Do not touch the air inflator immediately after pumping, and we suggest you wear gloves to protect yourself against burning;
5. In order to prolong the the life of battery, please charge the device after purchase and charge and discharge the device every three months to ensure that it is in good condition for the next use;
6. Do not use a jump starter that has been severely hit, dropped or other damaged;
7. Please do not disassemble the jump starter without authorization. Please contact a professional maintenance personnel for repairing the jump starter;
8. When the jump starter is charging, do not use it to start the vehicle;
9. Be extra cautious during operation to avoid metal tools falling on the jump starter interface (it is easy to cause a short circuit, equipment damage, or an explosion);
10. When using the jump starter, ensure that the surrounding area is well ventilated;
11. When starting the vehicle, make sure that the positive and negative contact points on the cable clamp of the jump starter are in good contact with the positive and negative poles of the battery;
12. Sparks and flames contacting the jump starter and engine is forbidden;
13. In order to prevent sparks from short-circuiting and damaging the jump starter, it is forbidden to clamp the positive and negative poles of the clamp together or touch the same metal;
14. Do not place the jump starter where children can reach it;
15. Do not expose the jump starter to rain or snow;
16. Do not leave the device in extreme environments for a long time (high temperature: above 131°F(55°C), extreme cold: below 14°F(-10°C), humid: humidity> 80%);
17. Please store the jump starter in a cool and dry place, and take protective measures if necessary;
18. Please charge the product in time to prevent battery low-voltage or out of power. Long time no power status of battery may cause the product to fail to charge.

Packing List & Specification

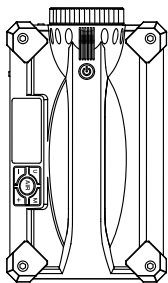

①
M6 Jump Starter
with Air Compressor

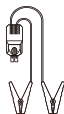

②
Smart Jump Clamps



③
Inflatable Hose



④
USB-C Cable

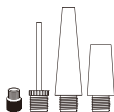

⑤
Nozzle Adapters

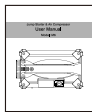

⑥
User Manual



⑦
Protection Case

Specification:

Model No.	: GL-JX66
Material	: ABS
Battery Capacity	: 24000mAh
Power	: 88.8W
Voltage	: 12V
Current	: 2000-6000A
Flashlight	: 15W
Brightness	: 2000 lm
Reading Light	: 5W
Pump Pressure	: 150 PSI
Airflow	: 40L/min
Charging Port	: Type-C
Charging Time	: 2 Hrs
Type-C Input	: 5V/3A, 9V/2A, 12V/3A, 15V/3A, 20V/3.25A
USB-A Output	: 5V/3A, 9V/2A, 12V/1.5A (QC 18W)
Type-C Output	: 5V/3A, 9V/3A, 12V/3A, 15V/3A, 20V/3.25A (PD65W)
Product Weight	: 1350 g
Product Dimensions	: 256*145*105 mm

Operation Interface

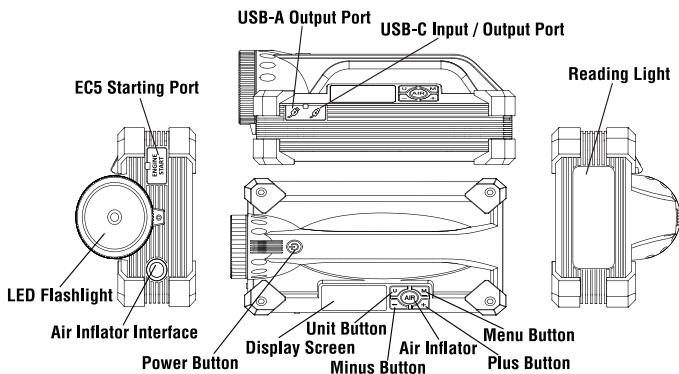

Power Button	Power Button/Light Mode Switch
Display Screen	Battery Volume, Input/Output Status, Air Pressure Value, Inflation Modes
Air Inflator	Turn on/off AIR inflator
Unit Button	Unit Switch Air inflation Pressure
Menu Button	Air Inflation Modes Wake and Switch
Minus Button	Decompress
Plus Button	Pressurize
EC5 Starting Port	To Connect with the Smart Clamp
Air Inflator Interface	To Connect Inflatable Air Hose
LED Flashlight	White Flashlight / Strobe / SOS
USB-A Output Port	Output Charging Port
USB-C Input / Output Port	Input / Output Charging Port
Reading Light	Warm Reading Light

Operating Procedure

1. How to power up the jump starter?

Long press the “Power” button for 2 seconds.

2. How to use the jump-start function?

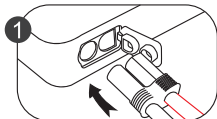

2.1 Connect the jump starter clamps with the EC5 connector to the jump starter;

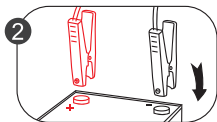

2.2 Connect the red (+) clamp to the positive (+) terminal on the vehicle battery and the black (-) clamp to the negative (-) terminal on the vehicle battery, and make sure that the connections are good, the green indicator will light up if there is no issues;

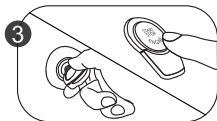

2.3 Press the “START” button or turn the ignition switch to start your vehicles. If the vehicle starts successfully, the jump starter will automatically disable the power output;

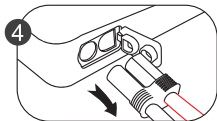

2.4 Please remove the jump-start clamps from the car battery instantly after you finished the starting. Pressing on the “Power” button for 2 seconds to shut down jump starter. If there is no operations for 60 seconds, the product will automatically shut down.

In most cases, the vehicles will be able to start immediately after the jump starter has been connected. Some vehicles may need to be connected to the jump starter for 30-120 seconds (the product will charge the car battery at this time) to continue the operation. If the vehicle does not start immediately, please wait 20-30 seconds before each attempt. Do not attempt more than five times within 15 minutes;

3. How to use the air inflator function?



3.1 The inflatable hose is connected to the output port of the air inflator, and then tighten the nut, and the other end is connected to the car tire;

3.2 Long press "Power" button for 3 seconds to turn on the device (If the device is off).

3.3 Press the "M" button to enter the air inflation mode and short press to select the correct mode from the 4 inflation modes: car, motorcycle, bicycle and ball;

3.4 Short press the "Unit" button to switch the pressure unit of tire pressure: BAR, PSI, KPA, kg/cm²;

Car		Motorcycle		Bicycle		Ball	
PSI	BAR	PSI	BAR	PSI	BAR	PSI	BAR
24-51	1.7-3.5	24-42	1.7-2.9	30-150	2.1-10.3	4-16	0.3-1.1

3.5 To set the target tire pressure value, you must first know the tire pressure requirements of the tire. (For the standard tire pressure value of the tire, you can check the pressure value mark on the tire, or check the manual of the inflated product), set the target tire pressure value by pressing "+/-" button. After setting, the value will enter the real-time monitoring state of tire pressure;

3.6 Press the "AIR" button to turn on the air inflator. When the tire pressure reaches the set value, the air inflator will be turned off automatically. To turn off the inflator manually: Press the "AIR" button;

3.7 Remove the inflatable hose.

(Safety Reminder: During the inflation process, the heat generated by the air inflator will cause local high temperature. Please leave the product for 10 minutes to dissipate heat before removing the inflation tube to prevent scalds.)

4. How to charge your jump starter?

4.1 You will need a USB-C power adapter (output 5V/3A or 9V/3A or 12V/3A or 15V/3A, or 20V/5A USB-C adapter if PD protocol supported);

4.2 Connect the USB-C power adapter with the jump starter's USB-C charging port by the USB-C cable. At this point, the battery indicator and the "INPUT" icon on the screen will turn on, indicating that the product is charging;

4.3 In the case of running out of power or low power, please charge the product in time to prevent battery under-voltage. Long-term no power status of battery may cause the product to fail to charge.

5. How to use LED light?

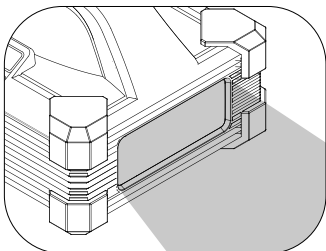
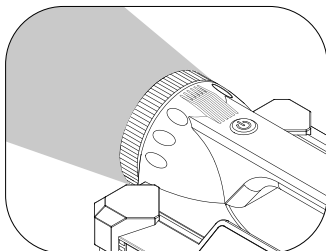

5.1 Short press the “Power” button, the LED lights up;

5.2 Short press the “Power” button in order to switch the modes of ON, strobe, SOS, reading light and OFF;

5.3 Long press the “Power” button for 2 seconds to turn off the LED light forcefully.

Troubleshooting Guides

NO.	ERROR CODE	EXPLANATION	SOLUTION
1	E01	Air inflator error	Drying automatic for 24 hours
2	E04	Over temperature of the battery	Wait for the product to cool down
3	E05	Over temperature of air compressor	Wait for the product to cool down
4	Solid red indicator	Low voltage	Recharge the product
5	Solid red indicator	Over heating	Remove the clamps to let it cool
6	Solid red with discontinuous beeping	Reverse polarity	Reverse the clips and ensure the correct connection
7	Solid red with continuous beeping	Short circuit	Don't connect the clips together or to the same metal

Warnings & Recycling Treatment

Warnings

- Do not disassemble the product as there are no user-serviceable parts. Any maintenance should be operated by professional maintenance-specialist.
- Quickly starting your vehicle can be possible when the jump-starter battery capacity is not less than 70% although your vehicle may not be able to start electively if the jump starter does not have enough sufficient power.
- It is normal for the jump starter to heat up after it is turned on or while the air inflation function is being used.
- In order to maintain optimal the life of battery, charge the jump starter at least once every 3 months.
- If the jump starter start to leak or emit any peculiar smell, stop using it and contact us immediately.
- Do not connect the red clamp with the black clamp as this can be dangerous.
- Use the original jump starter clamps only.
- Stay away from fire and water to avoid safety accidents.
- Do not place the jump starter in an environment with temperatures above 60°C and do not allow it to have prolonged exposure under sunlight. Store the jump starter in a cool and dry place.
- Do not disassemble or modify this product without approval.
- Do not violently knock, press or shake the jump starter; otherwise, it may cause a fire, explosion or combustion.
- Do not use chemical cleaners to clean this product.
- Keep this product away from children.

Recycling Treatment

1. To avoid irreparable harm to the environment or human beings, do not dispose the jump stater with other household garbage.
2. Separate the device from other types of garbage and recycle it in a responsible manner to maintain sustainable use of materials.

Warranty Policy

we offer a limited warranty on the product 12 months from the date of purchase on any defects in materials and workmanship. Conditions are as follows:

1. The buyer must provide proof of order details from the official channel to apply for after-sales service.
2. The warranty does not cover damage or malfunction caused by normal wear and tear, physical damage, improper installation, misuse, or modification or unauthorized repairs by third parties.
3. The manufacturer shall not be liable for any loss or damage caused in transit by a third party or by force majeure.
4. The manufacturer is not responsible for any incidental or consequential damages arising from the use or misuse of this product.
5. All warranty claims are limited to the repair or replacement of defective products and are at our sole discretion.
6. If we repair or replace the product, the product will be covered for the remainder of the original warranty period. We reserve the right to repair or replace refurbished equipment, products or accessories which may involve the use of the same functions.
7. Consumable parts, such as batteries, are not covered by the warranty.
8. The manufacturer reserves the right to change and interpret these terms and conditions of the warranty at its own discretion.

