

PORODO



Porodo

KIDS

DRAWING & WRITING BOARD

SKU: PDKHBY1



Table of Contents

Product Overview	2
Specifications	2
Schematic View	3
Buttons and Other Functions	4
Operation Instructions	5
Safety Precautions	7
Disposal	7
Warranty	8
Contact Us	8

Product Overview

The Kids Drawing & Writing Board from Porodo is an interactive educational tool designed to help children learn and create in a fun and engaging way. Featuring a 3.0" IPS display, this board comes with 95 guided drawings to inspire creativity and artistic expression. It supports video recording, allowing children to capture their drawings in real-time, and the video-sync feature adds an extra layer of interaction to their creative process. The "Intelligent Learning Board" promotes both drawing and writing skills, offering a perfect combination of learning and fun for young minds. Ideal for parents looking to enhance their child's cognitive and artistic abilities, this board provides a smooth, user-friendly experience for children of various ages.

Specifications

Display Size	3.0" IPS
Battery Capacity	1200mAh
Video Recording	1080P
I/O Ports	USB-C, TF Card Slot
Alphabet	26 Letters (A-Z)
Song	18 Nursery Rhyme (English)

Story	15 Story (English)
Words	10 Categories
Pinyin	6 Categories
Simple Drawings	95 (Voice-Guided)
Product Size	15 x 190 x 300mm
Product Weight	331g
Model Number	PDKHBY1

Schematic View

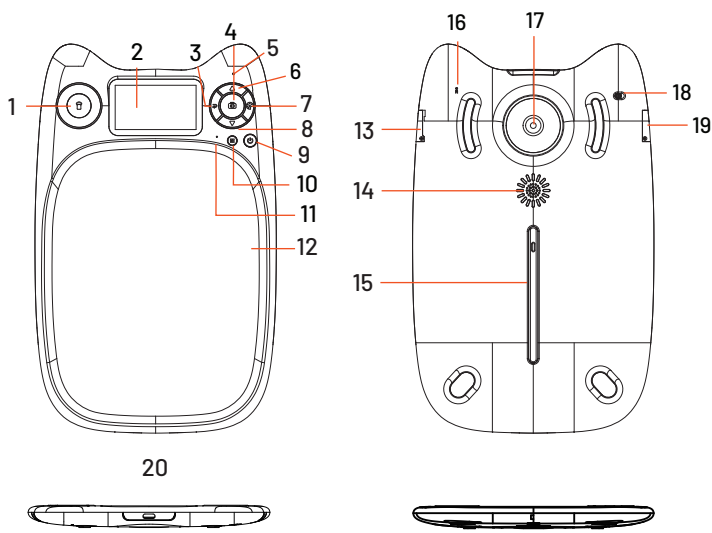

- | | | | |
|---------------|-----------------|---------------------|-------------------------|
| 1. Clear Key | 6. Up Button | 11. Indicator Light | 16. Reset pin |
| 2. Display | 7. Right Button | 12. Paint Board | 17. Camera Lens |
| 3. Left-click | 8. Down Button | 13. TF card slot | 18. Anti-clear Button |
| 4. OK Button | 9. Power Switch | 14. Speaker | 19. Battery Compartment |
| 5. Markers | 10. Mode Button | 15. Brushes | 20. Charging Port |

Buttons and Other Functions

1. Power Switch

- a. Press and hold to turn on/off the device.
- b. In playback mode, click to bring up the Delete option.

2. Up Arrow Key

- a. Up arrow key: Switch to the previous file in playback mode.
- b. Click to increase volume or long-press to fast forward in video playback.
- c. For the camera and video interface, press to increase volume or zoom in.

3. Down Arrow Key

- a. Down arrow key: Switch to the next file in playback mode.
- b. Click to reduce volume or fast forward in video playback.
- c. For the camera interface, press to reduce volume or zoom out.

4. Left Key

Click to return to the previous screen (except for photo, video, and playback modes).

5. Right-Hand Button

When taking photos or recording, press to return to the home screen.

6. OK Key

Confirm action (e.g., shutter button for photos/videos), take a photo or video, pause or play tutorial video.

7. Mode Keys

In photo, recording, or playback mode, click to switch between functions.

8. Clear Key

Clears the content on the drawing board.

9. Anti-Clear Key

- a.** Move left to prevent content from being cleared.
- b.** Move right to disable this prevention.

10. Reset Pin

If the device crashes, use a pin to reset it by poking into the hole.

11. USB Data Interface

Type-C port: Connect an external power supply to charge the device or transfer data.

12. TF Card Slots

For storage cards (e.g., SD cards).

Operation Instructions

1. Power On and Off

- a.** Press the Power Button to turn the device on.
- b.** Long-press the Power Button again to turn it off.

2. Photo Mode

- a.** Press the Up/Down Keys to navigate to photo mode ().
- b.** Click the OK Button to enter photo mode.
- c.** Press the OK Button to take a photo. A "click" sound indicates that the photo has been successfully captured.
- d.** Use the Up/Down Keys to adjust the volume of the system.
- e.** Press the Mode Key to switch between camera and replay mode.
- f.** Click the Right-click Button to return to the main interface.

3. Video Mode

- a.** Press the Up/Down Keys to navigate to the video mode ().
- b.** Click the OK Button to enter video recording mode.
- c.** Press the OK Button to start recording. The blue light will start flashing to indicate that recording is in progress.

- d. Press the OK Button again to stop the recording and automatically save it.
- e. Use the Up/Down Keys to adjust the volume of the system.
- f. Press the Mode Key to switch between playback and camera modes.
- g. Click the Right-click Button to return to the main interface.

4. Playback Mode

- a. Press and hold the Up/Down Keys to navigate to playback mode ().
- b. Click the OK Button to enter playback mode.
- c. Press Up/Down keys to switch files.
- d. Press the power button to open the delete window.
- e. When playing a video, press the OK button to play or pause the video.

5. Pictographs/Words/Letters/Chinese Characters/Pinyin

- a. Press the Up/Down Keys to navigate and select this mode.
- b. Click the OK Button to enter.
- c. Use the Up/Down Keys to select the desired option, then click the OK Button to enter.
- d. Once entered, it will play automatically. Click the OK Button to pause or play.
- e. Press the Up Key to return to the previous step, and press the Down Key to move to the next step. During playback, use the Up/Down Keys to adjust the volume.
- f. Press the Mode Key to switch to video/camera/recording mode.
- g. Click Left/Right Keys to return to the previous step or main screen.

6. Folk Songs/Stories

- a. Press the Up/Down Keys to navigate to this mode.
- b. Click the OK Button to enter.
- c. Press the Up/Down Keys to select a nursery rhyme or story.
- d. Click the OK Button to pause or play the video.
- e. Use the Up/Down Keys to increase or decrease the volume.
- f. Press the Mode Key to switch to video/camera/recording mode.
- g. Click the Left/Right Keys to return to the main interface.

7. Settings

- a. Press and hold the Up/Down Keys to move to the setup mode.
- b. Click the OK Button to enter the settings.
- c. Use the Up/Down Keys to select menu options.

- d. Click the OK Button to confirm and save changes.
- e. Press the Left Key to return to the previous step.
- f. After selecting the English model, the options for "Chinese characters" and "pinyin" will no longer be available.

Safety Precautions

- 1. This toy is not suitable for children under 3 years old due to containing small parts.
- 2. Clean the toy with a dry cloth. Disconnect it from the transformer before cleaning.
- 3. The product contains high-precision components. Do not disassemble or modify it.
- 4. Regularly check the transformer's wires, plugs, casings, and other parts for faults. If any issues are found, stop using it and contact our after-sales service for repairs.
- 5. Do not connect the toy to more than one (5V = 1A) power supply. Only use the recommended transformer.
- 6. The toy has a built-in 3.7V battery that is non-removable and non-replaceable. If damaged, contact the repair service.
- 7. The transformer should be used by adults or under adult supervision.
- 8. Toys are not suitable for children under 3 years old.
- 9. Retain important information provided on this package for future reference.

Disposal

This product must not be disposed of as unsorted household waste. It is important to separate such waste for proper treatment and recycling, in compliance with local waste management regulations.

Warranty

Products that you buy directly from our **Porodo** website or shop come with a 24-month warranty.

When you buy **Porodo** products from any of our approved sellers, you only get a 12-month warranty. If you want to extend this warranty, go to our website at **<https://www.porodo.net/warranty>** and fill out the form with your information. Don't forget to upload a picture of the product too. After we've checked and accepted your request, we'll send you an email to confirm that your product's warranty has been extended.

For more info, please check:
<https://www.porodo.net/warranty>

Contact Us

If you have any questions about this Privacy Policy, please contact us at:

info@porodo.net

Website: **<https://www.porodo.net/>**

Service Support: **support@porodo.net**

Instagram: **porodo**