



**Green Lion**

**HEATER LITE**

**Fan and Heater**

SKU: GNHTLW1500BK

Model No: GHT1500

# Table of Contents

Overview	2
Safety Instructions	2
Precautions	4
Package Contents	6
Product Diagram	6
Specifications	7
Mode Setting	8
Control Panel Diagram	8
Remote Control Guide	8
Button Function Guide	9
Display Screen Description	10
Safety Features	11
Battery Replacement	12
Warning	13
Cleaning and Maintenance	13
Troubleshooting	15
Disposal	16
Warranty	16
Contact Us	16

## Overview

The Green Lion Heater Lite is a 1500W fan and heater combination offering quick 3-second ceramic heating. It provides all-season comfort with two heat settings (High Heat, Low Heat) and features a smart LED display, remote control, and timer functionality. It has a stable circular base and a safety child lock. The heater is designed for efficient room coverage and comes with overheating and tip-over protection for added safety. Ideal for versatile use, it combines both heating and fan functions in one device.

## Safety Instructions



Do not place near flammable items.



Do not plug in the power cord with wet hands.



Do not touch the air vent with hands.



Do not use water, wax, glaze, or chemical solutions to clean this product.



Do not place near children.



Do not use in a humid place, such as a shower room.



This product uses a polarized plug (the two ends of the plug have different thicknesses). To reduce the risk of electric shock, ensure that you plug this product into a polarized outlet only. If the plug does not fit into the outlet, try twisting it and plugging it back in. If it still does not fit, consult an electrician. Do not damage the safety features of this product.

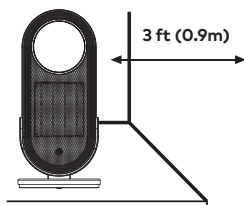

Always place this product on a stable, level surface. Keep at least 3 feet (0.9 meters) away from surrounding walls and flammable objects.



Do not disassemble this product. Additionally, do not operate the product with a damaged power cord or plug. Do not use the product after it has been damaged in any way (e.g., dropped).

## Precautions

1. Read all instructions before using this heater.
2. This heater is hot when in use. To avoid burns, do not let bare skin touch hot surfaces. If available, use handles when moving this heater. Keep combustible materials, such as furniture, pillows, bedding, papers, clothes, and curtains, at least 3 feet (0.9 meters) from the front of the heater, and away from the sides and rear.
3. Always unplug the heater when not in use.
4. Extreme caution is necessary when any heater is used by or near children or invalids, and whenever the heater is left operating unattended.
5. Do not operate any heater with a damaged cord or plug, or after the heater malfunctions, has been dropped, or damaged in any way.
6. Do not use outdoors.
7. This heater is not intended for use in bathrooms, laundry areas, or similar indoor locations. Never place the heater where it may fall into a bathtub or other water container.
8. Do not run cord under carpeting. Do not cover cord with throw rugs, runners, or similar coverings. Do not route cord under furniture or appliances. Arrange cord away from traffic areas, where it will not be tripped over.
9. To disconnect the heater, turn controls off, then remove the plug from the outlet.
10. Do not insert any foreign objects into any ventilation or exhaust openings as this may cause an electric shock or fire, or damage the heater.
11. To prevent a possible fire, do not block air intakes or exhaust in any manner. Do not use on soft surfaces, like a bed, where openings may become blocked. A heater has hot and arcing or sparking parts inside.

Do not use it in areas where gasoline, paint, or flammable vapors are used or stored.

**12.** Use this heater only as described in this manual. Any other use not recommended by the manufacturer may cause fire, electric shock, or injury to persons.

**13.** Always plug heaters directly into a wall outlet/receptacle. Never use with an extension cord or relocatable power tap (outlet/power strip).

**14.** If there is a loose fit between the plug and the socket, or if the plug becomes very hot, the socket may need to be replaced. Check with a qualified electrician to replace the socket.

**15.** It is normal for the plug and cord to feel warm to the touch. A plug or cord which becomes hot to the touch or becomes distorted in shape may be the result of a worn electrical outlet. Worn outlets or receptacles should be replaced prior to further use of the heater. Plugging the heater into a worn outlet/receptacle may result in overheating of the power cord or fire.

**16.** The output of this heater may vary and its temperature may become hot enough to burn exposed skin. Use this heater with extreme caution if near persons with a high sensitivity to heat or an inability to react to avoid burns.

**17.** Make sure the heater is on a stable, secure surface to eliminate the potential of tipping it over.

**18.** Make sure no pieces of polystyrene or other packaging material have been left between elements of the appliance. It may be necessary to pass over the appliance with a vacuum cleaner.

**19.** Do not attempt to modify or repair the product yourself. Doing so could void the warranty and cause damage or personal injury. Only a repair technician may disassemble or repair this product.

**20.** Choking hazard – This remote control unit contains a small battery. Keep the remote control away from children and do not swallow the

battery. If the battery is swallowed, seek medical advice at once.

**21.** If the machine is not working as intended, has received a sharp blow, has been damaged, left outdoors, or dropped into water, do not use it and contact Customer Support.

## Package Contents

1. Green Lion HEATER LITE Fan and Heater
2. Remote Control
3. Manual

## Product Diagram



## Specifications

Model No	GHT1500
Material	ABS
Rated Voltage	220–240V
Rated Frequency	50Hz
Rated Power	1500W
Air Speed	1.4m/s
Heating Coverage	10m <sup>2</sup>
Timer Function	1–12H
Mode	3 Settings (Fan, High Heat, Low Heat)
Noise Level	<56dB
Power Plug	3-Pin UK Plug
Gross Weight	1.4kg
Product Dimension	150 × 150 × 325mm



## Mode Setting

This product features three working modes: Fan Mode, Low Heating, and High Heating. You can switch between these modes based on your preference. Use the M button (Mode button) to select your desired mode and customize the device to suit your needs.

## Control Panel Diagram

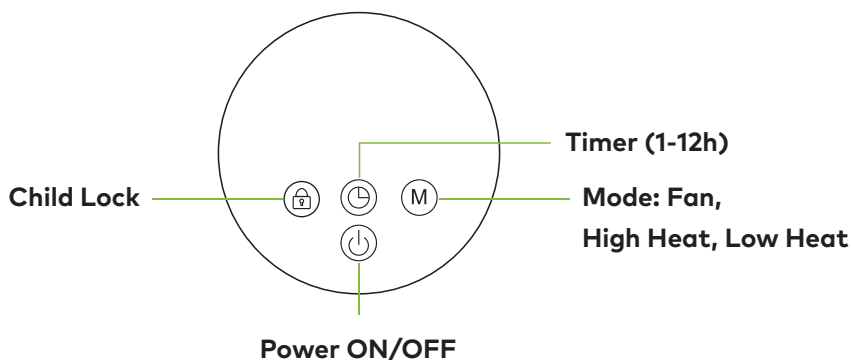

## Remote Control Guide



When using the remote control, align the transmitting sensor on the front of the remote with the receiving sensor on the device's display screen.

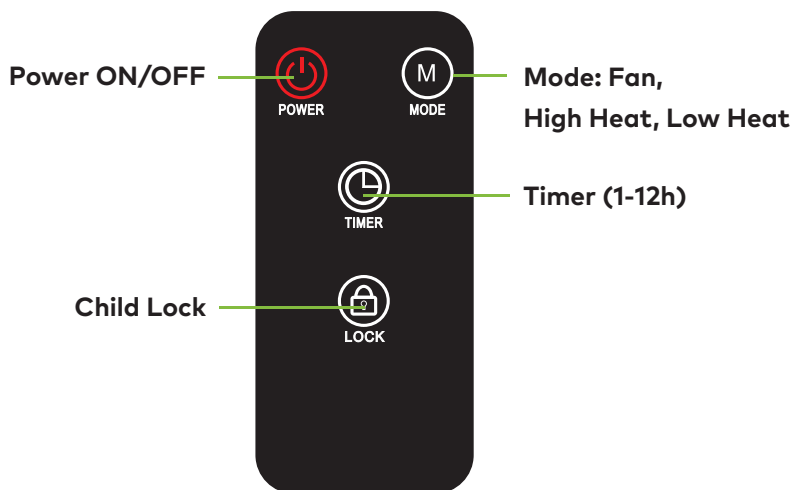

1. The maximum effective range of the remote control is approximately 5 meters, with a detectable angle of about 30 degrees to the left and right.
2. Avoid direct sunlight from hitting the receiving sensor, as it may interfere with the signal reception.

3. Before using the remote control, remove the protective plastic sticker from the bottom of the device to ensure proper functionality.



## Button Function Guide

	Power On/Off: Touch to turn the heater on or off. When the heater is plugged into the power outlet, the power indicator (  ) will light up in red. Once turned off, a 30-second countdown will appear on the display, as the fan continues to run for 30 seconds to dissipate the remaining heat.
	Child Lock: Touch to activate or deactivate the child lock.

	<p>Auto-Off Timer: When the heater is on, touch to set a timer (0-12 hours). After the timer expires, the heater will automatically turn off. To cancel the timer, set it to 0 hours.</p>
	<p>Mode Settings: Touch to cycle through modes that are Fan, High Heat, and Low Heat.</p>

## Display Screen Description

1. Insert the power plug into the outlet; the display will light up.



2. Press the Power ON/OFF button to start the heater.



3. Press the Mode button to select the low heating level.



4. Press the Mode button again to select the high heating level.



5. Press the Mode button again to select the natural wind mode.



6. Press the Timer button to set the automatic shutdown timer for 1–12 hours.



7. Press the Lock button (🔒) to activate or deactivate the child lock function.



## Screen Timeout:

The LED screen will automatically turn off after 3 minutes of inactivity. It can be reactivated by pressing any button.

## Safety Features

### 1. Tip-over Protection

If the unit tilts forward or backward, the built-in automatic power-off function will be triggered. To ensure safe operation, always use the product on a flat, level surface. If the unit tips over, simply return it to a flat surface, press the Power ON/OFF button, and readjust the settings to your preferences.

### 2. Overheating Protection

When the heating element reaches a critical temperature, the overheating protection feature will automatically activate to reduce the temperature and prevent any potential damage.

## Battery Replacement

1. Press the locking button to release the battery holder.
  2. Replace with the same battery type, ensuring the (+) side is facing up.
  3. Push the holder back into place until it is securely locked.
- Note:** If the indicator on the remote control no longer turns on, please replace the battery.

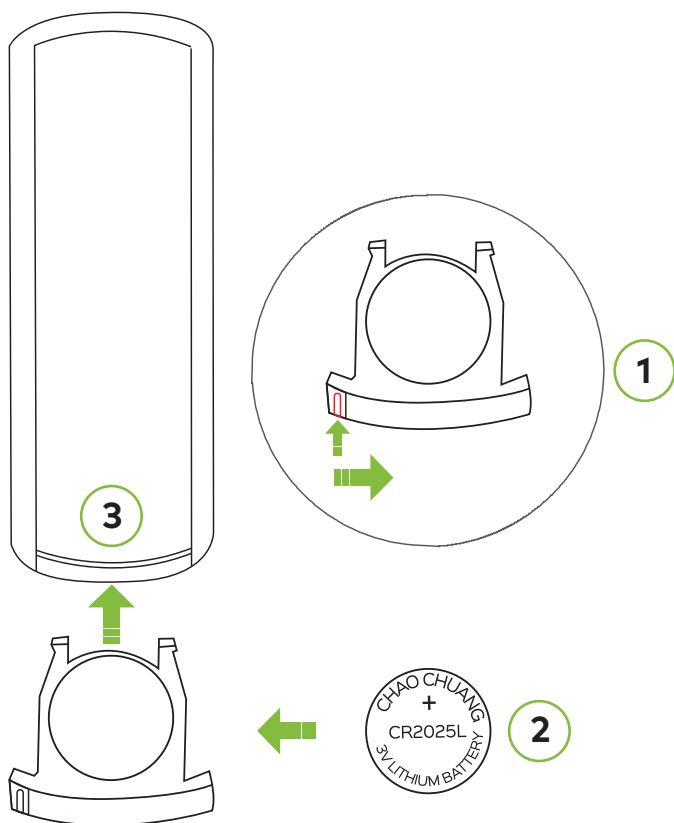

## **Warning**

1. Chemical Burn Hazard. Keep batteries away from children.
2. This product contains a lithium button/coin cell battery. If a new or used lithium button/coin cell battery is swallowed or comes into contact with the body, it can cause severe internal burns and may lead to death within 2 hours.
3. Always ensure the battery compartment is securely closed. If it does not close properly, discontinue use, remove the battery, and keep it away from children.
4. If you suspect that batteries have been swallowed or inserted into any part of the body, seek immediate medical attention.
5. Properly dispose of batteries and keep them away from children. Even used batteries can cause injury.

## **Cleaning and Maintenance**

We recommend cleaning the heater at least once during the operating season and before storing it for the off-season to ensure optimal performance.

1. Always disconnect the heater from the power source by turning it off and unplugging it before cleaning.
2. Use a soft cloth to gently wipe the outer surfaces of the heater.
3. Do not use any cleaning agents or detergents.
4. Never immerse the heater in water, and be careful not to let water drip into the motor housing, heating element, or switches.
5. For storage, cover the heater to protect it from dust. Store it in a cool, dry location, away from areas with high foot traffic to prevent tripping or damage.

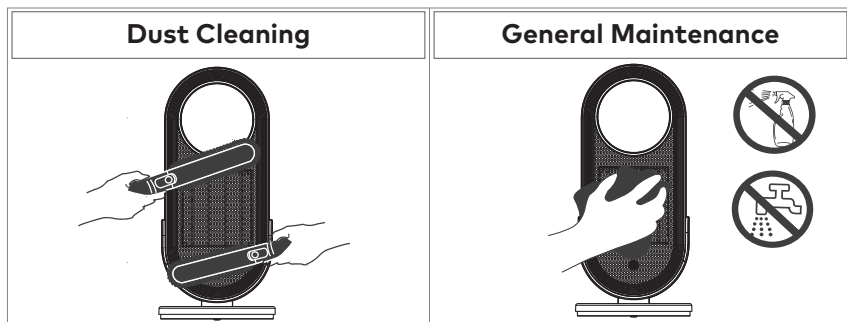

### Caution

- a.** Do not allow water to enter the interior of the heater, as this could result in a fire or electric shock hazard.
- b.** Any servicing should only be performed by an authorized service representative.
- c.** Except for cleaning, any maintenance or repairs must be carried out by an authorized professional.
- d.** Carefully fold the power supply cord, tie it with a cord, and store the heater in its packing box. Keep it in a cabinet away from heat or wet locations.



Problem	Possible Causes	Solution
Malfunction codes appear on the LED display.	E3: Tip-Over Protection.	Place the heater back on a flat, level, and stable surface.
The heater does not start.	The power cord is not properly plugged in.	Connect the plug to a powered electrical outlet.
	Overheat protection has been activated.	Unplug the heater and allow it to cool.
		Remove any objects on or near the heater.
	No power is passing through the unit.	Ensure that your circuit breaker or fuse is working properly.
		Ensure that your heater is placed on a flat and even surface.
	The set temperature is lower than the ambient temperature.	Ensure that the temperature is set to be higher than the ambient temperature.
The set temperature is lower than the ambient temperature.	The temperature exceeds the threshold of the thermal cutoff.	Turn off and unplug the unit. Allow it to cool and plug it into the electrical outlet again.
	The heater is tipped over.	Place it on a flat, level, and stable surface.
	In ECO mode, the heater will turn off automatically when the set temperature has been reached.	This is normal. If your heater turns off frequently, please raise the set temperature or switch to Power Heat mode.



## Disposal

This product must not be disposed of as unsorted household waste. It is important to separate such waste for proper treatment and recycling, in compliance with local waste management regulations.

## Warranty

Products that you buy directly from our **Green Lion** website or shop come with a 24-month warranty.

When you buy **Green Lion** products from any of our approved sellers, you only get a 12-month warranty. If you want to extend this warranty, go to our website at <https://www.greenlion.net/warranty> and fill out the form with your information. Don't forget to upload a picture of the product too. After we've checked and accepted your request, we'll send you an email to confirm that your product's warranty has been extended.

For more info, please check:  
<https://www.greenlion.net/warranty>

## Contact Us

If you have any questions about this Privacy Policy, please contact us at:  
Website: <https://www.greenlion.net/>

Sales: [sales@greenlion.net](mailto:sales@greenlion.net)

Service Support: [Support@greenlion.net](mailto:Support@greenlion.net)

Telegram: [@greenlion\\_global](https://t.me/greenlion_global)

Instagram: [@greenlion\\_global](https://www.instagram.com/greenlion_global)