

PORODO



Porodo

LUMACAST

Smart Full HD Projector

SKU: PDPR2236

Table of Contents

Product Overview	2
Specifications	2
Important Notes	3
Trapezoidal Adjustment	4
Schematic View	6
Power Control	8
Focus Adjustment	8
Bluetooth Connection Guide	9
Projector Settings and Features	10
Safety Instructions	15
Karaoke & Lighting Function	15
FCC Statement	16
Disposal	17
Warranty	17
Contact Us	17

Product Overview

The PORODO LUMACAST Smart Full HD Projector delivers a 1080p Full HD resolution with a 200" ultra-wide screen for immersive viewing. With 230 ANSI lumens brightness, it ensures clear images in various lighting conditions. The projector supports wireless screen mirroring for Android and iOS devices and features auto focus and keystone correction for optimal clarity. Powered by Android 13, it provides a smart interface for seamless performance.

Specifications

Input Voltage	100-240V
Rated Frequency	50/60Hz
Light Source Life	30,000 Hours
Bluetooth Version	5.4
Brightness	230ANSI
Resolution	1080 × 920 Full HD
LCD Panel Size	3"
Operating System	Android 13

Internal Storage	1GB RAM + 8GB ROM
Speaker	10W, 4Ω
Contrast Ratio	1200:1
Aspect Ratio	4:3 / 16:9
Interface	HDMI ×1, USB-A ×1 , 3.5mm ×1 Earphone
Wi-Fi	2.4GHz & 5GHz
Projection Image Size	30" - 200"
Projection Distance	1.4m-5m
Net Weight	1.3kg
Model Number	PDPR2236

Important Notes

- Please read this manual carefully before use and keep it for future reference.
1. The projector is not dustproof or waterproof.
 2. To reduce the risk of fire and electric shock, do not expose the projector to rain or fog.
 3. Use only the original power adapter. The projector should operate under the specified rated power supply.

4. When the projector is in use, avoid looking directly into the lens as the strong light may cause slight eye discomfort. Children should use the projector under adult supervision.
5. Do not cover the projector's vents, as overheating can shorten its lifespan and cause potential hazards.
6. Regularly clean the projector vents to avoid dust buildup, which may cause malfunction.
7. Do not use the projector in greasy, damp, dusty, or smoky environments. Oil or chemicals may cause malfunction.
8. Handle the projector with care during daily use.
9. If the projector is not used for an extended period, please turn off the power.
10. Non-professionals should not dismantle, test, or repair the projector.

Trapezoidal Adjustment

1. Make sure the machine angle is $\geq 15^\circ$ before using the autofocus and trapezoid functions.
2. If the trapezoid effect is not correct, follow the on-screen instructions. Press the OK button on the remote to adjust the corners. Use F+ or F- to improve the clarity.



3. For optimal results, keep the horizontal left/right/pitch angle within 20°. If the angle exceeds this range, a pop-up prompt will appear. Press the "OK" key to enter manual trapezoidal correction mode.



Press down OK button to have slightly manual adjustment.



Press down OK button to have slightly manual adjustment.

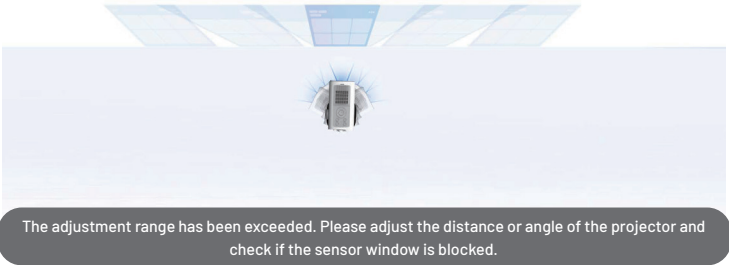

Press down OK button to have slightly manual adjustment.

4. In manual trapezoidal mode, use the directional keys to adjust the screen angle. Press the "OK" key to confirm each corner position.

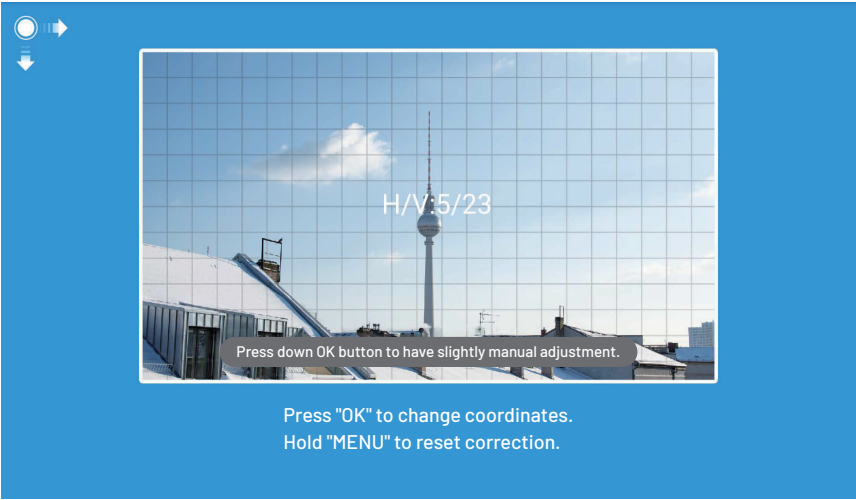

Schematic View

a. Back View

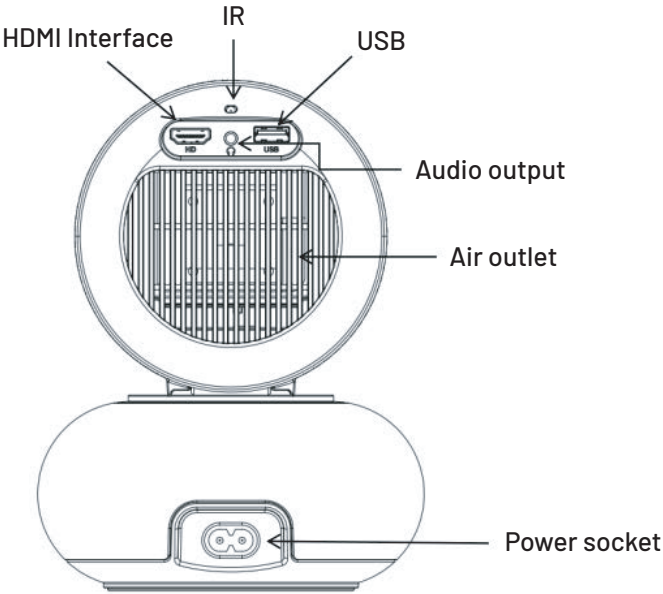

b. Front View

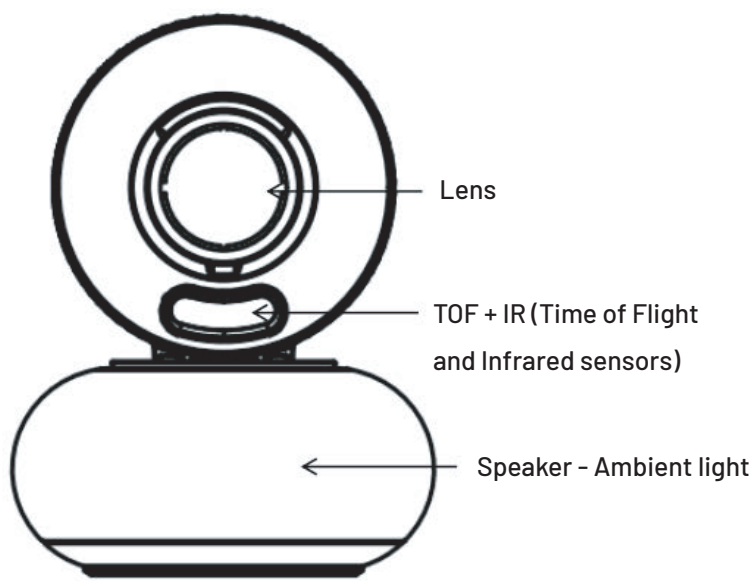

c. Remote Control Buttons

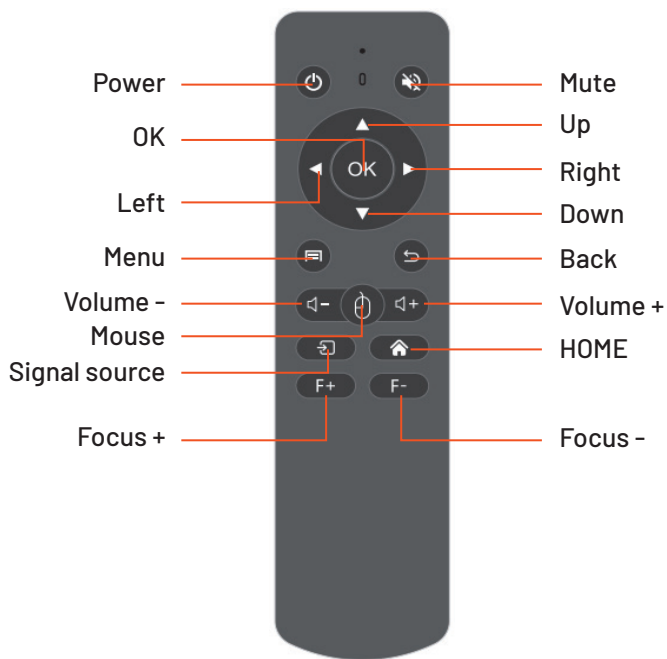

Power Control

1. **Power On:** Press and hold the Power button on the projector for 3 seconds to turn it on.
2. **Power Off:** When the projector is on, press and hold the Power button on either the projector or the remote control for 3 seconds to turn it off.

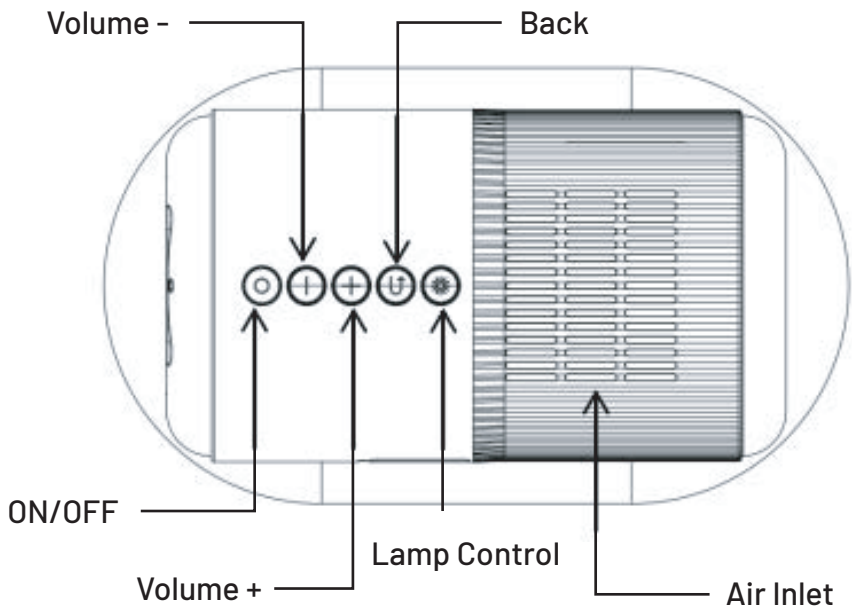

Focus Adjustment

When the projector is powered on, adjusting its position or angle will automatically activate the trapezoid and focus functions. Alternatively, the focus button on the remote control can be used to manually adjust the lens to ensure a clear image on the screen.

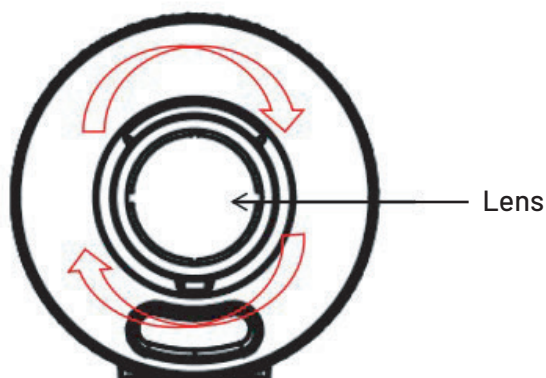

Bluetooth Connection Guide

1. Press and hold both buttons until the indicator lights flash and Bluetooth turns on.
2. The Bluetooth options will search for the device. Select it, and pairing will be complete.

Note: The Bluetooth name may vary for each projector. You can find the specific Bluetooth name in the settings menu.



Bluetooth Connect

Press and hold the button as shown in the figure to enter pairing mode, and wait for the connection to complete.

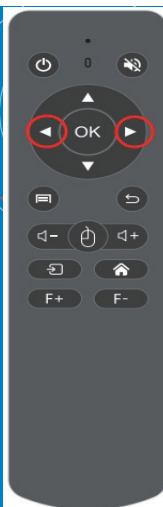

Projector Settings and Features

1. Launcher UI

Note: Enter the setting of two displays, please refer to the actual display.

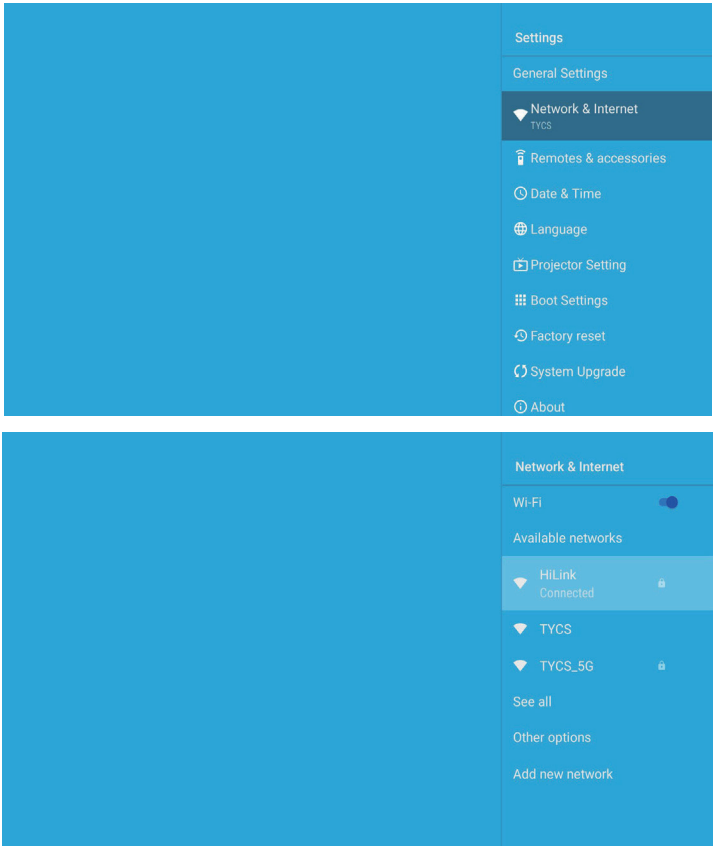

2. Language Settings

Setting – System Settings – OSD Lang > To choose your language.

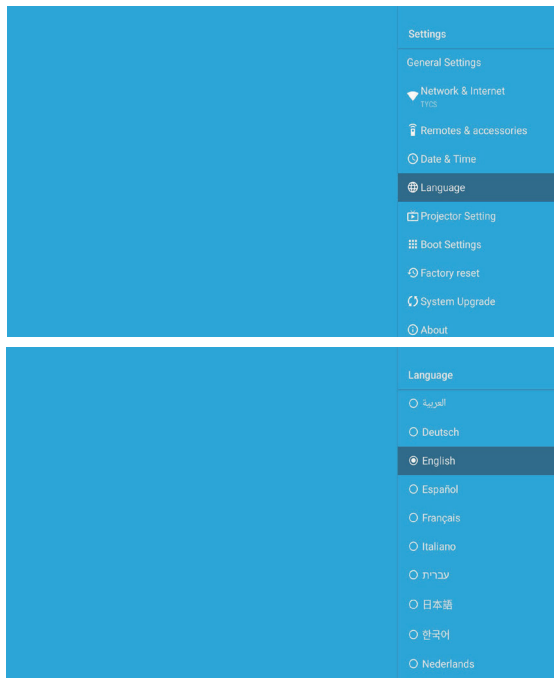

3. Main Background Setting

To select the desired main background, please navigate to the upper right corner of the interface.



4. Projector Mode

To select the appropriate mode for your application scenario, go to Setting – System Settings – Flip. Four modes are available:

- 1. Front Table
- 2. Front Ceiling
- 3. Back Table
- 4. Back Ceiling

The auto focus and trapezoidal functions can be enabled or disabled as needed.

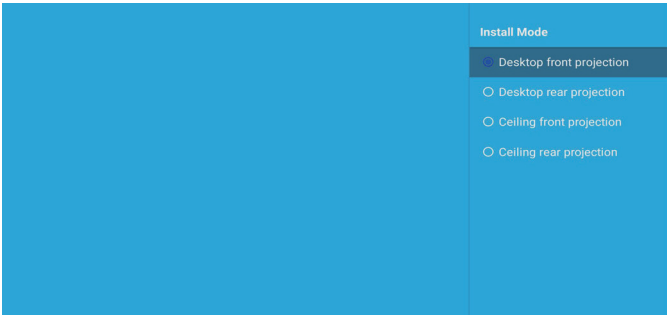

4. Media Player

Insert the USB disk and click the USB icon on the homepage to access and read local videos, music, photos, and books.

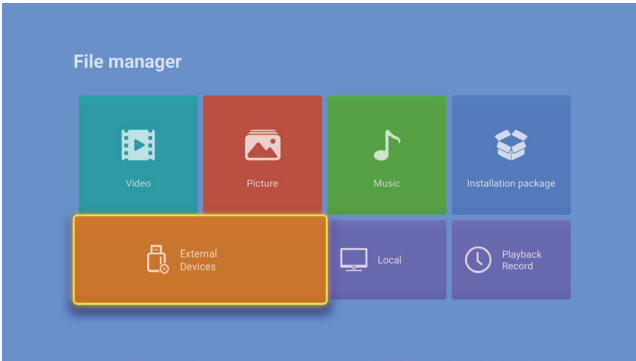

6. HDMI Signal

Connect the projector to an external sourcing device using an HDMI cable. Select HDMI from the homepage, and the signal from the external device will be transmitted to the projector for display.

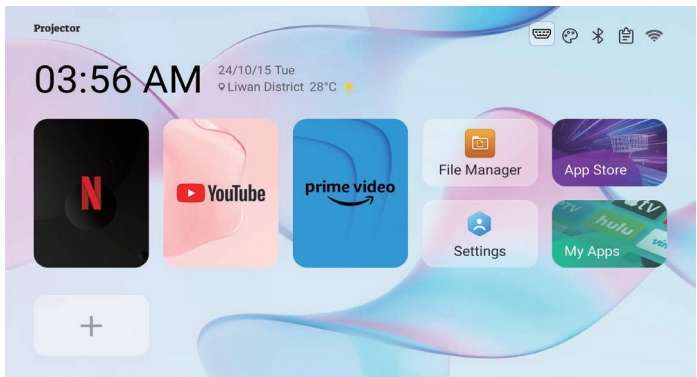

7. Screen Mirroring Setup

7.1. iOS System

- a. Connect the projector device and the mobile phone to the same network.
- b. Slide down on the phone to open the control center and click the screen mirroring button (for iPhone series, slide up to open the control center).
- c. Select the device name to display on the same screen and start the mirroring.

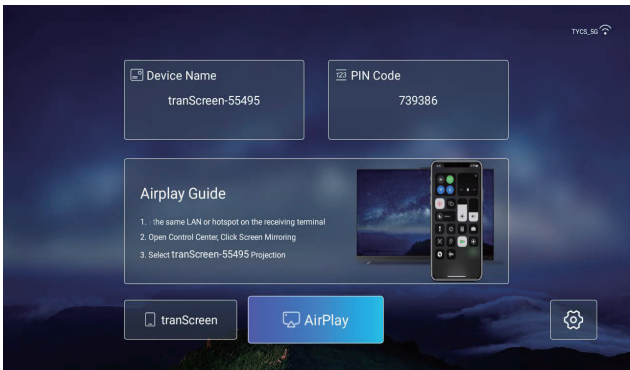

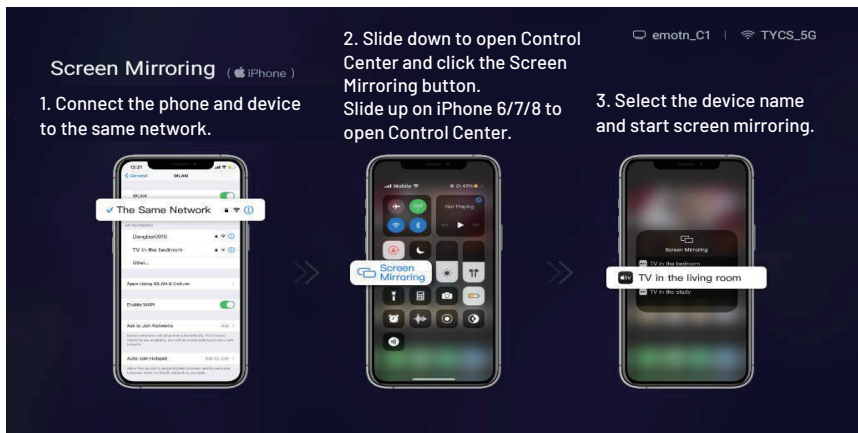

7.2. Android Screen Projection

1. Connect the projection device and the mobile phone to the same network.
2. Open the screen mirroring interface on your phone and click on the word "Android_****".
3. Select the device name to complete the screen projection.

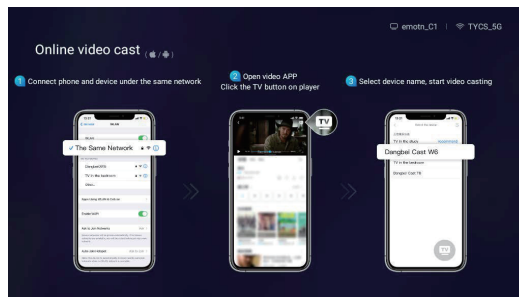
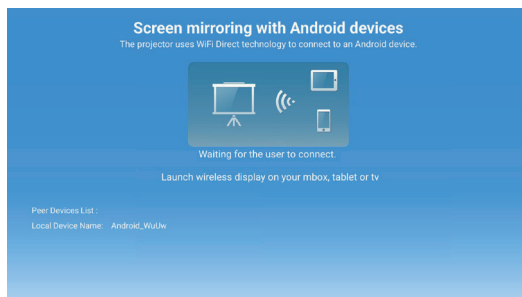

Safety Instructions

- a.** Please read the following important information carefully to ensure safe operation and maintenance of the projector. Following these instructions will help extend the projector's lifespan.
- b.** For installation and repair, consult qualified personnel. Do not use damaged cables, accessories, or peripherals.
- c.** Keep the projector away from flammable or explosive materials and strong electromagnetic sources (such as radar stations, power stations, and substations). Avoid strong ambient light and direct sunlight.
- d.** Do not block the projector's ventilation.
- e.** Always use the original power adapter.
- f.** Ensure proper ventilation and keep vents clear to prevent overheating.
- g.** When the projector is in use, avoid looking directly into the lens as the strong light may cause discomfort.
- h.** Do not bend or drag the power cord.
- i.** Never place the power cord under the projector or heavy objects.
- j.** Do not cover the power cord with other materials.
- k.** Do not heat the power cord.
- l.** Avoid touching the power adapter with wet hands.

Attention:

Do not look directly into the lens while projecting, as the strong light may harm your eyes. Children should use the projector under adult supervision.

Karaoke & Lighting Function

This product supports karaoke, and the following methods are available:

- 1.** The machine includes a built-in karaoke app for singing.
- 2.** The karaoke function can be used on the same screen as your phone.

3. It can be connected to a Bluetooth speaker to enable the karaoke function. Additionally, the product features colorful lights.

FCC Statement

1. This device complies with Part 15 of the FCC Rules. Operation is subject to the following two conditions:

(1) This device may not cause harmful interference; and

(2) This device must accept any interference received, including interference that may cause undesired operation.

2. Changes or modifications not expressly approved by the party responsible for compliance could void the user's authority to operate the equipment.

Note: This equipment has been tested and found to comply with the limits for a Class B digital device, pursuant to Part 15 of the FCC Rules. These limits are designed to provide reasonable protection against harmful interference in a residential installation.

This equipment generates and can radiate radio frequency energy, and if not installed and used in accordance with the instructions, may cause harmful interference to radio communications. However, there is no guarantee that interference will not occur in a particular installation. If this equipment does cause harmful interference to radio or television reception, which can be determined by turning the equipment off and on, the user is encouraged to try to correct the interference by one or more of the following measures:

Reorient or relocate the receiving antenna.

Increase the separation between the equipment and receiver.

Connect the equipment to an outlet on a circuit different from that to which the receiver is connected.

Consult the dealer or an experienced radio/TV technician for assistance.

RF warning statement:

The device has been evaluated to meet general RF exposure requirements.

The device can be used in portable exposure conditions without restriction.

Disposal

This product must not be disposed of as unsorted household waste. It is important to separate such waste for proper treatment and recycling, in compliance with local waste management regulations.

Warranty

Products that you buy directly from our **Porodo** website or shop come with a 24-month warranty.

When you buy **Porodo** products from any of our approved sellers, you only get a 12-month warranty. If you want to extend this warranty, go to our website at [**https://www.porodo.net/warranty**](https://www.porodo.net/warranty) and fill out the form with your information. Don't forget to upload a picture of the product too. After we've checked and accepted your request, we'll send you an email to confirm that your product's warranty has been extended.

For more info, please check:

[**https://www.porodo.net/warranty**](https://www.porodo.net/warranty)

Contact Us

If you have any questions about this Privacy Policy, please contact us at:

[**info@porodo.net**](mailto:info@porodo.net)

Website: [**https://www.porodo.net/**](https://www.porodo.net/)

Service Support: [**support@porodo.net**](mailto:support@porodo.net)

Instagram: **porodo**