

PORODO
LIFESTYLE



Porodo Lifestyle
CORDLESS
Turbo Air Duster

SKU: PDTBYMG826BK



Table of Contents

Product Overview	2
Specifications	2
Safety Precautions	3
Product Design	4
Package Contents	4
Installing the Air Nozzle	5
Switch Operation Instructions	5
Maintenance Guide	6
Indicator Lights	6
Troubleshoot Guide	7
Battery Removal and Disposal	7
Warranty	8
Contact Us	8

Product Overview

The Porodo Cordless Turbo Air Duster is a high-performance cleaning tool designed for versatility and convenience. Featuring a powerful 160W motor, it delivers an impressive airflow of 130,000 RPM, making it perfect for cleaning delicate electronics and hard-to-reach areas. The air duster is equipped with three-speed airflow settings to suit different cleaning needs, and it includes a digital battery display that provides real-time information on its charge. Additionally, the built-in LED work light ensures visibility when cleaning in dark spaces, while the long standby mode helps extend battery life. Its cordless design offers freedom of movement, making it an ideal tool for both home and office use.

Specifications

Input	5V/2A
Rated Power	160W
Blowing Force	200g Max
Motor Speed	130000RPM
Air Speed	16m/s~26m/s
Speed Levels	3 (Low / Medium / High)
Noise Level	80dB

Battery Capacity	2 x 3000mAh
Working Time	8Min (High), 30Min (Low)
Standby Time	Up to 180 Days
Charging Interface	USB-C
Model Number	PDTBYMG826

Safety Instructions

1. Do not use this product with wet hands.
2. Avoid using this product in environments with splashing or immersion in water.
3. Ensure the air outlet or air inlet is not blocked during use.
4. Do not insert foreign objects into the air outlet or air inlet.
5. Keep the product away from heat sources, such as stoves.
6. Do not use this product near gas stations, petroleum gas, or other flammable products like paint thinner, volatile agents, or sprays, as they may cause an explosion or fire.
7. Handle the product with care to avoid dropping or colliding. If it malfunctions, contact after-sales service immediately.
8. Do not forcefully pull, twist, squeeze, or modify the charging cable. If the cable becomes unusually heated or damaged, stop using it immediately.
9. If the product emits an abnormal odor, produces noise, or if the blades do not rotate normally, stop using it and contact after-sales service.
10. Do not disassemble the product.

Product Design

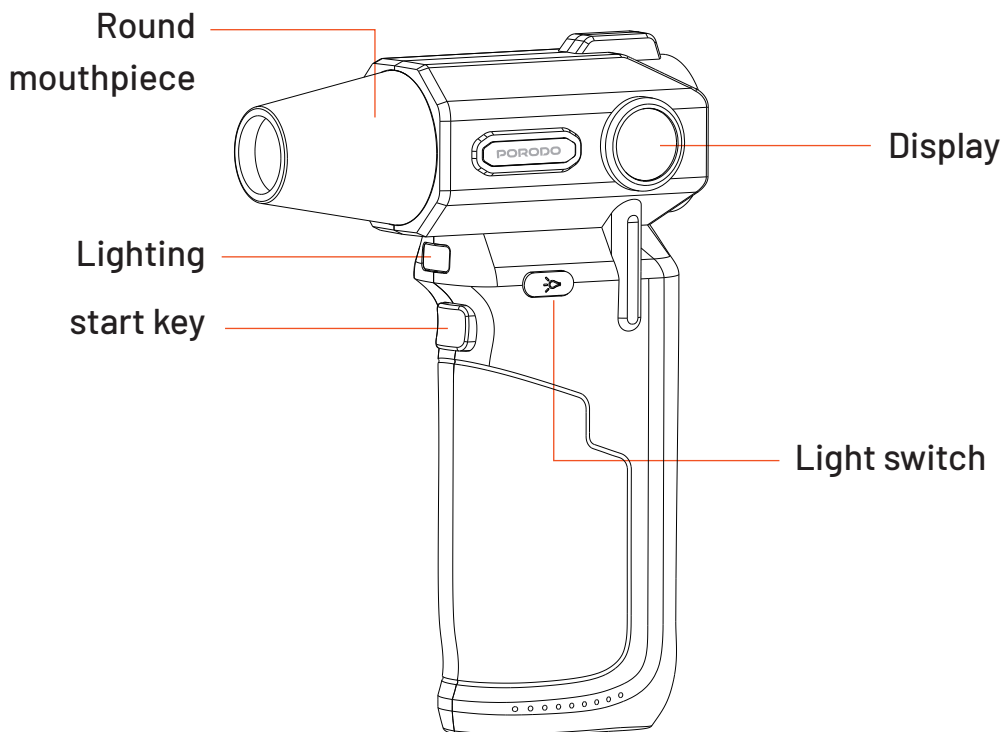

Package Contents

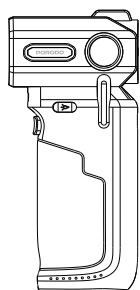

Air duster x1

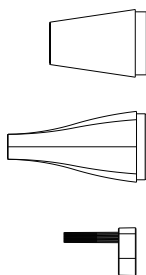

Nozzles x3

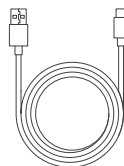

Type-C Charging
Cable x1

Installing the Air Nozzle

Align the air nozzle with the empty space and insert it in the direction shown in the picture.

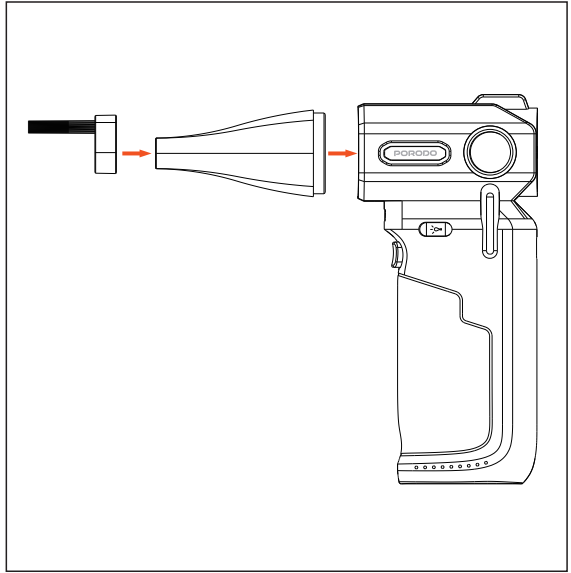
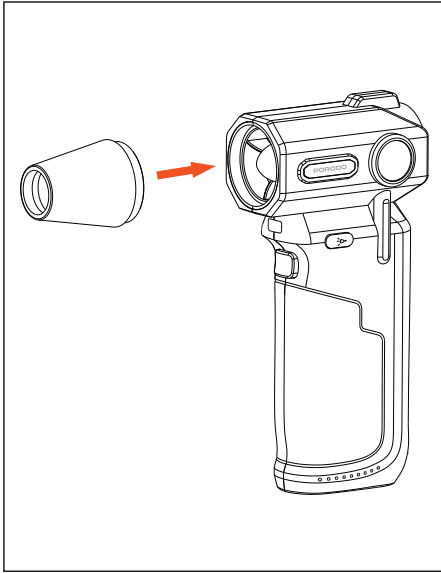

Switch Operation Instructions

1. Starting the device:

- a.** Long-press A button to turn on the device. The initial setting will be low gear.
- b.** To increase the gear, short-press A button again for medium gear.
- c.** Press A button again to switch to high gear.
- d.** To turn off the device, long-press A button in any gear.

2. Turning on the light:

Press B button to turn the light on.

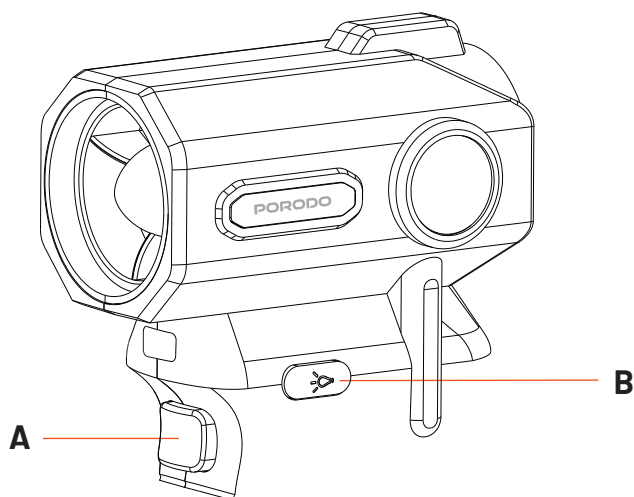

Maintenance Guide

1. This product is not waterproof. Do not clean with liquids such as alcohol, nail polish remover, or detergent. Use a clean, soft cloth for cleaning.
2. Regularly remove any attachments from the air outlet and air inlet.
3. Avoid pressing or rubbing the air inlet and air outlet with fingernails or sharp objects.
4. Do not overcharge the battery, as it may cause damage to the battery cell.

Indicator Lights

Constantly lit	Working status / Charging complete
Flashing	Low battery / About to shutdown / Needs recharge
Blinks slowly	Charging state

Troubleshoot Guide

1.

Problem: Device is not working?

Solution: Ensure that the battery is charged, as it may be low.

2.

Problem: The Light Does Not Shine

Solution: Check if the adapter is properly plugged into the power outlet, and confirm that the power charging cable is securely connected to the machine's Type-C port.

Battery Removal and Disposal

1. Battery Removal Steps:

- a.** Use professional tools to remove the switch cover.
- b.** Disconnect the battery lead terminal from the motherboard.
- c.** Use professional iron scissors to cut the case and safely remove the battery.

2. Battery Disposal

- a.** The batteries used in this product are recyclable and renewable.
- b.** When disposing of the battery, ensure it is handed over to a certified battery collector for proper recycling.
- c.** Before discarding the battery, disconnect it from the product and remove it from any power source.
- d.** Dispose of the battery safely.

Warranty

Products that you buy directly from our **Porodo** website or shop come with a 24-month warranty.

When you buy **Porodo** products from any of our approved sellers, you only get a 12-month warranty. If you want to extend this warranty, go to our website at **porodo.net/warranty** and fill out the form with your information. Don't forget to upload a picture of the product too. After we've checked and accepted your request, we'll send you an email to confirm that your product's warranty has been extended.

For more info, please check:
porodo.net/warranty

Contact Us

If you have any questions about this Privacy Policy, please contact us at:

info@porodo.net

Website: **porodo.net**

Service Support: **support@porodo.net**

Instagram: **porodo**