

# PORODO



## Porodo

### CHROME VOLT 10000mAh Power Bank

SKU: PDPBFCH088BK

# **Table of Contents**

Product Overview	2
Specifications	2
Product Features	3
Display Functions	3
Product Design	4
Recharging Instructions	4
Safety Precautions	5
Hazardous Substances Declaration	6
Troubleshooting	7
Disposal	9
Warranty	9
Contact Us	9

## Product Overview

The Porodo Chrome Volt 10000mAh Power Bank is designed for fast, efficient, and convenient charging on the go. Featuring a sleek and compact design, it comes equipped with an LED digital display that shows the current charge level, making it easy to monitor power at a glance. With both USB-C and Lightning ports offering 35W fast charging, it supports simultaneous charging for multiple devices. The power bank also supports Qualcomm Quick Charge (QC) 22.5W and PD 35W, ensuring rapid charging for your devices. Its lightweight construction and efficient design make it the perfect companion for anyone who needs reliable power throughout the day.

## Specifications

Battery Capacity	10000mAh
USB-C Input	5V/3A, 9V/3A, 12V/2.92A, 15V/2.33A, 20V/1.57A, 35W Max
Lightning Input	5V/3A, 9V/3A, 12V/2.92A, 15V/2.33A, 20V/1.57A, 35W Max
USB-C Output	5V/3A, 9V/3A, 12V/2.92A, 15V/2.33A, 20V/1.57A, 35W Max
Lightning Output	5V/3A, 9V/3A, 12V/2.92A, 15V/2.33A, 20V/1.57A, 35W Max
USB-A Output	5V/3A, 9V/2A, 10V/2.25A, 12V/1.5A, 22.5W Max
Total Output	5V/3A, 15W Max

Product Weight	180g
Model Number	PDPBFCH088

## Safety Precautions

- 1. High Capacity: 10000 mAh capacity to charge your devices multiple times throughout the day.
- 2. Fast Charging: Features USB-C and Lightning ports, each delivering up to 35W fast charging for quick power-ups.
- 3. LED Digital Display: Allows you to monitor the remaining battery level at a glance, ensuring you always know when it's time to recharge.
- 4. Simultaneous Charging: Supports charging two devices at once without compromising charging speed or performance.
- 5. Quick Charge (QC 22.5W): Ensures fast charging for compatible devices like smartphones, tablets, and other gadgets.
- 6. PD 35W Output: Delivers rapid and reliable charging for power-hungry devices such as laptops and larger electronics.
- 7. Compact & Lightweight Design: Convenient and portable, perfect for travel and everyday use, fitting easily into your bag or pocket.
- 8. Reliable & Efficient: Engineered for long-lasting performance, making it the ideal charging solution for on-the-go use.

## Display Functions

### 1. Display Powers

The LED digital tube shows the current power level. When the power is turned

off or in low volume mode, the button has no output, and the digital tube turns off.

## 2. LED Status When Discharging the Power Bank

The LED displays the current power level while discharging. In low power mode, the button has no output, and the digital tube turns off.

## Product Design

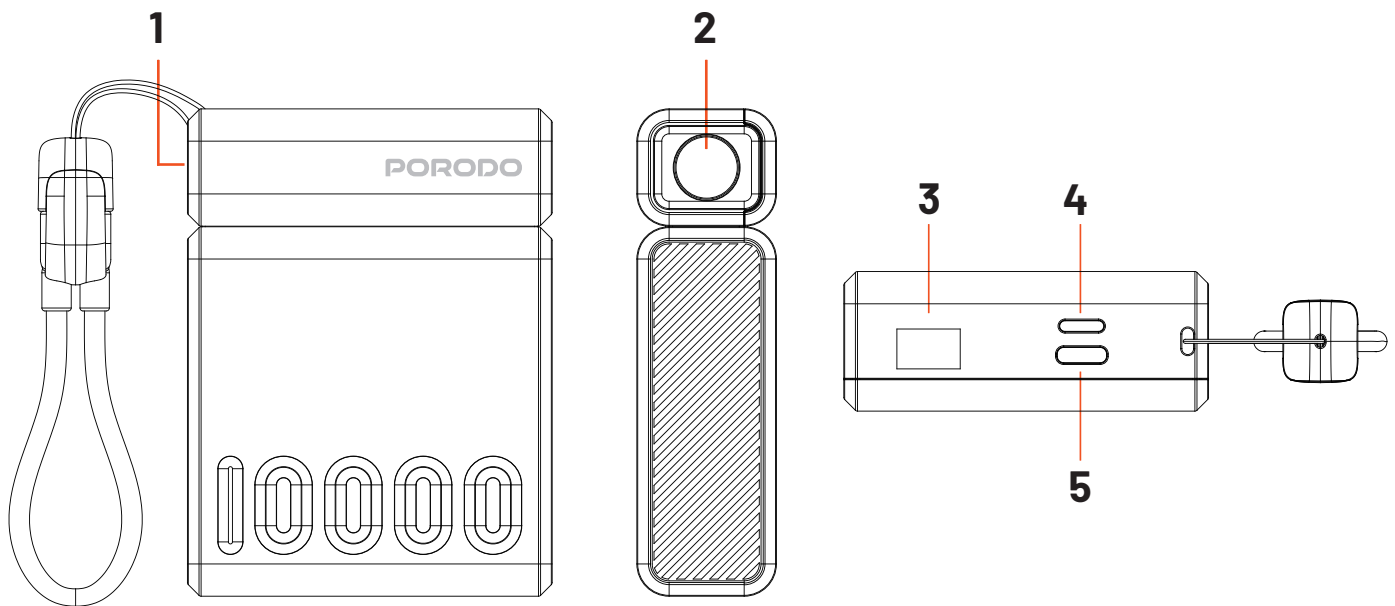

1. USB-A Output

2. Switch Button

3. Display

4. Lightning Input/Output

5. Type-C Input/Output

## Recharging Instructions

### 1. Charging the Power Bank:

When charging, the digital tube flashes and displays the current power status. Once fully charged, the display shows "100" and the light stays on.

### 2. Charging Other Devices:

While charging other devices, the digital tube shows the current battery percentage.

If the power drops below 0%, the display shows "0%" and flashes at 1Hz to indicate a low battery.

When the battery voltage is lower than 3V, the power bank will automatically turn off.

## Safety Precautions

- 1. Operating Temperature:** The product is designed to work within a temperature range of 0°C – 25°C. It is recommended not to use it in environments exceeding 25°C or below 0°C.
- 2. Water Exposure:** Do not submerge the product in water, and avoid cleaning it with a damp cloth to prevent leakage or malfunction.
- 3. Product Care:** Do not cover the product with paper or other objects that could obstruct heat dissipation and cooling.
- 4. Disassembly:** Do not attempt to disassemble or maintain the product yourself. There are no user-serviceable components.
- 5. Handling:** Avoid dropping, shaking, knocking, or squeezing the product to prevent damage.
- 6. Short-Circuit Prevention:** Ensure the product's terminals are not short-circuited to avoid damage or malfunction.
- 7. Storage and Use:** Keep the product out of the reach of children or pets.
- 8. Charger Use:** Always use the charger that came with the product or one that meets the required specifications. Ensure the charger is fully charged before use.
- 9. Abnormal Conditions:** If you notice any abnormal signs such as odor, heat, discoloration, or deformation, or experience any leakage, immediately unplug the product and stop using it.
- 10. Power Supply Requirements:** When using a power adapter, ensure it meets the necessary CCC certifications and standard requirements. If the battery is not replaceable, avoid attempting to replace it yourself.

**11. Battery Safety:** Batteries must not be exposed to extreme conditions such as direct sunlight, heat, or moisture. Do not immerse in water.

## Hazardous Substances Declaration

When disposing this product, please do not put in together with general household waste. It should be handed over to a recycling center, which is beneficial for environmental protection.

Declaration of Hazardous Substances in Electronic and Electrical Products						
Component Name	Pb	Cd	Hg	CR6+	PBBs	PBDEs
Shell	○	○	○	○	○	○
PCB	×	○	○	○	○	○
Battery	○	○	○	○	×	×
Screw	○	○	○	○	×	×
Metal components	○	○	○	○	--	--
Data line	○	○	○	○	○	○
<p>This table is prepared in accordance with the provisions of SJ/T11364.</p> <p>O: Identify that the content of the toxic and harmful substance in all homogeneous materials of the component is within the limit requirements specified in GB/T 26572.</p> <p>X: The components marked with an X in the table above indicate that the toxic and harmful substance exceeds the limit requirements specified in GB/T 26572 in at least one homogeneous material of the component and cannot be replaced due to technical reasons. However, with technological advancements, replacement or improvement may be possible in the future.</p> <p>—: According to GB/T 26572, metal components are not subject to content requirements for PBBs and PBDEs.</p>						



The Environmental protection of this product under normal use is 5 years.

## Troubleshooting

**1.** Indicators can't display a full charge status after a long time of charging the product.

Reasons:

- a.** Not enough charging time.
- b.** Adapter or product malfunction.

Solutions:

- a.** Charge the product for 12 hours.
- b.** Consult the distributor or after-sales service for assistance.

**2.** The remaining power of the product cannot be detected.

Reasons:

- a.** No remaining power.
- b.** Power button or indicator malfunction.
- c.** Power failure of the product.

Solutions:

- a.** Charge the product again.
- b.** Consult the distributor or after-sales service for assistance.
- 3.** The product cannot charge other devices.

Reasons:

- a.** Low power of the product.
- b.** No power transmission in the USB cable or the adapter.
- c.** Improper choice of adapters.
- d.** The power management system of the product prohibits charging the device.



Solutions:

- a.** Charge the product again.
- b.** Change the USB cable or adapter.
- c.** Look for a proper connector that suits the product's interface.
- d.** Ensure the product is compatible with the device you're charging.
- 4.** The product can charge other devices, but can't fully charge them up.

Reasons:

The battery of the product is used up.

Solutions:

Charge the product.

- 5.** When charging other devices with the remaining power, the product suddenly stops working or fails to display any power.

Reasons:

External short circuit or overload leads to an automatic shutdown for self-protection.

Solutions:

Charge the product to reactivate it.



## Disposal

This product must not be disposed of as unsorted household waste. It is important to separate such waste for proper treatment and recycling, in compliance with local waste management regulations.

## Warranty

Products that you buy directly from our **Porodo** website or shop come with a 24-month warranty.

When you buy **Porodo** products from any of our approved sellers, you only get a 12-month warranty. If you want to extend this warranty, go to our website at **[porodo.net/warranty](https://porodo.net/warranty)** and fill out the form with your information. Don't forget to upload a picture of the product too. After we've checked and accepted your request, we'll send you an email to confirm that your product's warranty has been extended.

For more info, please check:  
**[porodo.net/warranty](https://porodo.net/warranty)**

## Contact Us

If you have any questions about this Privacy Policy, please contact us at:  
**[info@porodo.net](mailto:info@porodo.net)**

Website: **[porodo.net](https://porodo.net)**

Service Support: **[support@porodo.net](mailto:support@porodo.net)**

Instagram: **[porodo](https://www.instagram.com/porodo)**