

**PORODO**  
LIFESTYLE



**Porodo Lifestyle**

**2-IN-1**

**MULTIFUNCTIONAL ELECTRIC SHAVER**

SKU: PDK007



# Table of Contents

Product Overview	2
Specifications	2
Product Components	3
Safety Precautions	4
Usage Instructions	5
Travel Lock	6
Charging	6
Maintenance and Cleaning	6
Troubleshooting	7
FCC Statement	8
Disposal	9
Warranty	10
Contact Us	10

## Product Overview

The Porodo 2-in-1 Multifunctional Electric Shaver with USB-C Charging offers powerful dual-head operation with a motor speed of 5500RPM, delivering efficient and quiet performance. Designed with an ergonomic structure, it provides a comfortable grip and easy handling for a smooth grooming experience. It also features a built-in light function for enhanced visibility and precise trimming. Additionally, the device supports fast USB-C charging, which enables quick and convenient power-ups. With its combination of performance, design, and convenience, this electric shaver is ideal for achieving professional results at home.

## Specifications

Material	ABS
Input	5V/1A
Battery Capacity	200mAh
Working Time	50 Minutes
Recharge Time	30 Minutes
Motor Speed	5500rpm
Charging Interface	USB-C
Product Weight	59g

Product Size	29 x 29 x 130mm
Model Number	PDK007

## Product Components

1. Nose hair cutter protective cap
2. Nose hair cutter head assembly
3. Nose hair cutter drive shaft
4. LED
5. Main body unit
6. Power switch and power indicator
7. Shaver drive shaft
8. Shaver head assembly
9. Shaver head protective cap
10. Type-C charging cable

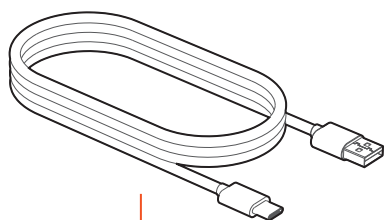

10

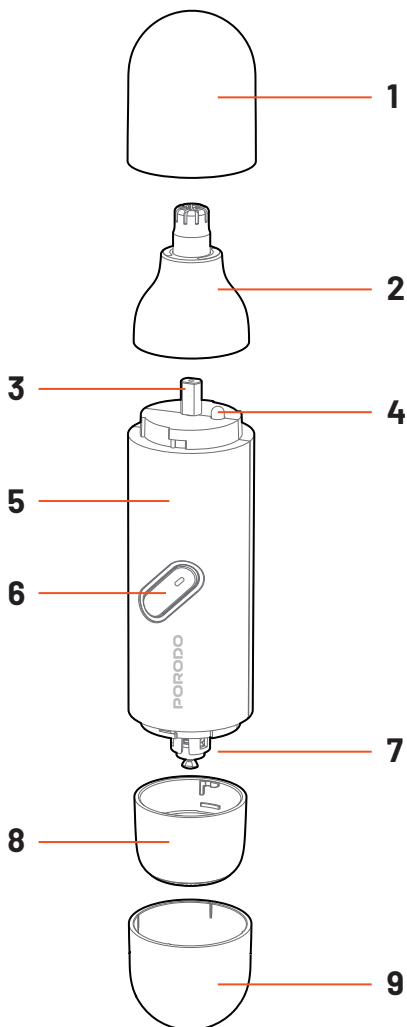

## Safety Precautions

**WARNING:** The cutter head can only be washed with water after being detached from the main body of the device.

1. Keep the USB power cable dry.
2. Before connecting the product, ensure the voltage marked on the power supply matches the product's required voltage. Use only a low-power circuit output adapter that complies with GB 4706.1-2005 standard, with an output voltage not exceeding 5V and an output current not exceeding 1A.
3. Immediately stop using the product if any abnormality or malfunction is detected. Address the issue according to the type of fault, and if necessary, have it repaired by the company's maintenance department.
4. Individuals with physical disabilities, mental impairments, or lack of relevant experience and knowledge (including children) must use the product only under the supervision and guidance of a guardian.
5. Only use the provided USB-C power cable to charge this product. If the USB cable is damaged, it must be discarded.
6. Do not forcefully pull the USB power cable while charging the product.
7. The nose hair cutter head and shaver head are detachable and washable, but do not immerse them in water.
8. Do not clean the nose hair trimmer with salt water, thinner, gasoline, alcohol, or other chemicals.
9. When traveling, always attach the protective cap to the nose hair trimmer to safeguard the cutter head.
10. The nose hair trimmer may become slightly warm during use or charging; this is normal and safe.
11. This nose hair trimmer is designed exclusively for trimming nose and ear hair. Do not attempt to use it for any other purpose.
12. To avoid injury, control the force and depth of use carefully. Do not forcefully push the cutter head into the nostrils or ear canals.
13. Do not charge the nose hair trimmer for extended periods.

14. Charge, use, and store the nose hair trimmer between 5°C and 35°C. Do not store it in direct sunlight or near heat sources.
15. Do not disassemble the cutter head assembly during use or after exposure to hot water.

## Usage Instructions

1. Press the power button to turn the trimmer on, and press again to turn it off (Figure 1).
  2. The nose hair trimmer head features a built-in light function for precise trimming, which can be used with a mirror (Figure 2).
  3. The nose hair trimmer head is designed specifically for trimming nose hair (Figure 3).
  4. The shaver head is used for trimming mustaches (Figure 4).
- WARNING:** Do not use the product if the blade is damaged.

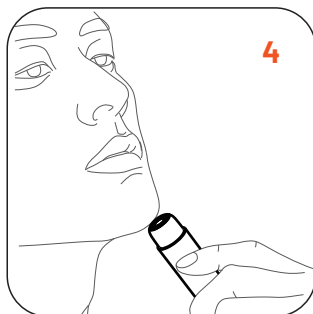
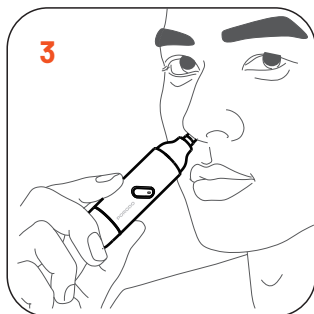
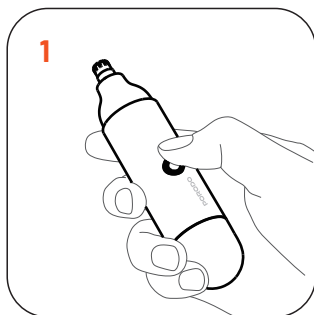

## Travel Lock

1. For first-time use: Press and hold the power button for over 3 seconds to unlock and power on.
2. When unlocked: Press briefly to turn the device on/off.
3. To activate lock mode: Press and hold for more than 3 seconds; the green indicator will flash 3 times to confirm.
4. To unlock: Press and hold for more than 3 seconds to directly unlock and power on.
5. When locked: A brief press causes the indicator to flash 3 times, signaling the lock status.

## Charging

1. Press the power button to turn off the nose hair trimmer.
2. Insert the USB Type-C plug into the trimmer and connect the other end to a power source.
3. Red blinking indicator: Charging in progress.
4. After approximately 1 hour: Solid green light indicates full charge.
5. A fully charged trimmer provides up to 90 minutes of runtime
6. Actual trimming time varies based on trimming habits, maintenance, frequency, and hair type (nose/ear)

## Maintenance and Cleaning

1. Before cleaning, press the power button to turn off the nose hair trimmer.
2. Rotate the cutter head assembly clockwise to remove it.
3. Rinse the cutter head assembly under running water.

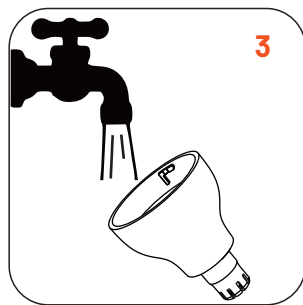
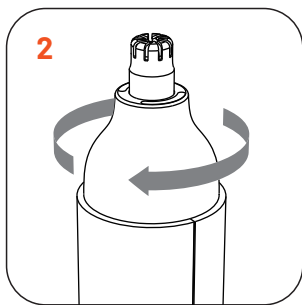

**4.** After the cutter head assembly dries completely, align it with the main body and rotate counterclockwise until a click is heard, indicating secure installation.

**Warning:** The cutter head can only be washed with water after being detached from the main body unit.

## Troubleshooting

### **1.** Charging indicator not lit

Possible Cause: Faulty charging indicator

Solution: Return for after-sales repair

Possible Cause: Low battery (long-term disuse)

Solution: Continue charging; normal function resumes in ~5 minutes

Possible Cause: Charging circuit failure

Solution: Return for after-sales repair

### **2.** Excessive charging time

Possible Cause: Non-original USB cable used

Solution: Use the included USB power cable

Possible Cause: End of battery lifespan

Solution: Return for after-sales repair

Possible Cause: Charging circuit failure

Solution: Return for after-sales repair



### 3. No response when powering on

Possible Cause: Insufficient battery charge

Solution: Connect USB cable for charging/wired operation mode

Possible Cause: Power button failure

Solution: Return for after-sales repair

Possible Cause: Circuit malfunction

Solution: Return for repair; device unusable

### 4. Failure to charge

Possible Cause: Damaged trimmer/USB cable

Solution: Return for after-sales repair

Possible Cause: Charging temperature too low/high

Solution: Charge in ambient temperatures between 5°C–35°C

### 5. Skin allergy after use

Possible Cause: Skin adaptation period required

Solution: Symptoms typically disappear after 2–3 weeks of regular use

## FCC Statement

1. This device complies with Part 15 of the FCC Rules. Operation is subject to the following two conditions:

(1) This device may not cause harmful interference; and

(2) This device must accept any interference received, including interference that may cause undesired operation.

2. Changes or modifications not expressly approved by the party responsible for compliance could void the user's authority to operate the equipment.

**Note:** This equipment has been tested and found to comply with the limits for a Class B digital device, pursuant to Part 15 of the FCC Rules. These limits are designed to provide reasonable protection against harmful interference in a residential installation.

This equipment generates and can radiate radio frequency energy, and if not installed and used in accordance with the instructions, may cause harmful interference to radio communications. However, there is no guarantee that interference will not occur in a particular installation. If this equipment does cause harmful interference to radio or television reception, which can be determined by turning the equipment off and on, the user is encouraged to try to correct the interference by one or more of the following measures:

Reorient or relocate the receiving antenna.

Increase the separation between the equipment and receiver.

Connect the equipment to an outlet on a circuit different from that to which the receiver is connected.

Consult the dealer or an experienced radio/TV technician for assistance.

RF warning statement:

The device has been evaluated to meet general RF exposure requirements.

The device can be used in portable exposure conditions without restriction.

## Disposal

This product must not be disposed of as unsorted household waste. It is important to separate such waste for proper treatment and recycling, in compliance with local waste management regulations.



## **Warranty**

Products that you buy directly from our **Porodo** website or shop come with a 24-month warranty.

When you buy **Porodo** products from any of our approved sellers, you only get a 12-month warranty. If you want to extend this warranty, go to our website at **<https://www.porodo.net/warranty>** and fill out the form with your information. Don't forget to upload a picture of the product too. After we've checked and accepted your request, we'll send you an email to confirm that your product's warranty has been extended.

For more info, please check:  
**<https://www.porodo.net/warranty>**

## **Contact Us**

If you have any questions about this Privacy Policy, please contact us at:  
**[info@porodo.net](mailto:info@porodo.net)**

Website: **<https://www.porodo.net/>**

Service Support: **[support@porodo.net](mailto:support@porodo.net)**

Instagram: **[porodo](#)**