



Green Lion

ULTIMATE GRIND

ELECTRIC COFFEE GRINDER

SKU: GNULCGRNRBK

Model No: GL-CG47

Important Protective Measures

Instructions for Proper Storage

The appliance is for household use only.

During use of the appliance, it is necessary to always follow the basic safety precautions to reduce the risk of fire, electric shock, and/or personal injury, including the following:

1. Please read all instructions before use.

2. Do not immerse the charging cable, plug, or machine in water or other liquids to prevent electric shock. Do not wet the appliance (water splash, etc.), or use the appliance with wet hands.
3. Do not use the appliance after malfunction, falling, or damage in any way. You only need to send the appliance back to the nearest authorized service center for check, repair, or adjustment.
4. Do not place the appliance on or near hot air or electric furnaces, or in heated ovens. Do not let wires come into contact with hot surfaces, including furnaces. Because the protective insulation will burn, the appliance cannot be operated or cannot be operated safely at this time.
5. Do not immerse the electric base in liquids or put it in the dishwasher.
6. Adults should closely supervise when children use the appliance, or the appliance is used near children. Keep an eye on children and prevent them from playing with the appliance. Please keep the appliance and its power cord out of reach of young children.
7. Avoid contact with moving parts. The blade is sharp and rotates at high speed, which may cause injury. Touching the blade can cause injury.
8. Be sure to cover the lid properly when operating the grinder. Do not remove the lid until the blade has completely stopped rotating. Before operating the appliance, make sure that the lid is securely in place to prevent injury or physical harm.
9. Do not attempt to operate the appliance without properly covering the lid.
10. Using accessories not recommended or sold by Hubo may result in fire, electric shock, or injury. Please only use components specifically designed for the appliance at all times.
11. Before use, check whether there are any foreign objects in the coffee bean hopper.
12. Improper use may cause personal injury.
13. When not in use, turn off the switch before installing or removing parts, as well as cleaning; do not touch the start button, otherwise, accidentally starting the appliance may cause serious personal injury.
14. Please be extremely careful when handling sharp cutting blades or during cleaning.
15. Do not use the appliance for unexpected household use.
16. Do not disassemble the appliance under any circumstances. We do not accept warranty claims for damages caused by improper operation.
17. The appliance is not intended for use by individuals (including children) with physical, sensory, or intellectual disabilities or lack of experience and understanding, unless they are supervised or guided by personnel responsible for their safety when using the appliance. The appliance cannot be used by individuals with poor physical and sensory conditions, low intelligence, or lack of experience and understanding, unless they are supervised or obtain the user manual.
18. After continuously grinding one full hopper of coffee beans, please wait for 1 min before grinding the second full hopper of coffee beans. After grinding for a total of 9 min within 15 min, to grind more, please wait for the appliance to cool to room temperature.

Get to Know Your Coffee Grinder

1. Bean hopper cover
2. Bean hopper
3. Main machine
4. Base
5. Powder discharge tube
6. Large handle bracket
7. Powder receiving cup
8. Automatic grinding key
9. Time decrease
10. Digital display screen
11. Time increase
- 12 On/Off

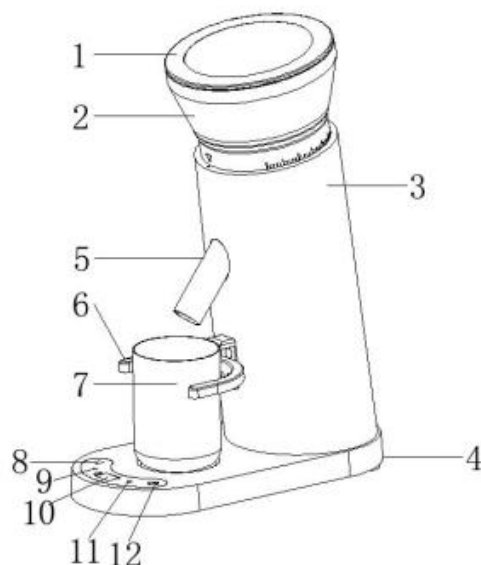

Overview of the Coffee Grinder

This coffee grinder features 60 unique grinding size settings, suitable for a wide range of brewing styles, from the finest espresso to the coarsest French-style pressed coffee settings. By adjusting the time to select the amount of beans ground, you can choose 0-130 g coffee powder according to your needs.

Suggestions for Grinding Size Settings

Types of coffee	French coffee pot	Drip coffee maker/hand-brewed coffee	Espresso
Grinding style	Coarse	Average	Fine
Recommended grinding size	35-60 scale gear	15-35 scale gear	0-15 scale gear
Default maximum grinding time	147 s (7.5 s)	147 s (7.5 s)	147 s (7.5 s)
Optional accessories	Powder hopper/handle bracket		

Note: The coffee bean hopper can hold up to 130 g coffee beans, and the powder hopper can hold up to 60 g coffee powder. Warning: The coffee bean hopper cannot be used to store coffee beans, and the powder hopper cannot be used to store coffee powder. Please empty the coffee beans in the coffee bean hopper and the coffee powder in the powder hopper after grinding. Note: The grinder can only be cleaned with a cleaning brush after use, and all appliances must be completely turned off.

Before the First Use

Before the use of the coffee grinder, wipe the shell and coffee bean hopper with a clean damp cloth. Make sure that the inside is completely dry before use. Clean the powder hopper and its lid in water at a suitable temperature, then rinse and dry. (Please refer to "Cleaning after Grinding Coffee Beans")

Use Your Coffee Grinder

Assembly

1. Install the coffee bean hopper in the correct position of the appliance (as shown in the figure).

Align the unlock icon ○ on the base with the icon ▽ on the coffee bean hopper. Ensure that the positioning nodes on the coffee bean hopper are aligned with the grooves on the main body.



The coffee bean hopper can be rotated when the icons ▽ and ○ on the coffee bean hopper are aligned. Note: The display screen will show an E1 alarm when the bean hopper is not properly installed.

2. Rotate the coffee bean hopper clockwise to lock it in place, and then set the grinding thickness of the coffee.



3. The coffee grinder has 60 optional grinding sizes. According to the type of coffee powder required, rotate the coffee bean hopper clockwise and adjust the scale on the coffee bean hopper to the desired grinding size, from coarse to fine.

4. Open the lid of the coffee bean hopper, fill it with the required whole coffee beans, and then close the lid.



Note: The coffee bean hopper can hold up to 130 g coffee beans. The display screen will show E2 alarm when there are particularly hard beans or foreign objects during the grinding.

5. Use the powder hopper.

Install the powder hopper and its lid in the correct position. Check to ensure that the parts are correctly placed on the main body of the product.

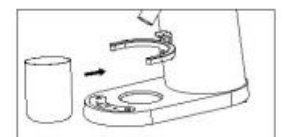

Note: The powder hopper can hold up to 60 g coffee powder.

6. Use the handle:

① Install the handle onto the bracket.

Note: It is normal for the correct amount of coffee powder to appear to overflow from the handle. The volume of un-compacted coffee powder is approximately three times that of compacted coffee powder.

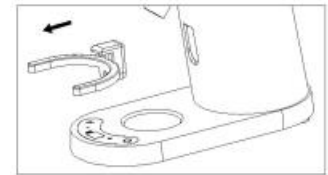
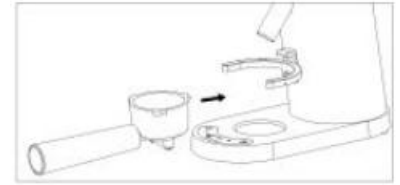

7. Replace the small handle bracket

① Remove the large handle bracket with a hexagon wrench, replace the small handle bracket that has been prepared for replacement, and tighten the screws, at this time, the product can be used normally



Grinder setup and operation

1. Click the switch

Rotate the coffee bean hopper and select grinding sizes from 0 (fine) to 60 (coarse). Please refer to the "Suggestions for Grinding Size Settings".



2. Set the time to the desired grinding amount (click or long press).

Time setting: You can choose from 5 to 98.

When set to 98, the maximum single grinding time is 147 s, and when set to 5, the minimum single grinding time is 7.5 s.

Note: After grinding for a total of 9 min within 15 min, the machine will display E0 and force a 20 min break.



3. The display screen will show an E3 alarm when the motor wire accidentally falls off.

4. When the battery power is consumed to a low level during the grinding, the battery indicator flashes red to indicate charging.

After being fully charged, the white battery indicator will remain on for 3 min before turning off.

Note: When the battery level is too low and the charging cable is not connected, the display screen will show an E2 alarm, reminding that the charging cable is not connected.



5. When the battery accidentally detaches, the display screen will show an E5 alarm, reminding the battery detachment.

Tips: For preset settings, please refer to the "Suggestions for Grinding Size Settings". According to your needs, you may wish to try different grinding sizes and time settings to achieve the desired grinding effect.

Warning: To prevent the motor from overheating, do not grind more than 2 complete coffee bean hoppers continuously. Let the motor cool to room temperature for at least 20 min.

6. Press the grinding button to start the grinding. The appliance will automatically stop when the set time decreases to 0.



7. You can also press any button again at any time during the grinding cycle to stop the grinding at any time.



8. The appliance will be in a screen off state and will not work when the switch button is clicked.



Tips for Using the Coffee Grinder

1. Freshly ground coffee is the key to making coffee more flavorful and palatable (so fresh coffee beans should be used every time for optimal results).
2. Use freshly roasted coffee beans, and coffee beans that have not yet been roasted or have already been roasted on the same day, to maximize the flavor.
3. Use coffee beans within 5 to 20 days after roasting to achieve the best freshness.
4. The flavor and strength of the coffee depends on personal preference. It is best to change the type of coffee beans, the amount of coffee, and the grinding size to get the preferred flavor.
5. Fresh beans yield the best flavor and aroma.
6. To get the freshest and most delicious coffee, simply grind enough for the pot of coffee you are brewing. To brew a large pot, you may need to grind coffee beans in several batches.
7. Continue grinding until the required amount is obtained. After fine grinding, the surface area of the particles in contact with water is larger, so the flavor is extracted more quickly.
8. During the grinding of coarser particles, the surface area of the particles in contact with water is smaller, making it suitable for filters with longer brewing cycles.
9. Important note: You can try different grinding times to get your favorite coffee.
10. Store the coffee beans in a dark, cool, and dry place. If possible, seal them.
11. Purchase whole coffee beans in small batches to reduce their storage time.
12. Once ground, the coffee bean will quickly lose its flavor and aroma. To achieve the best results, grind the coffee beans before brewing.
13. During operation of the appliance, run the grinder until the ground coffee beans left in the chamber are completely emptied.
14. Before each use, run the grinder for 10-15 s to remove any remaining coffee power and maximize freshness.
15. Clean the coffee bean hopper and the conical grinder regularly.
16. You can change the grinding size while the coffee grinder is running.
17. Before operating or cleaning the appliance, all users must read and understand the user manual.
18. During use, do not leave the appliance unattended.
19. If the appliance malfunctions during use, please immediately press the on/off button again and remove the battery. Do not use or attempt to repair the faulty appliance, which may cause serious personal injury, fire, or property damage.
20. When the appliance falls or accidentally gets immersed in water, if the charging cable is connected, the power should be disconnected immediately. Do not immerse the product in water! Do not use the appliance after it has fallen into or been immersed in water. Do not put your hands into the water as there is a risk of electric shock.

21. To reduce the risk of personal injury or property damage, do not use the appliance in unstable locations.
22. The blade is very sharp and can cause injury if touched.
23. The coffee grinder is used for processing coffee beans and spices.
24. Do not use it for a long time.
25. Do not operate the coffee grinder without a lid.
26. Do not use it if the lid is broken or has a gap.
27. It is not recommended to use extension cords for the product.

Not Recommended

- The coffee grinder cannot grind anything that is damp, sticky, or extremely hard, such as: Ice cubes, chocolate, whole nutmeg, preserved ginger by sugar, etc. This coffee grinder cannot make any kind of paste from sunflower or sesame seeds.
- Do not add oil or liquid during grinding.
- Grains, such as corn, wheat, rice, barley, and rye, etc., may damage the lid.
- It is not recommended to chop, mince or puree soft food.

Cleaning and Maintenance

Cleaning of the Coffee Grinder

Important note: To avoid damage, do not wash or soak the main body or grinder of the coffee grinder in water, or put it in the dishwasher.

1. Clean the coffee bean hopper and its lid, as well as powder hopper with warm soapy water, then thoroughly rinse and dry them. Do not use grinding cleaner, steel wool pads, or other grinding materials (do not clean the product in the dishwasher).

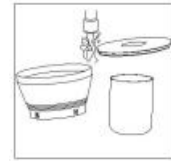

2. Wipe the body of the coffee grinder with a soft damp cloth, and then thoroughly dry it with a soft dry cloth.



Cleaning of the Grinder

If the coffee grinder is frequently used, it should be cleaned regularly to achieve optimal performance, which is particularly important during grinding. Through cleaning, the grinder can achieve the finest and most consistent grinding effect every time.



1. Empty the powder hopper, then remove the lid and powder hopper (as shown in the figure).

2. Remove the upper grinder.



3. Clean the upper grinder with a cleaning brush.



4. Clean the lower grinder with a cleaning brush, or remove any coffee power with a vacuum cleaner.



5. Install the upper grinder in the correct position.



6. Install the coffee bean hopper and its lid in the correct position (as shown in the figure).



Notes on Instructions for User Maintenance

The appliance requires almost no maintenance. The appliance does not contain any components that can be repaired by the user. Except for cleaning, any repairs that require disassembly must be carried out by qualified electrical appliance repair technicians.

Troubleshooting Guide

Problem	Possible causes and solutions
The appliance is not functioning (or there is not enough power to run).	<ul style="list-style-type: none"> • Display E0, indicating that the coffee grinder has been ground for more than 9 min within 15 min. Leave it for 20 min and wait for it to cool down before using it normally. • Display E1, indicating that the bean hopper is not installed properly. After reinstalling the bean hopper, it can be used normally. • Display E2, indicating that there is a blockage during the grinding. After turning off the switch, removing the foreign object that caused blockage in the bean hopper, and reinstalling the bean hopper, it can be used normally. • Display E3, indicating that the motor connection wire has fallen off. It is recommended that a qualified electrical appliance repair technician should be asked to remove the bottom cover, reconnect the fallen motor connection wire, and assemble it into a normal working state before use. • Display E4, indicating low battery level, prompting charging. After connecting the charging cable and charging for half an hour, it can be used normally. • Display E5, indicating that the charging cable is connected but the battery detaches. After unplugging the charging cable, removing the battery cover, reinserting the battery connection terminal, and installing the battery cover, it can be used normally.
There is no coffee powder being processed	<ul style="list-style-type: none"> • The setting of the coffee bean hopper may be incorrect. Please refer to the instructions under "Assembly". • The grinder needs to be cleaned or it is worn out. Please refer to the "Cleaning and Maintenance" section for detailed information on cleaning of the grinder.
There is too much coffee powder in the handle.	It is normal for the correct amount of coffee powder to appear to overflow from the handle. The volume of un-compacted coffee powder is approximately three times that of compacted coffee powder.
The grinding size adjustment selector is no longer working properly.	Check whether the position of the upper grinder is correct

Storage Method

1. Store the coffee grinder in a box or in a clean and dry place. Warning: Do not store the coffee grinder with the charging cable connected *.
2. Do not apply any pressure to the wires connected inside the appliance, as this may cause the wires to wear and/or break.

Recycling and Environmentally Friendly Treatment



In order to protect the environment, the product cannot be discarded like domestic waste after its service life expires; Please recycle at a professional recycling center. The waste generated during the coffee making should be collected and disposed of according to the methods specified in your region.

For more information about the recycling of the product, please consult the local municipal government, disposal service center, or the store where you purchased the product.

The manufacturer reserves the right to change the design, structure and specifications without prejudice to the general operating principles of the product, without prior notice. Therefore, there are no significant differences between the manual and the product.

You can contribute to protecting the environment! Remember to comply with local regulations and hand over the appliance that is not in use to the appropriate waste disposal center.

Warranty

Products that you buy directly from our **Green Lion** website or shop come with a 12-month warranty.

When you buy **Green Lion** products from any of our approved sellers, you get a 12-month warranty. If you want to extend this warranty, go to our website at **<https://www.greenlion.net/warranty>** and fill out the form with your information. Don't forget to upload a picture of the product too. After we've checked and accepted your request, we'll send you an email to confirm that your product's warranty has been extended.

For more info, please check:
<https://www.greenlion.net/warranty>

Contact Us

If you have any questions about this Privacy Policy, please contact us at:

Website: **<https://www.greenlion.net/>**

Sales: **sales@greenlion.net**

Service Support: **Support@greenlion.net**

Telegram: **[@greenlion_global](https://www.instagram.com/greenlion_global)**

Instagram: **[@greenlion_global](https://www.instagram.com/greenlion_global)**