



Green Lion

Rotary Shaver
5 in 1 Grooming Kit

SKU: GNROTM54SBK

Model No: GL-TM54

Table of Contents

Product Parts	2
Safety Instructions	2
Charging Instructions	4
Specifications	4
Instructions	5
Trouble Shooting	8
Environmental Protections	9
Disposal	10
Warranty	10
Contact Us	10

Product Parts

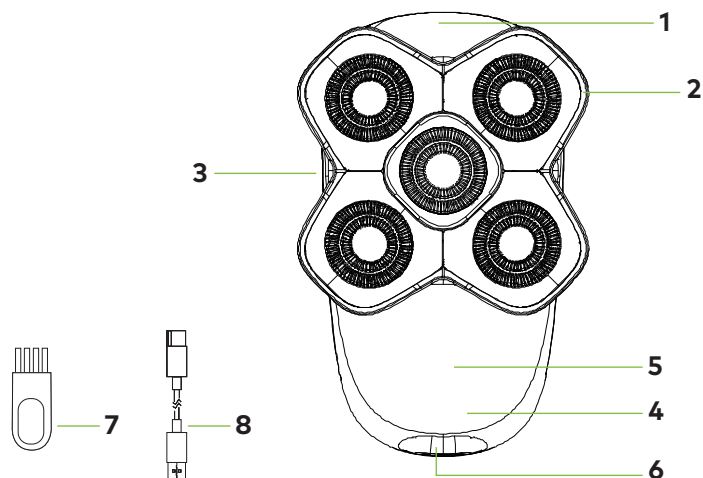

1. Tool head assembly

2. Knife head cover

3. Power button

4. Indicator light

5. Fuselage

6. Type-C charging port

7. Clean the brush

8. Type-C charging cable

Safety Instructions

Warning

Wash the hand-held part under water only after disconnecting it from the power cord.

Do not disassemble the body for battery replacement.

When operating the charging plug, do not pull the charging cord.

Do not charge the product for a long time without anyone watching.

The charging time should be no more than 24 hours.

The product contains a built-in rechargeable battery, which must not

be thrown away or disposed of in hazardous high temperatures.

Do not attempt to modify or repair the product yourself.

Caution

If the charging cord is damaged or does not work normally, please stop using it.

If the power cord is damaged, it must be replaced with a dedicated cord, or a replacement part from the manufacturer's service department.

Keep the product out of reach of children.

Ensure the charging port is dry when charging.

Please use a 5V charger for charging.

If the product is not used for a while, please fully charge it at least once every six months.

Reminder

The product is to be used by one person only.

When traveling with the razor, ensure the protective cover and the travel lock are in place to protect the razor.

Charge, use, and store the razor at temperatures from 5°C to 35°C.

To avoid damage to the charging cord, please do not wrap it around the product.

The product is only suitable for removing facial hair. It is not recommended to use it on the head or other body parts.

The product has passed the IPX7 waterproof test and can be washed with water or under a faucet. Nevertheless, do not soak in water for prolonged time.

During cleaning, it is normal for water to drip from the device in the enclosure. This does not pose any danger, as all electronic components are enclosed in separate waterproof parts inside.

Persons who do not have full capacity and lack relevant experience and knowledge (including children) must use, clean, and maintain the product under the supervision and guidance of a guardian.

Charging Instructions

The content of the LED display indicates the percentage of remaining power of the electric razor.

Connect one end of the USB cable to the charger and the other end to the Type-C interface of the charging port for charging. During charging, the power indicator blinks, and the power digits increase, i.e., from 00 to 99. When fully charged, the "99" digit is lit.

When the battery is low and the product cannot be powered on, it will take about 60 minutes to fully charge. It can be used for about 12 minutes after a full charge. When the battery is low, charge the product. If not in use for a while, please charge it at least once every six months.

When the battery is below %20, the LED display (current battery) starts to blink as a reminder to charge until the electric razor is powered off.

The plug and go mode is available after connecting the charger when the battery is low. (Charging is prohibited when the charging port is wet.)

Specifications

Model Number	GL-TM54
Material	ABS
Blade	Stainless Steel Blade
Motor	DC 260
Battery	1400mAh Battery
Power	5W
Speed	2 Levels

RPM Range	3300 RPM
Charging Port	Type-C
Charging Time	2.5 Hrs
Working Time	2 Hrs
Waterproof	IPX7
Product Weight	218 g
Product Dimensions	104*112*73 mm

Instructions

I. Blade Heads Disassemble and Assemble Steps

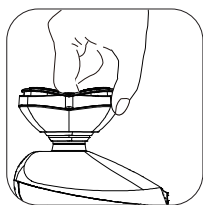

Pull up

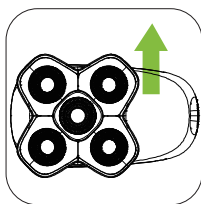

Detach the razor body

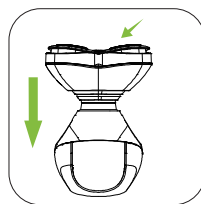

Assemble the blade heads back to the body

Note:

If you need to remove and wash the blades, it is recommended for a professional to operate and ensure all blades and blade meshes do not switch positions. Install them back into their original positions. Failing to do so may cause increased noise, weakened shaving effect, and unsmooth operation.

II. Operation Method

Clean the facial skin before shaving. The skin may be mildly irritated after the first few shaves, which is normal. It is recommended to use the razor regularly over a 3-week period (about 3 times a week) to allow the skin to adapt as soon as possible.

During shaving, just press gently and move slowly on the face in circles. It can be used dry or with water (dry shaving is preferred).

Press the power button to switch on the razor, after which the LED display and circular indicator light up concurrently. After 1 second of self-test, the LED display shows the remaining power percentage. Press the power button again to switch off the razor and the LED display turns off.

Long press the power button for 1 second to switch modes when the razor is powered on. The circular indicator means acceleration mode and one of the same standard mode. When the razor is switched on the next time, it is in the same mode by default as during the previous use.

After shaving, press the power button to turn off the electric razor. (Improper use may easily damage the blade meshes and blade heads. Please confirm if the blade meshes and blade heads are intact before use. If damaged, please stop using).

III. Travel Lock

The razor is equipped with a travel lock feature to prevent accidental switching on of the razor in the luggage.

Engage the travel lock: When the electric razor is off, long press the power button for 3 seconds. The motor does not rotate and the travel lock is engaged. The LED display shows all digits and flashes.

Disengage the travel lock: In the locked state, long press the power button for 3 seconds, and the LED display shows all digits and flashes. After disengaging the lock, the razor powers off directly.

IV. Cleaning and Maintenance

To keep the optimal performance of the razor, please clean it after each shave (When the cleaning indicator is on, there is too much hair residue accumulated in the razor, which impedes its normal operation).

1. When cleaning the razor, ensure the product is not being charged and is powered off.
2. Gently remove the hair residue from the storage chamber with the cleaning brush.
3. After brushing off the hair residue, rinse the body, blade heads, and hair residue storage chamber with water (warm water is recommended). Do not use towels or paper towels to wipe the blade heads.

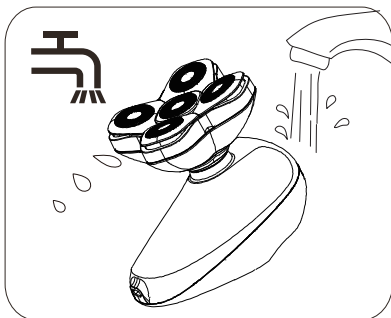
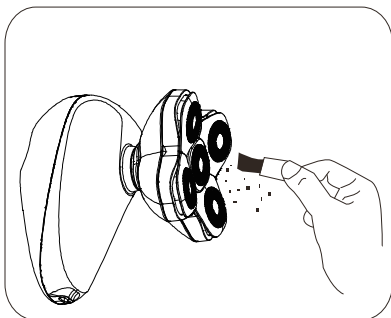

Note: The razor can be washed under the faucet (Ensure the charging port is dry when charging).

4. After rinsing, dry or wipe with a cloth, keep the blade heads dry, and reassemble the blade heads.

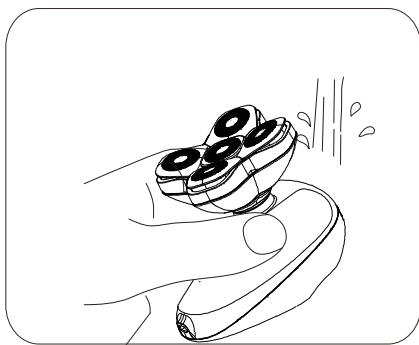

Trouble Shooting

Malfunction	Cause of the Issue	Solution
Non-ideal shaving	Blade head is damaged or worn	Replace with a dedicated blade head
	Hair residue clog the razor	Thoroughly clean the blade heads
	Low or no power	Connect the charging cord for charging
Does not power on when pressing the power button	Power button fails	Return to after-sales service for repair
	The travel lock is engaged	Long press the power button for 3 seconds to disengage the lock
The LED display is abnormal/off	Low battery and needs to be charged	Please charge the razor
	Damaged circuit board	Return to after-sales service for repair
Skin irritation after shaving	Blade head is damaged or worn	Replace with a dedicated blade head
	The razor head has not been cleaned for a long time, which causes a larger load	weeks of 3 to 2 After adaptation, the skin allergy shall disappear
Unable to charge	Damaged Razor	Return to after-sales service for repair
	Charging environment temperature is too low or too high	Charge in an environment between C°35 C and°5
Shave for less than 45 minutes after a full charge	The razor head has not been cleaned for a long time, which causes a larger load	Thoroughly clean the razor head
	The battery malfunction	Return to after-sales service for repair
The razor automatically powers off and the display flashes 3 times	Blockage by foreign objects	Thoroughly clean the razor head
	The razor is damaged	Return to after-sales service for repair

Environmental protection

When the razor reaches its service life, the battery inside must be removed for recycling and proper disposal as per the laws and regulations of the country or region before discarding the razor. If the battery cannot be removed, please hand over the product to the recycling center designated by the government or the company-designated service department. The service department shall disassemble and recycle the battery.

Warning

Please do not discard the battery into the fire, which may cause explosion or release of toxic and harmful substances.

Please do not short-circuit the battery, which may set it on fire.

Do not disassemble the product unless it is to be discarded. Premature disassembly will damage the product. During operation, basic safety precautions must be observed. Disconnect the product from the power supply before battery removal.

Remove the razor heads assembly when the electric razor is powered off. Use a screwdriver to detach the left and right screws of the hair residue storage chamber and remove it.

Use a screwdriver to gently pry the left and right sides of the waterproof cover and remove it.

Press the screwdriver against the charging port. Push out the circuit board assembly and gear stand.

Use a screwdriver to detach the front and rear screws of the gear stand and pull out the circuit board assembly.

Cut the positive and negative soldering lugs on the battery and remove it.

Disposal

This product must not be disposed of as unsorted household waste. It is important to separate such waste for proper treatment and recycling, in compliance with local waste management regulations.

Warranty

Products that you buy directly from our **Green Lion** website or shop come with a 24-month warranty.

When you buy **Green Lion** products from any of our approved sellers, you only get a 12-month warranty. If you want to extend this warranty, go to our website at <https://www.greenlion.net/warranty> and fill out the form with your information. Don't forget to upload a picture of the product too. After we've checked and accepted your request, we'll send you an email to confirm that your product's warranty has been extended.

For more info, please check:
<https://www.greenlion.net/warranty>

Contact Us

If you have any questions about this Privacy Policy, please contact us at:

Website: <https://www.greenlion.net/>

Sales: sales@greenlion.net

Service Support: Support@greenlion.net

Telegram: [@greenlion_global](https://www.instagram.com/greenlion_global)

Instagram: [@greenlion_global](https://www.instagram.com/greenlion_global)