

LèPRESSO



LePresso
ESPRESSOVAC
PORTABLE VACUUM CLEANER

SKU: LPCFFPVC0061BK

Table of Contents

Product Overview	2
Specifications	2
Product Features	3
Product Design	3
Usage Instructions	4
Notice	4
Safety Precautions	4
Disposal	5
Warranty	6
Contact Us	6

Product Overview

The LePresso EspressoVac Portable Vacuum Cleaner is designed to provide a perfect clean for your espresso machines and other kitchen surfaces. With its powerful 15000Pa suction capability, it ensures a thorough clean by easily removing powder messes and debris from hard-to-reach spots. Its sleek, modern design combines functionality with ease of use, making it a handy tool for maintaining a tidy and efficient kitchen. The EspressoVac is equipped with a strong motor and a long-lasting battery, ensuring consistent performance and convenience with every use. Whether you're cleaning coffee grounds or small debris, this vacuum is an ideal solution for coffee enthusiasts and home baristas alike.

Specifications

Battery Capacity	2500mAh
Suction Power	15,000Pa
Motor	70,000RPM
Power	80W
Noise	75dB
Torch Light	100LM
Weight	520g
Dimension	60x90x235mm

Product Features

1. Compact and lightweight design for easy portability and storage.
2. Brushless motor providing high suction power and extended durability.
3. Wireless lithium battery suitable for both home and car use.
4. Ultra-bright 300LM lighting with SOS functionality for added convenience.
5. Multi-purpose blowing/suction nozzle included.
6. Chargeable through Type-C interface, usable at home or in the car.

Product Design

1. Handle
2. Switch
3. Lamp Switch
4. Dust Cylinder
5. Charging Port
6. Lamp
7. Outlet
8. Charging Cable
9. Brush
10. Suction Nozzle
11. Air Nozzle 1
12. Air Nozzle 2
13. Air Nozzle 3
14. Air Nozzle 4
15. Round Brush

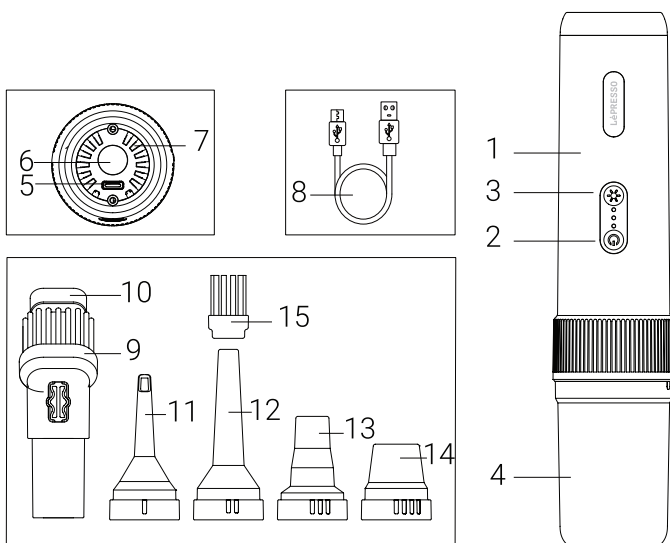

Usage Instructions

- 1.** Fully charge the product before use.
- 2.** Press and hold the power switch for 0.5 seconds to turn on the vacuum cleaner in standard mode. Press again to switch to strong mode, and press once more to turn off the machine.
- 3.** Press and hold the light button to activate the lighting mode. Press again to enter SOS mode, and press once more to turn it off.
- 4.** For prolonged use, regularly clean the dust cylinder and wipe off floating dust with a handkerchief to maintain optimal performance.

Notice

- 1.** This product is suitable for use on home dust, car dust, vacuum bags, inflatable beds, swimming rings, and similar items.
- 2.** For transportation safety, lithium battery products cannot be shipped with a full charge. Please ensure the product is fully charged before use.
- 3.** The product has two settings: the first gear is for small particles, and the second gear is for larger particles.
- 4.** If the lamp circle on the product turns red, charge it immediately to prevent insufficient power in future use.

Safety Precautions

- 1. Keep Away from Water:** Avoid using the vacuum cleaner near water or wet surfaces to prevent electric shock or damage to the device.
- 2. Proper Storage:** Store the vacuum in a cool, dry place, away from direct sunlight and heat sources to maintain its longevity

and prevent malfunction.

3. Check for Blockages: Before use, ensure that the nozzle and attachments are free from blockages to maintain optimal suction performance.

4. Avoid Overheating: Never use the vacuum for extended periods without allowing it to cool down. Overheating could cause damage to the motor.

5. Use Approved Attachments: Only use the recommended attachments to prevent any damage to the device and ensure safe and effective operation.

6. Supervised Use: Always operate the vacuum cleaner under supervision, especially around children, to prevent accidents.

7. Turn Off When Not in Use: Always switch off the vacuum cleaner when not in use to avoid unnecessary battery consumption or wear.

Disposal

This product must not be disposed of as unsorted household waste. It is important to separate such waste for proper treatment and recycling, in compliance with local waste management regulations.

Warranty

Products that you buy directly from our **LePresso** website or shop come with a 24-month warranty.

The 24-month warranty applies to products purchased directly from our **LePresso** website or store. If **LePresso** products are bought from any of our verified retailers, then the product is eligible for only a 12-month warranty. To extend your product's warranty, visit our website **<https://www.lepresso.com/warranty>** and fill in your details in the provided form along with an uploaded picture of the product to process your request. Once approved, you will receive a confirmation email of the extended product warranty. Upload the required information within 48 hours of purchase to be eligible for a 24-month warranty period.

For more info, please check:
<https://www.lepresso.com/warranty>

Contact Us

If you have any questions or concerns about our Shipping and Returns Policy, please contact us at: **info@lepresso.com**

Website: **<https://www.lepresso.com/>**

Instagram: **[lepresso_official](#)**