



Green Lion

Solo Flame Camping Stove

SKU: GNSOLSTVGN

Model No: GSC-45

Table of Contents

Preface	2
Quick View	2
Safety Instructions	3
Operating Instructions	5
Maintenance	8
Specifications	9
Disposal	10
Warranty	10
Contact Us	10

Preface

Thank you for purchasing our portable camping stove.

We value your choice and are committed to ensuring that you have a higher level of satisfaction with the product.

May every consumer enjoy a healthy, fashionable, wonderful, and convenient life.

At the same time, we also look forward to receiving your feedback, good suggestions, and ideas, so as to promote us to better improve and improve.

Quick View

Product: Outdoor Stove





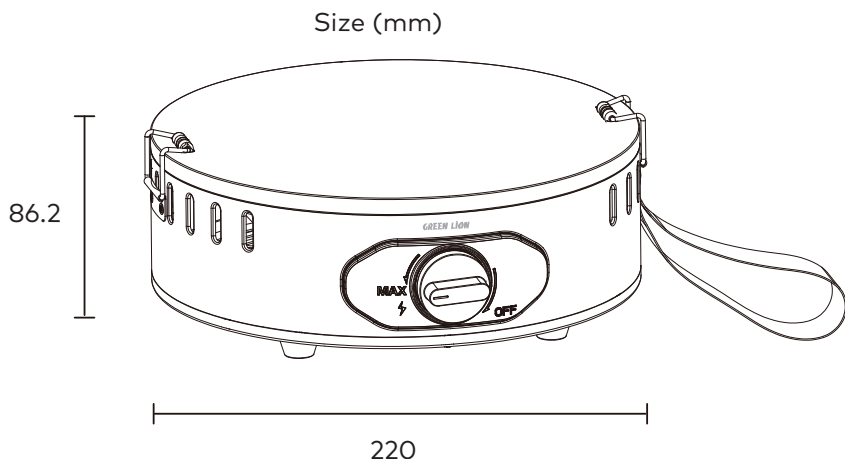

Item: GCS-45

Size: $\phi 86.2 \times 220$ mm



Please note

1. Read the instructions carefully before using the product.
2. Easily accessible areas will be hot, please keep away from children.
3. Please do not move the product when using.
4. Keep the manual for future reference.

icon	The meaning of the icon
	 Attention
	 Forbid
	 Enforcement

Attention

Please follow the instructions strictly to avoid damage to the product or property damage to the user

5. Before ignition, please check whether there is oil accumulation in the work area, such as the stove frame, and then ensure that there are no fire hazards in the work area before using the product.

6. Please keep away from heat sources, flammable and explosive materials when using, and pay attention to fire prevention.
7. Do not touch the heat source with your hands during use to avoid burns.
8. Please use in a ventilated outdoor environment.
9. Suitable for use on calm, stable, and non-flammable surfaces.
10. Do not use sharp objects or tools to scratch the furnace to avoid damaging the product.
11. After the use of the product, the gas cylinder should be removed and stored separately.

Enforcement

Please strictly follow the instructions to avoid damage to the product or property damage to the user.

At the end of use, please make sure that the gas switch is turned off, and then tidy up the stove after the stove body cools down, so as not to burn the stove. When using the stove, please do not exceed the maximum load of each barbecue accessory, the maximum load of the stove body is 6kg, and the maximum load of the stove frame is 3kg.

Forbid

Failure to follow the following instructions may cause fire, explosion, etc., resulting in casualties and property damage.

12. Strict and private disassembly of gas appliances.
13. Do not approach other heat sources, such as induction cookers and other gas appliances.
14. It is forbidden to place portable furnaces with gas cylinders on top of each other.
15. Do not use strong or hot air to extinguish the flame, and the hot air

may increase the pressure of the cylinder, causing an explosion.

16. It is forbidden to use utensils containing large radiation such as stones, sand, and ceramic materials.

17. Do not use cooking utensils that are equivalent to the entire stove or can cover the side covers.

18. It is forbidden to pour fluids such as soup on the stove to prevent the fluid from clogging the flame.

19. It is forbidden for non-professionals to disassemble it by themselves to avoid damage to parts or perceived injury.

Attention

Please follow the instructions strictly to avoid damage to the product or property damage to the user.

20. Improper installation may cause harm to persons and property.

21. The installation of gas appliances should be carried out in strict accordance with the instructions.

Operating Instructions

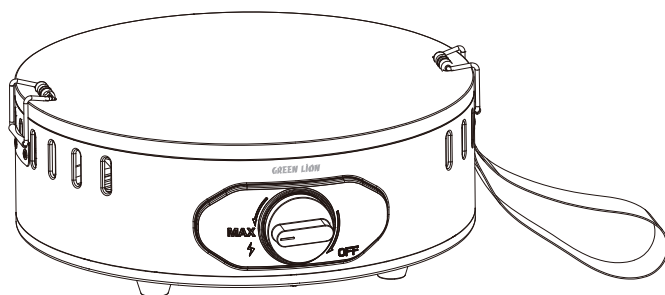

1. Place the product horizontally on a flat surface.

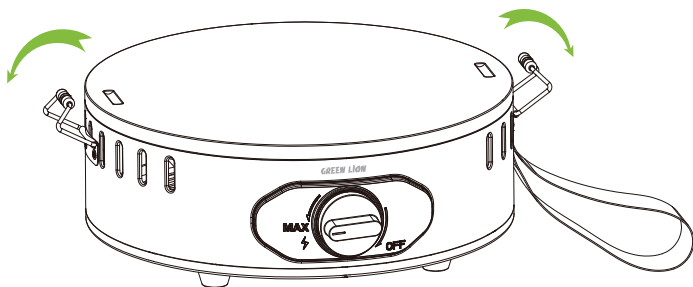

2. Unlock the latch.

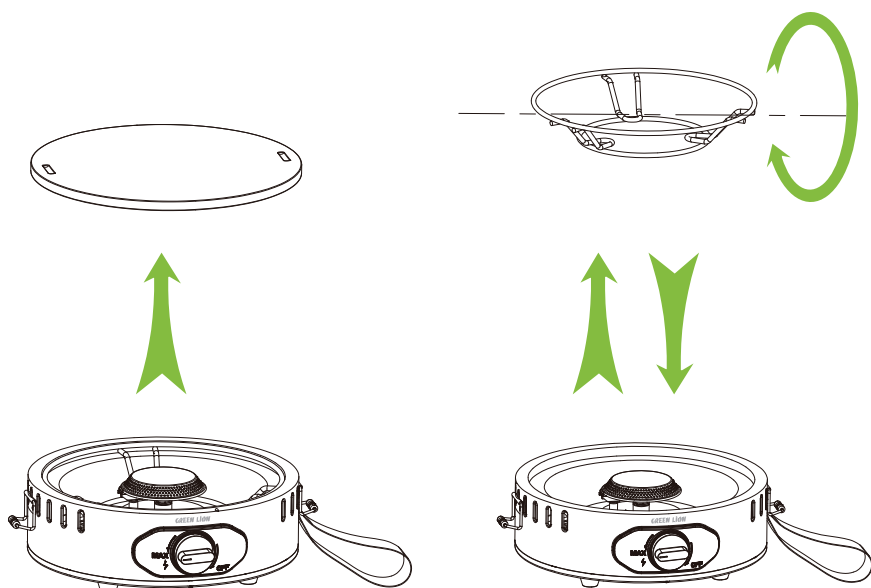

3. Take out the Planks

4. Flip the stove and placed on the product

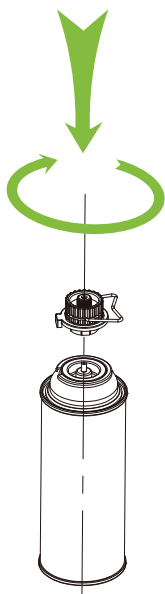

5. Press down on the adapter and rotate it clockwise by 5-10°.

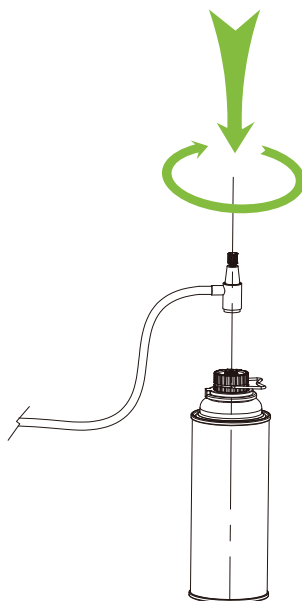

6. Rotate the regulator gas pipe clockwise until it locks.

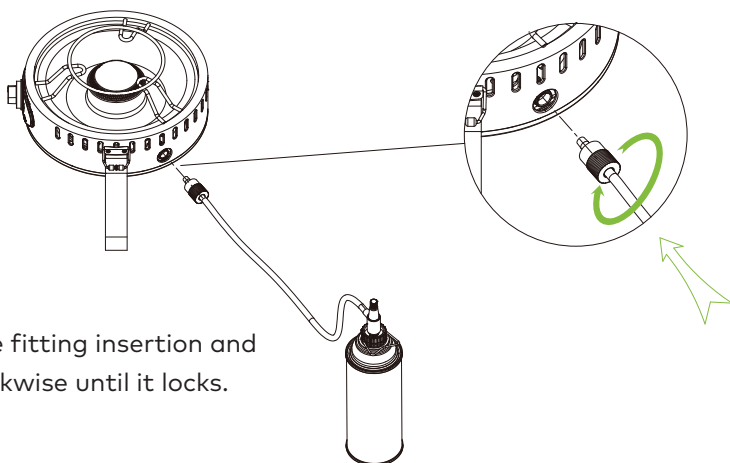

7. Align the fitting insertion and rotate clockwise until it locks.

Ignition Method

The operating knob is rotated in different directions to achieve different functions.

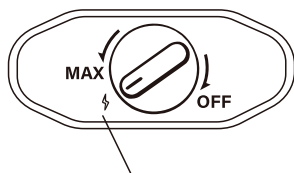

Counterclockwise rotation ignition

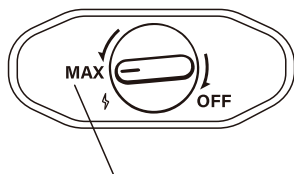

Rotation to this position is maximum firepower

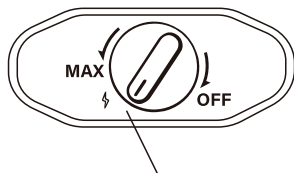

Clockwise rotation is the direction of closing the valve

Maintenance

1. After the stove is used, clean the furnace and tools after the furnace fire is extinguished and the furnace body cools down.

2. Wipe the inner wall and exterior of the product with a wet towel, and keep the product dry inside and outside after cleaning.
3. Do not use corrosive sponges to wipe the furnace body or spray any awakening chemical solvent on the furnace body.
4. Be careful when cleaning, do not brush with hard objects to avoid scratching the coating.
5. When not in use, please clean the product and store it in a dry and ventilated place.

Specifications

Model No.	GCS-45
Material	Iron
Burner Material	Stainless Steel
Rated Heat Input	8,000 BTU(~ 2.34 kW)
Gas Type	Butane / Propane
Gas Consumption	153 g/h
Gas Pipe Length	60 cm
Maximum Load Capacity	5 kg
Product Weight	1.37 kg
Product Dimensions	86*220 mm

Disposal

This product must not be disposed of as unsorted household waste. It is important to separate such waste for proper treatment and recycling, in compliance with local waste management regulations.

Warranty

Products that you buy directly from our **Green Lion** website or shop come with a 24-month warranty.

When you buy **Green Lion** products from any of our approved sellers, you only get a 12-month warranty. If you want to extend this warranty, go to our website at <https://www.greenlion.net/warranty> and fill out the form with your information. Don't forget to upload a picture of the product too. After we've checked and accepted your request, we'll send you an email to confirm that your product's warranty has been extended.

For more info, please check:
<https://www.greenlion.net/warranty>

Contact Us

If you have any questions about this Privacy Policy, please contact us at:

Website: <https://www.greenlion.net/>

Sales: sales@greenlion.net

Service Support: Support@greenlion.net

Telegram: [@greenlion_global](https://www.instagram.com/greenlion_global)

Instagram: [@greenlion_global](https://www.instagram.com/greenlion_global)