



**Green Lion**

**URANUS**  
**Charger | Speaker| RGB**

SKU: GNURNSLMPWH

Model No: GWC-8

## Table of Contents

Overview	2
Product Diagram	2
Instructions	3
A. Charging the product	3
B. Wireless Charging	3
C. Button Function	4
D. Bluetooth Pairing	4
E. Bluetooth speaker Instructions	5
F. Ambient Light Operation	5
Compatible Charging Devices	6
Safety Instructions	6
Specification	7
Disposal	7
Warranty	8
Contact Us	8

## Overview

The Green Lion Uranus is a 3-in-1 device that combines a bedside lamp, Bluetooth speaker, and wireless charger. It offers 8 RGB lighting modes and 15W wireless charging for your devices. With a 1800mAh battery, it provides up to 6 hours of use. The lamp has a 3000K color temperature for a warm, cozy light, and the easy-to-use control buttons make it simple to adjust settings. Plus, it supports Type-C charging for fast power input. Perfect for adding style and functionality to your space.

## Product Diagram

1. Portable lantern
2. Control buttons
3. Ambient light
4. Wireless charging induction area
5. Mobile phone stand
6. Indicator light
7. Type-C port
8. Speaker

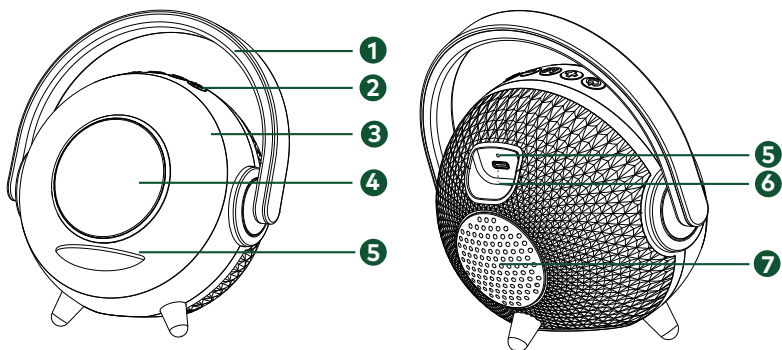

## Instructions

### A. Charging the product

1. Connect the USB end of the cable to the power adapter and plug the Type-C end into the product.
2. Once the product is powered on, a red indicator light will signal that charging is in progress. When fully charged, the light will turn green

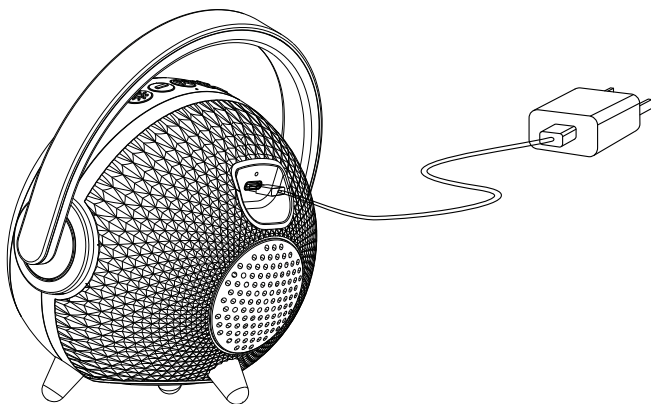

### B. Wireless Charging

After connecting the main power source, place the wireless charging device on the designated charging area of this product to begin charging.

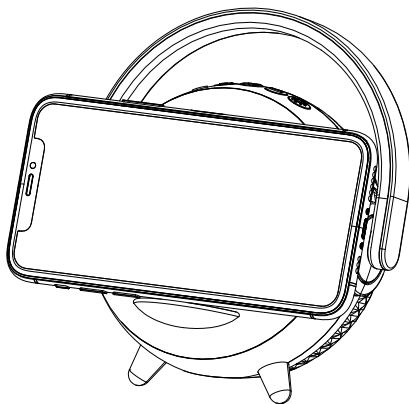

## C. Button Function

1. Power On/Off
2. Volume up
3. Light Mode
4. Volume Down
5. Light Brightness Button

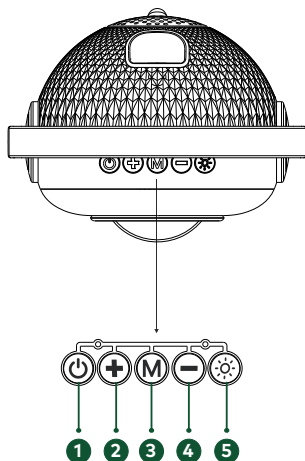

## D. Bluetooth Pairing

1. Press and hold the M button to reset Bluetooth pairing.
2. Enable Bluetooth on your phone and select "GWC-8" from the list of available devices. The device will automatically enter pairing mode. Once pairing is successful, a confirmation tone will sound.

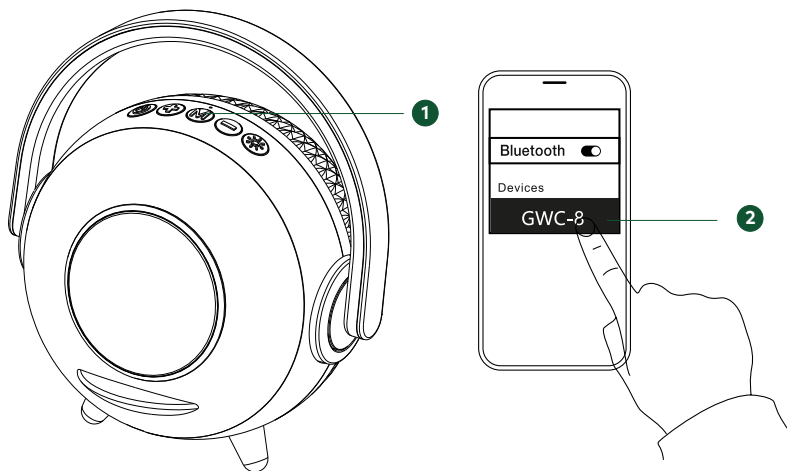

## E. Bluetooth speaker Instructions

1. When playing music Briefly press the power on/off button to pause or play the music.
2. Press and hold the volume up button to skip to the next track. Briefly press the volume up button to increase the volume. A beep will indicate when the maximum volume is reached.
3. Press and hold the volume down button to skip to the previous track. Briefly press the volume down button to decrease the volume.

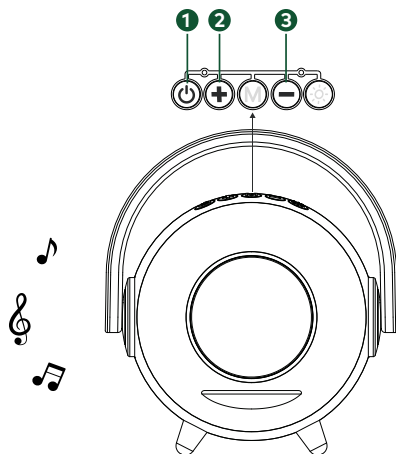

## F. Ambient Light Operation

### F.1 Light Modes Adjustment

Press the M button repeatedly to cycle through RGBW color modes and eventually turn off the lights.

### F.2 Light Brightness Adjustment

1. Press the light brightness button repeatedly to adjust the brightness to 25 %, 50 %, 75 %, 100 %, or Off.
2. Press and hold the light brightness button to cycle through the lighting modes: Handle light on  
-Both handle and ambient light on-Ambient light on-Both handle light and ambient light off.

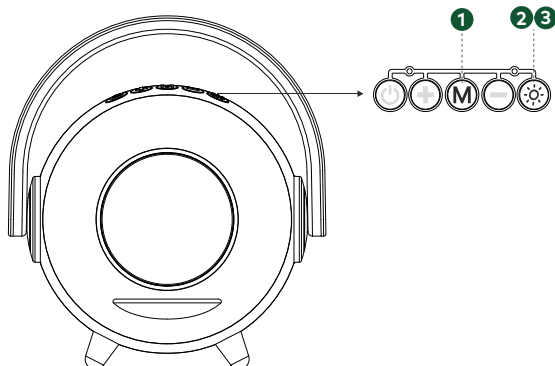

## Compatible Charging Devices

This product supports fast wireless charging and is compliant with the Qi wireless charging standard. It uses magnetic induction for short-distance power transmission and is compatible with all wireless devices that meet the Qi standard. When paired with adapters that support QC2.0/QC3.0/PD protocols, the wireless charging can handle up to a 15W load and includes overvoltage and overtemperature protection.

## Safety Instructions

1. Avoid using or storing the product in direct sunlight or high-temperature environments for prolonged periods.
2. Do not charge the product near magnetic cards, magnetic media, or precision instruments.
3. Do not attempt to disassemble or modify the product.
4. Do not touch the AC adapter with wet hands.
5. Keep the product away from water or other liquids.
6. Always disconnect the power before cleaning the product.

## Specifications

Model No	GWC-8
Material	ABS
Battery	1800mAh
Power	5W
Bluetooth	V5.2
Speaker	5W 4Ω
Lights	22 RGB + 22 White
Color Temp	3000K
Color Modes	8 Modes
Brightness	50-300 lm
Input Port	Type-C
Charging Time	2 Hours
Working Time	3-6 Hours
Transmission Range	<20m
Power Input	5V/1A, 5V/2A, 9V/2A
Wireless Output	15W/10W/7.5W/5W
Product Weight	400g
Product Size	220 x 110 x 240 mm

## Disposal

This product must not be disposed of as unsorted household waste. It is important to separate such waste for proper treatment and recycling, in compliance with local waste management regulations.



## Warranty

Products that you buy directly from our **Green Lion** website or shop come with a 24-month warranty.

When you buy **Green Lion** products from any of our approved sellers, you only get a 12-month warranty. If you want to extend this warranty, go to our website at **<https://www.greenlion.net/warranty>** and fill out the form with your information. Don't forget to upload a picture of the product too. After we've checked and accepted your request, we'll send you an email to confirm that your product's warranty has been extended.

For more info, please check:  
**<https://www.greenlion.net/warranty>**

## Contact Us

If you have any questions about this Privacy Policy, please contact us at:

Website: **<https://www.greenlion.net/>**

Sales: **[sales@greenlion.net](mailto:sales@greenlion.net)**

Service Support: **[Support@greenlion.net](mailto:Support@greenlion.net)**

Telegram: **[@greenlion\\_global](https://t.me/greenlion_global)**

Instagram: **[@greenlion\\_global](https://www.instagram.com/greenlion_global)**