



**Green Lion**

## **STEAM CARPET PRO**

SKU: GNSC18CARPBK  
Model No: GL-SC18

## Table of Contents

Safety Instructions	2
Usage Restrictions	2
Power Cord Usage	3
Usage Restrictions	4
Caution	4
Product Overview	5
Control Panel	6
Installation	7
How to Use	8
Care & Maintenance	10
Troubleshooting	12
Specifications	13
Disposal	14
Warranty	14
Contact Us	14

## Safety Instructions

Please read this manual carefully before use and keep it for future reference. When using any electrical appliance, always follow basic safety precautions. Failure to follow the instructions may result in electric shock, fire, or injury.

## Usage Restrictions

1. Do not use to clean arts and crafts, fibers, and items not suitable for cleaning by water, and surfaces easy to be hurt (like floors, tables, etc.).
2. Do not slant if water is in the tank to avoid wetting the floor.
3. Stop the machine and empty the dirty water tank if it reaches the full line.
4. Make sure the detergent used is not bad for your washed items.
5. The machine may stop when cleaning long hair carpet due to a blocked air outlet. Stop the machine if a large quantity of foam or dirty water comes out and empty the dirty water tank before using it again.
6. Do not use foam detergent.
7. Please ensure the users need assistance (including children) and are under supervision when they use the machine.
8. Do not use liquid like pesticides, hair dyes, and lubricants.
9. Do not use to pick up any flammable or combustible objects or cigarettes.
10. Do not use to pick up any oil or hot air, or dry dust.
11. Do not use if the hose is broken, avoid bending, stamping, and pulling violently of the hose.
12. Do not block the air outlet to avoid influence on the heat dissipation.

Stop use if there is any unusual noise and smell.

**13.** Do not disassemble, repair, or change the machine's structure by yourself.

**14.** Do not use it under the scene of heavy wind or rain.

**15.** Do not immerse in water or liquid to avoid fire or electric shock hazard.

**16.** Do not use to pick up any dust with infectious danger.

**17.** Do not use without dirty water tank in position.

**18.** If the supply cord is damaged, it must be replaced by the manufacturer, its service agent, or similarly qualified persons in order to avoid a hazard.

### **Precautions Against Steam/Hot Water Burns**

Please pay attention to avoid directly spraying towards people or animals to prevent burns. It will generate high temperature when using the hot water or steam settings.

Liquids or steam can't be directed towards devices that contain electrical components, such as the interior of ovens.

### **Children Safety Information**

This appliance can be used by children aged from 8 years and above and persons with physical, sensory, or mental capabilities or lack of experience and knowledge if they have been given supervision or instruction concerning the use of the appliance in a safe way and understand the hazards involved. Children shall not play with the appliance. Cleaning and user maintenance shall not be made by children without supervision.

This appliance may be normal used under 50Hz or 60Hz the frequency need not to be adjusted.

## **Power Cord Usage**

**1.** Clean the plug from time to time.

**2.** Plug in well when used.

**3.** Unplug the machine if it will not be used for a long time.

**4.** Unplug the machine before maintenance, checking, and moving.

**5.** Do not plug or unplug the machine with wet hands.

Keep the plug away from kids.

6. Do not damage the power cord. Do not pull the plug violently when moving the machine.
7. Do not use the machine in case of damaged power cord or plug.
8. Do not use overloaded socket.
9. Do not use in case of any failures; cut the power and unplug the machine.

## Usage Restrictions

These items should not be picked up by the appliance:

1. Dry dust
2. Large quantities of powder
3. Large quantities of sand and stones
4. Large quantities of rubbish
5. Metal objects, such as needles and pins
6. Large polythene bags and stockings
7. Items that can easily be dumped inside

## Caution

1. Use the machine only for cleaning purposes.
2. This appliance is for household use only.
3. Keep away from fire or heating equipment.
4. Stop operating if the water-spray nozzle is blocked.
5. Stop operation if any foreign objects are ingested.
6. Empty the tanks if any blockages are present before using again.
7. Do not tilt or sit on the machine.
8. Keep out of reach of children.
9. Not for outdoor use.
10. Do not use if the suction hole is blocked.

# Product Overview

## Component Parts:

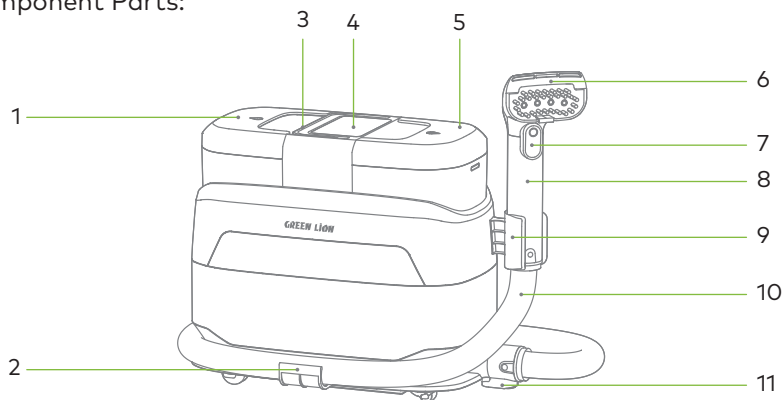

**1.** Clean Water Tank

**2.** Hose Bracket

**3.** Handle

**4.** Control Panel

**5.** Dirty Water Tank

**6.** Standard Steam Brush

**7.** Steam Brush Release Button

**8.** Handle

**9.** Handle Holder

**10.** Hose

**11.** Hose Release Button

## Packing List:

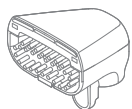

Standard  
Steam Brush

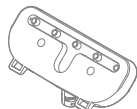

Ironing Brush

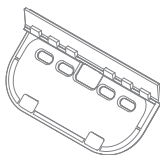

Window  
Cleaning Brush

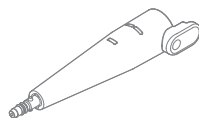

Steam Nozzle



Hose Bracket  
x2



Handle Holder

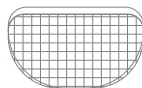

Cleaning Cloth  
x2

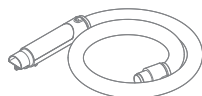

Hose

## Control Panel

### Note:

This product has voice prompt features. Please pay attention to the relevant prompts during operation.

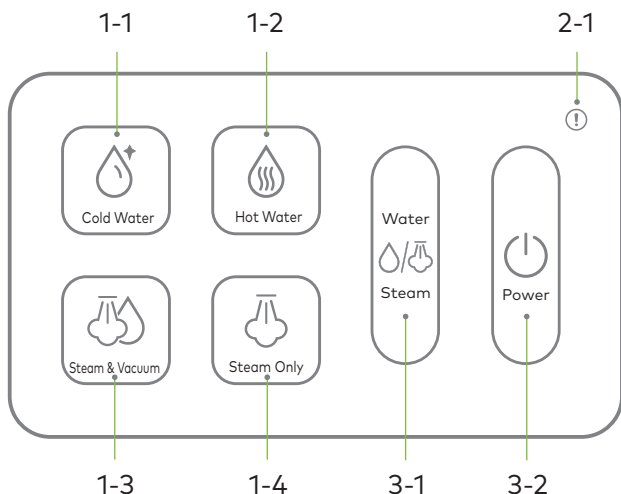

Mode Selection Area:

1-1. Cold Water

1-2. Hot Water

1-3. Steam & Vacuum

1-4. Steam Only

Failure Light Display Area:

2-1. Failure Light Display

Operation Area:

3-1. Spraying/Steam

3-3. Power

## Installation

### Installing the Holders

Insert the hose bracket and handle holder into the main unit until they install successfully with a click.

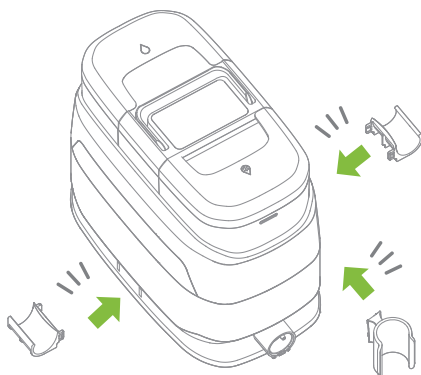

### Installing the Hose and Steam Nozzle

Insert the steam brush into the handle until it clicks into place.

Insert one end of the hose into the main unit until it installs successfully with a click, then secure the handle into the handle holder.

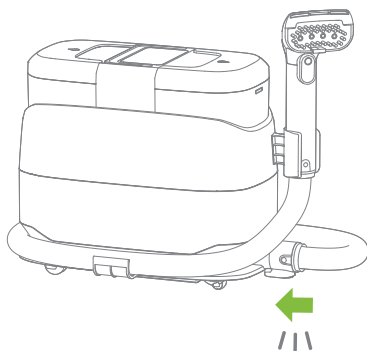
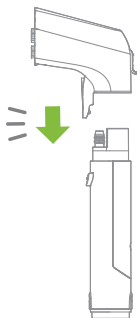



## How to Use

### Filling the Clean Water Tank

Remove the Clean Water Tank from the main body. Remove the Clean Water Tank cover. Fill the tank with water up to the "MAX" line on the tank.

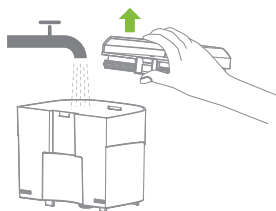
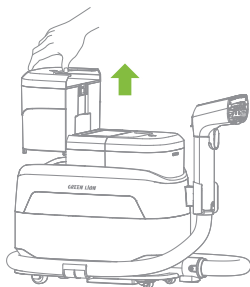

### Starting Cleaning

Plug the power cord into the power socket.

Select the cleaning mode on the touchscreen panel and press the "Power" button to turn on the main unit.

Aim the nozzle at the stained area and press the "Water/Steam" button to begin spraying water or steam.

To pause the spraying, press the "Water/Steam" button again. To turn off the unit, press the "Power" button. The unit will continue running for a few seconds after being paused or turned off to avoid dirty water residual inside.

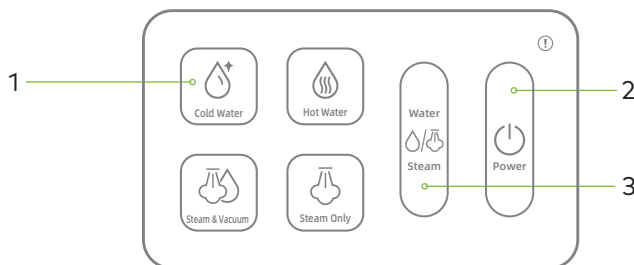

### Note:

When steam cleaning is required, press the "Steam Only" button. Once preparation is completed, press the "Water/Steam" button to start.

When hot water cleaning is required, press the "Hot Water" button again. Press the "Water/Steam" button to start.

When steam and vacuum cleaning is required, press the "Steam & Vacuum" button. Once preparation is completed, press the "Water/Steam" button to start.

When cold water cleaning is required, press the "Cold Water" button, then press the "Water/Steam" button to start.

### Warnings:

When using the steam or hot water modes, there is a risk of burns. Make sure the brush head is facing downward during use and avoid directly spraying towards people or animals.

Liquids or steams cannot be directed towards devices that contain electrical components.

Steam and hot water preparation takes time. If the preparation is not complete and you press the "Water/Steam" button, the indicator light will flash, and no steam or hot water will be released.

### How to Use Other Accessories:

Press the brush release button to remove the Steam brush, and then attach the appropriate accessory to the end of the extension hose until it clicks into place.

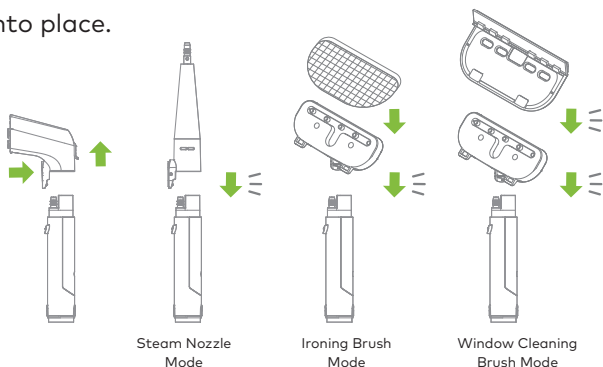

Emptying the Used Water Tank:

Pull up the tank cover and pour out the used water. Reinstall the tank cover and the tank before use.

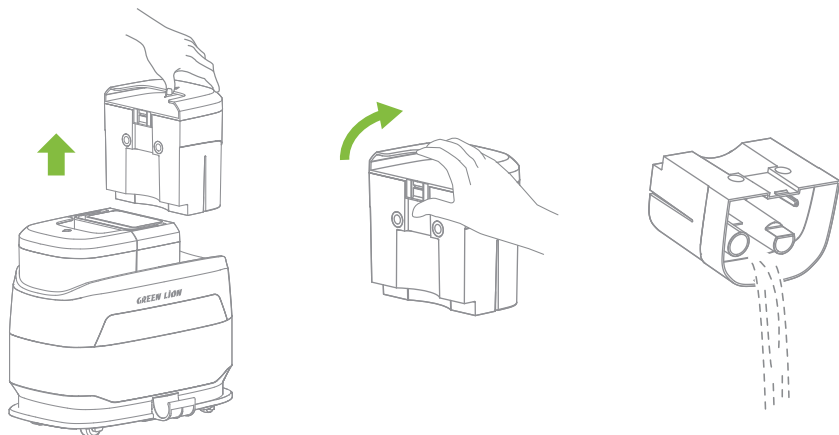

**Note:**

To maintain the normal use, please empty the Used Water Tank in time or before exceeding the MAX line.

## Care & Maintenance

**Tips:**

Turn off the appliance before maintenance. Do not touch the power switch.

Replace parts if needed. The parts must be replaced by those available from the manufacturer or its service agent.

### Cleaning the Hose

While the machine is on, place the nozzle close to a clean surface or countertop and press the "Water/Steam" button to clean the internal hose.

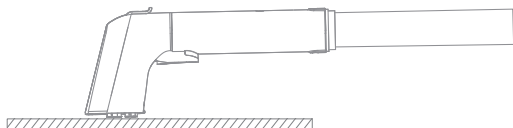

## Cleaning the Steam Brush

Open the steam brush cover and rinse it thoroughly with water.



## Cleaning the Used Water Tank

1. Remove the Used Water Tank from the main body and empty the Used Water Tank. Rinse the Used Water Tank with clean water.

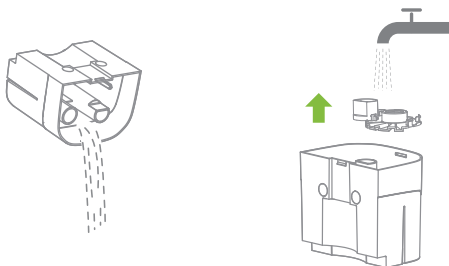

2. Wipe the appliance with a dry cloth or wet tissue.

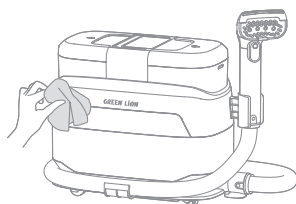

### Note:

It is recommended to carry out a descaling every 6-3 months to optimize steam performance. Mix the citric acid cleaning agent with water at a 1:20 ratio, and pour it into the clean water tank. Please remove any accessories attached to the hose, then turn on the machine and spray water out totally. Afterward, the inner descaling is completed.

## Troubleshooting

If an error occurs, the appliance will stop working. Please refer to the following table for troubleshooting. If the problem persists, please contact customer service

Error	Possible Cause	Solution
The appliance does not work.	The plug is not plugged to the power socket.	Be sure the power cord plug is fully plugged into outlet.
	The power cord is damaged.	Please contact customer service.
No water comes out or little water comes out after pressing the water-spray button.	Standard stain brush nozzle is blocked.	Clear the standard stain brush.
	The handle or the pump has been damaged.	Please contact customer service.
No suction or weak suction power.	The appliance is not on.	Turn on the power.
	The Used Water Tank is full.	Empty the Used Water Tank.
	The extension hose is not in good status.	Check the extension hose to make sure it is in well status.
	The filter in Used Water Tank is blocked.	Clean or replace the filter in time.
Reminding dirty water tank is full but it is not	The sensor of the dirty water tank may be blocked by dirt.	Please clean the sensor of dirty water well.

## Specifications

Model No.	GL-SC18
Material	ABS
Motor Power	450W
Heating Power	1200W
Voltage	220-240V
Frequency	60/50Hz
Noise Level	<= 82 dB
Heating Temperature	60°C
Steam Temperature	>=100°C
Suction Power	12 kPa
Air Flow	10 l/s
Clean Water Tank Capacity	1250 ml
Dirty Water Tank Capacity	900 ml
Waterproof	IPX4
Power Cord	UK Plug, 4 meters
Hose Length	1.2 meters
Product Weight	5.5 kg
Product Size	33.8×23.2×28.5 cm

## Disposal

This product must not be disposed of as unsorted household waste. It is important to separate such waste for proper treatment and recycling, in compliance with local waste management regulations.

## Warranty

This **Green Lion** product comes with a 12-month warranty when purchased from our website, official store, or approved sellers.

To extend the warranty, please visit **<https://www.greenlion.net/warranty>** and fill out the form with your product details. Make sure to upload a clear picture of the product.

After we review and approve your request, you will receive a confirmation email stating that your product's warranty has been extended.

For more info, please check:

**<https://www.greenlion.net/warranty>**

## Contact Us

If you have any questions about this Privacy Policy, please contact us at:

Website: **<https://www.greenlion.net/>**

Sales: **[sales@greenlion.net](mailto:sales@greenlion.net)**

Service Support: **[Support@greenlion.net](mailto:Support@greenlion.net)**

Telegram: **[@greenlion\\_global](https://t.me/greenlion_global)**

Instagram: **[@greenlion\\_global](https://www.instagram.com/greenlion_global)**