



Green Lion

MEN'S SHAVER X

SKU: GNMEN45SHVSL

Model No: GL-TM45

Table of Contents

| | |
|--------------------------------|---|
| Safety Warnings | 2 |
| Schematic View | 3 |
| Specifications | 3 |
| Instructions for Use | 4 |
| Travel Lock Function | 5 |
| Maintenance Guide | 6 |
| Troubleshooting | 7 |
| Environmental Protection Notes | 7 |
| Removing the Battery | 8 |
| Warranty | 8 |
| Contact Us | 8 |

Thank you for choosing our product. Before using the appliance, please read this user manual carefully to ensure proper use. Keep it in a safe place for future reference. Adhering to these instructions will help optimize the product's performance and extend its lifespan.

Safety Warnings

Danger: Always keep the charging cable dry.

- 1.** Before connecting the product, ensure that the voltage marked on the product matches the local power supply voltage.
- 2.** Avoid charging the product continuously for extended periods. Do not charge the product when the temperature is below 0°C or above 40°C, as this can reduce the battery's lifespan.
- 3.** Only use the provided charging cable for this product. Do not use any accessories that were not supplied by our company.
- 4.** If the power cord is damaged, it must be replaced with a compatible cord or component obtained from the manufacturer or an authorized service center.
- 5.** To clean the product, use a soft cloth and a mild, neutral detergent. Avoid using alcohol, gasoline, or other chemicals to clean the appliance.
- 6.** If you notice any abnormal conditions (such as unusual odors, temperature changes, or unusual sounds) during charging or use, immediately disconnect the power supply and stop using the product. Address the issue and, if needed, contact a service center.



Schematic View

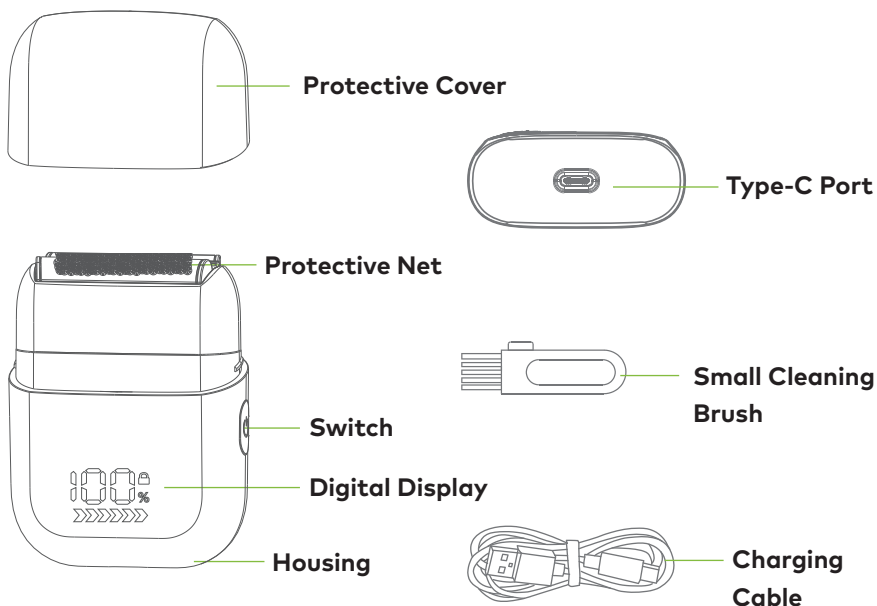

Specifications

| | |
|-----------|-------------------|
| Model No | GL-TM45 |
| Material | ABS |
| Blade | Stainless Steel |
| Motor | FF-150SH DC Motor |
| Power | 5W |
| RPM Range | 7500 RPM |
| Battery | 900mAh |

| | |
|--------------------|-------------|
| Waterproof | IPX7 |
| Charging Port | Type-C |
| Charging Time | 1.5 Hrs |
| Working Time | 100 min |
| Product Weight | 131 g |
| Product Dimensions | 31*62*86 mm |

Instructions for Use

1. To charge the product, connect the TYPE-C end of the charging cable to the product's charging port. Then, plug the other end of the cable into the charger.

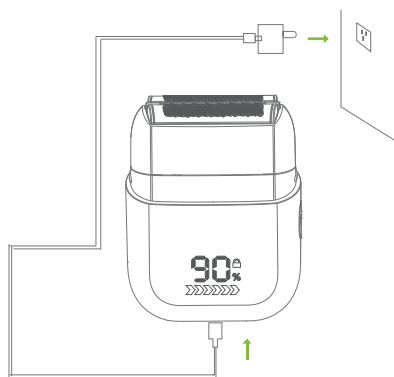

2. Turn on the power supply. The digital display will show the current battery percentage, and the indicator lights will cycle from left to right.

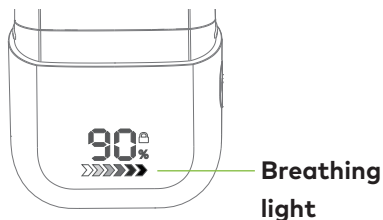

3. The product will fully charge in approximately 1.5 hours. After 5 seconds, the indicator lights will turn off, and the digital display will show "100," indicating a full charge. The product can be used continuously for more than 120 minutes.



4. When shaving, move the shaver slowly against the direction of hair growth. Make sure to move it straight and gently back to achieve an effective shave.

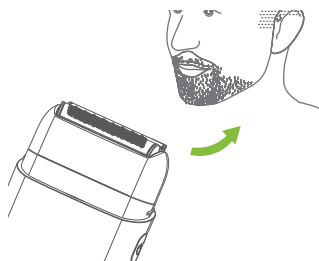

Travel Lock Function

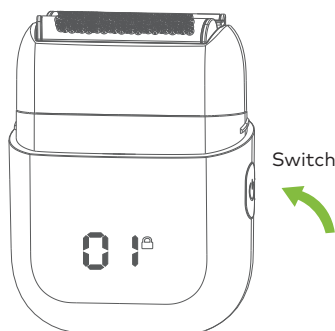

1. To unlock the travel lock, press and hold the button for 3 seconds. The digital display will show a countdown (1,2,3). The " " sign (red light) will flash 3 times and then turn off. The device can be turned on directly after unlocking.

2. To activate the travel lock, press and hold the button for 3 seconds. The digital display will show a countdown (1, 2, 3). The "🔒" logo will flash 3 times and then turn off, indicating the travel lock is activated.

Maintenance Guide

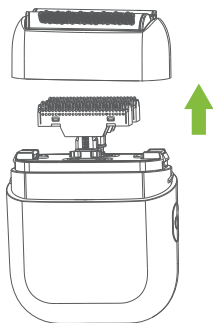

1. When the shaver is powered off, remove the head cover by pulling it upward.

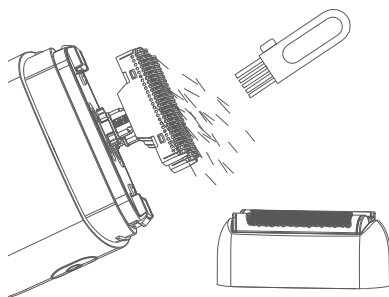

2. Use a small brush to clean the hair on the cutter head.

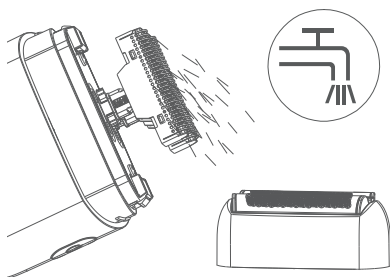

3. This machine is waterproof and can be rinsed directly under the tap.

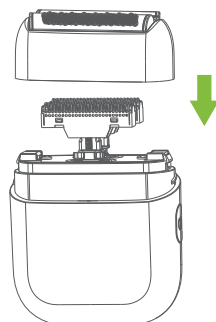

4. After cleaning, securely place the net cover back onto the machine.

Troubleshooting

| Problem | Possible Cause | Solution |
|---|--|--|
| Not sharp, weak rotation, and few usable times. | The blade mesh may be damaged, dirty, or the battery may be low. | Replace the blade mesh, clean the unit, and charge it. |
| Unable to charge or power on. | The shaver or adapter may be damaged, the battery may be depleted, or there may be a switch failure. | Charge the product. If the issue has not resolved, send the product to a service center. |
| The running water light does not illuminate. | The flow light or circuit may be malfunctioning. | Send the product to a service center. |

Environmental Protection Notes



The built-in rechargeable battery contains materials that may harm the environment. Before disposing of the shaver, ensure that the battery is removed, or send the shaver to an official recycling station for proper disposal. Alternatively, you can send the discarded electric shaver to the company's designated maintenance department, where the battery will be safely recycled.

Removing the Battery

To remove the battery, turn off the power and allow the shaver to run until the battery is fully drained. Unscrew all screws on the shaver, remove the plastic parts, and then take out the battery. Do not attempt to charge the battery after removal.

Warning: Rechargeable batteries should only be removed when discarding the shaver.

Warranty

Products that you buy directly from our **Green Lion** website or shop come with a 24-month warranty.

When you buy **Green Lion** products from any of our approved sellers, you only get a 12-month warranty. If you want to extend this warranty, go to our website at <https://www.greenlion.net/warranty> and fill out the form with your information. Don't forget to upload a picture of the product too. After we've checked and accepted your request, we'll send you an email to confirm that your product's warranty has been extended.

For more info, please check:
<https://www.greenlion.net/warranty>

Contact Us

If you have any questions about this Privacy Policy, please contact us at:

Website: <https://www.greenlion.net/>

Sales: sales@greenlion.net

Service Support: Support@greenlion.net

Telegram: [@greenlion_global](https://t.me/greenlion_global)

Instagram: [@greenlion_global](https://www.instagram.com/greenlion_global)