

**PORODO**  
LIFESTYLE



**Porodo Lifestyle**  
**Full-Body Grooming Kit**

SKU: PDLFST186

# Table of Contents

Product Overview	2
Warning Before Use	2
Usage Guide	3
Safe Operating Instructions	4
Display and Charging Instructions	5
Cleaning and Maintenance	5
Environmental Protection	6
Specifications	6
Warranty	7
Contact Us	7

## Product Overview

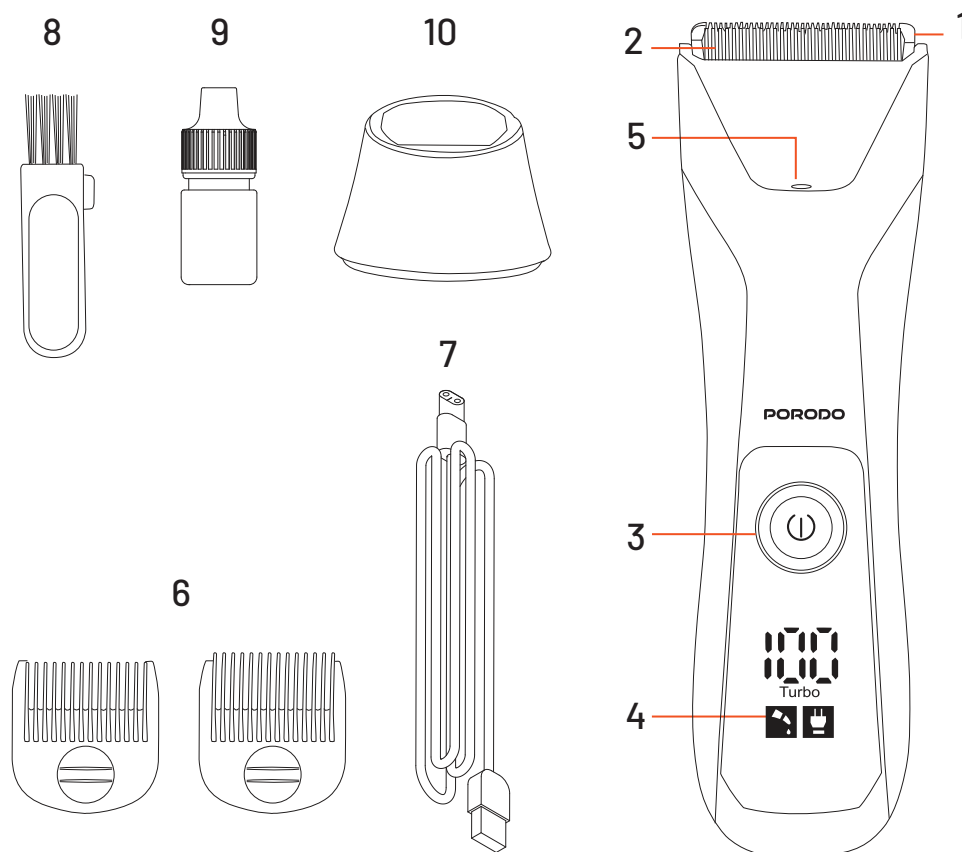

- |                          |                       |
|--------------------------|-----------------------|
| 1. Stainless Steel Blade | 6. Cut-Guide Combs    |
| 2. Ceramic Blade         | 7. USB Charging Cable |
| 3. ON/OFF Switch         | 8. Cleaning Brush     |
| 4. LCD Display           | 9. Oil Bottle         |
| 5. Indicator             | 10. Charging Base     |

## Warning Before Use

1. Prior to using this appliance, carefully read the user manual and retain it for future reference.
2. This appliance is not intended for use by individuals (including children) with limited physical, sensory, or mental capabilities, or those lacking experience or knowledge, unless they have received proper instruction or supervision on how to safely operate the appliance from a responsible person.

3. Children should be supervised to ensure they do not play with the appliance.
4. Do not use the trimmer or any damaged parts, as this may cause injury. If any parts are damaged, replace them with original components of the same model.
5. Never use compressed air, scouring pads, abrasive cleaning agents, or harsh liquids such as petrol or acetone to clean the appliance.
6. Do not soak the appliance in water, and avoid using it when water is being sprayed during a shower.
7. Always unplug the trimmer before cleaning it.

## Usage Guide

1. The trimmer head can be easily opened for cleaning, as shown in the images (refer to Fig. 1 - Fig. 2).

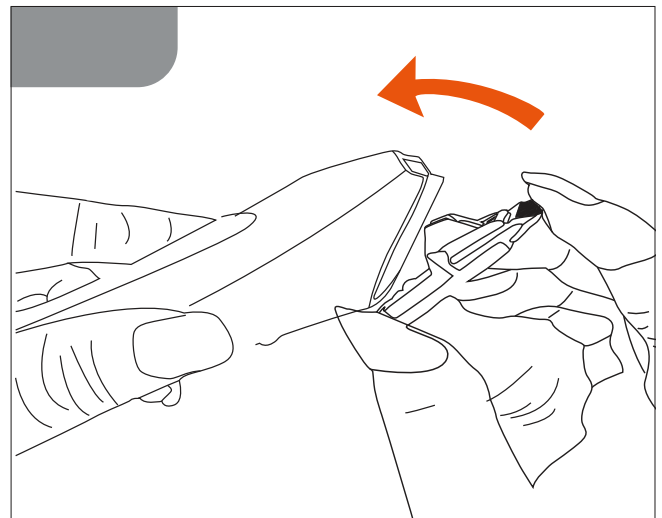
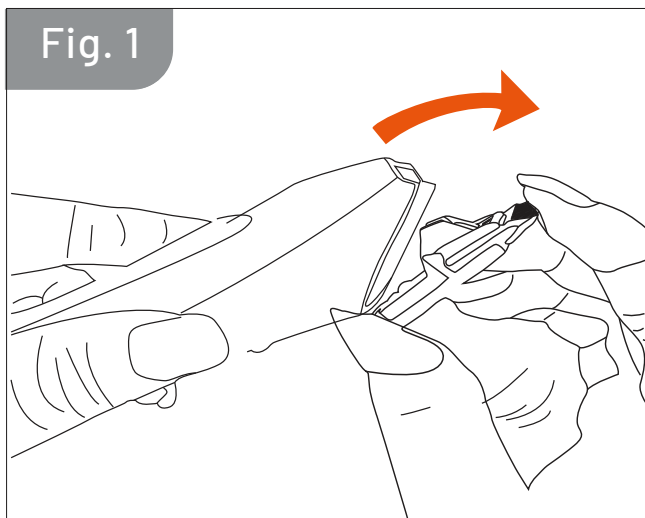

2. Choose the detachable guide combs to achieve your desired hair length. Two guide comb sizes are provided: 2/3/4mm and 6/7/8mm.
3. Attach the limit comb to the cutting blade by inserting it into the groove at the head of the blade (refer to Fig. 3 - Fig. 6).

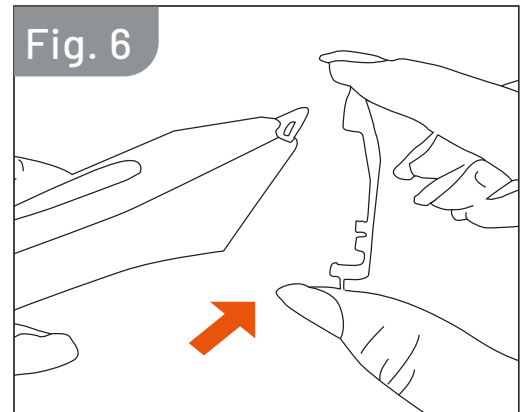
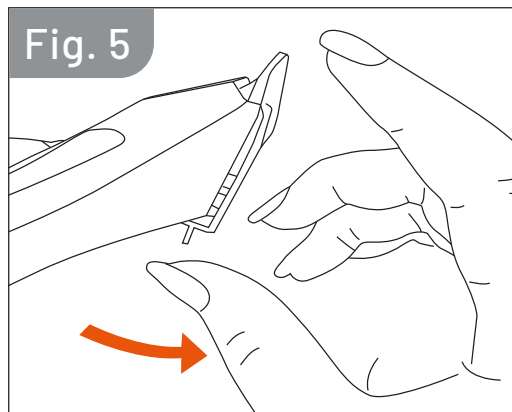
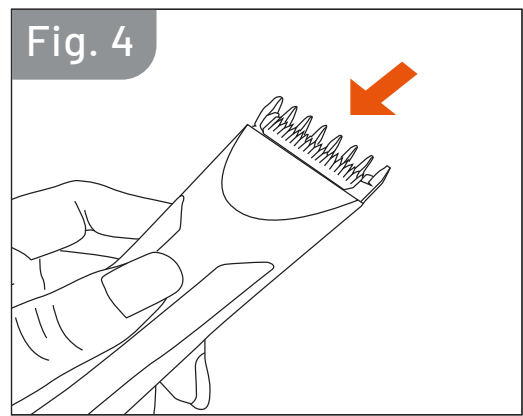
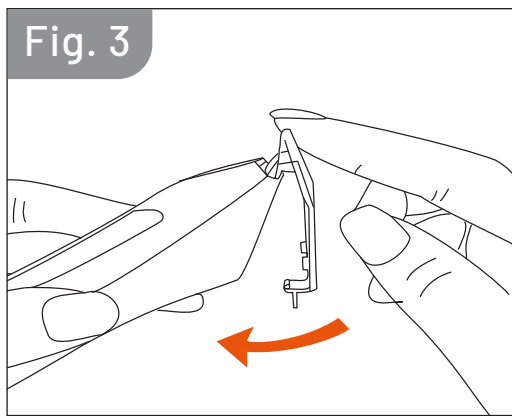

- 4.** Press the On/Off button once to turn on the trimmer.
- 5.** Press the button again to activate the spotlight feature.
- 6.** Gently move the trimmer along your skin, ensuring you stretch the skin when trimming sensitive areas.
- 7.** Press the On/Off button to turn off the trimmer.
- 8.** Follow the cleaning and maintenance instructions provided in the manual.
- 9.** Press and hold the button for five seconds to activate or deactivate the travel-lock feature.

## Safe Operating Instructions

- 1.** Gently stretch the skin and proceed with slow, careful shaving.
- 2.** When trimming sensitive areas, ensure the stainless steel blade is parallel to the skin, with the blade tip aligned in the same direction.
- 3.** If prone to ingrown hairs or follicle issues, trim in the direction of hair growth to minimize the risk of bleeding, follicle damage, and skin the charging cable.

irritation. If these concerns are not applicable, trim against the direction of hair growth.

**4.** For safety purposes, the device cannot be operated while connected to

## **Display and Charging Instructions**

- 1.** Ensure the trimmer is turned off before charging.
- 2.** Use the provided USB charging cable and charging base. Insert the small plug into the trimmer and connect the other end to a USB adapter (not included).
- 3.** The LCD display will show a flashing charging symbol along with the battery percentage. A full charge takes approximately 2 hours, providing 1.5 hours of use. Note: The trimmer cannot be turned on while charging.
- 4.** When the battery is low, the charging indicator will flash, signaling that the trimmer needs to be charged.
- 5.** If the trimmer has been used continuously for more than 20 minutes, a lubrication reminder will appear. You may ignore this reminder or turn off the trimmer to lubricate the blade.
- 6.** To activate the travel-lock mode, press and hold the switch button for 5 seconds. To deactivate, press and hold the switch button again for 5 seconds.

## **Cleaning and Maintenance**

- 1.** Begin by removing the guide comb and sliding the trimmer head downwards to detach it from the main body.
- 2.** Use the cleaning brush to remove any hair from the trimmer, brushing up and down along the blades.
- 3.** Rinse the hair chamber under running water for approximately 10 seconds.
- 4.** Align the trimmer head with the notch and press down until it clicks into place.
- 5.** This appliance has an IPX7 waterproof rating, meaning it can resist water splashing. However, it should not be fully immersed in water.

Tips: To maintain optimal trimming performance, lubricate the blades with 1-2

drops of sewing machine oil weekly or monthly, depending on your usage frequency.

## Environmental Protection

- 1. The built-in rechargeable battery contains environmentally harmful substances. When disposing of the product, always remove the battery and send it to an official designated recycling center.
- 2. Disconnect the power cord from the appliance before removing the battery.
- 3. Turn on the power switch and leave it on until the battery is completely discharged.
- 4. Dispose of the battery in a safe and responsible manner.

## Specifications

Input	5V/1A
Rated Power	5W
Battery Capacity	600mAh
Charging Time	2H
Working Time	1.5H
Charging Interface	USB-C & Charging Base
Water-Resistant Level	IPX7
Net Weight	167g
Product Size	110 x 43 x 55mm
Model Number	LFS186

## **Warranty**

Products that you buy directly from our **Porodo** website or shop come with a 24-month warranty.

When you buy **Porodo** products from any of our approved sellers, you only get a 12-month warranty. If you want to extend this warranty, go to our website at **porodo.net/warranty** and fill out the form with your information. Don't forget to upload a picture of the product too. After we've checked and accepted your request, we'll send you an email to confirm that your product's warranty has been extended.

For more info, please check:  
**porodo.net/warranty**

## **Contact Us**

If you have any questions about this Privacy Policy, please contact us at:  
**info@porodo.net**

Website: **porodo.net**

Service Support: **support@porodo.net**

Instagram: **porodo**