

PORODO
LIFESTYLE



Porodo Lifestyle
**Retro Thermometer Steam
and Heat Iron**

SKU: PD-LFST116

Table of Contents

Schematic View	2
Important Notes Before Use	2
Instructions for Use	3
Safety Precautions	5
Cleaning and Maintenance	7
Specifications	8
Disposal	8
Warranty	9
Contact Us	9

Schematic View

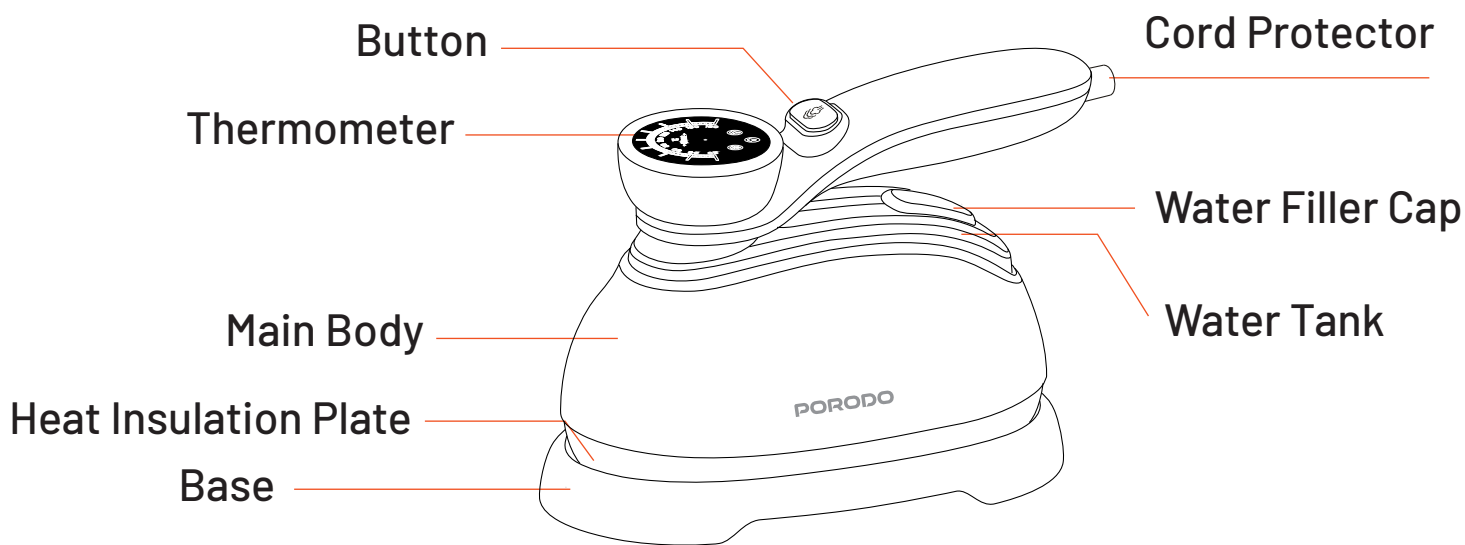

Important Notes Before Use

1. Remove any labels or protective covers from the product, and ensure the wires are properly straightened before use.
 2. For the first use, allow the product to sit for a few minutes. This will help eliminate any impurities or odors left from the manufacturing process.
 3. To prevent overloading the circuit, it is advised not to operate other appliances on the same socket.
 4. Upon unpacking, verify that all items and parts listed are present and avoid discarding any components.
 5. Since the temperature of this product is not adjustable, the panel thermostat is set to heat to approximately 160°C.
 6. Before using, check the clothing label for fabric composition and the maximum tolerable temperature range. If there is any uncertainty regarding the fabric's heat tolerance, it is recommended to first iron a towel as a test before ironing the garment itself.
- Tip:** Always iron on the base and ensure the steam switch is turned off to prevent burns from the high temperature.

Instructions for Use

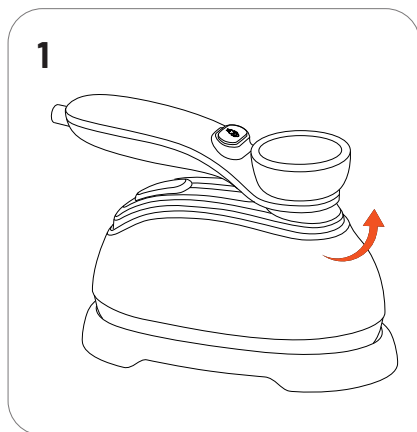

Turn the handle clockwise.

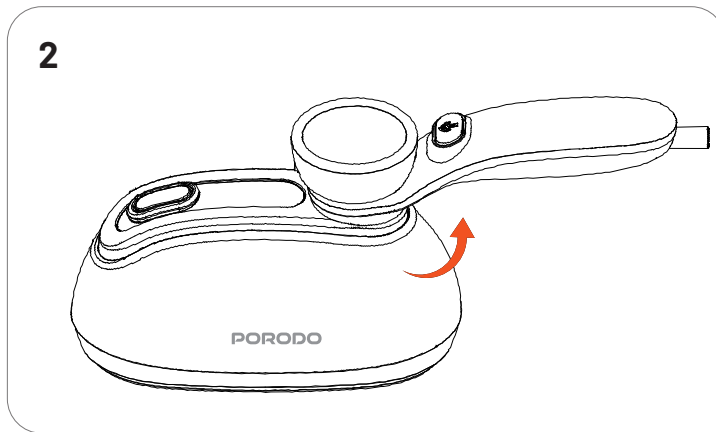

Rotate the handle 180° to open.

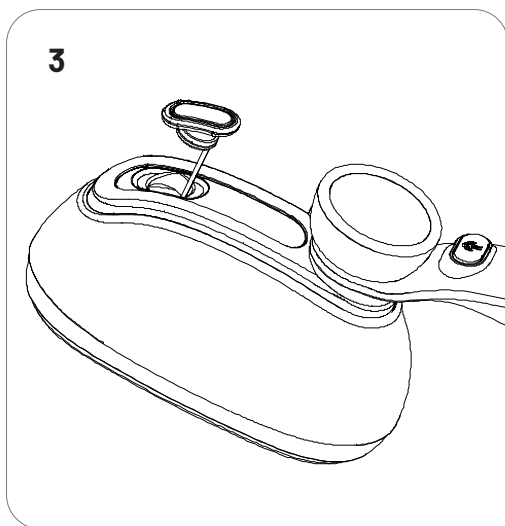

Open the tank filler plug.

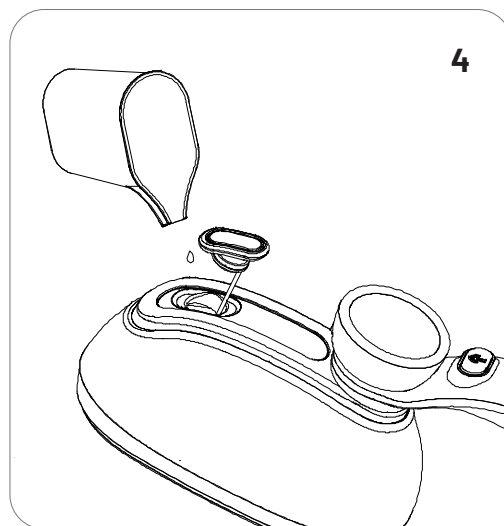

Fill the tank with water using a cup, ensuring not to overflow the tank.

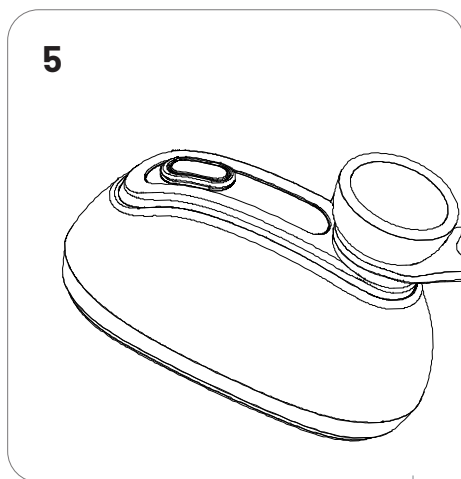

Close the water filler cap after filling with water.

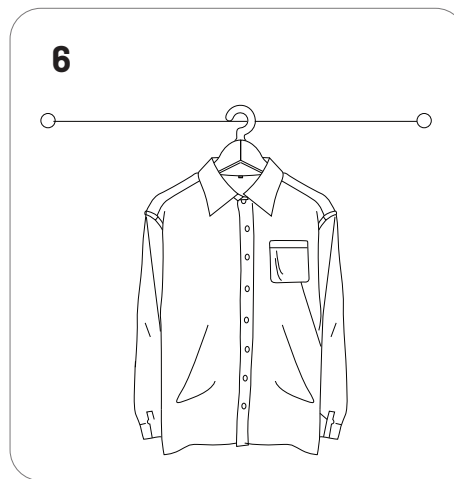

Hang clothes to be ironed on hangers.

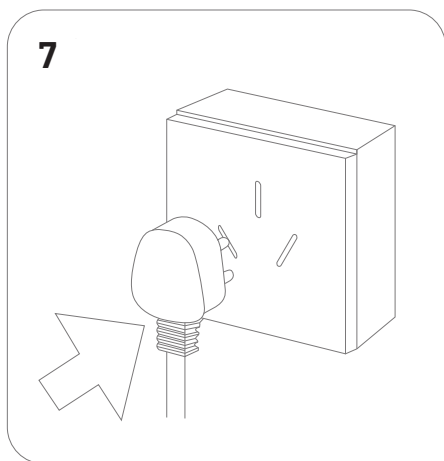

Plug the device in.

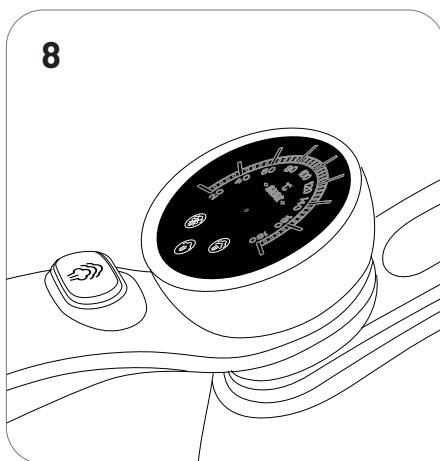

Start the warm-up countdown. The steam button will flash three times to indicate that preheating is complete.

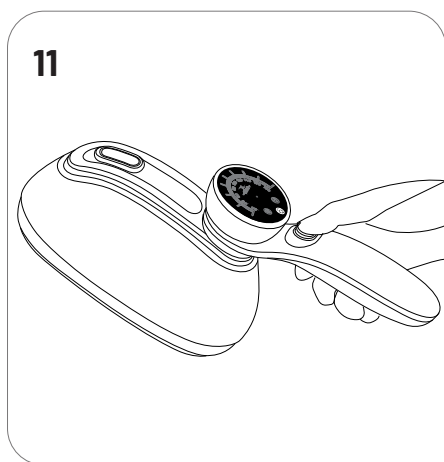
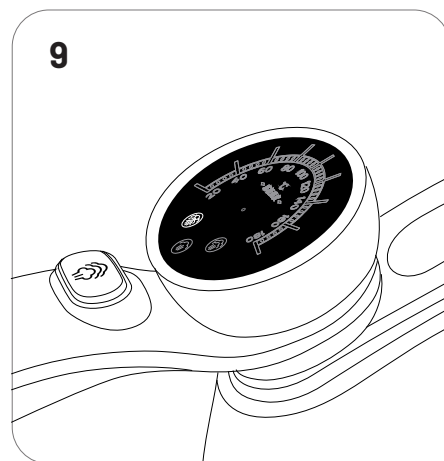

Tap the steam button.

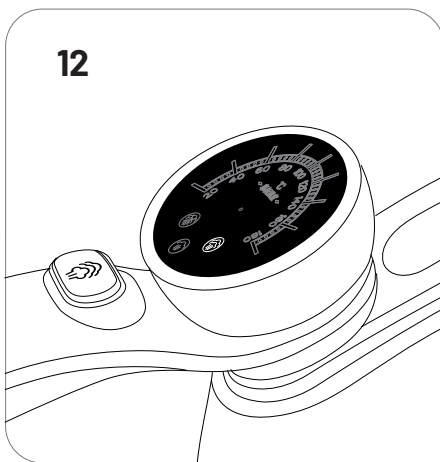

Select the high-grade setting.

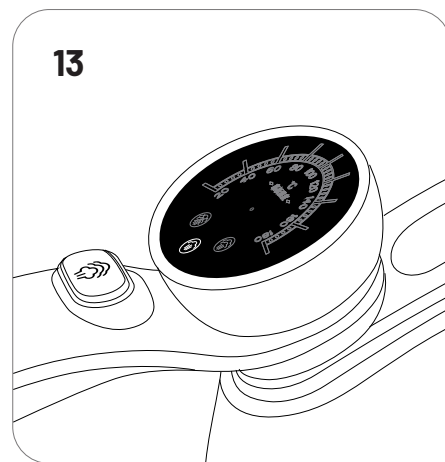

Select the low-grade setting.

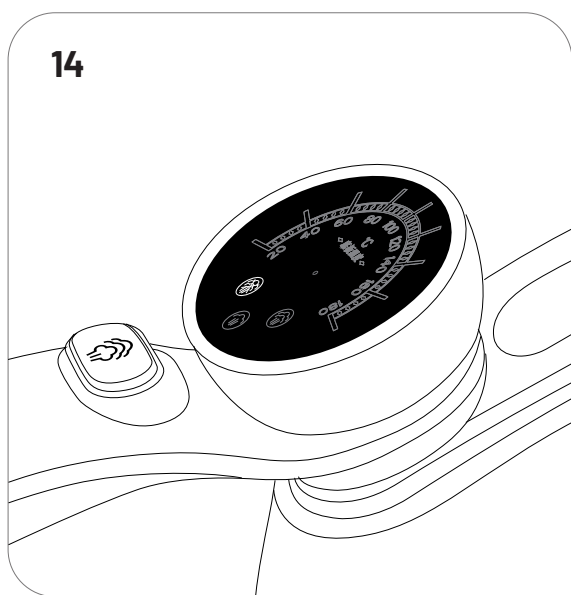

Use the dry ironing mode.

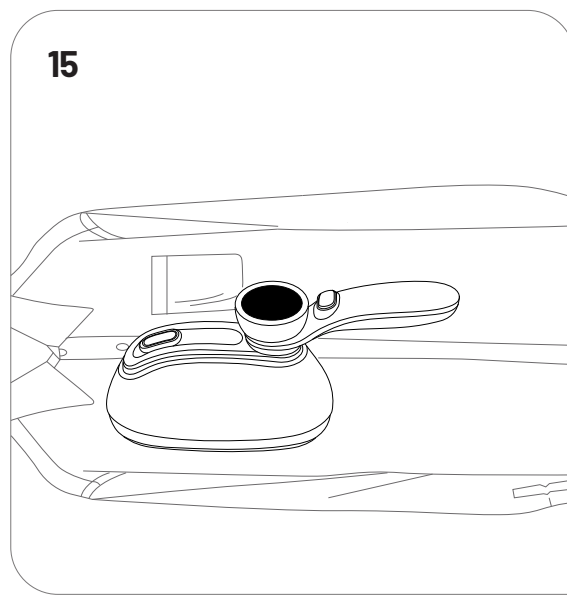

For better ironing results, please iron from top to bottom.

Safety Precautions

1. Before use, please read this instruction manual carefully.
2. Before use, ensure that the voltage required for this product matches the voltage in your home. If the product has a grounding plug, it must be plugged into an outlet with a grounding wire.
3. Do not use the product outside of its intended range of use.
4. Use the portable iron according to the functions for which it was designed.
5. This product is not intended for use by persons (including children) who are physically or mentally impaired or who lack experience and knowledge of the operation of this product, unless they are supervised and instructed in its use by a responsible person.
6. Do not allow children to play with this product.
7. Do not leave the user while the portable iron is switched on.
8. Do not leave the portable iron in a place accessible to children when the temperature of the portable iron has not cooled down.
9. Carefully supervise children when using near them.
10. The portable iron must be used and placed on a stable surface.
11. When the portable iron is placed on a stand, ensure that the flat surface on which the stand is located is smooth and reliable.
12. Never pour vinegar or other cleaning agents into the water reservoir.
13. The use of chemical additives, flavors, or descaling agents is prohibited.
14. For pressure steam irons: Do not open the water filler when in use.
15. For steam irons and irons equipped with a water jet: the power cord must be unplugged from the socket before filling the water tank. When temporarily stopping work after ironing, place the portable iron on its base and unplug it from the mains.
16. Before inserting or removing the plug, ensure the switch is set to the off position. Do not pull the power cord violently when in use.
17. To disconnect the power supply, grasp the plug and pull it out from the power supply.

- 18.** Do not use the product again if it has been dropped, or if visible damage or leakage is present.
- 19.** Avoid immersing the portable iron in water or other liquids.
- 20.** Do not handle the product with wet hands.
- 21.** Keep the product away from rain or direct sunlight.
- 22.** Hot water or steam can cause burns if the heating plate is touched. Exercise caution when handling the hot water tank, and be aware of the risk of scalding from hot water when the tank is inverted.
- 23.** The steam released from the portable iron is very hot. To prevent burns, never direct the steam toward your body.
- 24.** Do not hang the power cord from the edge of a table or allow it to touch any heat-generating surfaces. Improper assembly may result in an electrical hazard when the product is in use.
- 25.** To prevent overloading the circuit, avoid using other high-power electrical appliances on the same socket. If an extension cord is necessary, ensure it is rated for at least 10A. Using a cord with a lower rating may lead to excessive heat buildup and increase the risk of fire.
- 26.** To extend the product's lifespan, always store the iron on its base.
- 27.** Keep this instruction manual in a safe location for future reference.
- 28.** When using the appliance, take care to prevent injury from steam splashes.
- 29.** Always unplug the appliance from the mains before filling or cleaning.

Attention

- 1.** For heat-sensitive fabrics, place a cloth over the fabric and iron through it to prevent deformation or damage.
- 2.** When ironing blended fabrics, begin with the fiber that is less heat-resistant to avoid damage to the other fibers.
- 3.** When ironing clothes made of different fabrics, always iron the less heat-resistant fabric first.

Cleaning and Maintenance

- 1.** Switch off and unplug the iron from the mains and allow it to cool down.
- 2.** Turn the portable iron upside down and shake it gently to pour out any remaining water from the water tank and soleplate.
- 3.** After five minutes of heating, press the push button to release any remaining water from the water tank and soleplate.
- 4.** Switch off and unplug the iron from the mains. Place the portable iron on its base and allow it to cool down.
- 5.** Wipe the bottom and other parts of the iron with a soft cloth.
- 6.** For more stubborn stains, do not use water. Instead, use a soft cloth with a neutral detergent.
- 7.** Any deposits or starch substances adhering to the soleplate can be cleaned with a damp cloth or non-abrasive liquid detergent.
- 8.** Avoid wiping the base plate with a wire or metal-type cleaner. Plastic parts can be cleaned with a damp cloth and then wiped with a non-abrasive wipe.
- 9.** Store the power cord in a ventilated and cool place.
- 10.** Removing Limescale: Due to the high mineral content in water from many areas, sediment buildup is a common problem with steam irons. Mineral residues may cause steam to be emitted intermittently or prevent it from emitting altogether.

The following methods are effective in minimizing sediment buildup. If you are not using mineral-free or purified water, we recommend cleaning out the sediment on a monthly basis by following these steps:

- 10.1** Mix 50% vinegar with 50% water and pour it into the water tank.
- 10.2** Turn on the power, press the steam switch, and allow the mixture to enter the heating body. Unplug the iron and wait for 40 minutes.
- 10.3** Pour out the remaining mixture in the tank and add water.
- 10.4** Turn on the power, press the steam switch, and let the water enter the heating body.
- 10.5** Repeat several times until the sour smell in the machine is cleared.

11. If the machine cannot be started even after cleaning, it may need to be repaired.
12. Allow the iron to cool in a cool and dry place after cleaning.

Specifications

Material	ABS, PC
Rated Voltage	220-240V
Rated Frequency	50/60Hz
Power	1200W
Water Tank Capacity	160ML
Steam Output	20±3g/min
Temperature Levels	20°C to 180°C
Power Cord	UK 3-Pin Plug
Cord Length	1.7m
Product Weight	1000g (with Base & Water Cup)
Product Size	150 x 99 x 215mm (with Base)
Model Number	LFS116

Disposal

This product must not be disposed of as unsorted household waste. It is important to separate such waste for proper treatment and recycling, in compliance with local waste management regulations.

Warranty

Products that you buy directly from our **Porodo** website or shop come with a 24-month warranty.

When you buy **Porodo** products from any of our approved sellers, you only get a 12-month warranty. If you want to extend this warranty, go to our website at **porodo.net/warranty** and fill out the form with your information. Don't forget to upload a picture of the product too. After we've checked and accepted your request, we'll send you an email to confirm that your product's warranty has been extended.

For more info, please check:

porodo.net/warranty

Contact Us

If you have any questions about this Privacy Policy, please contact us at:

info@porodo.net

Website: **porodo.net**

Service Support: **support@porodo.net**

Instagram: **porodo**