



Green Lion

Palermo Gimbal

SKU: GNPALXV4GMLWH

Model No: GL-PX51

Table of Contents

Product List	2
Charging	3
Q&A	4
Product Introduction	5
Handheld dolly shot mode	6
AI tracker Mode	8
Indicator Description	11
Gesture Introduction (AI Tracking Mode)	12
Power Button Description	12
Remote Controller Description	13
Specification	15
Mobile Clip Light Controls	16
FCC Compliance Statement	17
Disposal	18
Warranty	19
Contact Us	19

Product List

Before using this product, please carefully check whether the product package contains the following items. If anything is missing, please contact customer service or the brand agent.



Palermo Gimbal



USB-C Cable x 1

Charging

Stabilizer Charging

Use the USB-C charging cable provided in the package to connect the power adapter to the charging interface of the stabilizer phone clip.

Low battery: red light blinking

Charging: red light blinking

Fully charged: red light constant on



Indicator light



What functions does this product have?

This AI single-axis stabilizer supports two functions: Selfie and face tracking. Different functions require different product postures. Please follow the detailed instructions below to adjust the product posture before shooting.

Why can't I start tracking using gestures?

1. Confirm that the phone holder buckle is unlocked.
2. Make sure the gesture is standard and keep for 3-1 seconds.
3. Make Sure the environment is bright and there is only one face on the phone screen.



Product Introduction

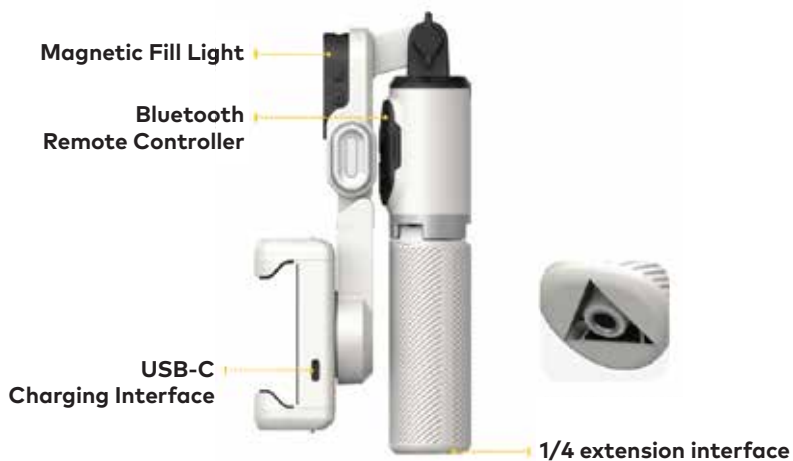
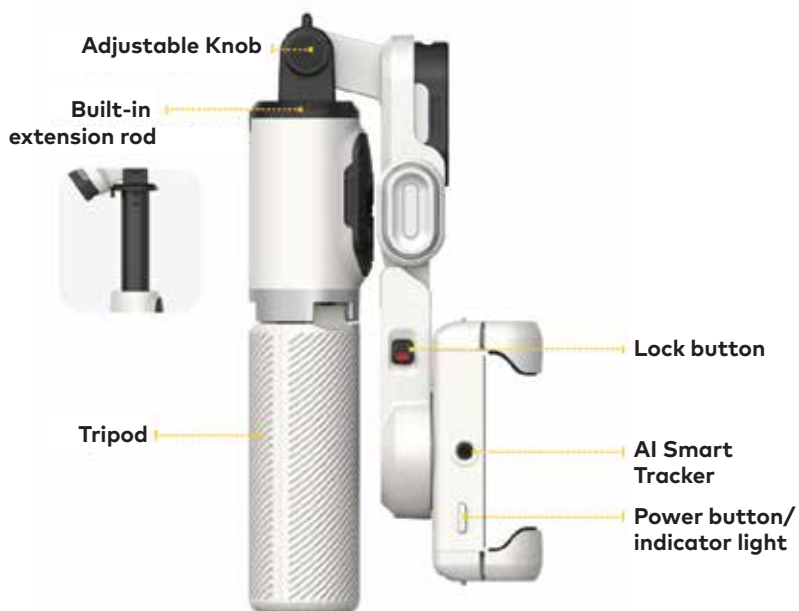

Handheld dolly Shot Mode

1. Hold and unfold Palermo Gimbal with both hands

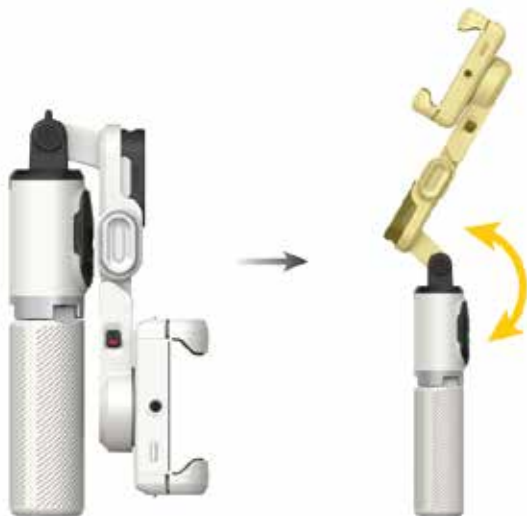

2. Rotate the phone Clip 180 degrees make the phone clip is on the front.

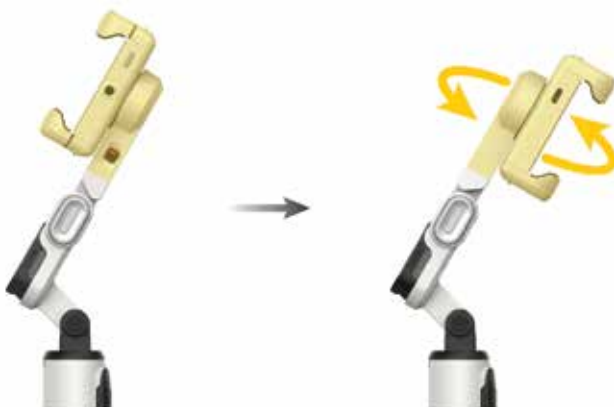

3. Turn on the lock button, put the phone in the center of the phone clip, horizontal and vertical panel can be installed. Note that the camera of the phone and the AI tracker keep the same direction when installing.



4. Long press the power button to turn on and use.

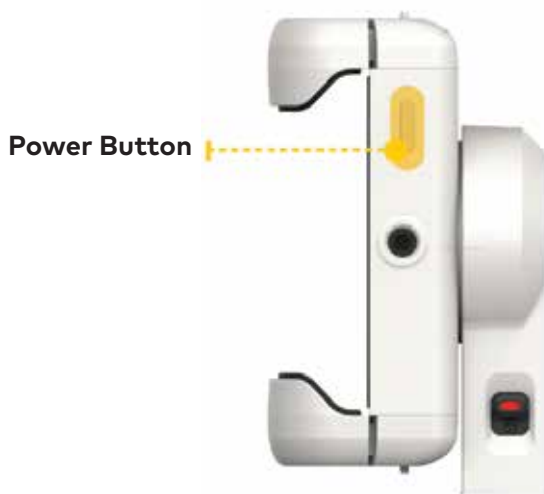

Attention:

Hold the Axis arm under the phone clip and stretch it upward to extend the built-in extension rod, and turn it back and forth to adjust the shooting angle.



AI tracking mode

1. Hold the Palermo Gimbal with both hands and unfold it completely press the axis arm against handle.

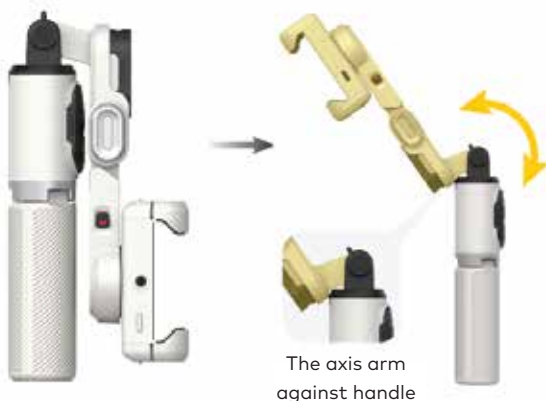

2. Hold the phone clip down make it horizontal

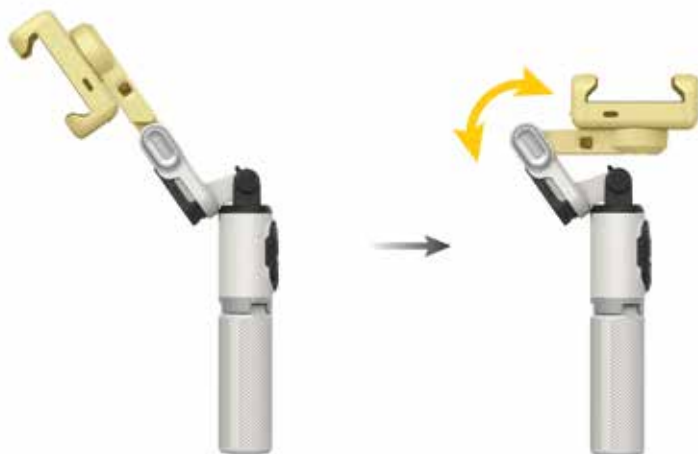

3. Hold the device axis arm and stretch upward to extend the built-in extension rod and place the device on the table

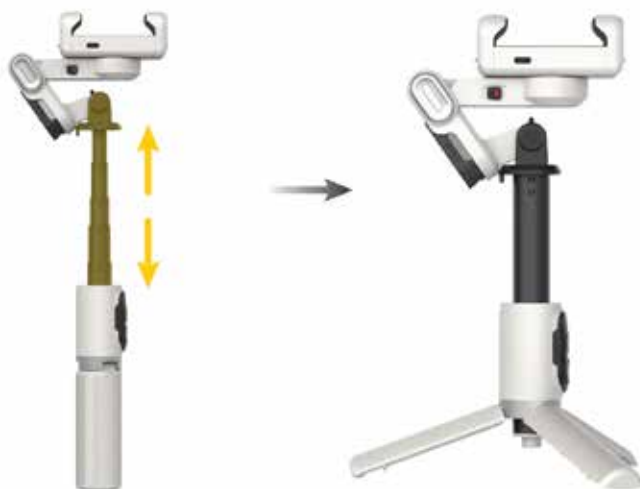

4. Turn on the lock button and rotate the phone clip make the AI tracker is facing forward.



5. Hold the phone clip and insert it directly into the phone. Both horizontal and vertical panels can be used.



6. Long press the power button to turn on and use.
(Showing the power button location on the device)



Indicator Description



Handheld Dolly Shot Mode

Blue Light	Power on Default
White Light	POV mode



AI Tracking Mode

Blue Light	Power on Default
Green Light Constant on	Locked Character (gesture function on)
Yellow Light Constant on	Locked Character (gesture function on)
Green Light Blinking	Unlocked Character

Gesture Introduction (AI Tracking Mode)



ok: Turn on tracking



Palm: Turn off Tracking



Both hands L: Turn on/ off gesture control

Power Button Description

You can use the power button to accomplish quick operations. The power button will have different functions in different modes.



Gimbal Power Button

Handheld dolly shot mode/ AI tracking mode	Long press: Power on/off
Handheld dolly shot mode	Single click: Switch to horizontal/ vertical panel
AI tracking mode	Single click: Turn on/off AI tracking

Remote Controller Description

Long press the shooting button on the remote controller to turn on the device. When the indicator light is blinking blue, turn on the Bluetooth setting on the phone, search for and connect to the Bluetooth "Gimbal." The indicator will turn off, indicating that the connection is successful.

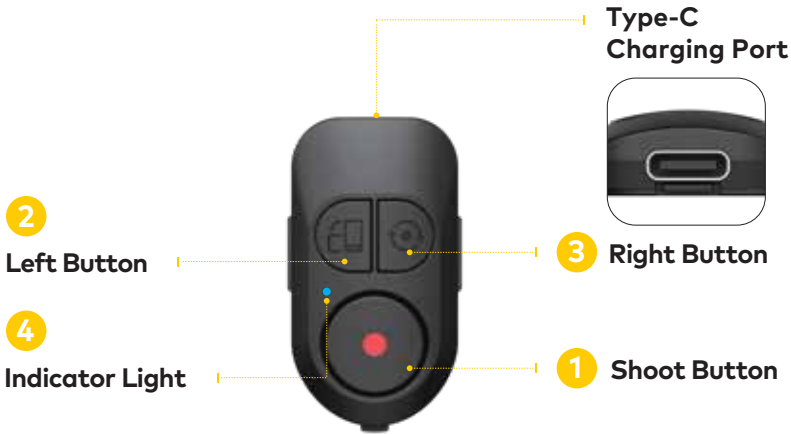

Shoot Button

Handheld dolly shot mode/ AI Tracking Mode	Long Press
	Single Click
AI Tracking Mode	Double Click
	Triple Click

Left Button

Handheld dolly shot mode	single click: Switch to horizontal/ vertical panel
	Double click: Center the phone/ exit POV/exit rotation
	Triple click: POV mode
Handheld dolly shot mode/ AI tracking mode	Long press: Adjust angle (turn left)

Right Button

Handheld dolly shot mode/ AI tracking mode	Single click: 200° automatic rotation
	Double click: 200° forward and reverse rotation twice
	Triple click: 360° infinite rotation
Handheld dolly shot mode/ AI tracking mode	Long press: Adjust angle (turn right)

Indicator Light

Power on (not connected to Bluetooth)	Blue light flashing
Power on (Bluetooth connected)	Blue light blinks 1 time each time the button is pressed
Fully charged (with power off)	Green light always on
Charging in progress (with power off)	Red light always on
Low power	Blue light blinks 3 times and then goes out

Specifications

Material	PC + ABS
Battery	1000mAh (Gimbal), 400mAh (Light), 40mAh (Remote)
Stabilization	Single Axis, 360° Rotation
Shooting Modes	L / POV / DM
Phone Holder Size	60–84 mm
Control & Connectivity	Bluetooth 10 ,5.2 m Range
Lighting	RGB Fill Light, 7 Colors
Charging Port	USB-C
Working Time	7 hrs (Gimbal), 2 hrs (Light), 30 days (Remote)
AI Tracking Mode	Up to 4 hrs
Load Capacity	350 g

Weight	280 g
Folded Dimensions	18*10*4.5 cm
Expanded Dimensions	4.5*17*100 cm

Mobile Clip Light Controls

Metal Plates on Mobile Clip

The fill light can be absorbed directly.



Power
Button

Long press: switch on/off

Single click: switch color (white/warm white/red/blue/green/purple/cyan)

Double click: gradually change to red/blue/green/purple/cyan



Mode
Button

Single click (single color mode): adjust brightness by three levels

Single click (gradual change mode): switch changing speed

Double click: blink slowly between red and blue



Charging
Indicator

Charging: Red light constant on

Fully charged: Green light constant on

FCC Compliance Statement

This device complies with part 15 of the FCC Rules. Operation is subject to the following two conditions:

This device may not cause harmful interference, and

This device must accept any interference received, including interference that may cause undesired operation.

Any changes or modifications not expressly approved by the party responsible for compliance could void the user's authority to operate the equipment.

Note:

This equipment has been tested and found to comply with the limits for a Class B digital device, pursuant to part 15 of the FCC Rules. These limits are designed to provide reasonable protection against harmful interference in a residential installation. This equipment generates uses and can radiate radio frequency energy and, if not installed and used in accordance with the instructions, may cause harmful interference to radio communications. However, there is no guarantee that interference will not occur in a particular installation. If this equipment does cause harmful interference to radio or television reception, which can be determined by turning the equipment off and on, the user is encouraged to try to correct the interference by one or more of the following measures:

Reorient or relocate the receiving antenna.

Increase the separation between the equipment and receiver.

Connect the equipment into an outlet on a circuit different from that to

which the receiver is connected.

Consult the dealer or an experienced radio/TV technician for help.

FCC Radiation Exposure Statement:

The device has been evaluated to meet general RF exposure requirements. The device can be used in portable exposure conditions without restriction.

Disposal

This product must not be disposed of as unsorted household waste. It is important to separate such waste for proper treatment and recycling, in compliance with local waste management regulations.



Warranty

This **Green Lion** product comes with a 12-month warranty when purchased from our website, official store, or approved sellers.

To extend the warranty, please visit **<https://www.greenlion.net/warranty>** and fill out the form with your product details. Make sure to upload a clear picture of the product.

After we review and approve your request, you will receive a confirmation email stating that your product's warranty has been extended.

For more info, please check:

<https://www.greenlion.net/warranty>

Contact Us

If you have any questions about this Privacy Policy, please contact us at:

Website: **<https://www.greenlion.net/>**

Sales: **sales@greenlion.net**

Service Support: **Support@greenlion.net**

Telegram: **[@greenlion_global](https://t.me/greenlion_global)**

Instagram: **[@greenlion_global](https://www.instagram.com/greenlion_global)**