

PORODO
LIFESTYLE



Porodo Lifestyle

Red Light Therapy Face Mask

SKU: PD-LFST099

Table of Contents

Technology Introduction	2
Package Contents	2
Controller Schematic	3
Instructions for Use	3
Indicator Light Guide	4
Safety Warning and Prohibitions	5
Specifications	5
Indicator Light	6
Disposal	6
Warranty	7
Contact Us	7

Thank you for purchasing the Spectrum Skin Rejuvenation Mask. Before using the mask, please read this manual carefully. Pay special attention to the safety instructions to ensure proper and safe operation.

This manual provides users with safe and effective usage guidelines. After reading, please keep it for future reference.

Technology Introduction

This product utilizes advanced light guide material technology and nanotechnology to generate various wavelengths of LED color light, including NIR, red, blue, orange, violet, cyan, green, and white light.

Package Contents

1. Face Mask
2. Straps
3. Controller
4. USB Cable
5. Eye Protector

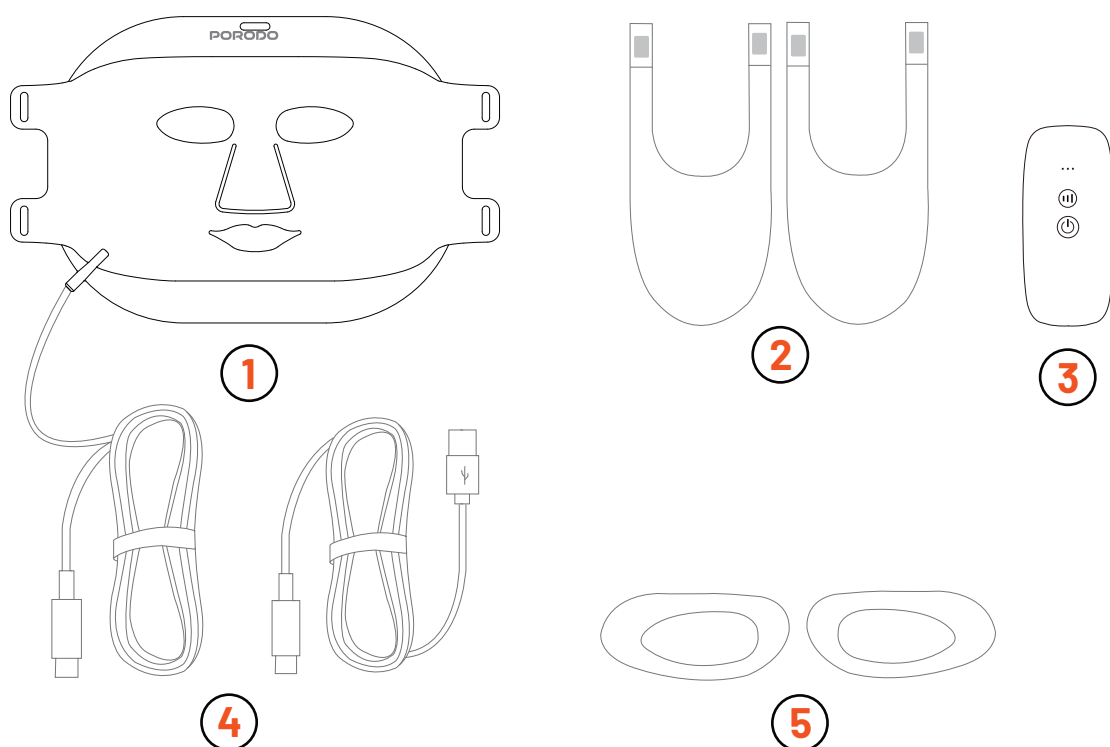

Controller Schematic

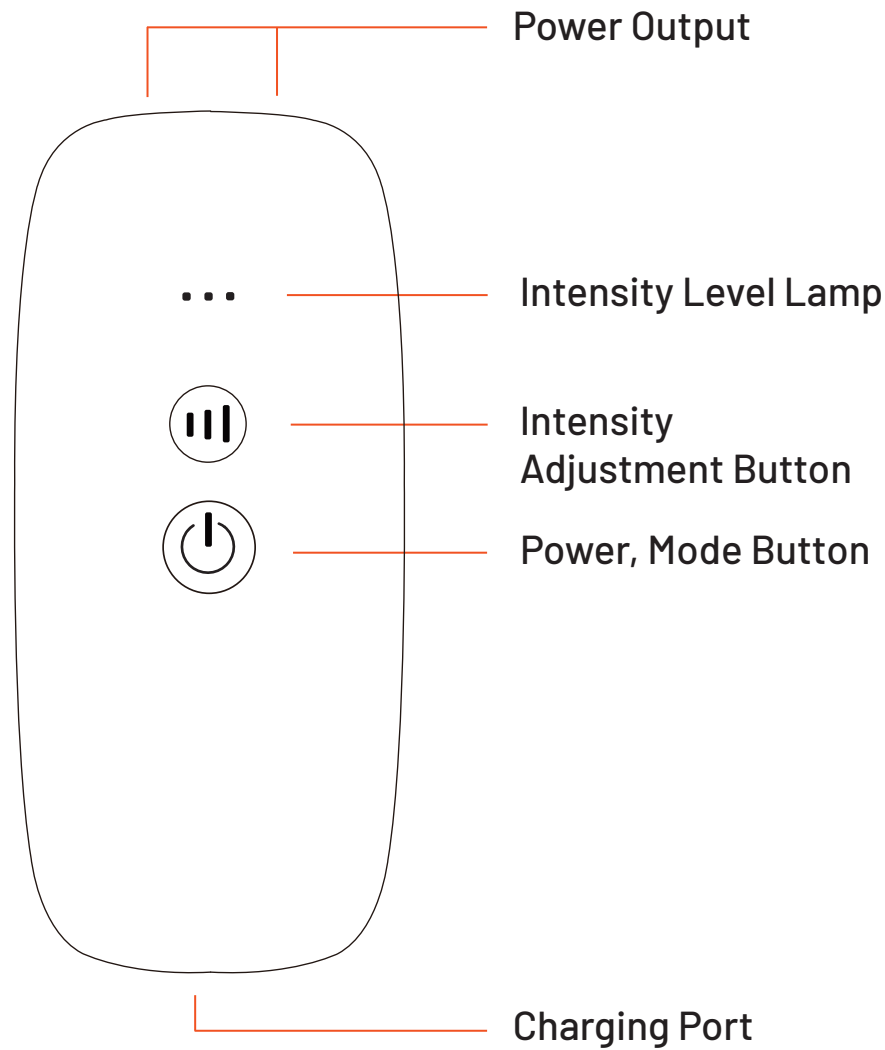

Instructions for Use



Step 1: Begin by removing any makeup and thoroughly cleansing your face.

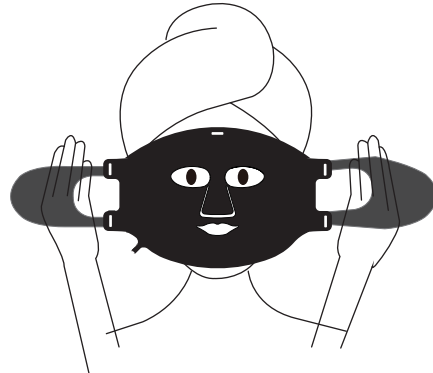

Step 2: Apply a mask or serum as needed. Then, secure the device onto your head using the Velcro straps for a comfortable fit.

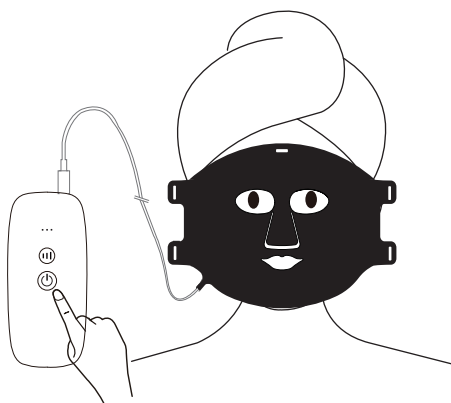

Step 3: Press and hold the power button for 3 seconds to turn on the device. It will automatically run for 21 minutes.



Step 4: Once the session is complete, remove the mask and apply a moisturizer to your skin.

Indicator Light Guide

on / off	Press and hold for 3 seconds to turn the device on and off.
Automatic mode	By default, the device starts in automatic mode. The program will automatically cycle through the following lights: NIR + red light for 3 minutes, blue light for 3 minutes, orange light for 3 minutes, violet light for 3 minutes, cyan light for 3 minutes, green light for 3 minutes, and white light for 3 minutes. The device will then automatically shut down.
Manual mode	In the working state, briefly press the function key to switch between different light modes. The selected light will run for 10 minutes and then automatically turn off.
intensity level	In the working state, briefly press the intensity key to adjust the intensity level. There are three levels of intensity to choose from.
Charging	When the indicator blinks, the device is in a low power state and needs to be charged. The indicator will light up red while charging, and when fully charged, all red lights will be on.
Operation	It is recommended to use the skin rejuvenation mask 3 to 5 times a week.

Safety Warning and Prohibitions

1. This product does not have fireproof functionality. Please keep it away from fire or corrosive liquids.
2. Do not disassemble or attempt to repair the product yourself.
3. Keep the product in a place that is out of reach of children.
4. This product is waterproof.
5. Avoid applying excessive pressure to prevent deformation or failure.

Specifications

Material	Food Grade Silicone, ABS
Battery Capacity	1000mAh
Rated Power	≤9.7W
Working Voltage	3.7V
Charging Voltage	DC 5V/1A
Charging Interface	Type-C
LED Lights Number	62 PCS
LED Lights	7 Wavelengths (Cyan, Purple, Green, Blue, White, Yellow, Red)
Product Size	5×209×328mm
Product Weight	275g

Indicator Light

Status	Solution
The device does not turn on.	Long press the ON/OFF switch for 3 seconds to turn it on. The device needs to be charged.
Battery voltage is low.	The device needs to be charged.
The USB plug or socket is faulty.	Re-insert the USB plug/socket. Replace the USB plug/socket.
Auto power-off function is activated.	Long press the ON/OFF switch for 3 seconds to turn it on. The device needs to be charged.

Disposal

This product must not be disposed of as unsorted household waste. It is important to separate such waste for proper treatment and recycling, in compliance with local waste management regulations.



Warranty

Products that you buy directly from our **Porodo** website or shop come with a 24-month warranty.

When you buy **Porodo** products from any of our approved sellers, you only get a 12-month warranty. If you want to extend this warranty, go to our website at **porodo.net/warranty** and fill out the form with your information. Don't forget to upload a picture of the product too. After we've checked and accepted your request, we'll send you an email to confirm that your product's warranty has been extended.

For more info, please check:

porodo.net/warranty

Contact Us

If you have any questions about this Privacy Policy, please contact us at:

info@porodo.net

Website: **porodo.net**

Service Support: **support@porodo.net**

Instagram: **porodo**