

**PORODO**



**Porodo**

**MagSafe Charger  
Retractable Type-C**

SKU: PD-HSM14

# Table of Contents

Specifications	2
Schematic View	2
Charging Guide	3
Charging Ring Installation	3
Installing the Charger	3
Compatibility	4
Precautions	5
FCC Statement	5
Disposal	6
Warranty	6
Contact Us	6

# Specifications

Material	ABS, PC
Input	24-12V
USB-C Input	5V/2A, 9V/2A 18W
Wireless Output	5W, 7.5W, 10W, 15W
Compatibility	4.7 to 6.9" Smartphones
Product Dimension	59.4×83.2×32.7mm
Product Size	105g

# Schematic View

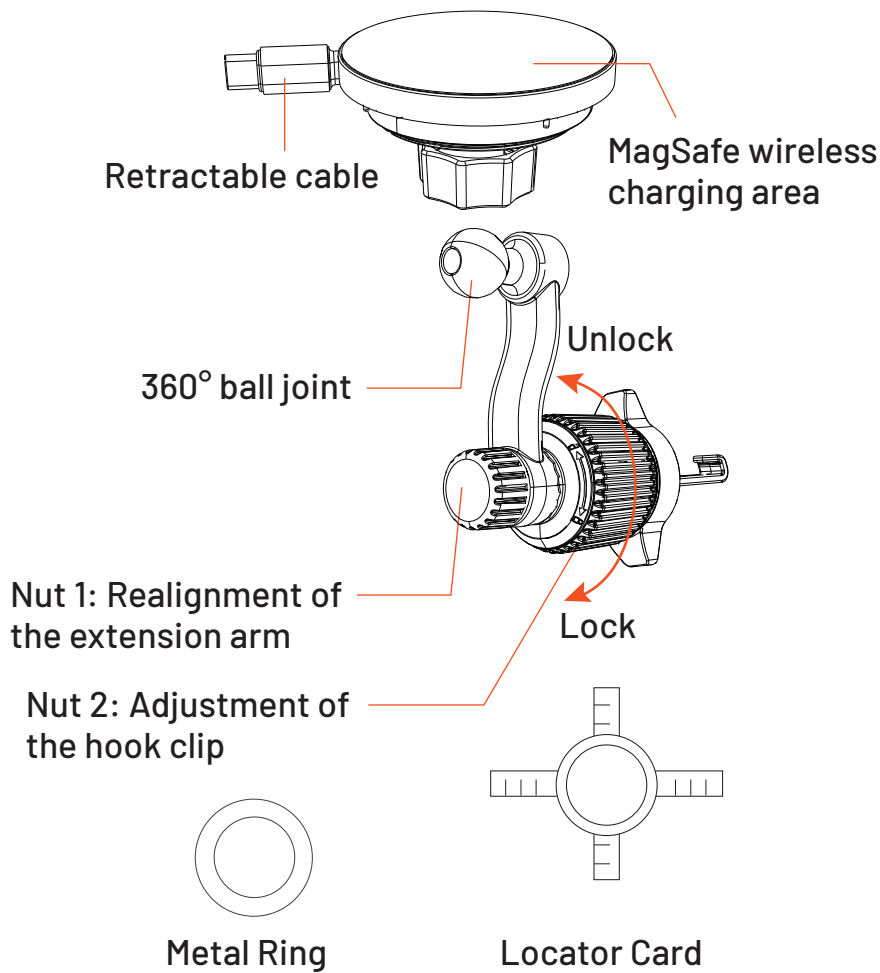

## Charging Guide

1. Pull the cable out and connect it directly to the USB-C car charger. The cable can be retracted back after use for convenience.
2. Place your phone directly onto the wireless charging pad to begin charging. For phones or cases that do not have MagSafe, you must first install the metal ring.

## Charging Ring Installation

1. Start by wiping the back of your phone with a damp cloth, followed by a dry cloth.
2. Find the center of the back of your phone using the Match-Up card. Position the card with the top and bottom facing up and down, and place it on the back of your iPhone or case.
3. Attach the transparent protective film to the center of your iPhone or case.
4. Peel the protective film off the metal ring and place the ring in the center.

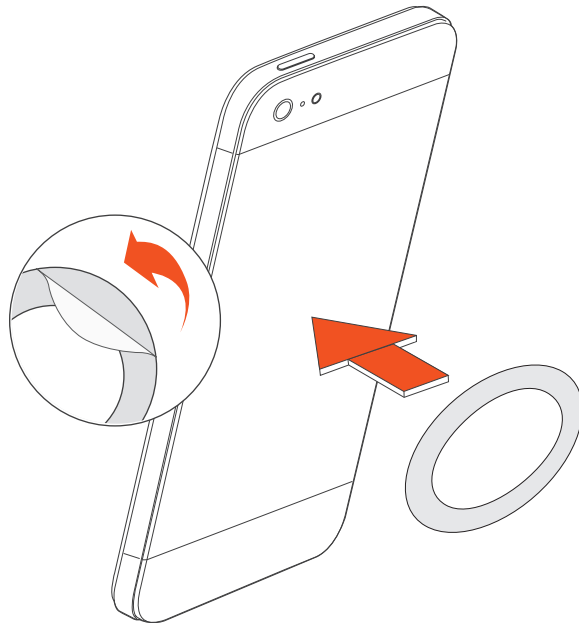

## Installing the Charger

1. Turn the nut counterclockwise to loosen the metal hook to its maximum length.
2. Insert the metal hook along the ventilation grille and gradually adjust its position until the grille clicks into place within the hook.
3. Adjust the angle of the upper and lower ventilation grilles so that they fit into

the grooves on both sides of the clip. Finally, turn the nut clockwise to secure it in place. Ensure the ventilation grilles are properly seated in the metal hook.

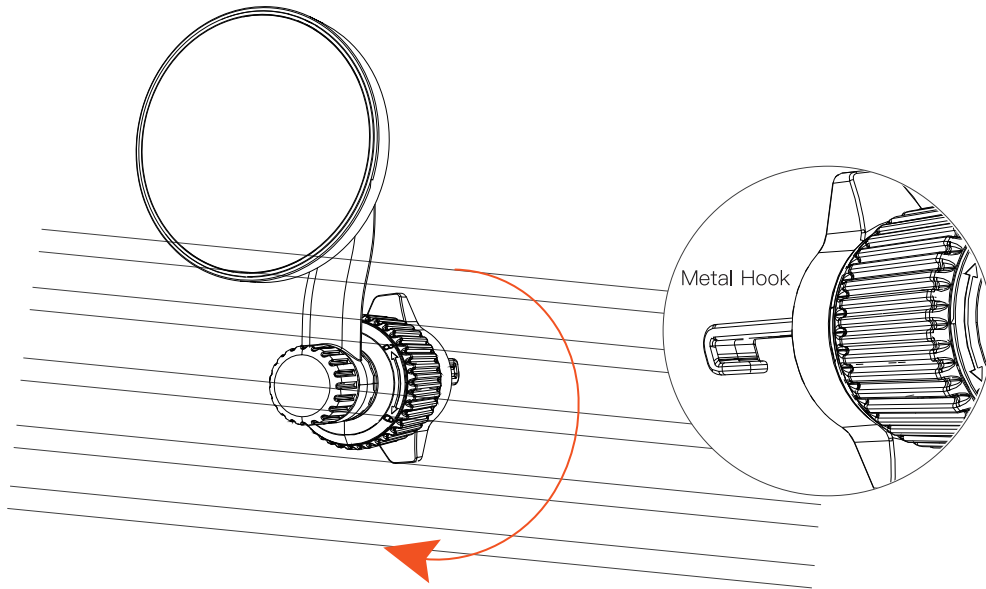

## Compatibility

### 1. iPhone 15/14/13/12 Series & MagSafe Case

Attach your iPhone from the 15/14/13/12 series directly to the magnetic mount without needing additional metal rings.

### 2. Suitable for other phones and cases:

If you are using an iPhone 15/14/13/12 with a case without MagSafe, or any other iPhone model (e.g., iPhone 8/7/6/X/11), you will need to first attach the metal ring to the phone and ensure a direct connection with the magnetic mount.

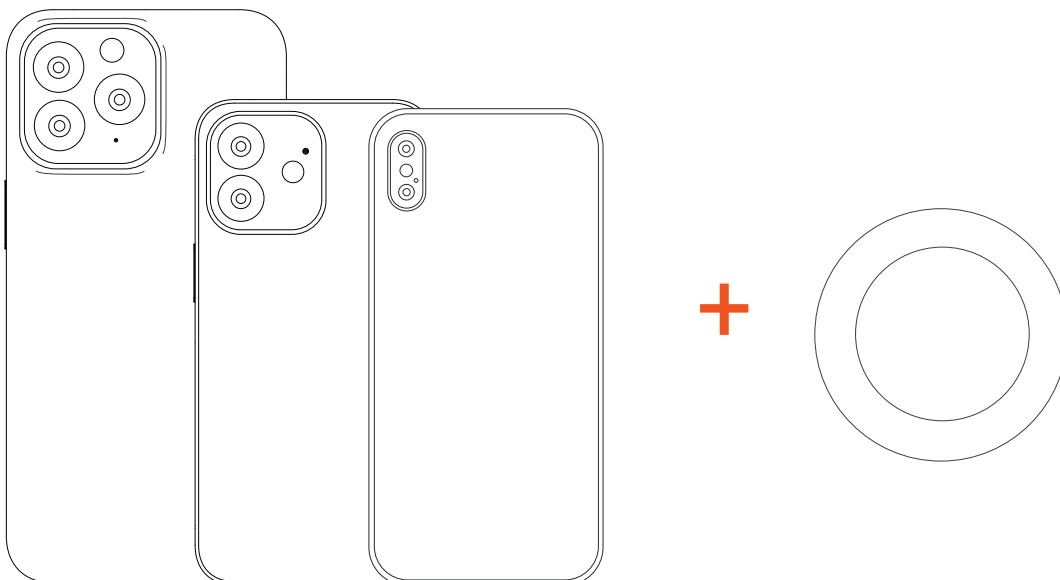

## Precautions

1. Please use the magnetic mount together with the PD car charger.
2. Any metal objects interfere with wireless charging (e.g., metal pad, PopSocket credit cards, etc.). Make sure no metal objects are present between your phone and the wireless charger.
3. If you use GPS or a music player on your phone during charging, the charging speed may be significantly affected. In the case of using GPS applications, power consumption could be higher than the charging speed.
4. It is normal for the wireless charger to warm slightly during use. If you notice excessive heating, please stop using the charger.

## FCC Statement

Any changes or modifications not expressly approved by the party responsible for compliance may void the user's authority to operate the equipment.

This equipment has been tested and found to comply with the limits for a Class B digital device, pursuant to Part 15 of the FCC Rules. These limits are designed to provide reasonable protection against harmful interference in a residential installation. This equipment generates and can radiate radio frequency energy and, if not installed and used according to the instructions, may cause harmful interference to radio communications. However, there is no guarantee that interference will not occur in a particular installation.

If this equipment causes harmful interference to radio or television reception which can be determined by turning the equipment off and on, the user is encouraged to try to correct the interference by one or more of the following measures:

1. Reorient or relocate the receiving antenna.
2. Increase the separation between the equipment and receiver.
3. Connect the equipment to an outlet on a circuit different from that to which the receiver is connected.
4. Consult the dealer or an experienced radio/TV technician for help.

This device complies with part 15 of the FCC rules. Operation is subject to the

following two conditions: (1) this device may not cause harmful interference and (2) this device must accept any interference received, including interference that may cause undesired operation.

The distance between the user and the products should be no less than 20 cm.

## **Disposal**

This product must not be disposed of as unsorted household waste. It is important to separate such waste for proper treatment and recycling, in compliance with local waste management regulations.

## **Warranty**

Products that you buy directly from our **Porodo** website or shop come with a 24-month warranty.

When you buy **Porodo** products from any of our approved sellers, you only get a 12-month warranty. If you want to extend this warranty, go to our website at **[porodo.net/warranty](https://porodo.net/warranty)** and fill out the form with your information. Don't forget to upload a picture of the product too. After we've checked and accepted your request, we'll send you an email to confirm that your product's warranty has been extended.

For more info, please check:  
**[porodo.net/warranty](https://porodo.net/warranty)**

## **Contact Us**

If you have any questions about this Privacy Policy, please contact us at:  
**[info@porodo.net](mailto:info@porodo.net)**

Website: **[porodo.net](https://porodo.net)**

Service Support: **[support@porodo.net](mailto:support@porodo.net)**

Instagram: **[porodo](https://www.instagram.com/porodo)**