

# PORODO



## Porodo

### Crystal Shell Wireless Keyboard

SKU: PD-ETK03

# **Table of Contents**

Schematic View	2
Compatible System	2
Specifications	2
Combination Key Functions	3
Switch Language	3
Multi-Device Connection	4
iOS Connection Guide	4
Mac Connection Guide	5
Windows Connection Guide	7
Android Connection Guide	8
Status Display LED	10
Keyboard Maintenance	10
FAQ	10
Disposal	11
Warranty	11
Contact Us	11

## Schematic View

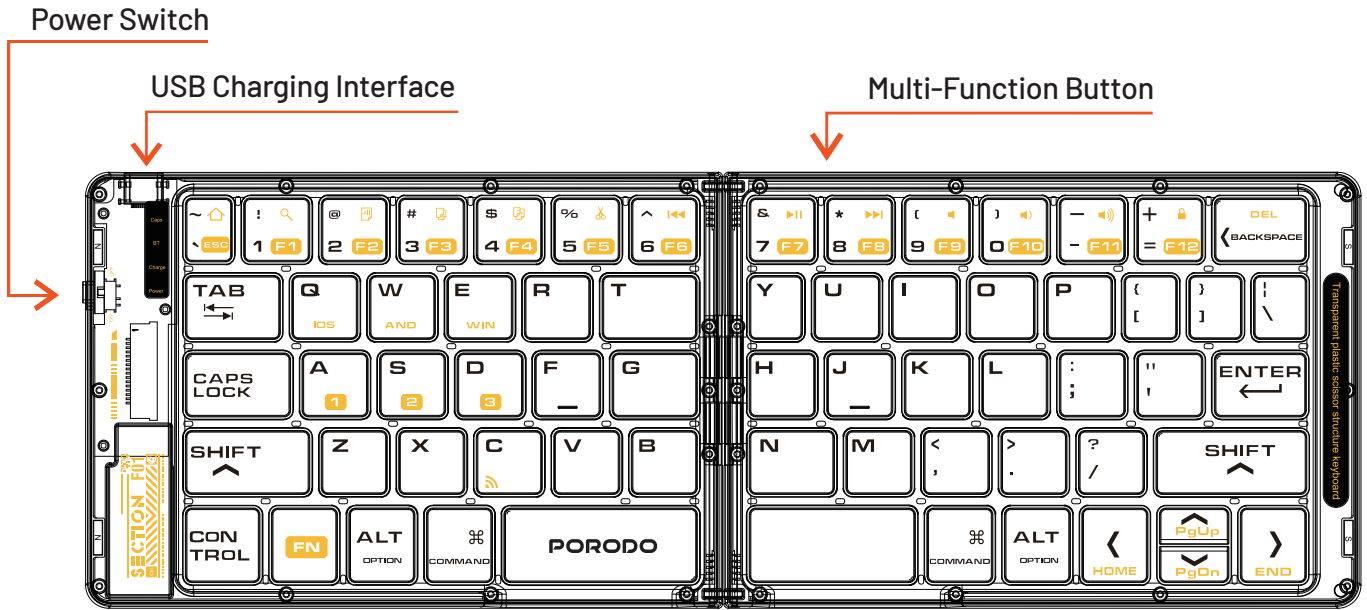

## Compatible System

This product is compatible with Windows, iOS, Android, and Mac operating systems.

## Specifications

Power Supply	80mAh Lithium Battery
Charging Current	50 to 100mA
Bluetooth Range	10m
Sleep Time	10min
Key Switches	Scissor
Layout	65keys + Arabic
Product Weight	177g
Product Size	299.5×102.4×6.8mm (Unfolded) 149.96×102.4×13.7mm (Folded)
Compatibility	Windows, iOS, Android, Mac









## Combination Key Functions

Fn +	iOS/Mac/ Android	Fn + Shift	Windows	Fn +	Windows
~ \	Return to Desktop	~ \	Open the Browser	~ \	Esc
! 1	Search	! 1	Search	! 1	F1
@ 2	Select	@ 2	Select	@ 2	F2
# 3	Copy	# 3	Copy	# 3	F3
\$ 4	Stick	\$ 4	Stick	\$ 4	F4
% 5	Cut	% 5	Cut	% 5	F5
^ 6	Previous Track	^ 6	Previous Track	^ 6	F6
& 7	Play/Pause	& 7	Play/Pause	& 7	F7
* 8	Next	* 8	Next	* 8	F8
( 9	Mute	( 9	Mute	( 9	F9
) O	Volume Down	) O	Volume Down	) O	F10
- -	Volume Up	- -	Volume Up	- -	F11
+ =	Lock	+ =	Lock	+ =	F12

## Switch Language

1. On Windows, press Alt + Shift to switch the language.
2. On iOS/Mac, press Ctrl + Space to switch the language.
3. On Android, press Shift + Space to switch the language.

## Multi-Device Connection

1. When connecting the first device, press Fn + (  ), then press Fn + (  ) to pair the code and start the connection.
2. When connecting the second device, press Fn + (  ), then press Fn + (  ) to pair the code and start the connection.
3. When connecting the third device, press Fn + (  ), then press Fn + (  ) to pair the code and start the connection.
4. When using multiple devices at the same time, press Fn + (  ) or Fn + (  ) or Fn + (  ) to switch to the connected device freely.

## iOS Connection Guide

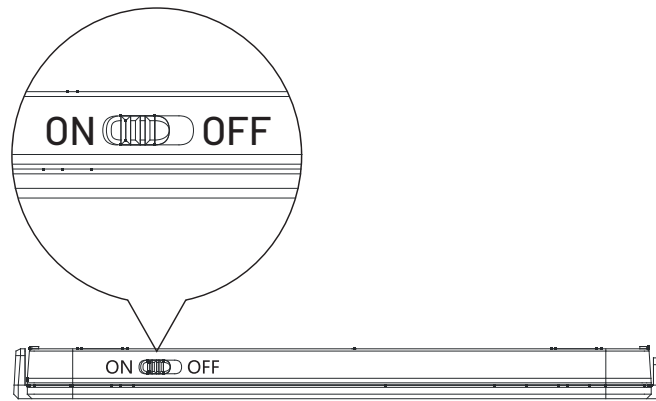

1. Slide the keyboard's power switch to the "on" position. Select the Bluetooth mode when the red light is visible. Then, press the Fn+C keys to initiate pairing when the blue light begins flashing.

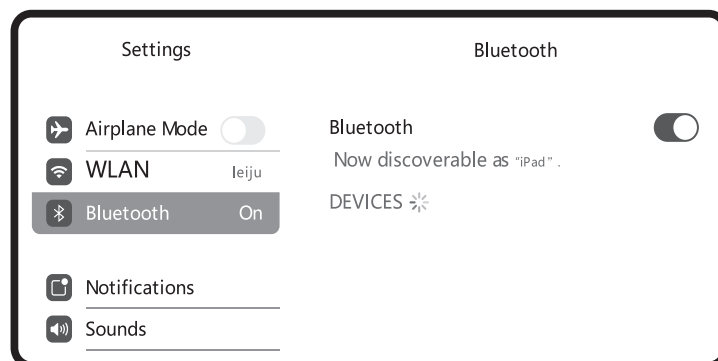

2. Open the setup button on the starting interface, select "Bluetooth," and begin the search process.

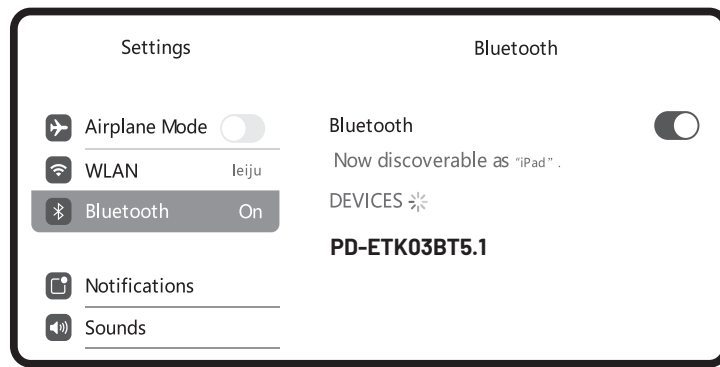

**3.** You will find "PD-ETK03BT5.1" in the list of available devices. Click on the pairing name to connect.

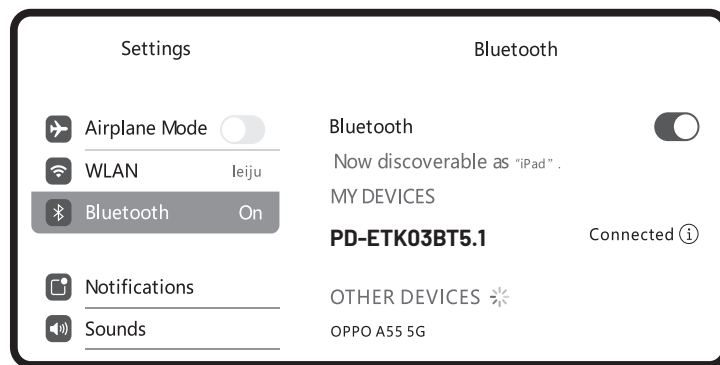

**4.** For successful connection, follow the tips provided to ensure you can use your keyboard comfortably.

## Mac Connection Guide

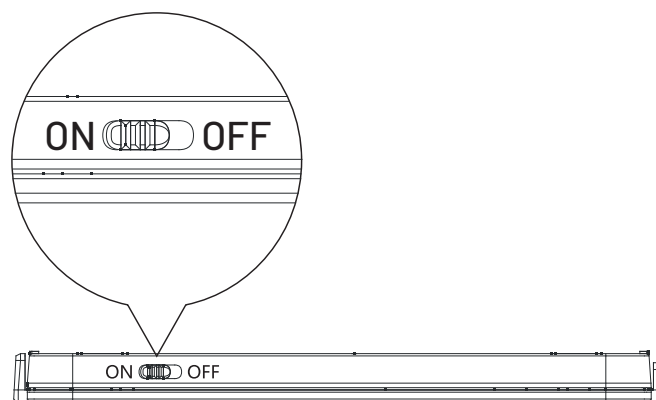

**1.** Slide the keyboard's on/off switch to the "on" position and select the Bluetooth mode when the red light is visible. Then, press Fn+C to begin pairing when the blue light starts flashing.

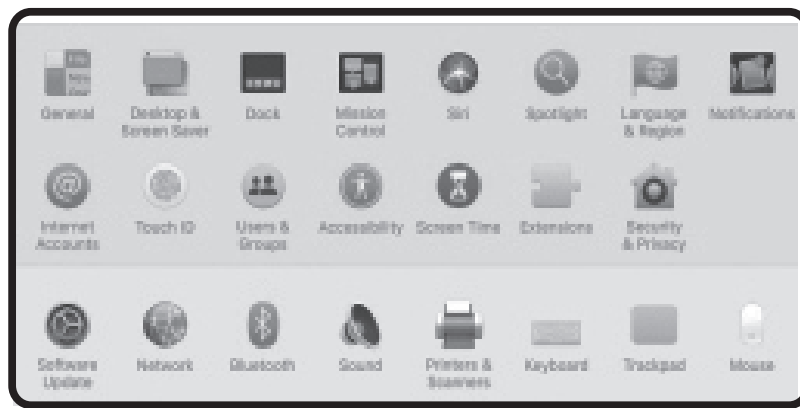

**2.** Open the Mac System Preferences, select "Bluetooth," and start searching for available devices.

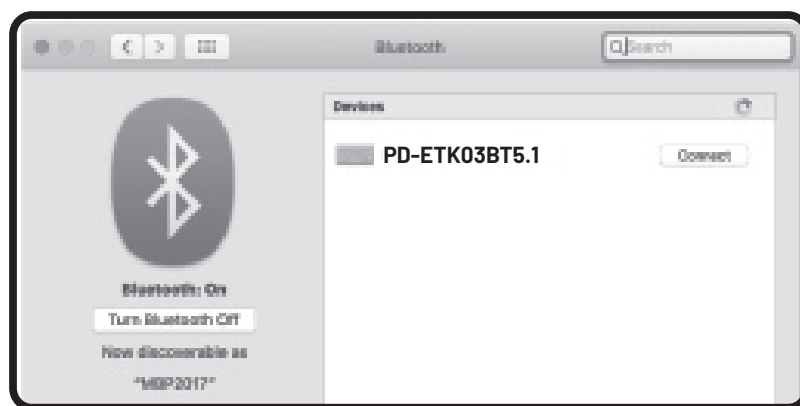

**3.** You will see "PD-ETK03BT5.1" in the list of available devices. Click on the pairing name to connect.

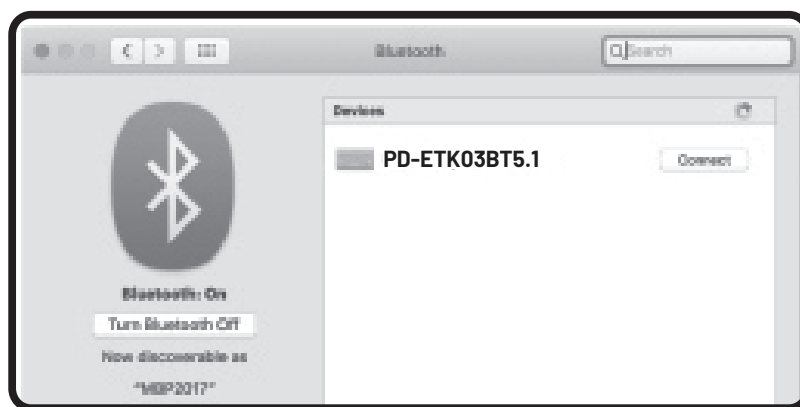

**4.** For successful connection, follow the provided tips to ensure you can use your keyboard comfortably.

# Windows Connection Guide

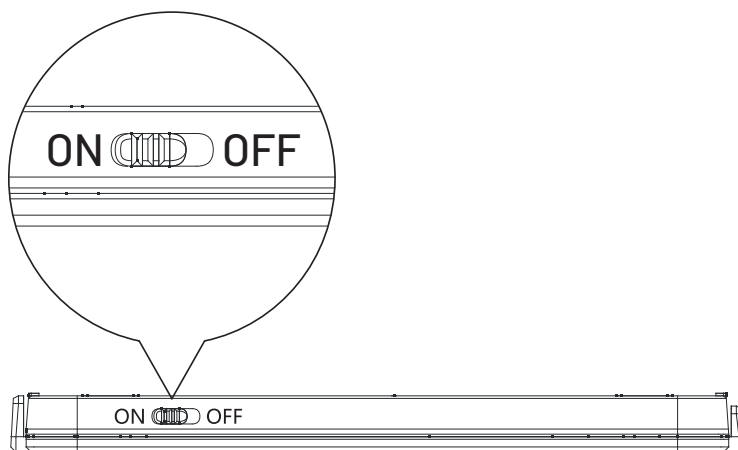

**1.** Slide the keyboard's on/off switch to the "on" position, and select the Bluetooth mode when the red light is visible. Then press Fn+C to initiate pairing when the blue light begins flashing.

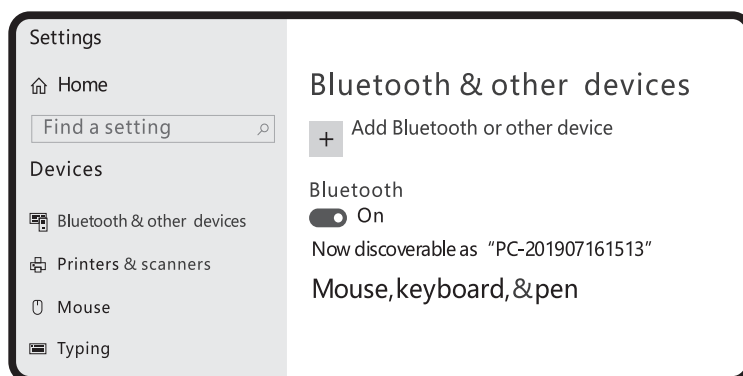

**2.** Open the settings, turn on Bluetooth, and click "Add Bluetooth or other devices."

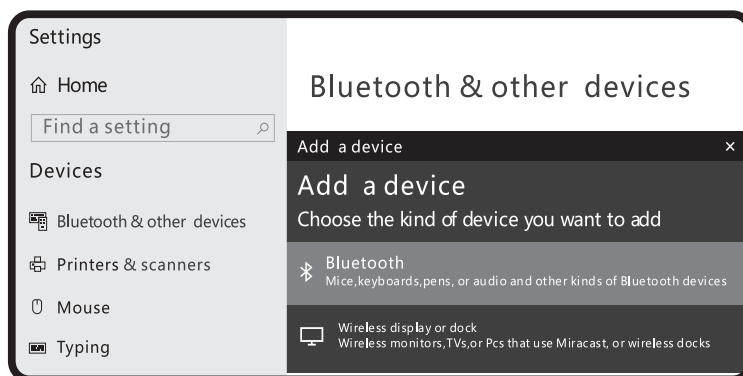

**3.** Select "Bluetooth" from the Add Device menu to begin searching.



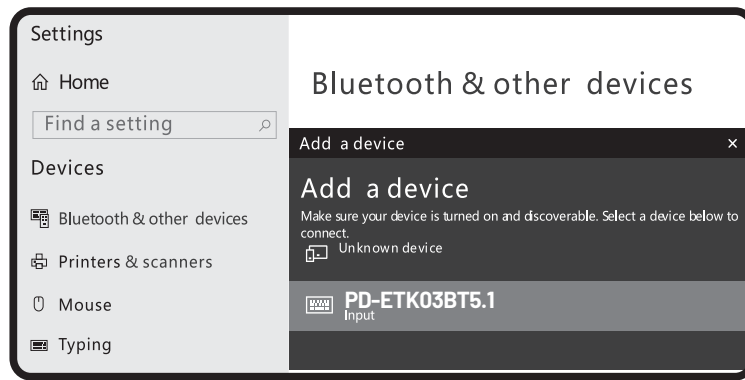

**4.** You will find "PD-ETK03BT5.1" in the list. Click on the pairing name to connect.

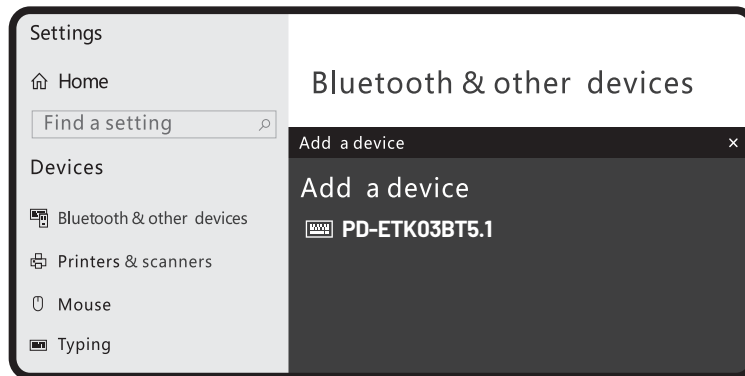

**5.** Follow the provided tip for a successful connection, ensuring you can use your keyboard comfortably.

## Android Connection Guide

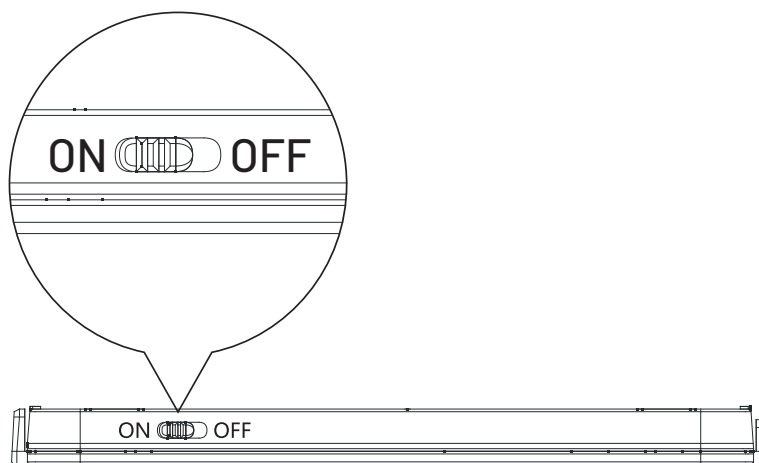

**1.** Slide the keyboard's on/off switch to the "on" position, and select the Bluetooth mode when the red light is visible. Then press Fn+C to start pairing when the blue light begins flashing.

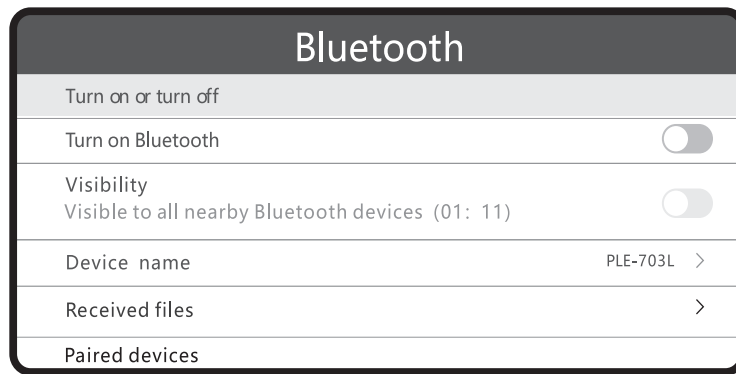

**2.** Open the tablet's PC settings, select "Bluetooth," and ensure it's in search and pairing mode.

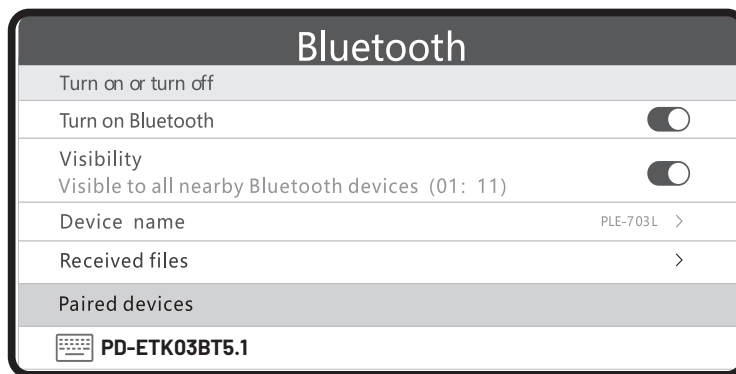

**3.** You will find "PD-ETK03BT5.1" in the list. Click on it to proceed to the next step.

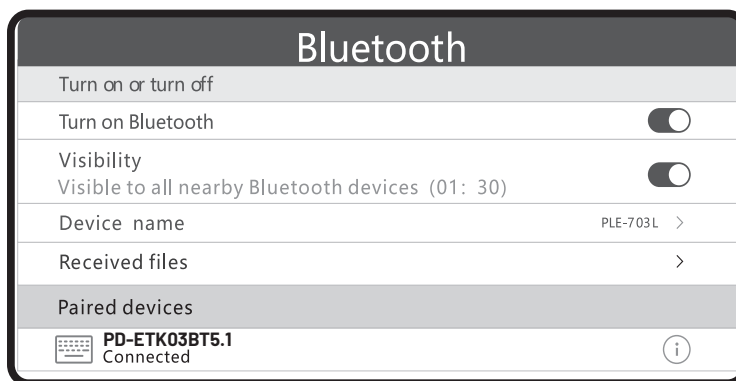

**4.** For a successful connection, follow the tips provided so you can comfortably use your keyboard.

**Remarks:** After successfully connecting, the next time you don't need to enter a matching code. Simply turn on the Bluetooth keyboard's power switch and enable Bluetooth on the tablet PC. The Bluetooth keyboard will automatically search for the device and connect.

## **Status Display LED**

- 1. Power:** Slide the keyboard's on/off switch to "on," and the red light will be visible for a few seconds.
- 2. Bluetooth:** Select the mode, and the blue light will be visible for a few seconds.
- 3. Pairing:** Press Fn+C. The blue light will flash. Once connected, the light will turn off.
- 4. Low Battery:** The red light will appear.
- 5. Charging:** The red light will be on. Once fully charged, the light will turn off.
- 6. Caps Lock:** The green light will be on.

## **Keyboard Maintenance**

- 1.** Keep the keyboard away from liquids or humid environments, such as saunas, swimming pools, or steam rooms. Do not let the keyboard get wet in the rain.
- 2.** Avoid exposing the keyboard to extremely high or low temperatures.
- 3.** Do not place the keyboard under direct sunlight for extended periods.
- 4.** Keep the keyboard away from open flames, such as cooking stoves, candles, or fireplaces.
- 5.** Avoid sharp objects that may scratch the product. Be sure to recharge the product in a timely manner to ensure normal use.

## **FAQ**

### **1. The tablet PC can't connect to the Bluetooth keyboard?**

First, check if the Bluetooth keyboard is in pairing mode, then open the tablet's Bluetooth settings to start searching.

Ensure the Bluetooth keyboard's battery is sufficiently charged. If the battery is low, it may prevent the connection.

### **2. The keyboard indicator light is always flashing when in use?**

The flashing indicator light means that the keyboard is running low on power. Please charge the keyboard as soon as possible.

### 3. The tablet PC displays that the Bluetooth keyboard is disconnected?

If the Bluetooth keyboard is not used for a period of time, the device will automatically enter sleep mode to conserve power. Press any key on the keyboard to wake it up, and the Bluetooth connection will be automatically restored.

## Disposal

This product must not be disposed of as unsorted household waste. It is important to separate such waste for proper treatment and recycling, in compliance with local waste management regulations.

## Warranty

Products that you buy directly from our **Porodo** website or shop come with a 24-month warranty.

When you buy **Porodo** products from any of our approved sellers, you only get a 12-month warranty. If you want to extend this warranty, go to our website at **porodo.net/warranty** and fill out the form with your information. Don't forget to upload a picture of the product too. After we've checked and accepted your request, we'll send you an email to confirm that your product's warranty has been extended.

For more info, please check:  
**porodo.net/warranty**

## Contact Us

If you have any questions about this Privacy Policy, please contact us at:  
**info@porodo.net**

Website: **porodo.net**

Service Support: **support@porodo.net**

Instagram: **porodo**