

Powerology

Cordless Vacuum
with Auto-Disposal Charging
SKU: PPBCHA54

Table of Contents

Safety Precautions	2
Schematic View	4
Package Contents	5
Specifications	6
First Use	7
Assembly	7
Touch Panel Guide	8
Accessory Usage Instructions	8
Cleaning the Floor Brush	9
Vacuum Filter Maintenance	9
Dust Collection Station Functions	9
Replacing the Dust Bag	10
Station Filter Maintenance	11
Dust Cup Maintenance	11
Disposal Note	12
Troubleshooting	12
Warranty	13
Contact Us	13

Safety Precautions

Carefully read this user manual before using the product and retain it for future reference. Failure to follow the instructions in this manual may result in damage to the product and could lead to electric shock, fire, or other injuries.

Warning

This product should not be operated by individuals with physical, sensory, or mental impairments, or by those lacking the necessary experience and knowledge (including children), unless they are supervised or instructed by a responsible guardian to ensure safe usage.

1. Children must not use this appliance and should be supervised to ensure they do not operate it. Children should not be allowed to clean the product without supervision.
2. This appliance is intended for indoor household use only. Do not use it outdoors or in wet conditions.
3. Avoid touching the plug or appliance with wet hands.
4. Do not use the appliance if the vacuum cleaner's battery is damaged, as this could lead to fire, explosion, or injury. Inspect the battery before use.
5. Do not immerse the vacuum cleaner or its electronic components in water or any other liquid. Ensure that the filter is completely dry after each cleaning session.
6. Turn off the appliance when cleaning the brush roller to prevent damage from the rotating brush head.
7. Do not operate the device without the lint brush, dust bin, and filter properly installed.
8. Avoid vacuuming water, oil, flammable liquids, or inhaling any toxic substances.
9. Do not vacuum ashes, burning items such as charcoal, cigarette

butts, or matches.

10. Refrain from vacuuming hard or sharp objects like glass, nails, or coins, as they may damage the equipment.

11. Keep the vacuum cleaner's suction port away from long hair, loose clothing, or fingers. Do not place the suction tube or any accessories near the eyes, ears, or mouth.

12. Ensure sufficient airflow when vacuuming and discontinue use if the device becomes blocked. Clean immediately if suction decreases due to a blockage.

13. Do not lean the vacuum cleaner against unstable surfaces such as chairs or tables to prevent it from falling or causing injury.

14. Charge the vacuum cleaner strictly following the instructions provided in this manual. Do not charge the vacuum when the temperature exceeds the recommended range to avoid battery damage.

15. Use only accessories and replacement parts recommended by the manufacturer.

16. Do not operate the vacuum until all accessories and parts are correctly assembled to avoid damage.

17. Unplug the device if it will not be used for an extended period or during maintenance.

18. Do not place the appliance near gas stoves, electric stoves, or any open flames.

19. Avoid immersing the appliance and its cables, and do not insert them into water or any other liquid.

20. Ensure that children do not touch the cables or the device.

21. Keep the appliance away from sharp edges, heating elements, or any other heat sources.

22. Remove all packaging materials and advertising labels before using the appliance.

23. This vacuum cleaner is equipped with a rechargeable battery. Follow local laws and regulations for battery recycling. Piercing or exposing the battery to high temperatures may result in explosions.

24. In extreme cases, the vacuum cleaner battery may leak. If battery liquid comes into contact with skin, wash the affected area immediately with soap and water, or neutralize with a mild acid such as lemon juice or vinegar. If battery liquid enters the eyes, rinse thoroughly with water and immediately seek medical attention.

Schematic View

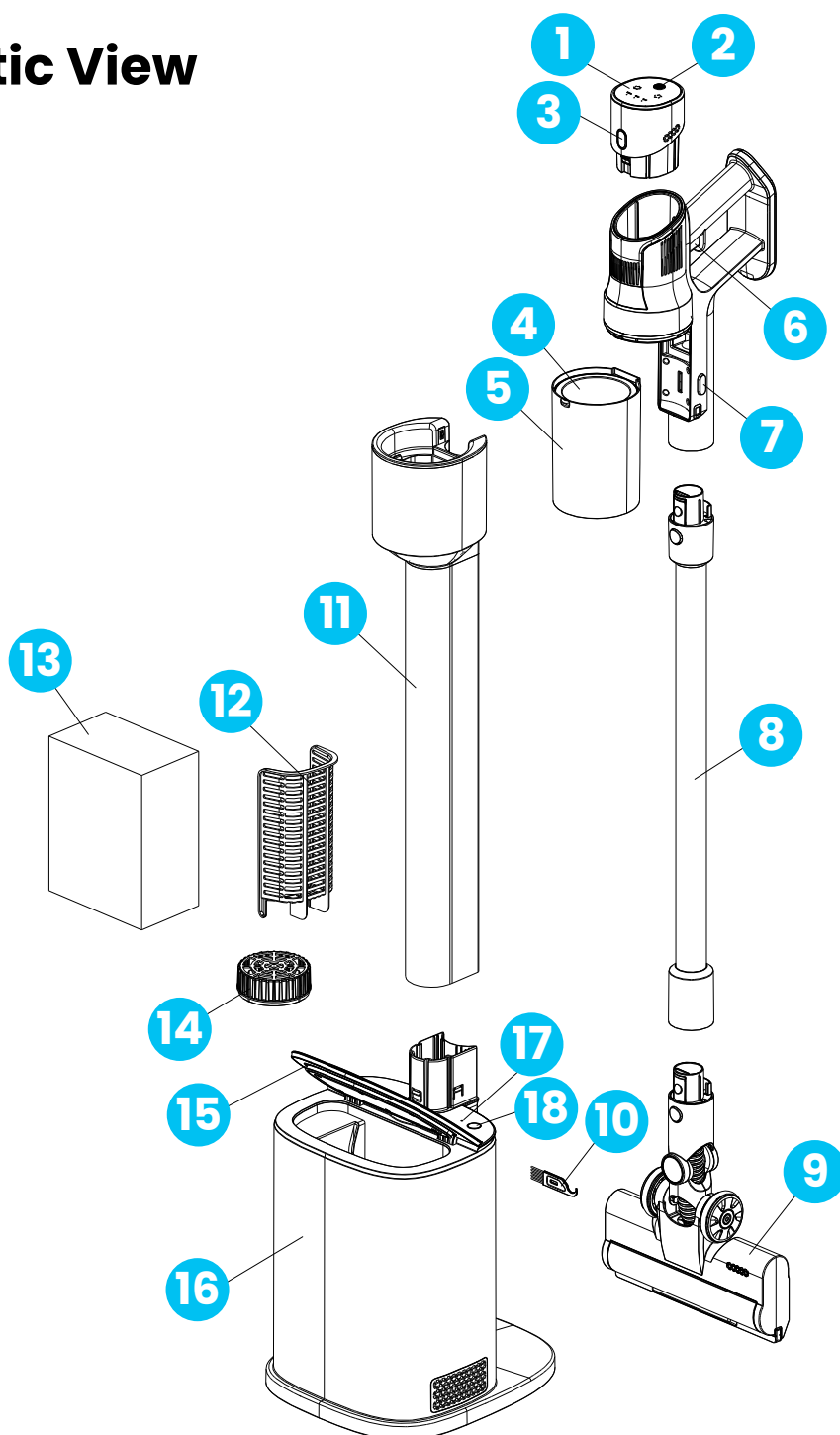

1. Battery Pack Display Panel	10. Hair Removal Brush
2. Power Adjustment Button	11. Dust Collection Pipe
3. Battery Pack Release Button	12. Dust Bag Air Duct Mesh
4. HEPA Filter	13. Dust Bag
5. Dust Cup	14. Protective Cover
6. Power Switch Button	15. Dust Bag Box Cover
7. Dust Cup Release Button	16. Dust Collection Station
8. Aluminum Tube	17. Indicator Light
9. Floor Brush	18. Dust Collection Station Button

Package Contents

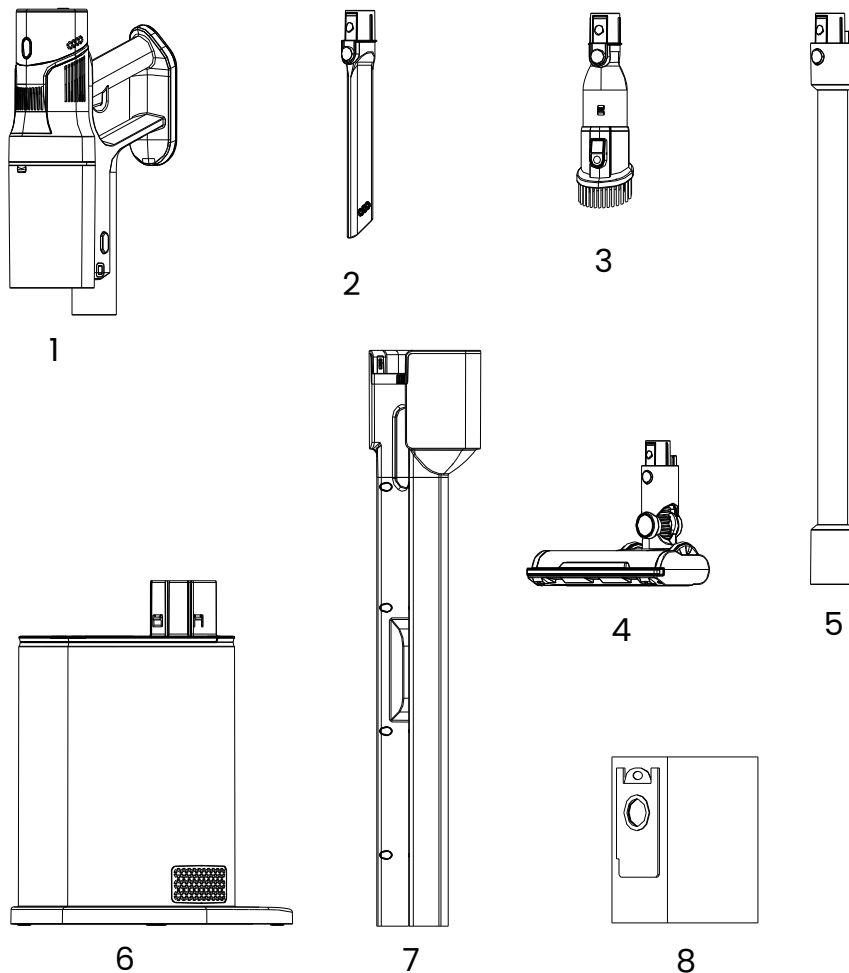

1. Vacuum Cleaner Main Unit	5. Aluminum Tube
2. Crevice Tool	6. Dust Collection Station
3. Brush	7. Dust Collection Pipe
4. Floor Brush	8. Dust Bag

Specifications

Rated Voltage	100-240V
Rated Frequency	50/60Hz
Battery Capacity	2500mAh
Recharge Time	5H
Motor Power	400W (Vacuum), 1000W (Dust Collection Station)
Speed Level	3 Modes
Base Station Capacity	3L
Dust Bin Capacity	450ML
Suction Power	22000Pa
Net Weight	5.2KG
Product Dimension	1013×317×266mm

First Use

1. Verify that all accessories and attachments are included when unpacking.
2. Carefully read this manual before using the device.
3. Fully charge the device prior to use.
4. Place the device in a well-ventilated area for a period before its first use to eliminate any residues and odors resulting from the manufacturing process.
5. To prevent circuit overload, do not plug the device into the same outlet as other appliances.

Assembly

1

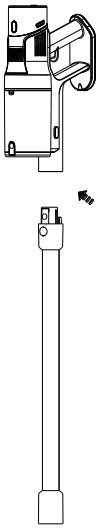

1. Attach the main unit of the vacuum cleaner to the aluminum tube.

2

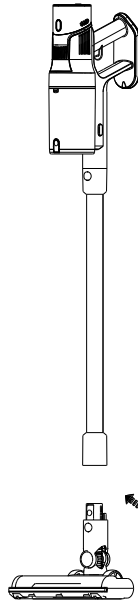

2. Attach the aluminum tube to the floor brush.

3

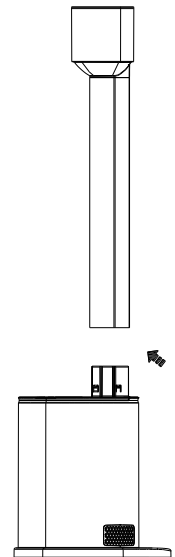

3. Connect the Dust Collection Pipe to the Dust Collection Station

4. To disassemble, press the buckle inside the hole at the back of the main unit with a hard object while simultaneously pulling out the handle.

Touch Panel Guide

1. Low Speed Indicator Light
2. Power Mode Selection Key
3. Battery Power Indicator Light
4. High Speed Indicator Light

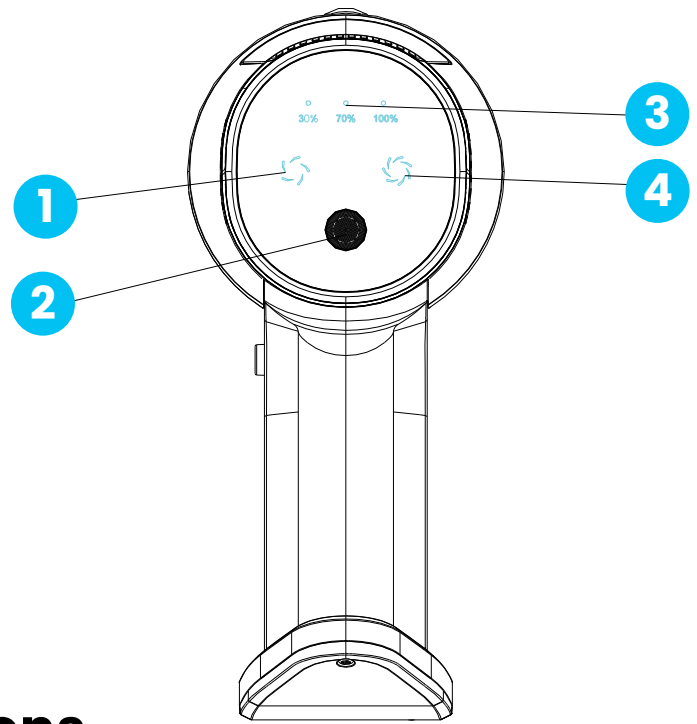

Accessory Usage Instructions

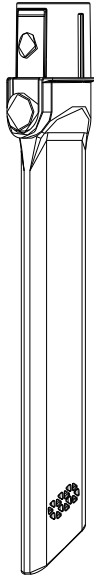

Crevice Brush: Ideal for cleaning corners and the narrow spaces found in doors and windows.

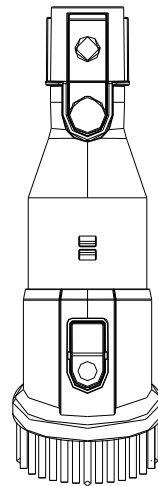

2-in-1 Brush: Designed for cleaning fabric furniture, including beds and sofas.

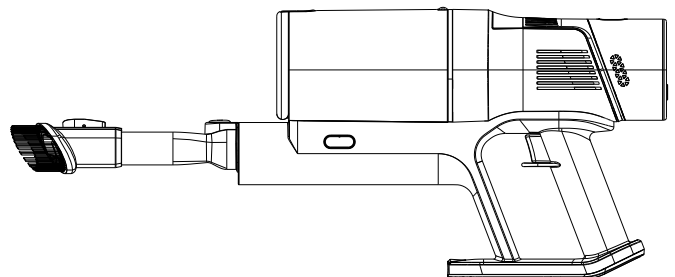
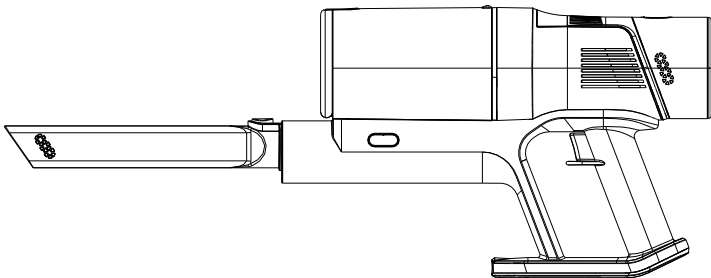

Remove the aluminum tube and attach the crevice tool or brush.

Cleaning the Floor Brush

1. Activate the bottom release switch, then remove the lower cover latch.
2. Remove the roller brush.
3. Press the side button on the floor brush to release the cleaning tool.
4. Use the cleaning tool to remove hair and dust from the roller and brush surface.
5. Reinsert the roller brush into the floor brush and secure it with the cover latch.

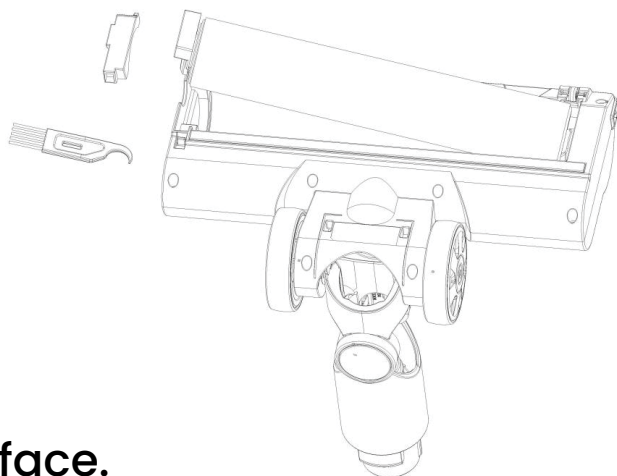

Vacuum Filter Maintenance

1. Press the dust cup release button to open.
2. Remove the HEPA filter and filter parts from the unit.
3. Clean both the filter parts and the HEPA filter thoroughly.
4. Reassemble the filter parts into the dust cup and secure the HEPA filter on top.

Note: If the filter parts are washed with water, ensure they are completely dry before reinserting them into the device.

Dust Collection Station Functions

1. The Dust Collection Station serves dual purposes. It charges the vacuum cleaner and collects garbage from the vacuum cleaner's dust cup.
2. After use, dock the vacuum cleaner in the Dust Collection Station to commence charging. The device will automatically stop charging once the battery is fully charged.
3. The station will empty the contents of the vacuum cleaner's dust cup into an internal dust bag. Each collection cycle lasts for 20 seconds.

4. If the initial collection is incomplete, press the dust collection station button multiple times for additional 20-second cycles.
5. The LED indicator flashes white during the collection process and turns off when the station is not in use.

Replacing the Dust Bag

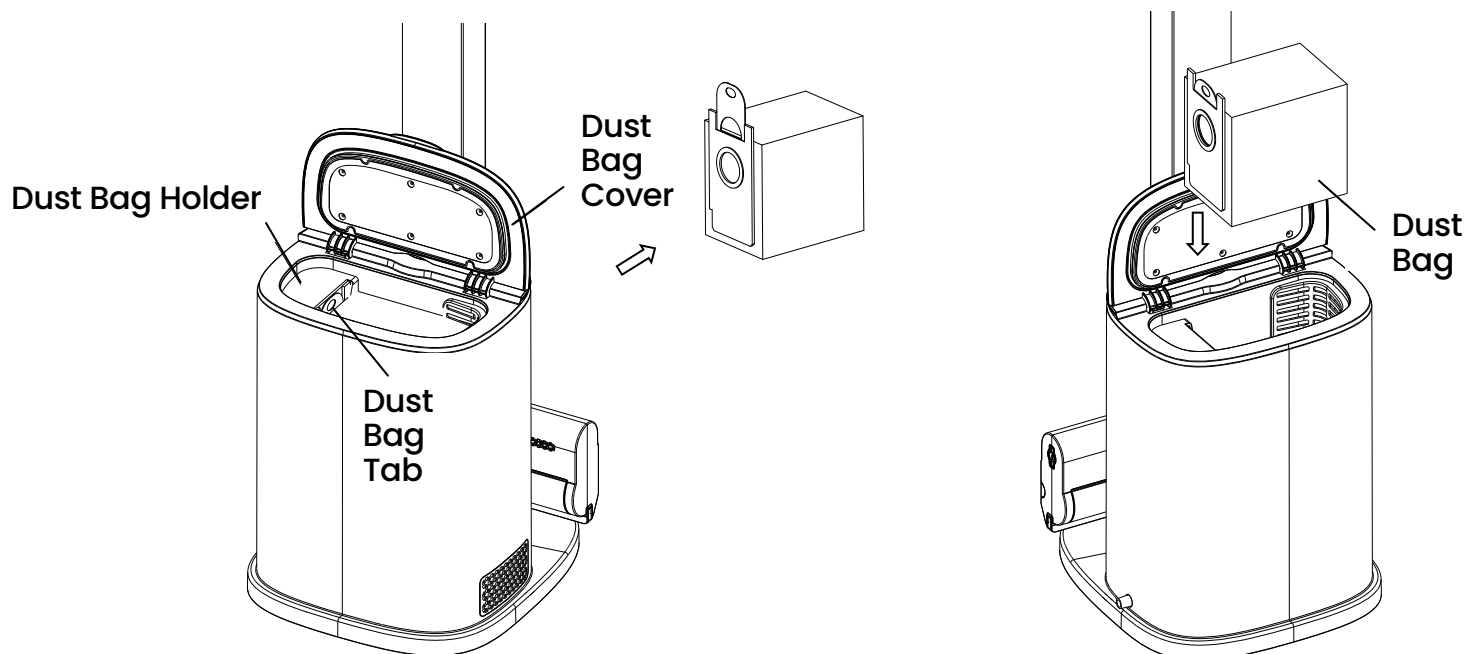

1. When the dust bag is full, the negative pressure sensor will deactivate the power, and the indicator light will blink red ten times before remaining lit.
 2. To replace the dust bag, open the dust bag box cover, lift the dust bag ring upwards to remove the old bag, and insert a new dust bag into the holder as illustrated.
 3. Ensure that the dust bag's top surface is flush with the top of the dust bag holder.
 4. Once the dust bag is properly positioned, the indicator light will turn off, allowing dust collection to resume.
- Note:** If the dust bag is incorrectly installed and does not activate the dust bag switch, the LED will remain red. The light will extinguish once the dust bag is correctly installed.
5. Dust bags are intended for single use only and must not be reused.
- Note:** To open or close the dust bag opening, lift or pull down the dust bag ring.

Opening/Closing the dust bag opening:

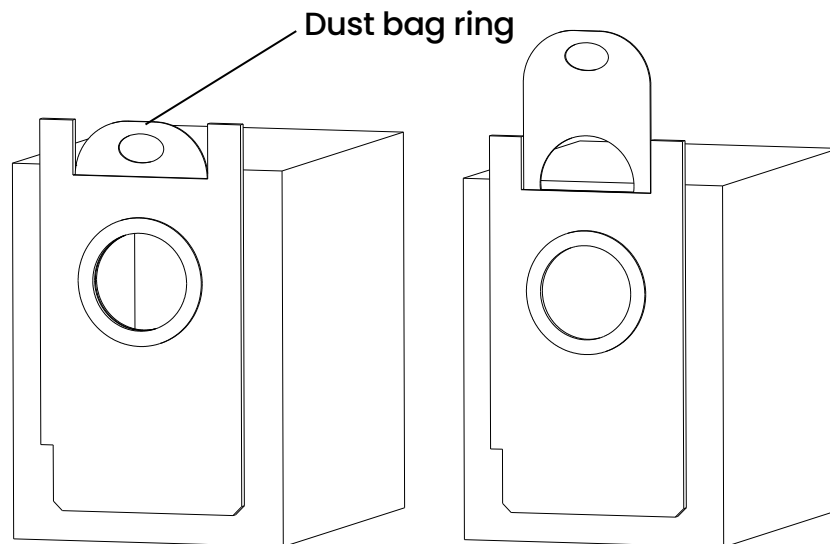

Station Filter Maintenance

1. Regularly remove dust and debris from the air duct of the dust collection station and periodically clean the exhaust outlet HEPA filter, especially if you notice a decrease in suction power.
2. Use a screwdriver to remove the screws from the anti-blocking cover, clean the debris from the air duct, and then replace the cover.
3. To remove the exhaust outlet HEPA filter, press the latch on its holder and pull upwards. Wash the filter thoroughly with clean water, allow it to dry completely, and then reinstall it.

Dust Cup Maintenance

1. Regularly clean the opening of the dust cup to remove any residual debris. This ensures a proper seal of the dust cup lid, preventing leakage during operation.
2. Open the lid of the dust cup and use a damp towel to wipe away debris from the dust inlet.
3. Ensure the towel is neither too dry nor overly wet.
4. After cleaning, securely close the lid.

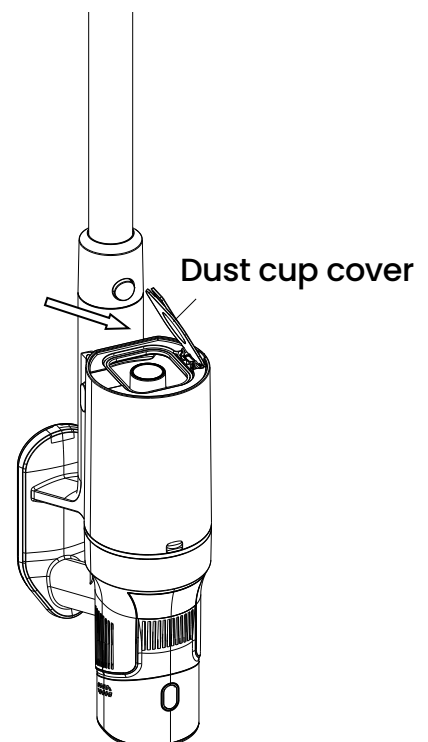

Disposal Note



Do not dispose of discarded appliances as unsorted household waste. The product should be taken to an officially designated recycling center. This helps promote environmental protection.

Troubleshooting

Problem	Possible Cause	Solution
Weak suction power	<ol style="list-style-type: none"> 1. Dust cup is full or filters are clogged. 2. Accessories are blocked. 	<ol style="list-style-type: none"> 1. Ensure the dust cup is emptied and the filters are thoroughly cleaned. 2. Inspect and clean any accessories that may be blocked.
Not working	<ol style="list-style-type: none"> 1. The product is out of power or the battery is low. 2. Overheating due to a blockage may have triggered the automatic protection feature. 3. There may be a blockage in the suction port or channel. 	<ol style="list-style-type: none"> 1. Make sure the product is fully charged before use. 2. If the device overheats, allow it to cool down before restarting. 3. Clear any blockages in the dust port or channel.
Unusual noise from motor	The main suction port or metal connection pipe could be obstructed.	Remove any obstructions from the main suction port or metal connection pipe.
Battery indicator does not turn on	<ol style="list-style-type: none"> 1. The main unit is not properly connected to the power adapter socket. 2. The battery might be fully charged and in sleep mode. 3. Check for any other potential problems. 	<ol style="list-style-type: none"> 1. Verify that the power adapter is properly connected. 2. Ensure the vacuum is being used under normal conditions. 3. If the issue persists, contact professional service agents for assistance.
Overcharging issue	The battery temperature may be either too low or too high.	Wait for the battery temperature to return to normal before attempting to charge.
Weak suction power in dust collection station	<ol style="list-style-type: none"> 1. The dust bag may be full, causing reduced suction power. 2. Dust may have accumulated in the dust collection station's air duct. 3. The HEPA filter at the dust collection station's motor outlet may be blocked. 4. The protective cover sponge may be obstructed. 	<ol style="list-style-type: none"> 1. Install a new dust bag to restore suction power. 2. Open the dust collection station's bottom duct cover and clean the air duct. 3. Remove the HEPA filter, rinse it with water, dry it thoroughly, and reinstall. 4. Remove the sponge, rinse it with water, dry it completely, and reinstall it.

Warranty

Products that you buy directly from our **Powerology** website or shop come with a 24-month warranty.

The 24-month warranty applies to products purchased directly from our **Powerology** website or store. If **Powerology** products are bought from any of our verified retailers, then the product is eligible for only a 12-month warranty. To extend your product's warranty, visit our website **powerology.me/warranty** and fill in your details in the provided form along with an uploaded picture of the product to process your request. Once approved, you will receive a confirmation email of the extended product warranty. Upload the required information within 48 hours of purchase to be eligible for a 24-month warranty period.

For more info, please check:
powerology.me/warranty

Contact Us

If you have any questions about this Privacy Policy, please contact us at: **hey@powerology.me**

Website: **powerology.me**

Instagram: **[powerology_official](https://www.instagram.com/powerology_official)**

Facebook: **[powerology.ME](https://www.facebook.com/powerology.ME)**