

PORODO



Porodo

**ESSENTIAL PULSE Smart Watch
with 1.38" HD Display**

SKU: PDSWEP2230

Table of Contents

Package Contents	2
Product Overview	2
Charging Instructions	2
APP Installation	3
General Instructions	4
Guide for Shortcuts	5
Notifications	6
Call Function	6
Multi-Sport Modes	7
Primary Functions	7
Settings	10
Specifications	11
Precautions	11
Disposal	12
Warranty	13
Contact Us	13

Package Contents

1. Porodo Smart Watch
2. Charging Cable

Product Overview

1. **Touch Screen:** Displays watch data. Swipe or tap the screen to navigate and select functions.
2. **Side Button:** Press and hold the side button to power the device on or off. A short press will either return you to the watch interface or toggle the display on/off.
3. **Heart Rate Sensor:** Monitors your heart rate.
4. **Blood Oxygen Sensor:** Measures your blood oxygen levels.



Charging Instructions

1. Before using your smartwatch for the first time, ensure it is fully charged.
2. The smartwatch will take approximately 2 hours to reach a full charge. Once the charging cable is plugged in, the device will charge automatically.

3. Make sure the charging cable is correctly connected to the charging pins on the back of the smartwatch, and then plug the other end of the cable into a power source.

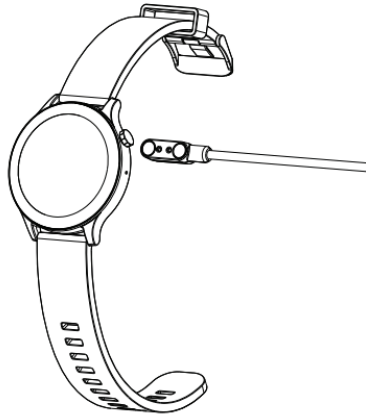

APP Installation

- 1.** Before downloading the "OPLAYER" app, ensure that it is compatible with your smartphone. The app is compatible with iOS 12+, Android 8.0+
- 2.** Search for the "OPLAYER" app in the App Store or Google Play, or scan the QR code provided to install the app. To connect with the device, tap on the product named "PD-SM2230".



3. Turn on Bluetooth on your smartphone, open the "OPLAYER" app, and set up your profile. Then, go to the settings and tap "Connect Smartwatch" to select your smartwatch and establish a connection.

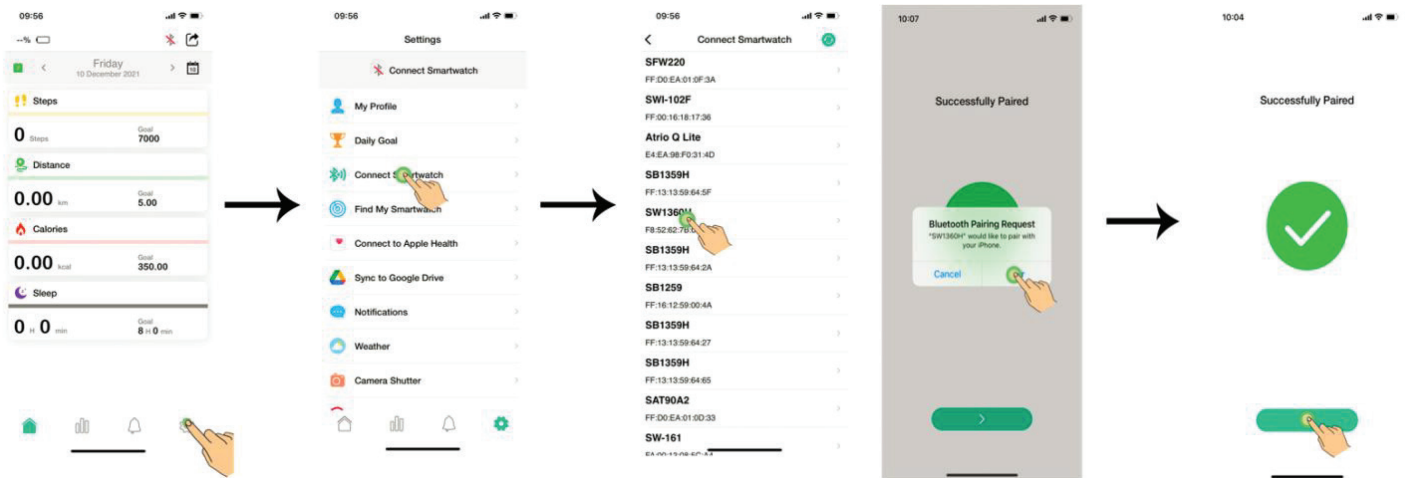

4. To disconnect your smartwatch, go to the app settings and tap "Forget This Smartwatch." For iPhone users, you will also need to navigate to the "Bluetooth" section in your iPhone Settings and select "Forget This Device."

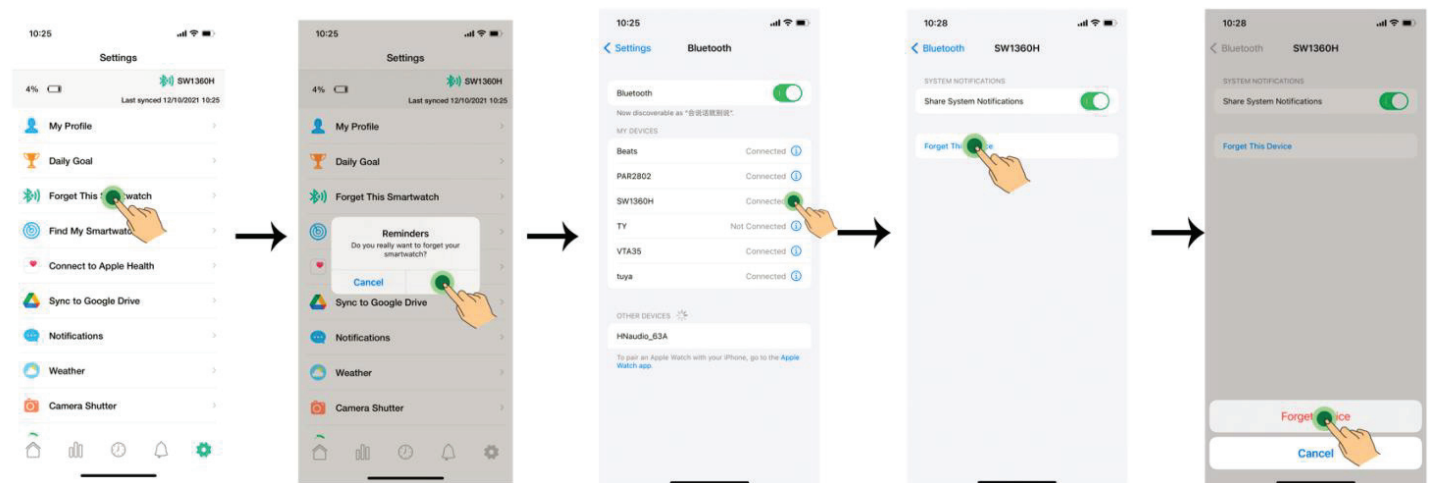

General Instructions

- 1.** Press and hold the side button for 3 seconds to turn on the smartwatch. Swipe up, down, left, or right to navigate through additional options.
- 2.** Main Menu: Access the main menu to view and select from the various features and functions available on your smartwatch.



3. After turning on the smartwatch, the watch face will be displayed. Press and hold for 5 seconds to select a different watch face of your choice.

Guide for Shortcuts

1. Press and hold the side button for 3 seconds to turn on the smartwatch. Swipe up, down, left, or right to navigate through additional options.

2. Main Menu: Access the main menu to view and select from the various features and functions available on your smartwatch.

 Sleep Mode: Activate sleep mode to minimize disturbances.

 Screen Brightness: Tap the brightness icon to adjust the screen brightness, either by increasing or decreasing it.

 Battery Saving Mode: Enable battery saving mode to conserve power.

 About: Access the "About" section to find the MAC address and software version of your smartwatch.

 Settings: Access the settings menu to configure your smartwatch preferences.

Notifications

Swipe up on the dial interface to view notifications, including incoming calls, text messages, WhatsApp, Facebook, and more. Notifications will be automatically deleted after they are read. When the watch face is displayed, swipe right on the watch face to enter and view all menus.

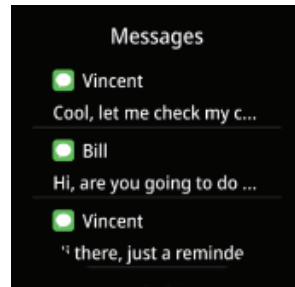

Call Function

1. After pairing the phone with the watch's call Bluetooth, tap this icon to make a call



2. Contacts: Connect the "OPLAYER" app and open it. Then, go to Settings and select Sync Contacts. Add your contact information, and it will be displayed on the watch once saved.

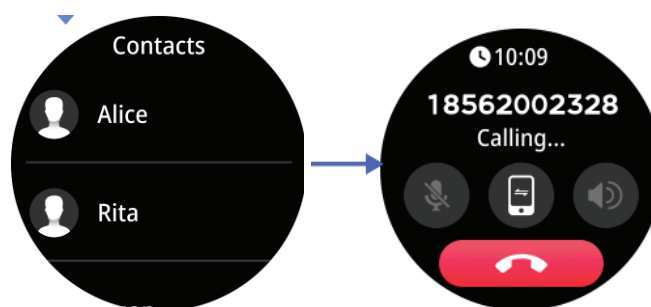

Multi-Sport Modes

1. Tap the sport icon to enter the multi-sport modes. To end the activity, swipe from left to right on the screen and tap the () icon to finish your session and save the sports data.

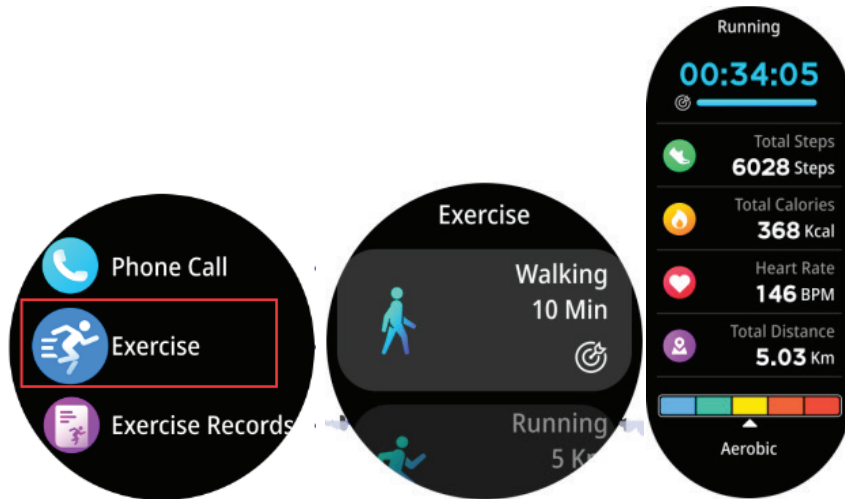

2. Tap the () icon to set your sport goal.

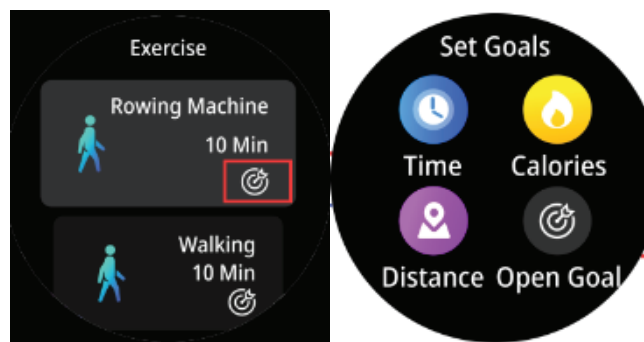

3. A reminder will appear once your sport data reaches the goal you have set.

Primary Functions

1. Heart Rate Test

The smartwatch can record your heart rate throughout the day. You can also tap on the page to start measuring your heart rate manually.

2. Blood Pressure Test

Tap on the blood pressure page to begin measuring your blood pressure. The page will also display the most recent blood pressure readings.

3. Blood Oxygen Level

Tap the SpO2 page to start measuring your SpO2 levels. On the SpO2 page, you can view the most recent SpO2 measurements.

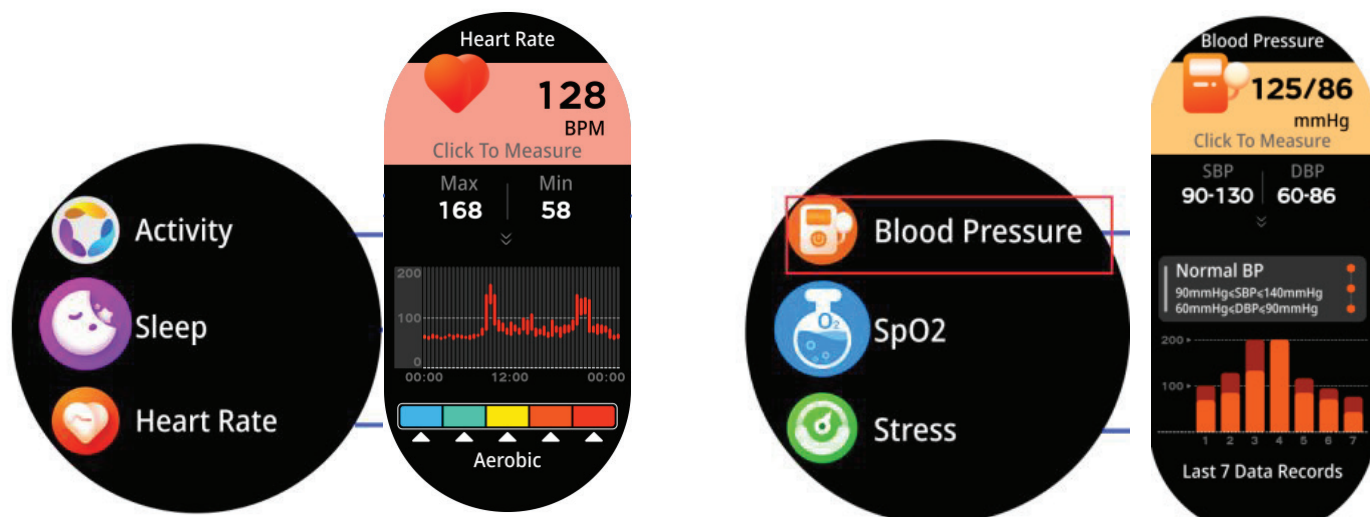

4. Sleep Monitor

The smartwatch automatically monitors your sleep between 9:00 p.m. and 9:00 a.m. to track sleep patterns.



5. Weather

The smartwatch displays the weather when connected to the OPLAYER app.

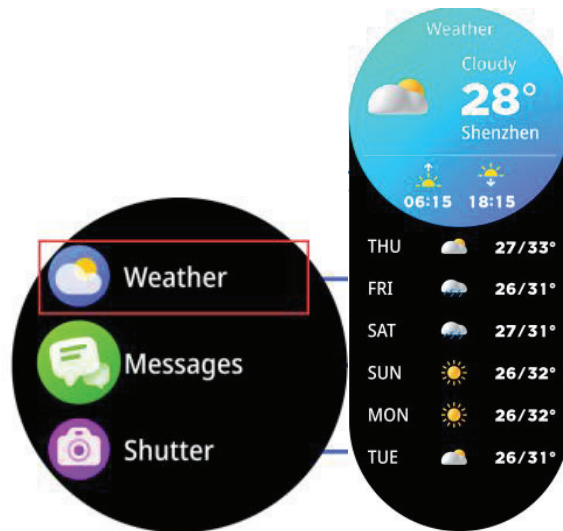

6. Shutter

Use the shutter function to take pictures remotely from your smartwatch.

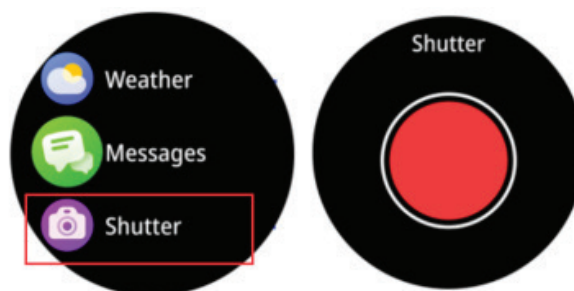

7. Music Control

Tap the music icon to enter the music playback control interface. From there, you can select the previous or next song, play or pause the music, and adjust the volume. You can also tap the icon to switch the audio output between the watch and the phone. To exit the music playback controls, swipe from left to right on the screen.

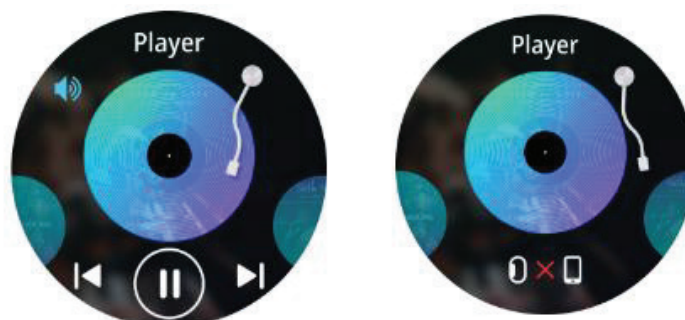

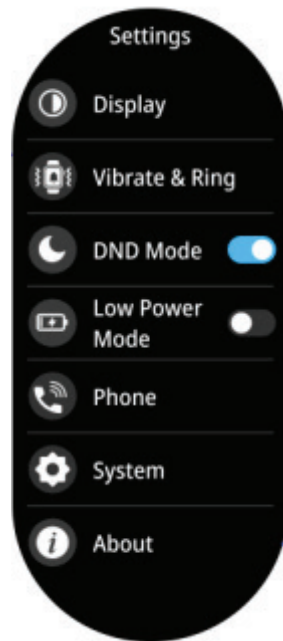

Display Settings: The display includes options for Brightness, Sleep, Watch Face, Menu View, and Wrist Raise functions.



Vibration Adjustment: Adjust the vibration strength of the watch (options: no vibration, weak, or strong).



Do Not Disturb (DND) Mode: When activated, the watch will disconnect the Bluetooth connection and only record steps, heart rate, body temperature, and blood oxygen. When enabled, calls and notifications will be silenced. To view notifications, lift your wrist.



Low Power Mode: Adjust the settings when the watch battery is low to extend battery life.



Call Reset: Tap OK to clear the contacts and call history.



About: Access the "About" section to find the MAC address and software version of your smartwatch.

Specifications

Screen Size	1.38"
Screen Resolution	TFT 240x240
Water Resistant Level	IP67
Bluetooth Version	5.4
Battery Capacity	210mAh
RAM/ROM	128Mb
Working Time	Up to 4 Days
Standby Time	Up to 12 Days
Charging Time	2.5H
Bluetooth Frequency	2402mhz-2480mhz
Compatibility	iOS 12+, Android 8.0+
Product Weight	34.3g
Product Size	44.6 x 9.7mm

Precautions

1. Ensure that both the device and its accessories remain dry to prevent the buildup of dirt and bacteria.
2. Avoid using a microwave, blower, or any other heat sources to dry or heat the device. Refrain from using the device in high-temperature environments or placing it in areas subject to extreme heat.

- 3.** Protect from strong impacts or vibrations, as these may cause damage to the device or its accessories. Keep the product away from direct sunlight, high temperatures, humidity, or open flames.
- 4.** Keep the device away from children and animals to prevent accidental ingestion or damage.
- 5.** Protect the device from impacts and avoid dropping it, as this could cause significant damage.
- 6.** Do not expose the device to extreme temperatures, as this may affect its performance and longevity.
- 7.** Do not clean the device with abrasive detergents, as these may cause surface damage. Use a soft, damp cloth for cleaning instead.
- 8.** After charging, always disconnect the charging cable from the power source to prevent short circuits when the cable comes into contact with conductive objects.
- 9.** This smartwatch is not a medical device. The data provided by the watch is for reference purposes only and should not be used for diagnostic or treatment purposes.

Disposal

This product must not be disposed of as unsorted household waste. It is important to separate such waste for proper treatment and recycling, in compliance with local waste management regulations.



Warranty

Products that you buy directly from our **Porodo** website or shop come with a 24-month warranty.

When you buy **Porodo** products from any of our approved sellers, you only get a 12-month warranty. If you want to extend this warranty, go to our website at **porodo.net/warranty** and fill out the form with your information. Don't forget to upload a picture of the product too. After we've checked and accepted your request, we'll send you an email to confirm that your product's warranty has been extended.

For more info, please check:
porodo.net/warranty

Contact Us

If you have any questions about this Privacy Policy, please contact us at:
info@porodo.net

Website: **porodo.net**

Service Support: **support@porodo.net**

Instagram: **porodo**