

**PORODO**



**Porodo**

**Vireo**

**Smart Wireless Mouse**

SKU: PDAMBTMGY

# Table of Contents

Preface	2
Product Overview	2
Instructions for Use	3
Different Modes	3
Desktop Mode	4
Air Mode	5
Software Settings	7
Specifications	8
Disposal	9
Warranty	10
Contact Us	10

## Preface

Thank you for purchasing the Porodo Vireo Smart Wireless Mouse. This versatile device combines dual-device connectivity with a touchpad design, offering adjustable DPI for smooth navigation. Its detachable and compact design makes it easy to carry, while the spotlight indicator light keeps you informed of the status. Enjoy up to 20 days of working time with this sleek, portable solution, perfect for desktop, air, and presentation use.

## Product Overview

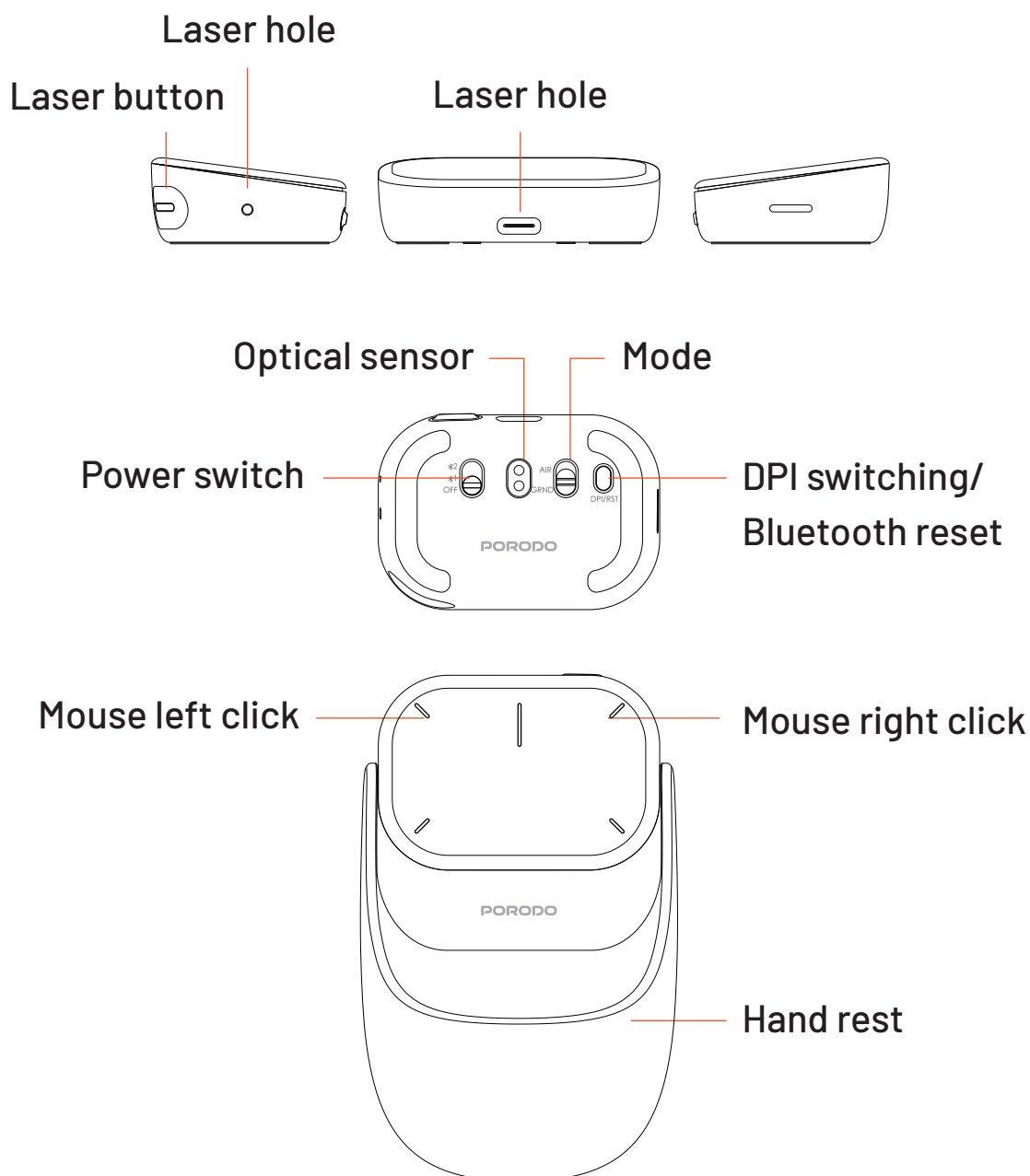

## Instructions for Use

### 1. Power On/Off

Move the power toggle switch to turn on or turn off the device.

### 2. Charging

When charging, the indicator light will display red. Once charging is complete, the light will remain steadily green. When the battery is low, the red light will flash intermittently.

### 3. Bluetooth Connection

**3.1** After powering on, a flashing blue LED indicates the device is in pairing mode.

**3.2** Depending on the toggle position, the device name will appear as PDAMBTM\_1 or PDAMBTM\_2.

**3.3** Open your Bluetooth settings, locate the device name, and select it to pair.

**3.4** Once successfully connected, the blue LED will stop flashing.

**3.5** For subsequent use, the device will automatically reconnect to the last paired device.

### 4. Bluetooth Reset

**4.1** To reset the current Bluetooth connection, press and hold the DPI/RST button for 3–5 seconds.

**4.2** The blue LED will flash, indicating the device is ready to pair with a new connection.

## Different Modes

**Desktop Mode:** Once the device is successfully paired via Bluetooth, toggle to the GRND position to activate Desktop Mode. In this mode, the device operates seamlessly as both a mouse and a touchpad.

**Air Mode:** After establishing the Bluetooth connection, switch the toggle to the AIR position to engage Air Mode. This mode enables the device to function either as an air mouse or as a laser pointer for presentations.

## Desktop Mode



**Press Left/Right Side:** This action simulates the left and right mouse buttons.



**Vertical Slide:** Used for scrolling through pages. The highlighted area indicates the designated sliding zone.

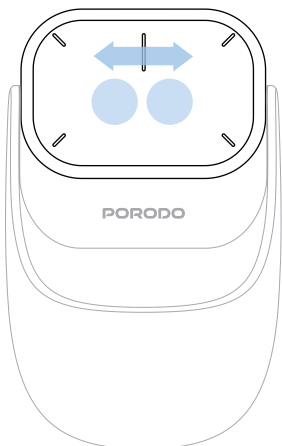

**Two-Finger Horizontal Slide:** Enables switching between desktops.

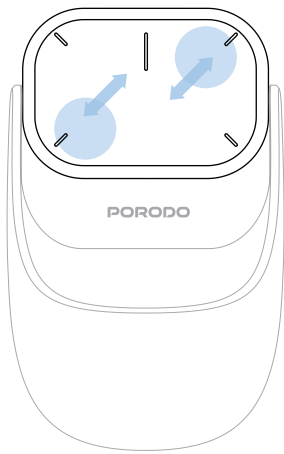

**Two-Finger Pinch/Expand:** This gesture allows you to zoom in or out. By default, this feature is disabled and can be enabled through the driver interface.

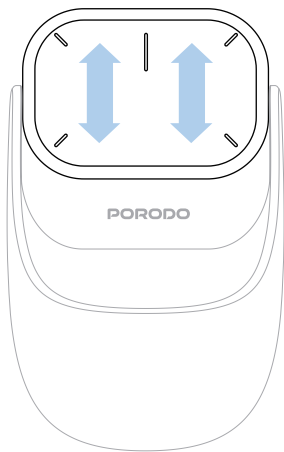

**Two-Finger Upward Slide:** This gesture displays the multitasking view.

**Two-Finger Downward Slide:** This gesture reveals the desktop view.

## Air Mode

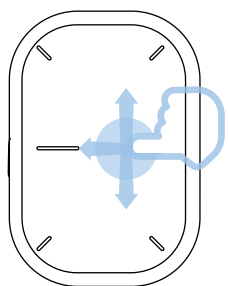

**Touch on the Surface:** This gesture moves the cursor on the screen.

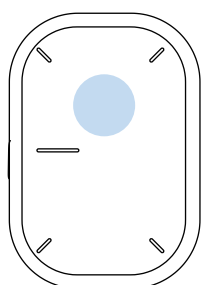

**One-Finger Tap (without pressing):** This action performs a left mouse click.

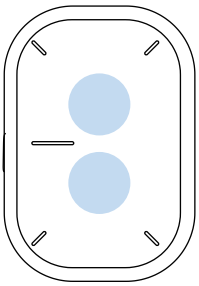

**Two-Finger Tap:** This action performs a right mouse click.

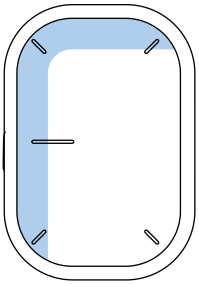

**Swipe Left or Top Edge:** This gesture enables vertical or horizontal scrolling.

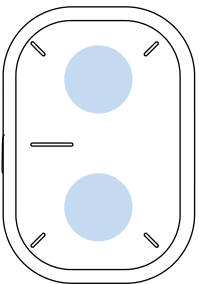

**Press Down on the Upper Half:** This action will scroll the page upward.

**Press Down on the Lower Half:** This action will scroll the page downward.

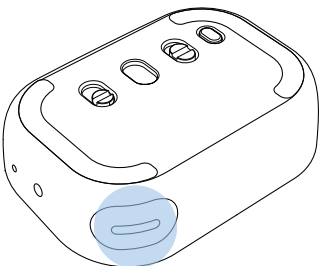

**Press the Laser Button:** This will turn the laser on.

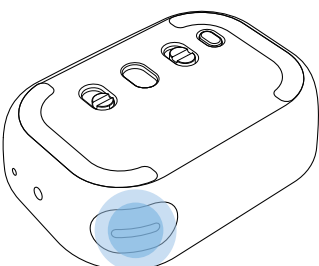

**Double-Click the Laser Button:** This will switch between the air mouse, spotlight, or digital light modes. Driver support is required for these modes.

# Software Settings

Please download and install the software from our website, where you can select the appropriate version for your system (MacOS or Windows). Driver software is available for download at: [www.cheerdots.com](http://www.cheerdots.com)

## 1. Desktop Mode

In Desktop Mode, you can enable or disable specific functions as needed. Additionally, you can configure shortcut functions for the one-finger left/right swipe gestures to enhance your office efficiency.

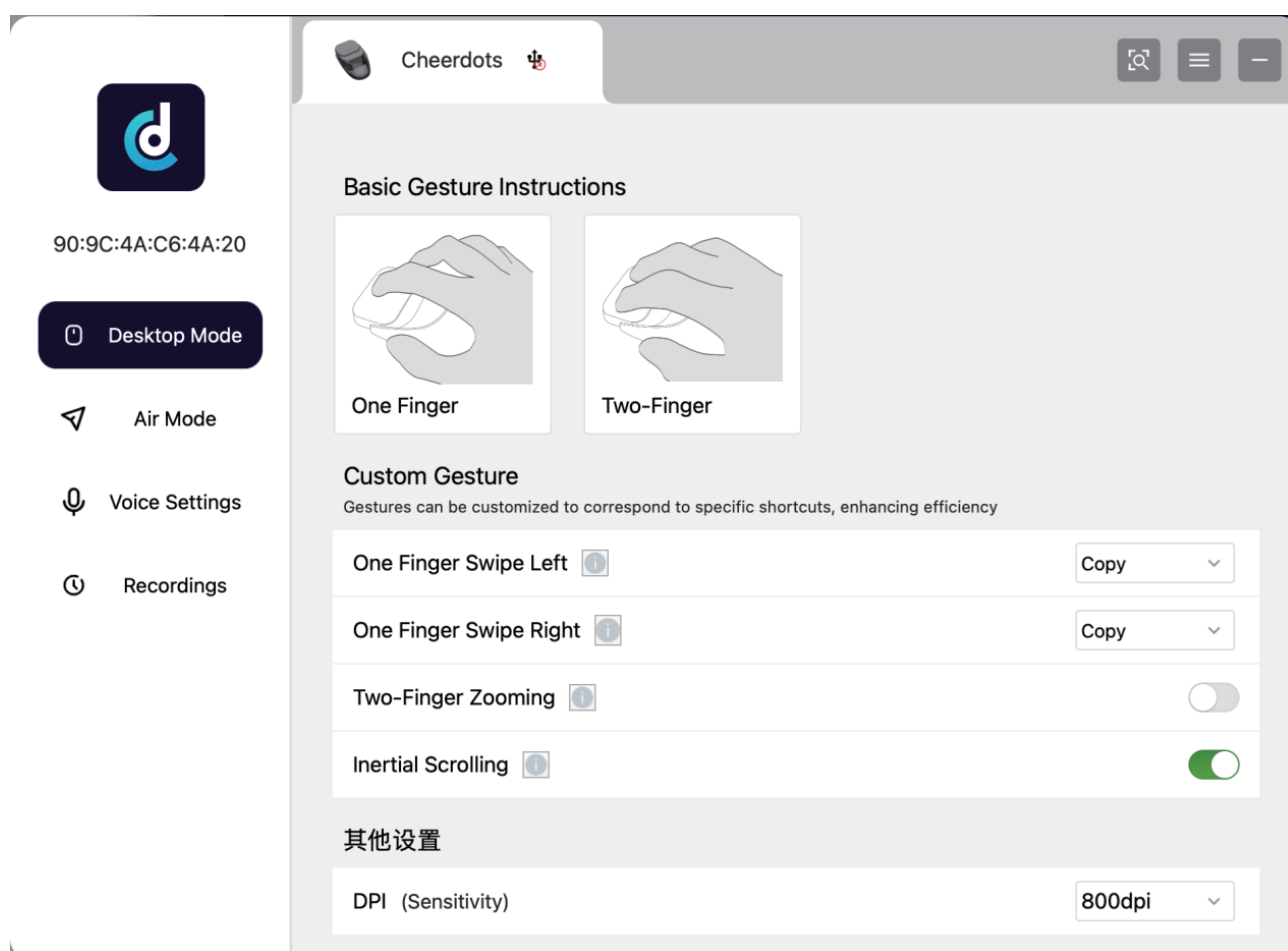

## 2. Air Mode

In Air Mode, you can switch to the professional PowerPoint presentation mode. This mode supports features such as Spotlight Mode and Digital Light Mode.



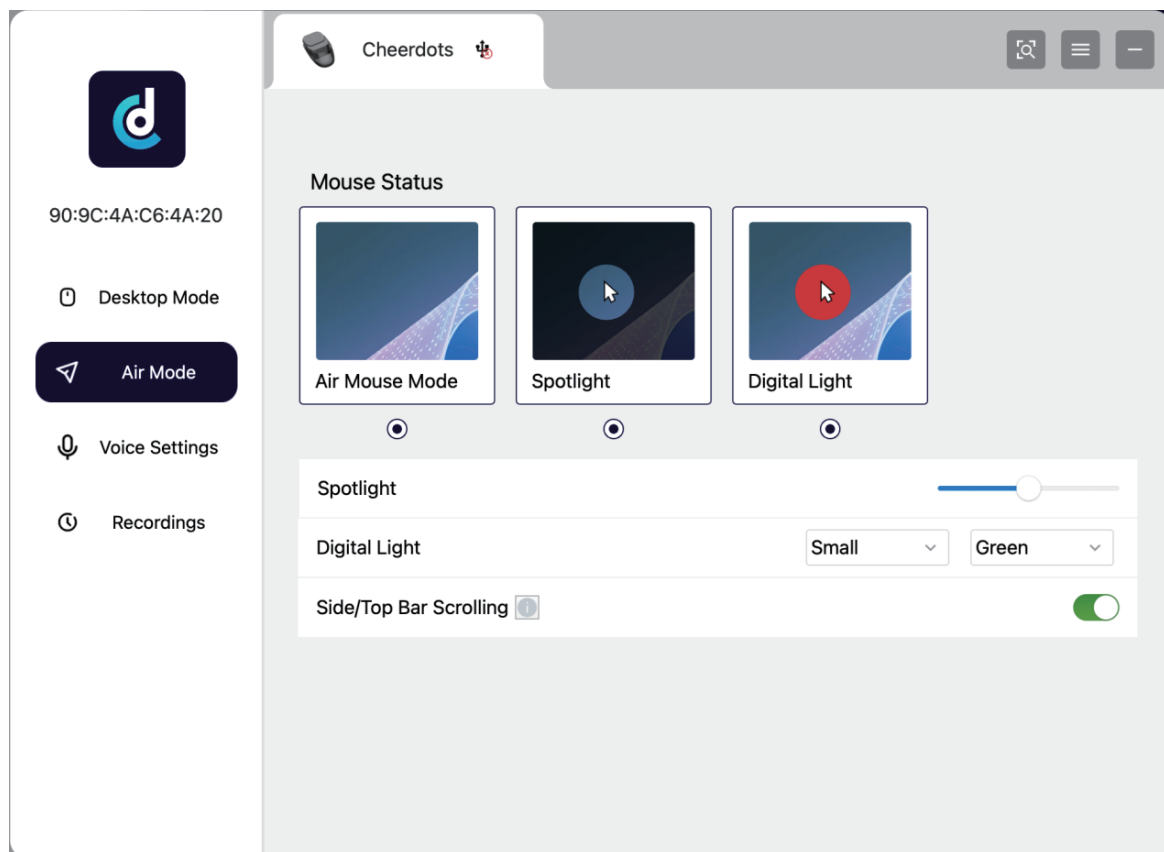

## Specifications

Input	5V/1A, 5W
Battery Capacity	450mAh
Charging Time	2.5H
Working Time	20 Days
DPI	800 ,1200 ,1600 ,2000 ,2400
Bluetooth Version	5.0
Compatibility	Windows, MacOS
Product Weight	70g

Product Dimensions	35*68*108mm
Model Number	PDAMBTM
Working Temperature	-10°C to 40°C

## Disposal

This product must not be disposed of as unsorted household waste. It is important to separate such waste for proper treatment and recycling, in compliance with local waste management regulations.



## **Warranty**

Products that you buy directly from our **Porodo** website or shop come with a 24-month warranty.

When you buy **Porodo** products from any of our approved sellers, you only get a 12-month warranty. If you want to extend this warranty, go to our website at **porodo.net/warranty** and fill out the form with your information. Don't forget to upload a picture of the product too. After we've checked and accepted your request, we'll send you an email to confirm that your product's warranty has been extended.

For more info, please check:  
**porodo.net/warranty**

## **Contact Us**

If you have any questions about this Privacy Policy, please contact us at:  
**info@porodo.net**

Website: **porodo.net**

Service Support: **support@porodo.net**

Instagram: **porodo**