



**Porodo Soundtec**

**ECHO FLEX Retractable  
ENC Neckband**

SKU: PD-STWLEP033

# **Table of Contents**

Safety Instructions	2
Battery Safety Warning	2
Schematic View	3
Power On/Off	3
Connecting with One Phone	3
Connecting with Two Phones	4
Music and Volume Control	5
Call Management	6
Factory Reset	6
Charging Instructions	6
Battery Warning	7
Specifications	7
Retracting the Wire	7
Warranty	8
Contact Us	8

Before using the product, please carefully read this User Manual to guarantee correct usage and keep it secure for future reference.

## **Safety Instructions**

1. Avoid using headphones at high volume levels to prevent potential hearing loss caused by prolonged noise exposure.
2. If you are in an unsafe or potentially hazardous situation, stop using the headphones to ensure your safety.
3. Use headphones responsibly by moderating both the volume and the duration of usage.
4. Keep the volume at a reasonable level to remain aware of your surroundings. If the volume is too high and causes tinnitus or discomfort, lower it immediately.
5. It is not recommended to listen to music while driving, as it may distract you from road safety.
6. Clean the headphones with a soft, dry cloth. Avoid exposing them to water, as this can cause permanent damage.
7. If you experience discomfort, irritation, or any adverse reactions while using the headphones, discontinue use immediately.
8. Store and use the headphones in a temperature range between -15°C (5°F) and 55°C (131°F). Extreme temperatures may damage the headphones or reduce their battery life.

## **Battery Safety Warning**

1. Use the original charging cable to charge the headset. Using an incompatible charging cable may damage the battery or the headset.
2. The headset is equipped with a built-in rechargeable battery. Do not attempt to remove the battery, as this may result in damage to the device.
3. Keep the battery away from high temperatures, such as direct sunlight, open flames, or other sources of overheating, to prevent damage or safety risks.
4. Always use the correct type of battery when replacing it. Improper battery replacement may lead to a risk of explosion.
5. Use a power adapter with an output of 5V/1A for charging. Using a high-voltage adapter may cause the device to overheat or become damaged.

## Package Contents

1. Neckband
2. Earplugs \*2
3. USB Cable

## Schematic View

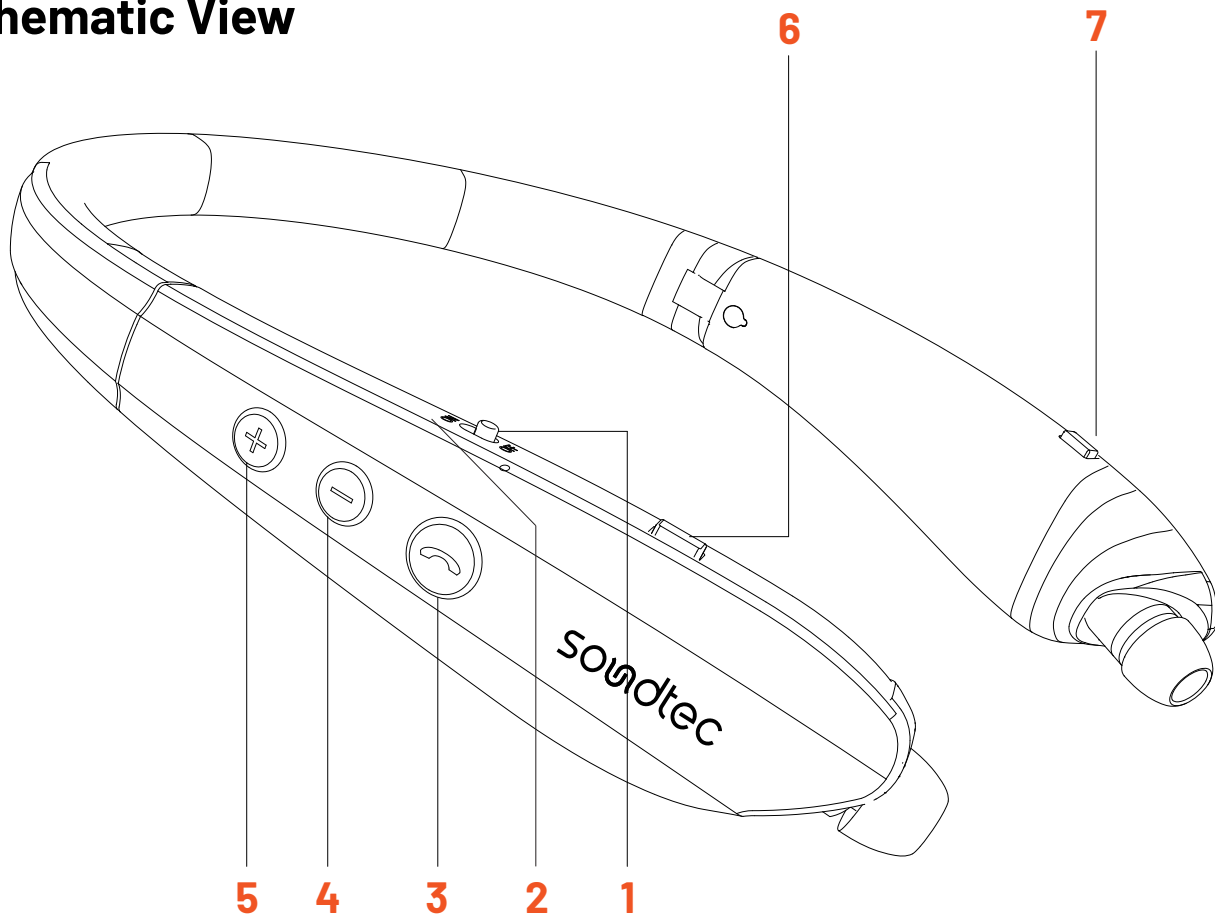

- |                                     |                                  |
|-------------------------------------|----------------------------------|
| 1. Power Button                     | 5. Increase Volume - Next Track  |
| 2. LED Indicator                    | 6. Earbud Retract Button (Right) |
| 3. Multifunction Button             | 7. Earbud Retract Button (Left)  |
| 4. Decrease Volume - Previous Track |                                  |

## Power On/Off

1. Power On: Slide the switch to the "ON" position. A voice prompt will announce "Power on." A blue light will illuminate to confirm activation. The device will vibrate once for additional confirmation.

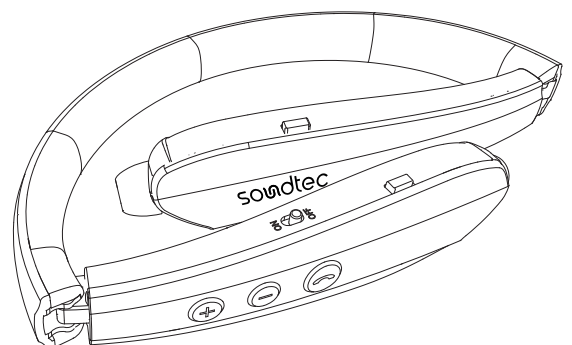

**2. Power Off:** Slide the switch to the "OFF" position.

A voice prompt will announce "Power off."

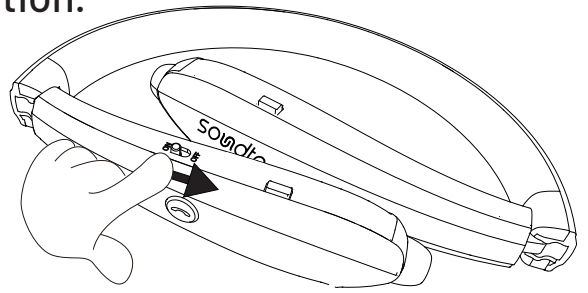

## Connecting with One Phone

**1. Activate Pairing Mode:** Switch the headphones to the "ON" position to enter auto-pairing mode.

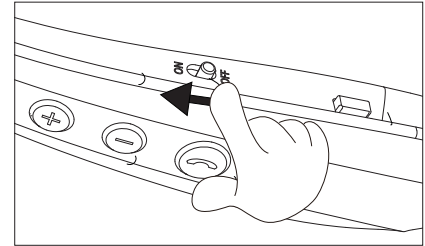

**2.** The blue and red lights will flash alternately, indicating the headphones are ready to pair.

**3.** A voice prompt will announce, "Ready to pair."

**4.** Turn on Bluetooth on your mobile device.

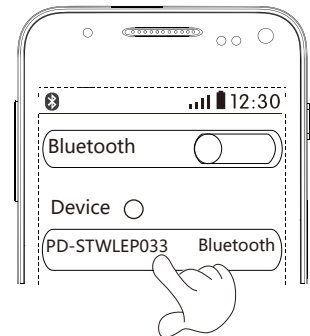

**5.** Connect to the headphone by searching the device name "PD-STWLEP033" in the list of available Bluetooth devices on your mobile phone and select it to connect.

**6.** A voice prompt will announce, "Device connected," to confirm successful pairing.

**Note:** After pairing successfully, the device will automatically reconnect the next time it is used. If the connection fails, the headset will automatically re-enter pairing mode. In such cases, please manually pair the device by following the provided instructions.

## Connecting with Two Phones

**1.** Turn off Bluetooth on both the mobile device and the headset.

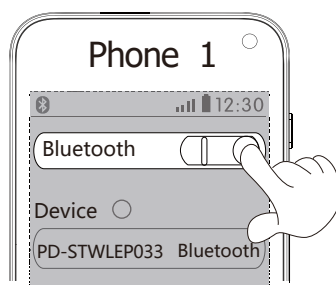

Disable Bluetooth connection on the phone.

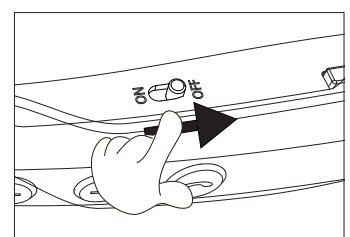

Turn off the headset.

2. Turn on Bluetooth on the second mobile phone and select "PD-STWLEP033" from the list of available devices to connect.

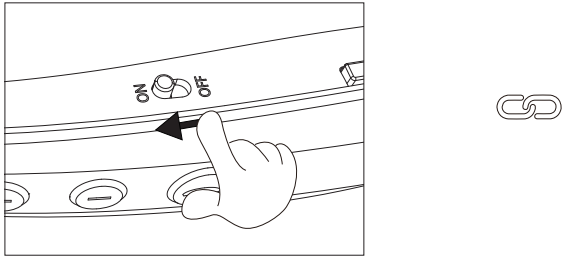

Turn on the headset.

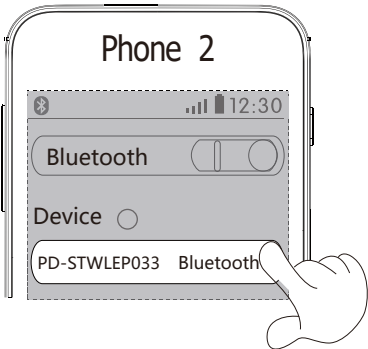

Choose PD-STWLEP033 to connect.

3. Reactivate Bluetooth on the first mobile phone and connect to "PD-STWLEP033" again to establish a dual connection.

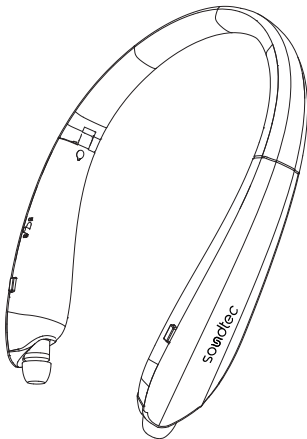
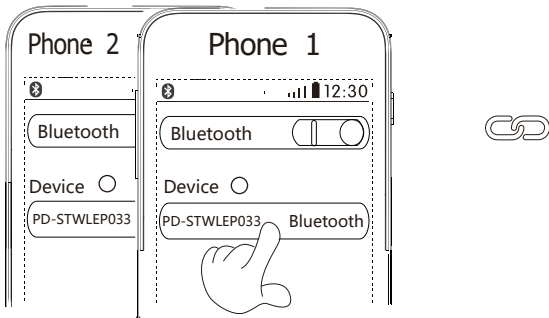

## Music and Volume Control

Function	Button	Operation
Play/Pause		Single-press <sup>*1</sup>
Next Track		Single-press <sup>*1</sup>
Previous Track		
Volume up		*.....
Volume down		

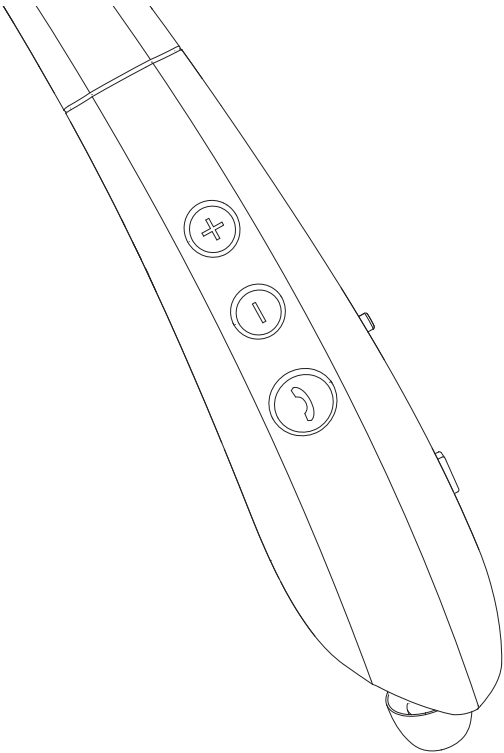

## Call Management

### Answer/End Call



Single-press the button once to answer an incoming call or to hang up an ongoing call.

### Reject Call

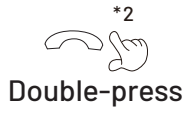

Double-press the  button to reject an incoming call.

### Switch Calls

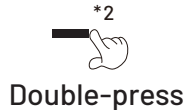

Double-press the  button to toggle between calls on your mobile phone and the headset.

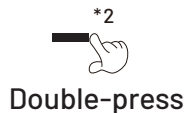

### Activate Voice Assistant

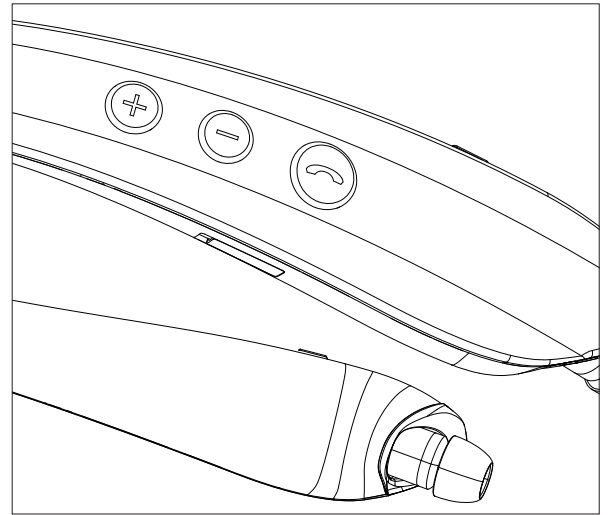

Double-press the  button to activate Siri or another voice assistant set up on your device.



## Factory Reset

While the device is charging, press and hold the  button. The red and blue light  flashes twice to signal that the reset operation is complete.

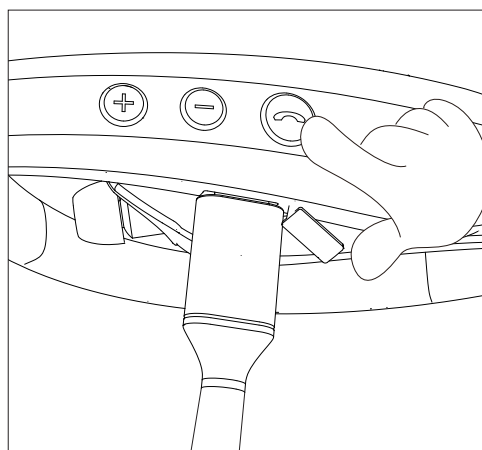

## Charging Instructions

Use the charging cable to attach the headset to a power source. The red indicator light will turn off once the device is fully charged.

**Note:** The headset cannot be powered on during the charging process.

## Battery Warning

1. Avoid disassembling, bumping, crushing, or exposing the battery to fire.
2. Discontinue use immediately if the battery exhibits severe swelling.
3. Do not store or operate the battery in high-temperature environments.

## Specifications

Battery Capacity	300mAh
Input	5V/1A
Charging time	≤2.5 hours
Talk time	≥35 hours
Music Time	≥30 hours
Standby time	≥300 hours
Bluetooth	V5.2
Working Distance	≤10m
Frequency Range	2.402GHz-2.480GHz
Input	≤5V/1A

## Retracting the Wire

### [A] Correct Method

To extend the lifespan of the headset, gently retract the wire by following these steps:

1. Hold the wire securely with your hands.
2. Press the Earbud Retract Button to begin retracting the earbuds into your hands.

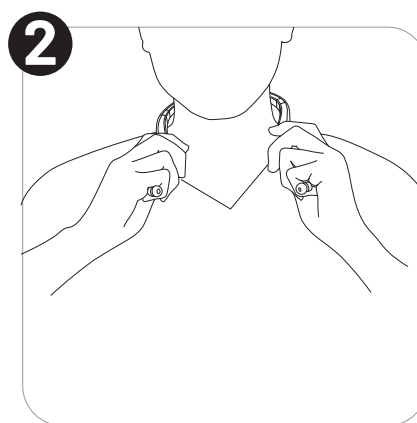
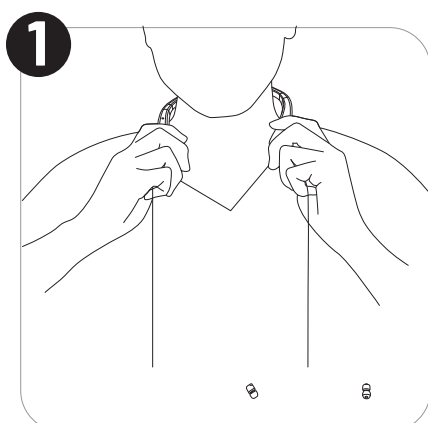



3. Release your grip on the wire while maintaining a relaxed curve in your fingers.
4. Press the Earbud Retract Button again to allow the remaining wire to fully retract into the headset.

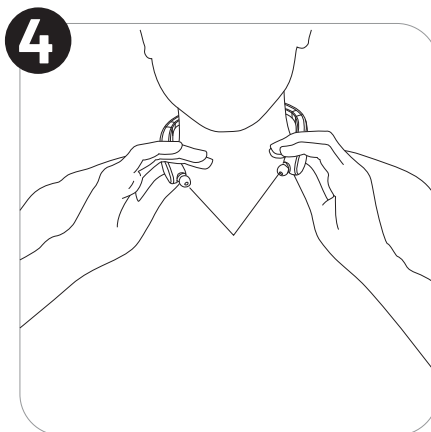
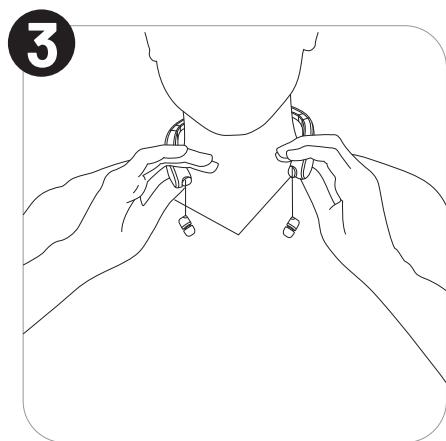

### **[B] Incorrect Method**

Avoid pressing the Earbud Retract Button directly without holding the wire. Doing so may cause the earbuds to retract forcefully, potentially damaging the headset.

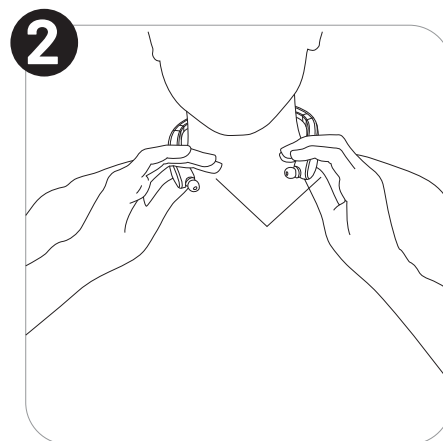
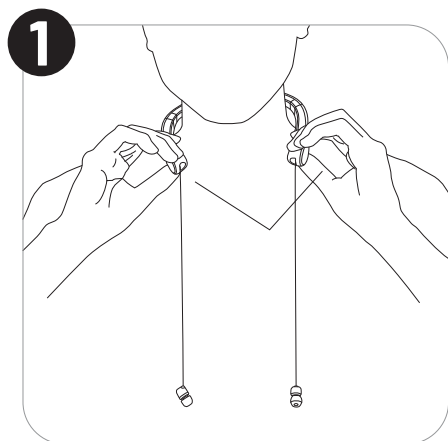

## **Warranty**

Products that you buy directly from our **Porodo** website or shop come with a 24-month warranty.

When you buy **Porodo** products from any of our approved sellers, you only get a 12-month warranty. If you want to extend this warranty, go to our website at **<https://porodo.net/warranty>** and fill out the form with your information. Don't forget to upload a picture of the product too. After we've checked and accepted your request, we'll send you an email to confirm that your product's warranty has been extended.

For more info, please check:

**<https://www.porodo.net/warranty>**

## **Contact Us**

If you have any questions about this Privacy Policy, please contact us at:

**[info@porodo.net](mailto:info@porodo.net)**

Website: **[porodo.net](https://porodo.net)**

Service Support: **[support@porodo.net](mailto:support@porodo.net)**

Instagram: **[porodo](https://www.instagram.com/porodo)**