

PORODO
LIFESTYLE



Porodo Lifestyle
Multi-Surface Steam Cleaner

SKU: PD-LFST145

Table of Contents

Safety Warning	2
Child Safety	2
Device Safety	3
Schematic View	3
Before the First Use	4
Instructions for Use	4
Specifications	5
Cleaning and Maintenance	5
Disposal	5
Warranty	6
Contact Us	6

Safety Warning

This section includes important instructions on safety of use. Please Read Carefully and Keep for Future Reference.

Note: By ignoring the safety instructions, the manufacturer cannot be held responsible for any damage.

- 1.** If the supply cord is damaged, it must be replaced by the manufacturer, its service agent, or similarly qualified persons to avoid a hazard.
- 2.** Never move the appliance by pulling the cord, and ensure the cord does not become entangled.
- 3.** The user must not leave the device unattended while it is connected to the power supply.
- 4.** This appliance is intended for household use only and for the purpose for which it was designed.
- 5.** To protect yourself from electric shock, do not immerse the cord, plug, or appliance in water or any other liquid.
- 6.** The appliance should only be connected to an earthed socket. Ensure that the voltage indicated on the appliance matches the local voltage before plugging it in.

Child Safety

This appliance should not be used by children under 8 years of age. It can only be used by children aged 8 years and above, and persons with reduced physical, sensory, or mental capabilities, or lack of experience and knowledge, if they are supervised or understand the hazards and instructions concerning the use of the appliance in a safe manner. Children should not play with the device. Keep the device and cord out of the reach of children under 8 years old. Cleaning and maintenance should not be performed by children unless they are over 8 years old and under supervision.

Device Safety

1. The emitted steam is extremely powerful; do not aim it at people, animals, or delicate items.
2. Allow the appliance to cool down before cleaning or storing it.
3. Do not direct the liquid or steam towards equipment containing electrical components, such as the interior of ovens.
4. The surface may get hot during use.

Schematic View

1. Spray Nozzle
2. Ring Cover
3. Safety Cap
4. Steam Button
5. Lock & Unlock
6. Body Cover
7. Indicator Light
8. Window Squeegee
9. Upholstery Nozzle
10. Fabric Cover
11. Round Brush
12. Funnel
13. Measuring Cup
14. Angle Nozzle
15. Straight Nozzle
16. Round Brush
17. Detergent Bottle

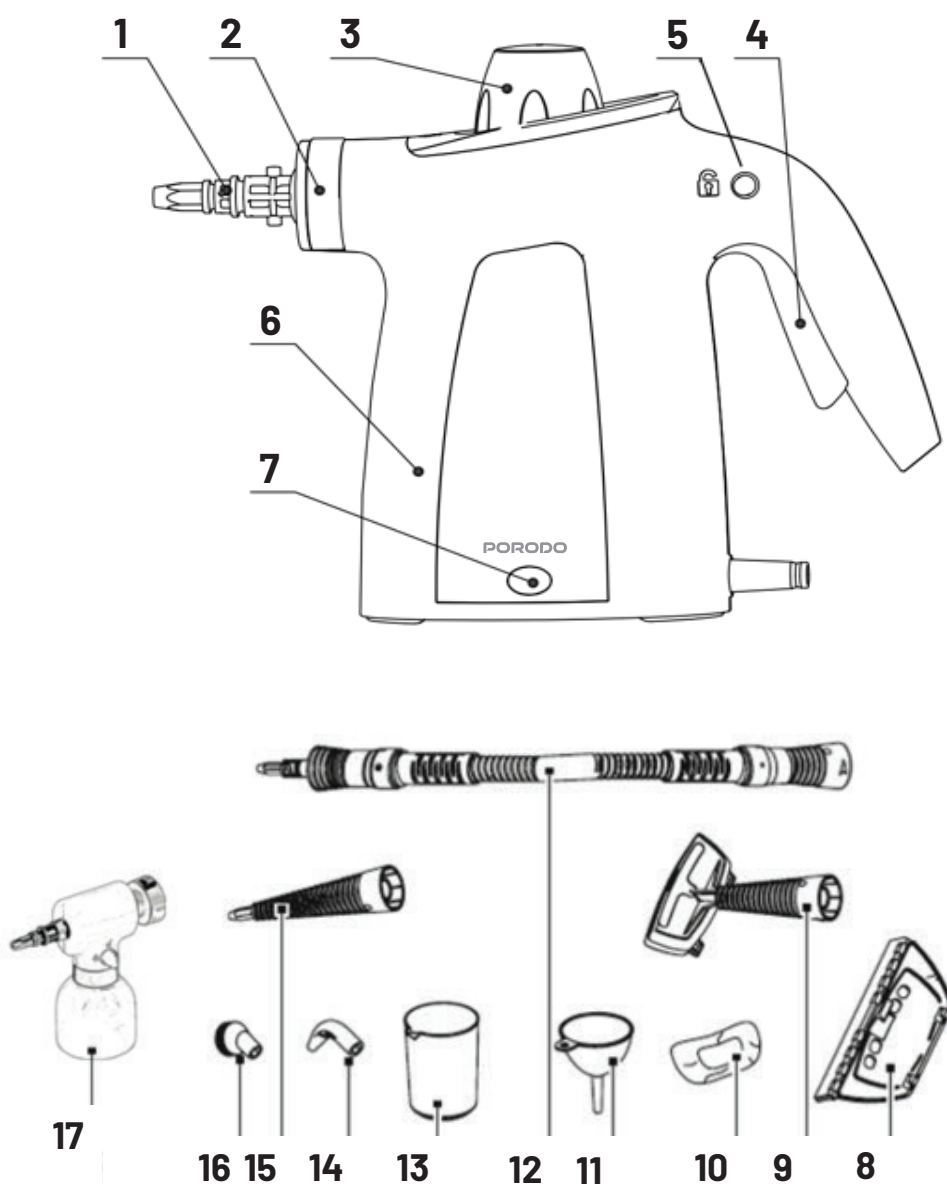

Before the First Use

1. Ensure the appliance is unplugged from the mains power supply.
2. Carefully unscrew and remove the water tank cap.
3. Fill the water tank with water using a measuring cup or similar device (350ml).
4. Securely load the water tank cap, ensuring it is thoroughly tightened.

Warning: To supplement water during operation, use caution. The reservoir may contain pressurized steam. Release steam by pressing the steam button until the steam exits the machine (ensure the device is unplugged). Then, slowly unscrew the lid of the water tank using kitchen gloves to protect yourself from the heat and steam.

Instructions for Use

1. Select and attach the desired tip or nozzle from the available accessories.
2. Plug the power cord into an electrical outlet. The device will begin warming up, and after approximately 3 minutes, it will build pressure in the tank. Once ready, press the steam button to begin use.
3. After finishing, press the steam button again until steam no longer exits the machine. Carefully unscrew the lid of the water tank using kitchen gloves to protect yourself from the heat and steam. Some residual steam may still be released. Allow the machine to cool down before storing.
4. Areas of Use: This appliance is ideal for disinfecting and sterilizing surfaces such as sofas, beds, fabrics, clothing, and toys. It is also effective for cleaning doors, windows, and all types of floors. Use it for tackling stubborn dirt on kitchen stoves, ovens, ceramic surfaces, as well as for bathroom and toilet cleaning.

Specifications

Model Number	LFS145
Rated Voltage	220-240V
Rated Frequency	50/60Hz
Rated Power	900-1050W
Water Tank Capacity	350ml
Power Cord	UK 3-Pin Plug

Cleaning and Maintenance

Before cleaning, press the steam button to release the pressure until no steam is emitted, and then allow the device to cool for 5 minutes. Ensure that the appliance is disconnected from the power supply. Clean the outer surfaces of the unit with a slightly damp cloth. Wipe it down with a damp cloth.

Note: Do not add any substances to the water in the tank, including descaling agents, aromatic oils, or cleaning products.

Disposal



This product must not be disposed of as unsorted household waste. It is important to separate such waste for proper treatment and recycling, in compliance with local waste management regulations.

Warranty

Products that you buy directly from our **Porodo** website or shop come with a 24-month warranty.

When you buy **Porodo** products from any of our approved sellers, you only get a 12-month warranty. If you want to extend this warranty, go to our website at **porodo.net/warranty** and fill out the form with your information. Don't forget to upload a picture of the product too. After we've checked and accepted your request, we'll send you an email to confirm that your product's warranty has been extended.

For more info, please check:

porodo.net/warranty

Contact Us

If you have any questions about this Privacy Policy, please contact us at:

info@porodo.net

Website: **porodo.net**

Service Support: **support@porodo.net**

Instagram: **porodo**