

PORODO
LIFESTYLE



Porodo Lifestyle
Portable Outdoor Stove

SKU: PD-LFST077

Table of Contents

Safety Precautions	2
Troubleshooting Cartridge Stove Issues	2
Specifications	4
Instructions for Use	4
Warranty	5
Contact Us	5

Safety Precautions

1. Ensure the stove includes warning labels and clear operating instructions. Specify the correct type of gas cylinder for use.
2. Avoid refilling small gas cylinders.
3. Do not attempt to disassemble the stove yourself.
4. Keep the stove away from other heat sources like induction cookers.
5. Always disconnect and store the gas cylinder separately after using the stove.
6. Do not stack portable stoves with the gas cylinders attached.
7. Do not use the stove in strong winds or hot air conditions. Strong winds may extinguish the flame, and hot air can increase cylinder pressure risking explosions.
8. Do not use containers that retain heat, such as those made from stone sand, or ceramic materials.
9. Use cooking utensils that do not cover or extend beyond the edges of the stove.
10. Improper installation can be dangerous. Follow the instruction manual closely and adhere to all relevant safety regulations.
11. Repairs or replacements should only be handled by authorized professionals or the manufacturer's agents.
12. Do not tamper with any seals on the stove.
13. The stove should only be operated by trained individuals. Keep away from children, infants, pets, and people who lack the ability to safely use the appliance.

Troubleshooting Cartridge Stove Issues

[A] Ideal Flame Characteristics

The ideal flame on a cartridge stove should be light blue with a clear inner flame approximately 60mm high, accompanied by a slight noise and strong firepower. If the flame is weak, consider the following potential causes and solutions:

1. **Blocked Burner Holes:** Dirt may block the burner fire cover holes, preventing the flow of mixed gas. Clean these holes to restore proper flow.

- 2. Clogged Nozzle:** If the nozzle is blocked, unscrew and clean it to ensure gas can pass through.
- 3. Rust in the Regulator or Nozzle:** Rust can prevent gas from flowing from the cylinder. Replace the regulator with a new, qualified one.
- 4. Deformed Copper Tube:** A bent or flattened copper tube can obstruct airflow. Straighten or replace the tube as needed.
- 5. Gas or Valve Issues:** If the gas cylinder is nearly empty or the valve isn't fully open, these conditions can also weaken the flame. Address these issues accordingly.

[B] Red Flames in Cartridge Stoves

Red flames typically indicate an issue and can be caused by:

- 1. Gas Quality:** Moisture or impurities in the combustion gas can cause the flame to turn red.
- 2. Environmental Factors:** Dust, increased moisture, or oil vapor in the air during cooking can lead to red flames.
- 3. Air Intake Adjustment:** Improper adjustment of the air intake can also result in red flames.

[C] Stove Ignition Problems

If the cartridge stove fails to ignite, follow these steps:

- 1. Check the Gas Source:** Ensure the gas source switch is on. If the gas is on, check for any bends or compression in the connecting copper tube.
- 2. No Fire:** If no fire is produced, check the ignition needle. If it doesn't discharge, replace it. If it discharges but still no fire, there might be a blockage in the gas route or a valve malfunction. Replace the faulty valve.

[D] Fire Produced but Issues Persist:

- 1.** If the fire burns normally but the igniter seems misplaced, adjust the igniter downwards and replace the pot support if necessary.
- 2.** If the flame is weak and doesn't reach the stove top, check for low gas pressure. This might be due to a nearly empty gas cylinder or a malfunctioning adjustment valve.
- 3.** If there is fire that reaches the fire cover but doesn't ignite, the valve might be clogged. Use a thin wire to unclog the nozzle.

Specifications

Gas Type	Butane gas cylinder (>%95 Butane)
Gas Consumption	230g/h
Heat Load	3200W
Net Weight	1.44kg
Product Dimension	280×120×85mm
Standard	GB/T38522-2020

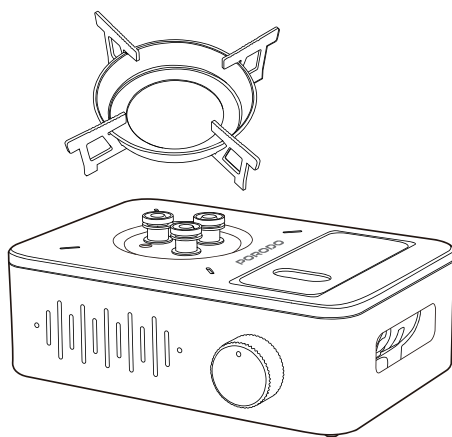

Instructions for Use

1. Start by determining the position and angle of the internal latch on your cartridge stove.
 2. Ensure the notch on the gas cylinder is facing upward.
 3. Carefully align the gas cylinder with the latch and insert it securely into position.
 4. As you insert the gas cylinder, listen for two distinct "ka-ka" sounds indicating the latch has engaged properly.
 5. Rotate the switch counterclockwise and pause for a second to ensure gas flow regulation.
 6. Listen for a "ka-da" sound followed by the emergence of a normal flame signifying a successful installation.
- Note:** Before igniting, please check for any gas leaks. If you smell gas or detect any unusual odors, stop ignition immediately and investigate the source.

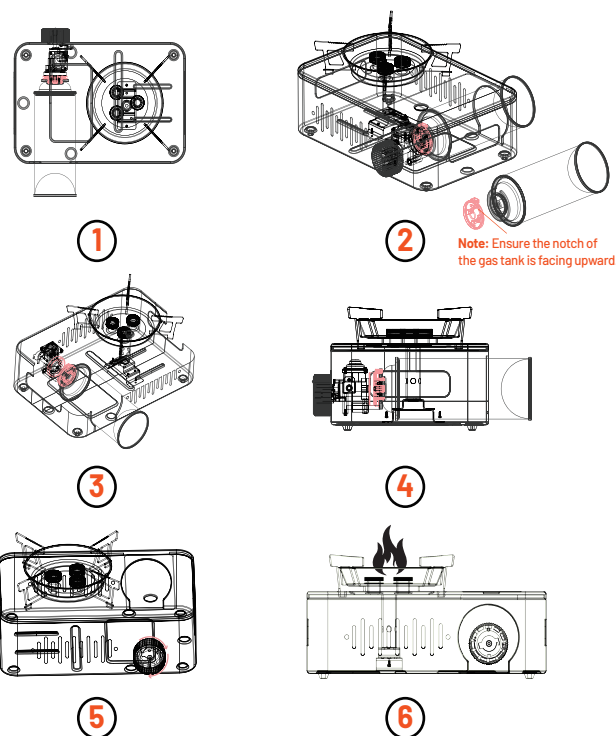

Warranty

Products that you buy directly from our **Porodo** website or shop come with a 24-month warranty.

When you buy **Porodo** products from any of our approved sellers, you only get a 12-month warranty. If you want to extend this warranty, go to our website at **porodo.net/warranty** and fill out the form with your information. Don't forget to upload a picture of the product too. After we've checked and accepted your request, we'll send you an email to confirm that your product's warranty has been extended.

For more info, please check:
porodo.net/warranty

Contact Us

If you have any questions about this Privacy Policy, please contact us at:

info@porodo.net

Website: **porodo.net**

Service Support: **support@porodo.net**

Instagram: **[porodo](https://www.instagram.com/porodo)**