

PORODO
LIFESTYLE



Porodo Lifestyle
**Electric Heated Indoor
Clothes Dryer**

SKU: PD-LFST037

Table of Contents

Safety Instructions	2
Instruction for Use	3
Power ON/OFF Switch	3
Cleaning	4
Specifications	4
Disposal	4
Warranty	5
Contact Us	5

Safety Instructions

Please read all instructions carefully before using this product and keep them for future reference.

- 1.** Always unplug the power cord when not in use.
- 2.** If the power cord is damaged, it must be replaced by a qualified person to prevent hazards.
- 3.** Keep away from children, infants, pets, and individuals with disabilities who are unable to operate the device safely.
- 4.** For indoor use only. Do not use outdoors.
- 5.** Never submerge the product in water, including baths or other containers.
- 6.** Avoid placing the power cord under floor mats, rugs, or carpets to prevent tripping hazards.
- 7.** Always unplug by holding the plug, not the cord.
- 8.** Do not use in areas where gasoline, paint, or flammable liquids are present or stored.
- 9.** Use the product only as described in this manual to prevent fire, electric shock, or personal injury.
- 10.** Children aged 8 and above, and individuals with reduced physical, sensory, or mental capabilities, may use the appliance under supervision or after receiving proper instruction on safe use and understanding the hazards involved.
- 11.** Children should not play with the appliance.
- 12.** Do not allow the children to perform the maintenance and cleaning.
- 13.** Always rinse clothes thoroughly before use to prevent water from dripping onto the ailer.
- 14.** Always unfold all wings before turning on the device.
- 15.** Do not completely cover the ailer with garments or bedding.
- 16.** Not suitable for drying silk, down jackets, or quilts.
- 17.** After 10-15 minutes of use, the heating region will reach temperatures of 45 to 55°C, depending on ambient temperature.
- 18.** This appliance is intended solely for drying textiles washed in water.

Instruction for Use

Note: Carefully read the installation instructions to understand how to use the product.

1. Set the power switch to the [OFF] position. The power indicator light will be off.
2. Plug the power cord into a grounded electrical outlet.
3. After connecting to a suitable power supply, press the power ON/OFF switch. The power indicator will light up, and the warmer will begin heating.

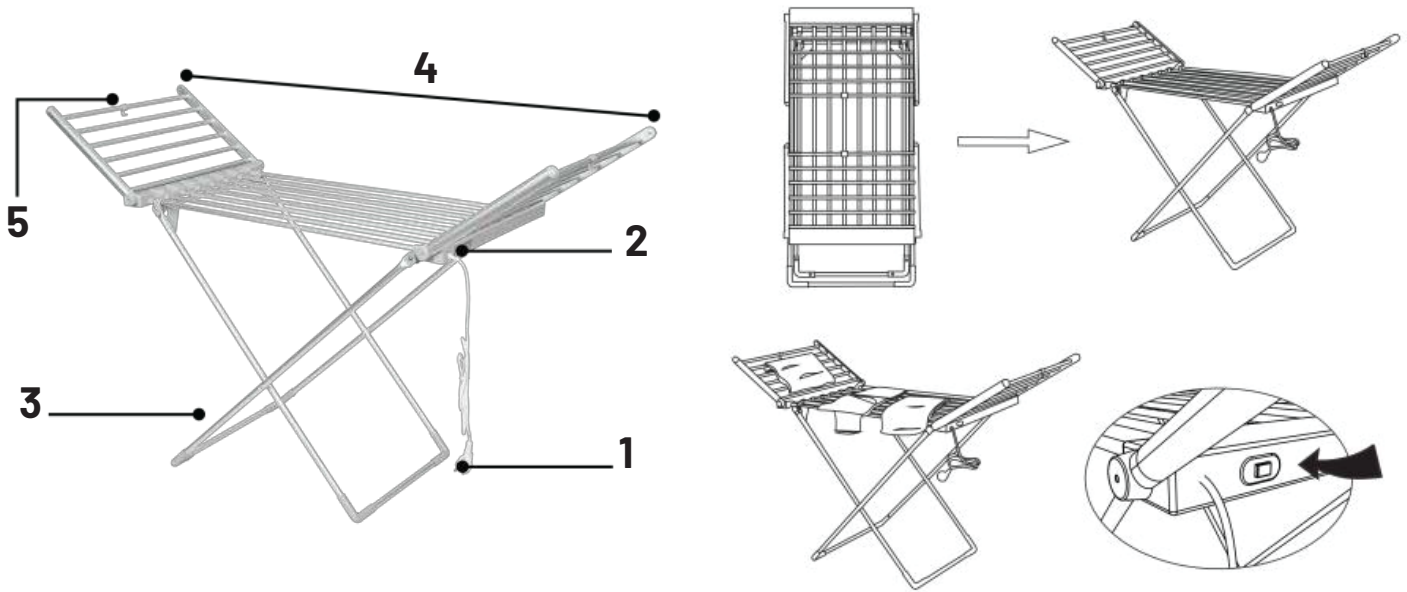

Item	Component	Function
1	Power Cord	Plug the power cord into the electrical outlet to connect to the home power supply.
2	Switch Button	Use the power switch to turn the clothes dryer on and off.
3	Support Legs	The stand base provides stable support for the clothes dryer.
4	Heating Region	Ensure the drying area is clean, dry, and free from obstructions.
5	Fixed Buckle	Fold the airer wings and secure them to save space when not in use.

Power ON/OFF Switch

1. Press the switch to the (I) position. The power indicator will light up, and the product will start working.
2. Press the switch to the [o] position. The power indicator will turn off, and the product will stop working.

Cleaning

1. Before cleaning, unplug the product and allow it to cool down.
 2. Do not submerge the product, power cord, or plug in water. Keep the cord dry.
 3. Never clean the product with alcohol or solvent-based cleaners.
 4. Clean the surface with a damp towel, then dry it with a soft cotton cloth.
- Note:** Do not use metal balls or rough cloths, as they may scratch the surface of the product.

Specifications

Material	Aluminum Heating Tubes x20
Dimension	95×54×147cm, 5.4×54×113cm (Folded Size)
Rated Voltage	240-220V, 60-50Hz
Rated Power	230W
Power Cord	2M UK 3-Pin Plug
Load Capacity	15kg
Heating Tube	20

Disposal



This marking indicates that the product should not be disposed of with other household waste in the EU. To prevent potential harm to the environment or human health from uncontrolled waste disposal, recycle it responsibly to promote the sustainable reuse of materials. To return your used device, please use the designated return and collection systems or contact the retailer where the product was purchased. They can assist with safe, environmentally-friendly recycling.

Warranty

Products that you buy directly from our **Porodo** website or shop come with a 24-month warranty.

When you buy **Porodo** products from any of our approved sellers, you only get a 12-month warranty. If you want to extend this warranty, go to our website at **porodo.net/warranty** and fill out the form with your information. Don't forget to upload a picture of the product too. After we've checked and accepted your request, we'll send you an email to confirm that your product's warranty has been extended.

For more info, please check:

porodo.net/warranty

Contact Us

If you have any questions about this Privacy Policy, please contact us at:

info@porodo.net

Website: **porodo.net**

Service Support: **support@porodo.net**

Instagram: **porodo**