

PORODO
LIFESTYLE



Porodo Lifestyle
Wall Mounted Electric Back Scrub

SKU: PD-LFST033

Table of Contents

Features	2
Package Contents	2
Specifications	2
Schematic View	3
Button Guide	4
Instructions for Use	5
[A] Power On/Off	5
[B] Charging	5
[C] Mode Selection	5
[D] Operating the Device	6
Reset Function	6
Height Adjustment	7
Installation Guide	7
Troubleshooting	9
Safety Precautions	10
Warranty	11
Contact Us	11

Features

1. Features a 182mm diameter brush disk for enhanced cleaning and massaging coverage. Made from various materials that facilitate easy cleaning of the entire back without leaving any areas untouched.
2. Equipped with a sliding track for adjustable height, making it simple to adapt to various user needs.
3. Incorporates a new intelligent sensor design for adaptive strength adjustment, ensuring optimal comfort.
4. The brush head is soft, delicate, and made from environmentally safe materials. It features a magnetic design for easy and versatile head replacement.
5. Offers a unique SPA massage design that not only purifies the skin but also enhances back aesthetics through a relaxing massage.
6. Designed with a split body card holder for easy assembly and disassembly, facilitating safer and quicker charging.
7. Comes with a built-in high-capacity battery that provides long-lasting use and reliability.
8. No drilling required for installation, making it straightforward and hassle-free to set up.

Package Contents

1. Electric Back Scrub
2. Nylon Brush Head
3. Silicone Brush Head
4. Sponge Brush Head
5. Backplate
6. Magnetic Charging Cable

Specifications

Battery Capacity	2600mAh
Rated Voltage	7.4V
Rated Current	3A
Charging Time	3.5h
Rated Power	22.2W
Waterproof Grade	IPX7
Dimension	66×230×292mm

Schematic View

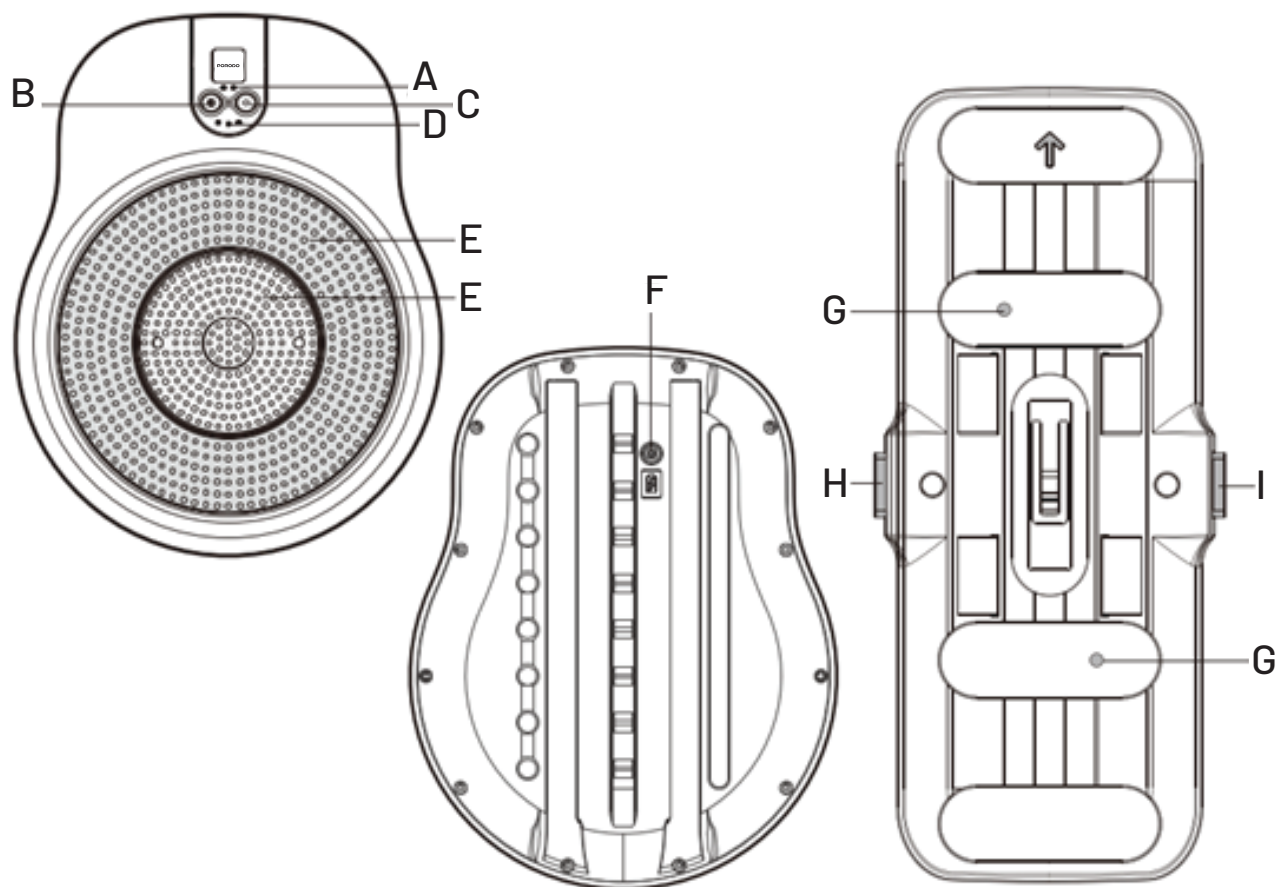

Item	Name
A	Charge/working/low battery indicator
B	On/Off button
C	Mode switching key
D	Mode Indicator
E	Brush head
F	Magnetic charging port
G	Screw reinforcement port (spare)
H	Slide exit button
I	Slide up/down button

Button Guide

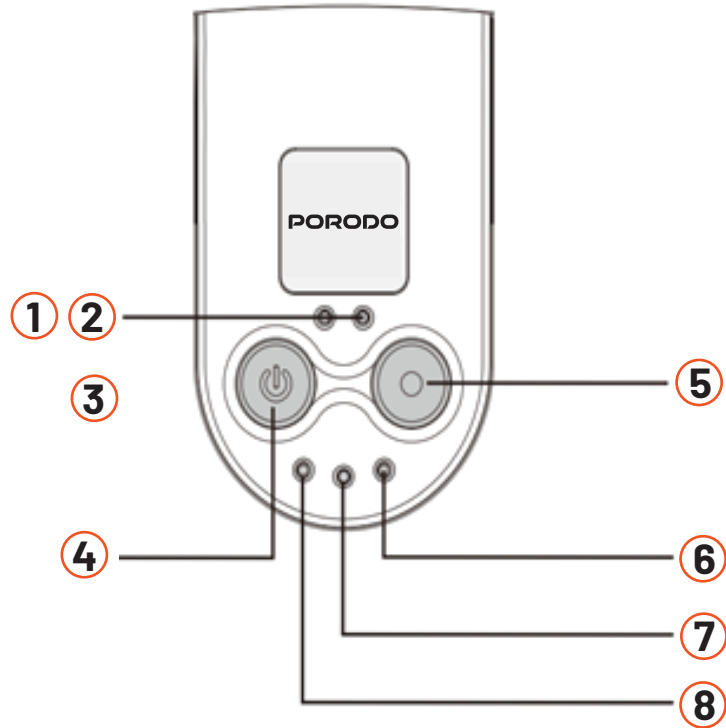

Button/Indicator	Description
① ② Low Power status, Charging Indicator	Battery Weak Power: The red light is continuously on. Battery Low Power: The red light blinks. Charging State: The red light blinks and then turns off when the battery is fully charged.
③ Device Working, Full Charge Indicator	Power On and Working: The green light remains on. Battery Fully Charged: The green light stays on.
④ Power Button	Press the power button to turn on the device, and press again to turn it off.
⑤ Mode Switching Button	Cycle through the modes by turning the power off and back on: Mode 1, then Mode 2, Mode 3, and back to Mode 1.
⑥ Mode 3 Indicator	Bright Blue Light: Always on.
⑦ Mode 2 Indicator	Light Purple Light: Always on.
⑧ Mode 1 Indicator	Orange Light: Always on.

Instructions for Use

[A] Power On/Off

1. Power On: Press the on/off key (power button) to activate the device. Upon activation, the orange light for Mode 1 will turn on, indicating that the product is operational and the current mode indicator remains on.

Power Off: Press the on/off key (power button) four times to turn off the device. Once shut down, all indicator lights will turn off, and the product will stop working.

[B] Charging

1. Low Power: The red indicator light signals low power, prompting you to charge the device.

2. Charging: While charging, the red indicator light flashes. Once fully charged, the red light turns off and the green light remains on to indicate full power.

3. Note: During the charging process:

3.1 The device will not operate, and all buttons are disabled.

3.2 If the charging function fails, all keys and buttons will not respond.

[C] Mode Selection

The mode switching key offers three distinct settings:

A. Mode 1

Adaptive Mode – Automatically defaults to this mode upon power-up. It provides a lower rotational speed initially and adjusts speed and strength dynamically based on the pressure detected on the brush plate.

B. Mode 2

Mid-range Mode – Offers a medium speed and strength setting, suitable for regular cleaning tasks.

C. Mode 3

Low-range Mode – Operates at a lower speed for gentle cleaning.

D. Additional Features:

1. Each mode is accompanied by a unique indicator light that illuminates when selected.

2. The device will automatically turn off after 60 minutes of continuous use or if no load is detected within 3 minutes, ensuring energy efficiency and safety.

3. The primary difference between the mid-range and low-range modes lies in their rotational speeds.

[D] Operating the Device

1. Press the start button to activate the device.
2. Apply bath soap or shower gel to the dampened brush head.
3. Rest the brush lightly against your back without pressing too hard.
4. Allow the main unit to run, moving it gently to clean the skin effectively.
5. After cleaning, rinse your back with water.

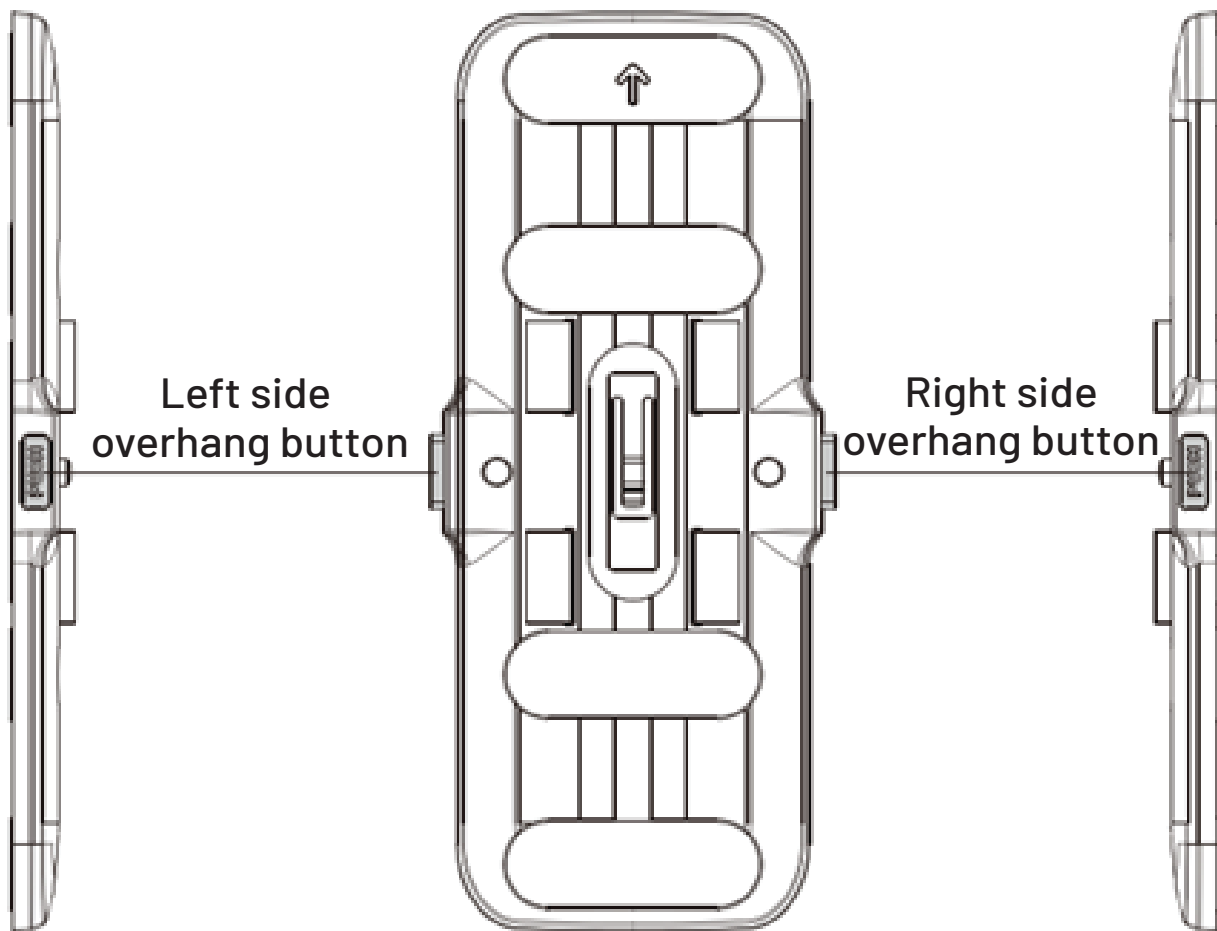

Reset Function

1. Long press the power button for five seconds. All indicator lights will flash to indicate the reset process has begun.
2. Press the mode switching key three times. The Mode 1 indicator light will turn on and the motor will start.
3. Let the motor run until it stops on its own. This completes the self-learning phase and the mainframe will return to normal operation.

Important Note: Avoid adjusting or touching the brush head during the self-learning process to prevent any disruptions or errors. The self-learning function must proceed without interference with the brush head.

Height Adjustment

1. Press and hold the up and down button with one hand while holding the main unit. Slide the unit up or down to your desired height. The host can slide up and down, allowing for an adjustment range of about 16 centimeters. Release the button to lock the unit in place at the chosen height.

2. Press and hold the right side up and down slide button. Slide the main unit upward to its highest position. Release this button, then press the left side slide exit button while still holding the main unit. This action allows the unit to slide up further and be removed from its position.

Attention: Securely hold the device when adjusting its position up or down to remove the main unit, preventing any unintended sliding.

Charging Guide

After detaching the main unit, connect it to a power source using the special magnetic charging cable included in the accessories. Attach the cable's magnetic interface to the corresponding area on the main unit to initiate charging. Use a standard charger for this purpose.

Note: Do not leave the charger plugged into the outlet for extended periods when not in use.

Installation Guide

[1] Choose the Installation Location

Select a smooth and flat wall in the bathroom, ensuring it is clear of other objects. Measure the height at which the bath machine will be installed using a ruler, measuring from the floor to the bottom of the backboard. Refer to the reference table provided below for guidance.

Installation Height (cm)	60	70	80	90	100	110	120	130
Corresponding Height (cm)	120-100	130-110	140-120	160-140	170-150	180-160	190-170	200-180

[2] Clean the Installation Position

Assess the desired installation area on the wall and mark the appropriate height. Use a clean rag to thoroughly clean the wall surface at this height, ensuring it is dry and free from debris to prepare for the installation of the back plate.

[3] Install the Bath Machine Back Plate

Remove the back plate of the bath machine from its packaging and peel off the protective film. Align the back plate with the marked installation area and press firmly against the wall. Smooth out any air bubbles to secure the back plate in place.

Attention: The adhesive surface of the backboard must be flat, smooth, and completely free of dust and moisture.

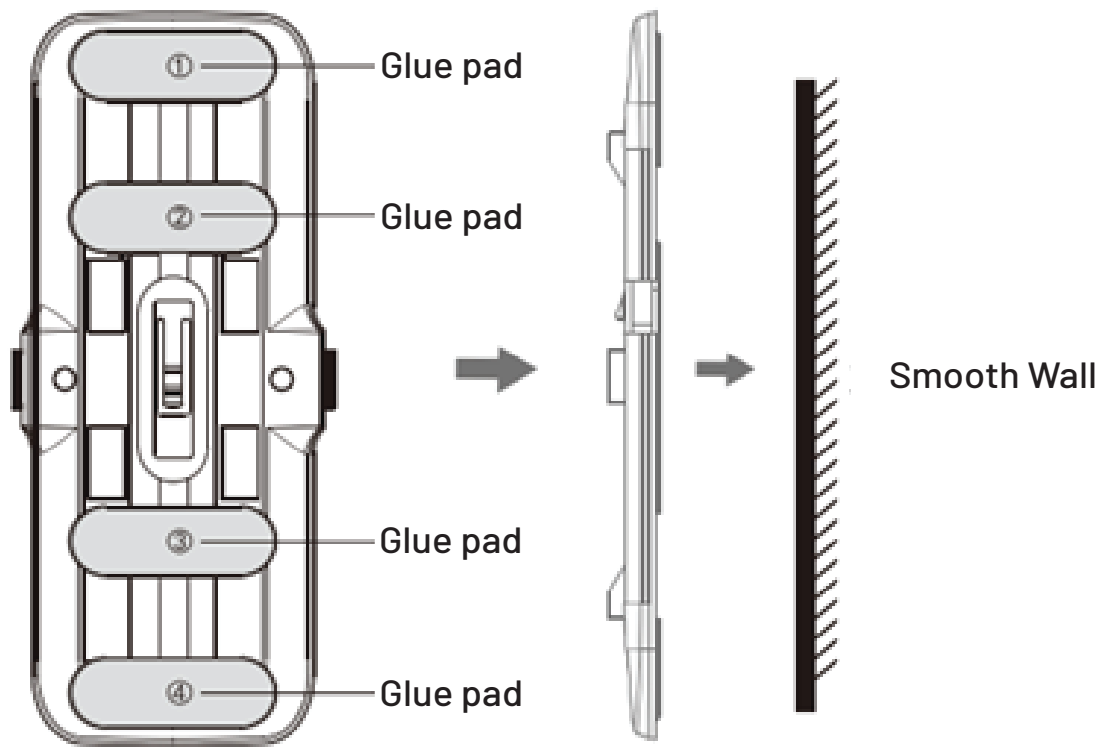

[4] Install the Main Body of the Bath Machine

After the back plate has set for 24 hours, slide the main body of the bath machine onto the track from the top. Use the slide button on the right side of the backboard to adjust the position of the main body, which can move up and down along the track for optimal placement.

[5] Installation of Bath Machine Brush Head

5.1 Nylon Brush Head

Align the brush head with the corresponding position on the host. Gently rotate until you hear a "click" from the magnetic suction head, indicating the installation is complete.

5.2 Silicone Brush Head

Similarly, place the brush head onto the designated position on the host. Gently rotate until the magnetic suction head emits a "click" sound, confirming that the installation is secure.

[6] Removal of the Main Body of the Bath Machine

Press and hold the "up and down slide button" on the back panel while simultaneously sliding the host upward to the highest point on the track. Release the up and down slide button, then press the slide button. Continue to slide the mainframe upward to completely detach it from the mount.

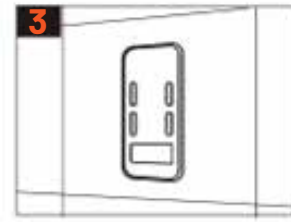
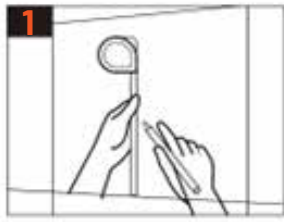

Troubleshooting

Problem	Possible Cause	Solution
The device does not turn on.	The battery is discharged and requires charging.	Charge the battery for at least 2 hours before attempting to turn on the device.
The indicator light is turned on, but the motor fails to operate.	Low battery is causing a failure in the control program.	If the charging indicator light does not illuminate, this may indicate a circuit issue with the motherboard. Please contact the authorized service professionals.
None of the buttons are functioning.	A button is stuck, or the main unit is malfunctioning.	Check if the keys provide tactile feedback. If there is no tactile response, the key may be faulty. Please contact the authorized service professionals if other issues are observed.
The main unit is unable to move along the track.	Issues with the slide or stand button.	Ensure that the main unit aligns properly with the bracket and slides smoothly. Confirm that the side button is functional and can be pressed.
The device is not charging.	The magnetic charging port may be dirty, or there is a potential failure with the charger or main unit.	<ol style="list-style-type: none">1. Clean the magnetic charging port to remove any dirt.2. Check that the charger is securely plugged in.3. If the host indicator light turns on, the charger is functioning correctly. If not, try using a different charger.4. If the host indicator light still does not turn on, the issue may be with the main unit itself.

Safety Precautions

[A] Prohibited Actions

1. Unauthorized modifications and usage are strictly prohibited.
2. Do not charge the device in the bathroom.
3. Children should not adjust or disassemble the main unit on their own.
4. This device is not suitable for children under 6 years of age to use alone. Individuals with heart disease, severe high blood pressure, diabetes, or those with electronic implants should consult a doctor before use.

[B] Precautions

1. If the user has broken skin or any other skin condition, use the device with caution.
2. This product should be used with caution by pregnant women, individuals with heart disease, severe high blood pressure, or those who have undergone surgery within the past 3 months.
3. Stand firmly while using the device to prevent slipping.
4. If you have long hair, tie it up before use to avoid the risk of hair entanglement.
5. Do not use the product while charging. Charging in the bathroom or other humid environments is not recommended.
6. When adjusting the height or dismantling the main unit, hold the device securely to prevent it from falling.
7. Children should not adjust or disassemble the main unit on their own.
8. Use only the standard charging cable provided with the product. If the main unit is dropped, hold it firmly to prevent further falls and potential safety hazards.
9. If the main unit has fallen, there may be a risk of water ingress, which can cause it to malfunction.

Attention: If the main unit has been dropped, visible gaps may allow water to seep inside.

Warranty

Products that you buy directly from our **Porodo** website or shop come with a 24-month warranty.

When you buy **Porodo** products from any of our approved sellers, you only get a 12-month warranty. If you want to extend this warranty, go to our website at **porodo.net/warranty** and fill out the form with your information. Don't forget to upload a picture of the product too. After we've checked and accepted your request, we'll send you an email to confirm that your product's warranty has been extended.

For more info, please check:
porodo.net/warranty

Contact Us

If you have any questions about this Privacy Policy, please contact us at:
info@porodo.net

Website: **porodo.net**

Service Support: **support@porodo.net**

Instagram: **porodo**