

LèPRESSO



LePresso

**PRECISION Conical
Burr Grinder**

SKU: LPCGHY1430BK

Table of Contents

Precautions	2
Schematic View	4
Specifications	4
Notes on Using the Grinder	5
Instructions for Use	5
Grinding Precautions	8
Care and Maintenance	9
Troubleshooting	11
Disposal	12
Warranty	12
Contact Us	12

Precautions

To ensure your safety while using this electrical product, please carefully follow the instructions below:

- 1.** This product is designed exclusively for grinding coffee beans. Avoid grinding other substances to prevent damage.
- 2.** Read all instructions thoroughly before first use to prevent injuries caused by improper operation.
- 3.** After unpacking, inspect the product for any visible damage or missing parts. If you notice any defects, do not use the product and contact the dealer immediately.
- 4.** Keep all packaging materials, such as cartons and plastic bags, away from children to avoid the risk of suffocation or injury.
- 5.** This appliance is intended for indoor household use only. Do not use it outdoors. Also, avoid placing it near gas tanks, induction cookers, or on stovetops to prevent accidents.
- 6.** The manufacturer is not liable for any damage resulting from negligence or improper use.
- 7.** Keep the product out of reach of children and pets. This appliance is not suitable for use by children. When used near children, adult supervision is necessary.
- 8.** This appliance should not be operated by individuals (including children) with limited physical, sensory, or mental abilities, or those lacking experience or knowledge, unless supervised or instructed by someone responsible for their safety.
- 9.** Do not handle the appliance, power cord, or plug with wet hands. When unplugging, always grasp the plug itself rather than pulling on

the cord. During use, ensure the cord does not hang over edges or come into contact with hot surfaces or other appliances.

10. Use only accessories recommended by the manufacturer. Using unauthorized accessories may cause fire, electric shock, or injury.

11. If the appliance malfunctions, turn off the power immediately. Do not attempt repairs yourself. Contact the dealer and have the appliance inspected and repaired by authorized service personnel.

12. Before each use, check the power cord, plug, and other components for damage. If any damage is found, discontinue use and contact customer service or a qualified repair center for replacement. Do not attempt to repair the appliance yourself to avoid hazards.

13. Always unplug the appliance when not in use or before disassembling or cleaning. Never immerse the appliance in water or other liquids.

14. Ensure the appliance is turned off before adjusting or replacing any accessories.

15. When cleaning the exterior of the product, simply wipe it gently with a damp brush or a soft cloth.

16. To prevent fire, electric shock, or personal injury, never immerse the plug or power cord in water or any other liquids.

17. Avoid any contact with moving parts of the appliance during operation.

18. If the appliance will not be used for an extended period, please clean the bean storage bin, upper and lower blades, powder outlet channel, and coffee powder container to prevent contamination. Coffee residue can deteriorate due to prolonged storage and rotation.

19. The device should not be maintained or cleaned by children. Keep it out of their reach at all times.

20. Do not expose the appliance to extreme weather conditions, such

as excessive heat, cold, humidity, or direct sunlight.

Schematic View

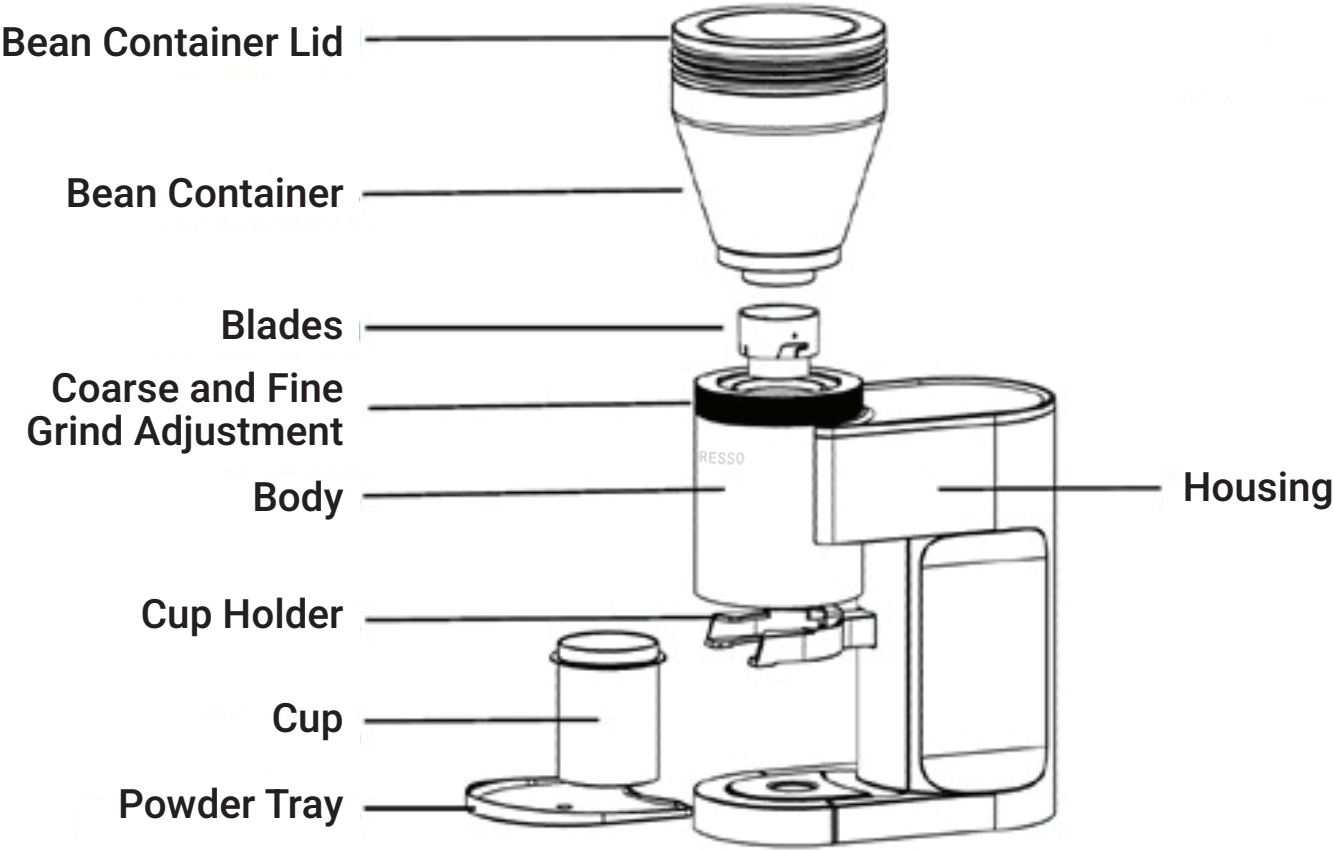

Specifications

Rated Power	150W DC Motor
Rated Voltage	220-240V
Rated Frequency	50/60Hz
Bean Hopper Capacity	400g
Ground Coffee Cup Capacity	90g

Portafilter Compatibility	51mm / 58mm
Material	ABS, 304 Stainless Steel
Power Cord	UK 3-Pin Plug
Product Size	247 x 130 x 425mm
Product Weight	2.6 kg

Notes on Using the Grinder

- 1.** Position the appliance securely on a flat, stable surface, ensuring it is kept away from open flames or any high-temperature devices.
- 2.** Verify that the surface is dry and place the appliance beyond the reach of children to prevent accidents.
- 3.** This product is intended for use with a standard voltage of 220 to 240V AC only. Confirm that the power supply is stable and adequate to support safe operation. Maintain sufficient clearance around the plug to enable quick disconnection from the socket if necessary.
- 4.** If the existing power outlet is incompatible with this appliance, seek assistance from a qualified electrician to install or replace the outlet with one that meets the required specifications.

Instructions for Use

- 1.** Add Roasted Coffee Beans:

Fill the bean storage compartment with roasted coffee beans and securely close the lid. Do not exceed the maximum capacity of 400

grams to ensure optimal performance.

2. Select Grinding Coarseness:

Adjust the grinding coarseness according to your preferred brewing method:

Coarse: Ideal for French press

Medium: Suitable for hand-brewed coffee



Medium-fine: Recommended for Moka pot brewing

Fine: Best for Italian-style coffee



Extra Fine: Designed for Turkish coffee



Please be aware that factors such as the coffee's variety, origin, freshness, and roast level can influence the grinding results. Fine-tune the setting to match your personal taste preferences.

3. Select Function:

3.1 Touch the operation panel (), select the display (), after the displayed value is reset to zero then press the power button () to start. The default program is 9g. To adjust the quantity, press the +/- keys to increase or decrease the weight in 1g increments. The maximum adjustment allowed is $\pm 3g$.

The next time you power on this function, the displayed gram weight will revert to the default 9g.

3.2 Touch the operation panel (), select the display (), after the displayed value is reset to zero then press the power button () to start. The default program is 18g. To adjust, press the +/- keys to increase or decrease the weight in 1g increments. The maximum adjustment allowed is $\pm 5g$. The next time you power on this function, the displayed gram weight will revert to the default 18g.

3.3 Touch the operation panel (), select the display (), after the displayed value is reset to zero then use the +/- keys to adjust the weight according to your needs, followed by pressing the power button () to start. Adjustments are made in 1g increments. The maximum value for this function is 60g, and the minimum value is 5g. The weight displayed the next time you use this function will be the weight set during the previous use.

3.4 Grinding:

Plug the power cord into the power socket. Select the desired function and press the power button () to start grinding. During the grinding process, do not open the bean storage compartment cover, and do not move the aroma cup or funnel.

3.5 Standby Mode:

If there is no operation within 20 minutes, the machine will automatically enter standby mode. In standby mode, all buttons become inactive. To cancel standby mode and return to working mode, press and hold the power button () for 2 seconds.

Note:

The powder output of this product is regulated according to the preset working weight. Once the powder output reaches the set weight, the machine will automatically stop. Since the funnel bracket contains an electronic scale, avoid touching the funnel or the container placed on the funnel bracket during operation to prevent inaccurate powder measurements.

This product uses an electronic scale to monitor the powder output. Therefore, before each operation, when the funnel or aromatherapy cup is placed on the funnel holder, 99 will be displayed on the operation panel. After 2 to 3 seconds, the weight will automatically return to zero. During this period, do not touch the funnel or container to ensure accurate powder output.

Grinding Precautions

- 1.** Please ensure the bean storage lid is securely closed to preserve the full flavor and aroma of the coffee beans.
- 2.** For the freshest and most flavorful coffee, grind only the amount needed for immediate brewing.
- 3.** This product is designed to grind medium to dark roasted, dry coffee beans only. It is not suitable for lightly roasted or flavored coffee beans, such as sticky or vanilla-flavored varieties. Grinding any ingredients other than coffee beans is strictly prohibited.
- 4.** After grinding, do not return the ground coffee powder to the bean storage compartment for re-grinding, as this may cause cleaning difficulties, powder clogging, and adversely affect the machine's performance.
- 5.** Idle operation is not permitted.

Warning:

If the machine is used continuously and overheats, the built-in protection mechanism will activate, causing the machine to stop. Please wait approximately 30 minutes for the machine to cool down before resuming normal operation.

6. During grinding, you may press the start/stop button at any time to halt the process.
7. The aroma cup has a maximum capacity of 60 grams of ground coffee. Please ensure the coffee powder does not overflow.

Care and Maintenance

1. Ensure the power is turned off and the power plug is unplugged before performing any maintenance.
2. Empty any remaining coffee beans from the bean hopper.
3. Rotate the bean storage bin counterclockwise to remove it. Rinse the bean bin, bean bin cover, aroma cup, and powder tray with water, then dry them thoroughly.
4. Remove the upper blade disc. Use the powder ejector to clear any remaining coffee grounds, then clean the upper and lower blade discs and surrounding areas with a brush. Wipe all parts with a dry cloth.
5. Align the two buckles on the upper blade disc with the back of the machine, secure it by tightening clockwise, and reattach the bean storage bin.

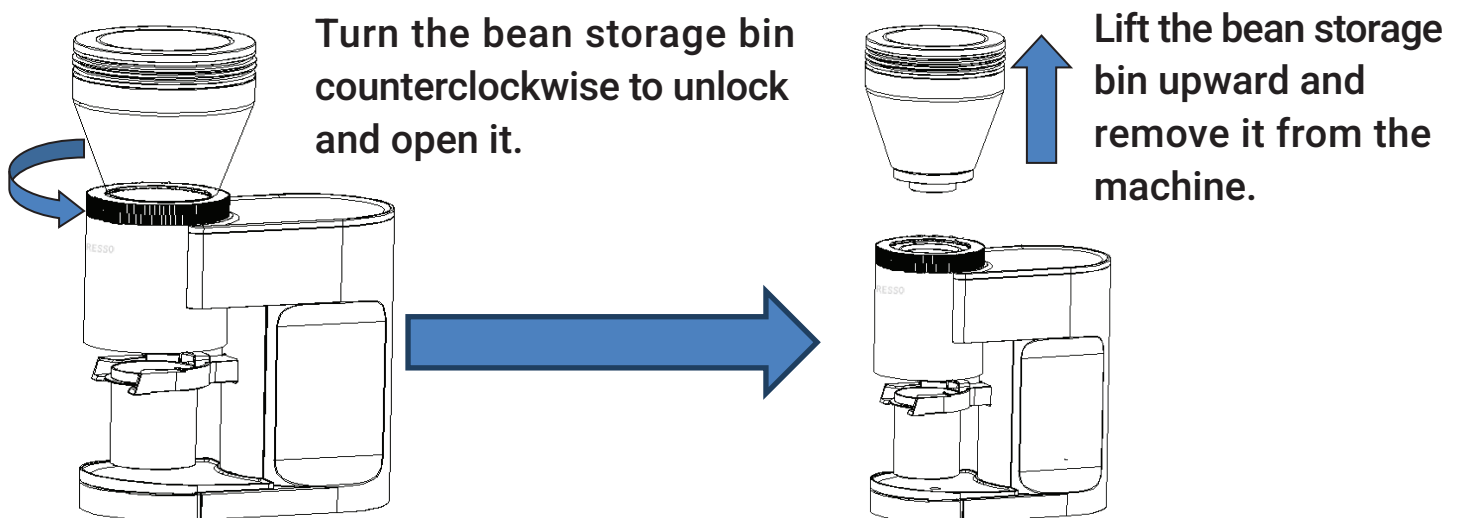

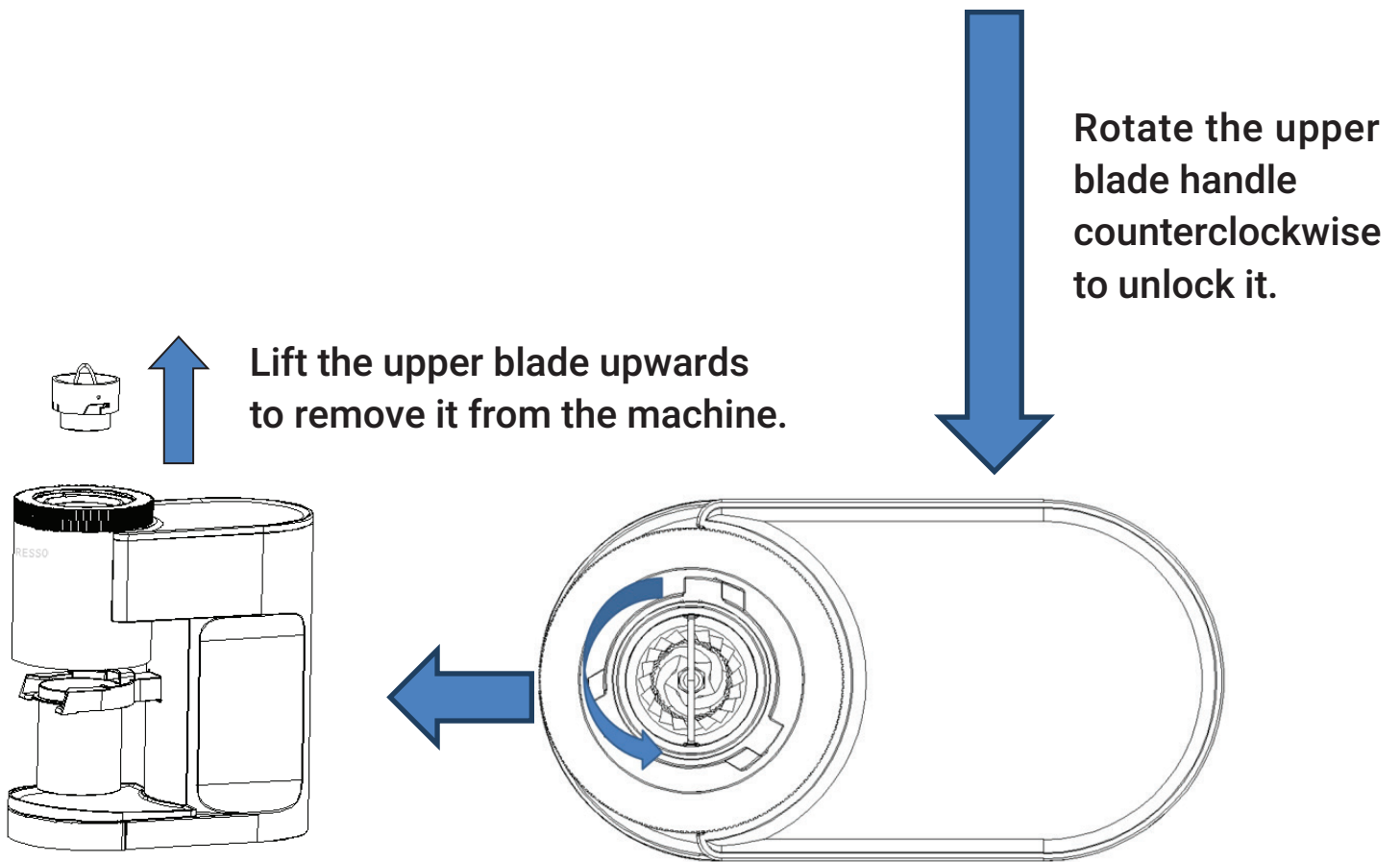

6. Wipe the machine body with a damp cloth and dry it thoroughly.
7. After cleaning, reassemble the machine by following the steps in reverse order, referring to the diagram as needed.
8. When not in use, store the machine in a dry, cool place.

Note: When reinstalling the upper blade disc, ensure the buckles are properly aligned with the grooves to prevent malfunction.

Troubleshooting

Problem	Possible Cause	Solution
Product Does Not Work	Verify whether there is a power outage.	Wait until the power is restored before using the product.
	Ensure the power plug is securely inserted into the socket.	Ensure that the plug is properly and securely inserted into the socket.
	Confirm that the power outlet switch is turned on.	Verify that the power switch on the socket is turned on.
	Check if any coffee grounds are stuck in the bean storage bin.	Check if an excessive amount of coffee powder or coffee beans is present, as this may cause the product to malfunction.
	Make sure the power button is fully pressed with sufficient travel.	Confirm that the bean storage bin is correctly assembled and properly installed.
Product Suddenly Stops Working During Operation	Confirm that the machine is properly powered on.	Inspect the plug for any looseness and secure it if necessary. Double-check that the socket is receiving power.
	Determine if the motor has overheated and triggered the automatic protection mechanism.	If the motor has overheated, allow the machine to cool down for approximately 20 to 30 minutes before resuming operation.

Disposal

This product must not be disposed of as unsorted household waste. It is important to separate such waste for proper treatment and recycling, in compliance with local waste management regulations.

Warranty

Products that you buy directly from our **LePresso** website or shop come with a 24-month warranty.

The 24-month warranty applies to products purchased directly from our **LePresso** website or store. If **LePresso** products are bought from any of our verified retailers, then the product is eligible for only a 12-month warranty. To extend your product's warranty, visit our website <https://www.lepresso.com/warranty> and fill in your details in the provided form along with an uploaded picture of the product to process your request. Once approved, you will receive a confirmation email of the extended product warranty. Upload the required information within 48 hours of purchase to be eligible for a 24-month warranty period.

For more info, please check:

<https://www.lepresso.com/warranty>

Contact Us

If you have any questions or concerns about our Shipping and Returns Policy, please contact us at: info@lepresso.com

Website: <https://www.lepresso.com/>

Instagram: [lepresso_official](#)