

LèPRESSO



LePresso

**Portable Espresso with Heating
Function and Digital Display**

SKU: LPCFFM0031

Table of Contents

Safety Precautions	2
Charging and Indicator Light	3
Troubleshooting	4
Schematic View	5
Instructions for Use	7
Tips	10
Product Features	10
Cleaning and Maintenance	11
Disposal	11
Warranty	12
Contact Us	12

Safety Precautions

Please read the following instructions carefully before using the coffee machine to prevent personal injury or damage to the machine.

- 1.** This product is for personal use only.
- 2.** Upon unpacking, ensure the product is intact and that all accessories are included.
- 3.** Before first use, run cold water through the device to clean the internal components. There is no need to load the portafilter; simply pour cold water into the water tank and press the power button to begin. Failure to do so may result in no coffee dispensed.
- 4.** Keep packaging materials and accessories out of the reach of children.
- 5.** Keep the product away from children, infants, and pets, especially during charging and while in operation.
- 6.** Do not leave the product unsupervised while charging to prevent risks associated with improper charging.
- 7.** Store the product in a cool environment, away from direct sunlight.
- 8.** This product is not dishwasher or microwave safe. Do not place it on a gas or electric burner or in an oven.
- 9.** Only use purified clean water with the machine.
- 10.** Ensure the water tank is filled before activating the heating function. Heating the machine without water will cause damage. Also, do not exceed the maximum fill line in the water tank.
- 11.** To prevent overheating, allow the machine to cool for 10-5 minutes between cycles if it has been continuously used.
- 12.** This appliance is not suitable for use by individuals including children with reduced physical, sensory, or mental capabilities, unless supervised or instructed by a responsible person.
- 13.** Do not place the appliance in the cabinet while in operation.
- 14.** Place the appliance on a stable, flat surface.

- 15.** This appliance is intended for household and similar uses, including:
- Staff kitchen areas in shops, offices, and other work environments
 - Farms
 - Hotels, motels, and other residential accommodations
 - Bed and breakfast environments
- 16.** While heating, do not open the water chamber lid as the water may be boiling, which could lead to injuries.
- 17.** During extraction, ensure that the portafilter is tightly secured to allow the pressure to puncture the coffee capsule properly. Tightening the portafilter also prevents water leakage.
- 18.** CAUTION! The extracted coffee will be very hot. Exercise caution while consuming.
- 19.** Be careful when opening the portafilter and capsule adapter, as temperatures may remain high after extraction.
- 20.** Do NOT wash this product under water. Instead, use a towel to wipe the surface of the machine. The coffee cup, capsule adapter, ground coffee filter basket, and cover can be hand washed separately.
- 21.** Do NOT use any parts not recommended by Espresso. The use of unauthorized or unidentified parts may damage the product. Stop using this product if it malfunctions.

Charging and Indicator Light

- 1.** The machine will not operate while charging. Ensure it is fully charged before use.
 - 2.** Use only the included charging cable to charge the device.
 - 3.** The charging cable may be damaged during shipment or delivery. If the device is unable to charge, try using another Type-C cable.
- Note:** Poor-quality adapters and charging cables can significantly extend charging times, prevent full charging, or even damage the machine.

- 4.** Use a Type-C adapter for charging.
- 5.** The LED light bar indicates both the battery power and real-time water temperature with a heating indicator.
- 6.** When plugged in, the LEDs will flash to indicate the battery level. When fully charged.
- 7.** During charging, if the battery is above 2 bars, the machine can heat and extract. If only 1 bar remains, it may not be able to heat.
- 8.** To check the battery status, press the button once. If the power lights flash 5 times during use, it indicates that the battery is too low, and the machine can only extract. Please wait until the machine is fully charged before operating.

Troubleshooting

Problem	Indicator Status	Solution
Battery power is low.	The indicator flashes 5 times.	Please operate the device after its fully charged.
Battery overheating protection has activated.	The middle 2 lights flashes 5 time.	Please use the machine after 5 minutes.
The anti dryness protection feature has activated.	Indicators and machine turn off automatically.	Please pour water into the water tank before using the machine.

Schematic View

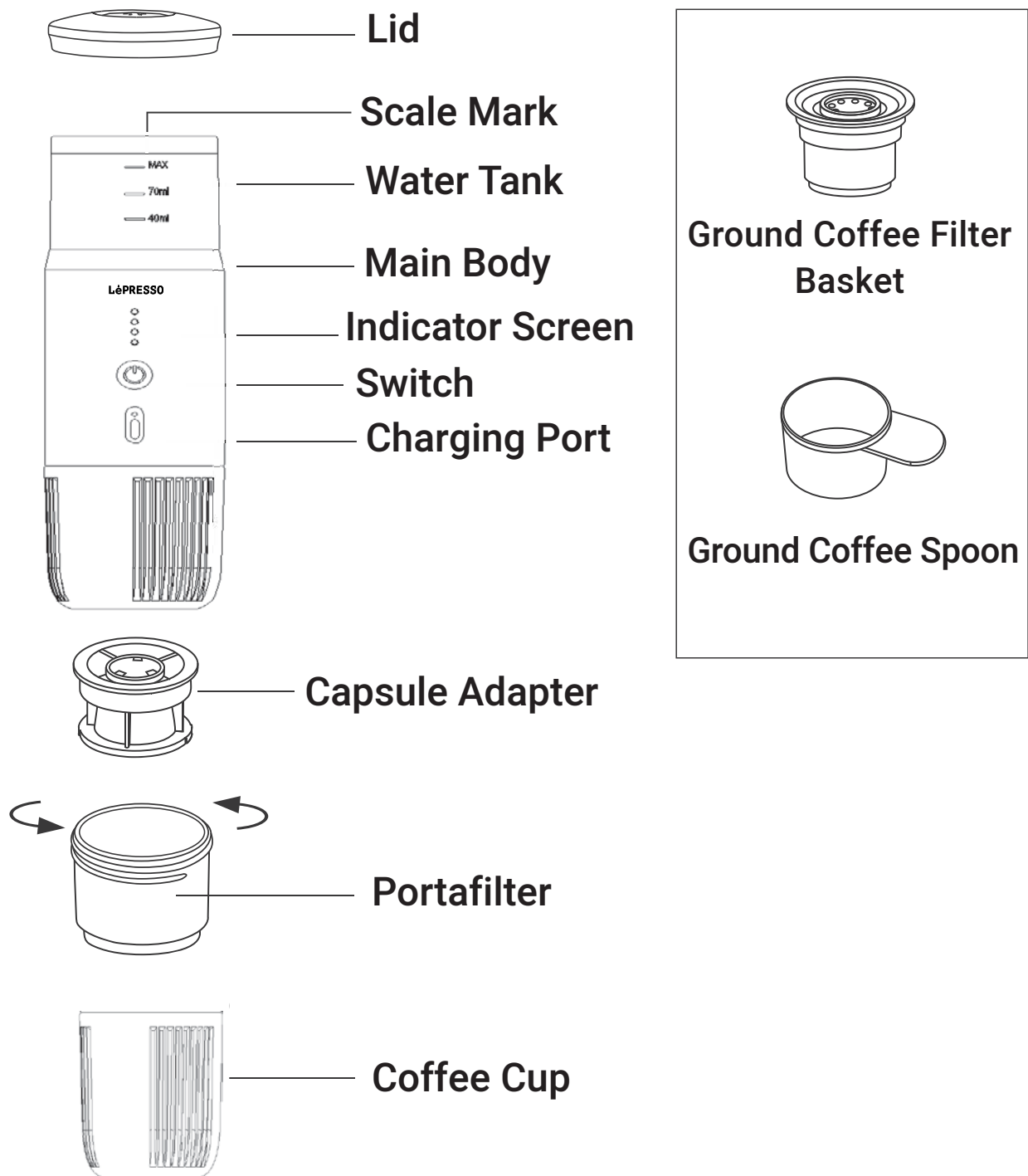

Capsule Adapter

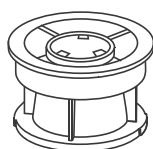

Nespresso Compatible Capsules:
Illy, Lavazza, Kimbo, etc

Ground Coffee Filter Basket

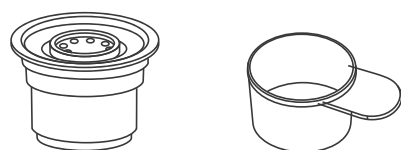

Ground coffee loading
Capacity: 8-5 g

Specifications

Water Tank Capacity	80ml
Battery Capacity	2500mAh x3
Input	5V/3A
Charging Port	Type-C
Power Output	135W
Battery Life	More than 200 Single-Espresso (Pre-Heated Water), Up to 5 Single-Espresso (Cold or Room Temperature Water)
Extraction Pressure	15-9Bar
Product Material	Food Grade Stainless Steel
Product Net Weight	670g
Compatibility	Nespresso and Ground Coffee

Tips: The charging cable may be damaged during shipment or delivery. If the device is unable to charge, try using a different Type-C cable. It is important to note that poor-quality adapters and charging cables can significantly prolong charging times, prevent the machine from fully charging, or even cause damage to the device.

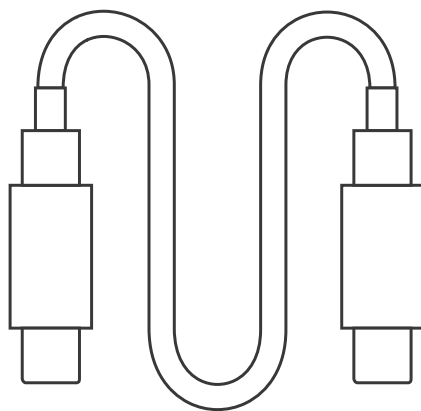

Type-C Cable



Please wait more than 5 minutes for continue heating.

Instructions for Use

This product is a portable electric espresso machine designed for coffee enthusiasts. It supports both ground coffee and capsules for extraction. Please follow the instructions below when using the machine.

[A] Capsule Extraction

- 1.** Check if the battery is fully charged.

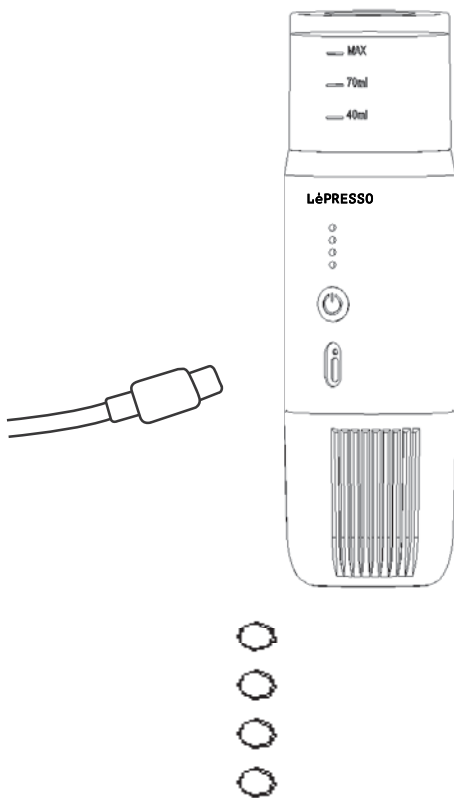

During charging, the LED lights will flash. When the machine is fully charged, all the LED lights will remain on for 1 minute, then turn off.

- 2.**

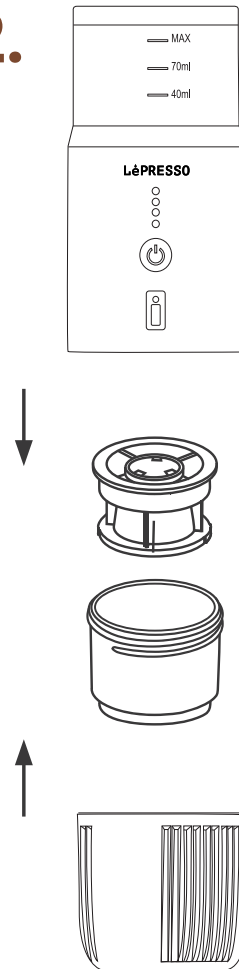

Disassemble the lower parts.

- 3.**

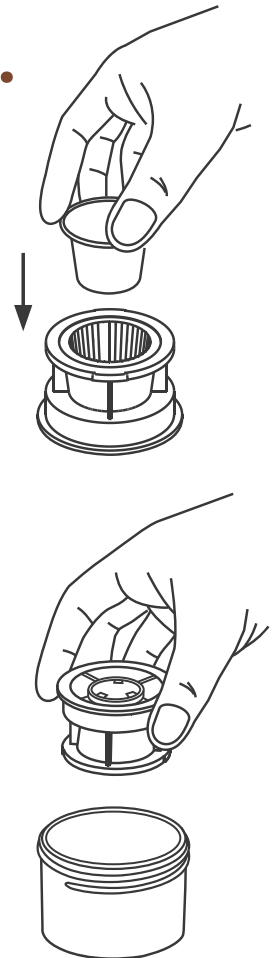

Press firmly to insert the capsule into the capsule adapter, then load it into the portafilter.

4.

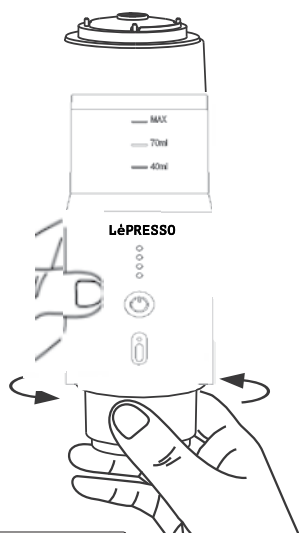

Tighten the portafilter onto the body, then place the coffee cup underneath.
Note: Ensure the portafilter is screwed on tightly, or the brew will fail.

5.

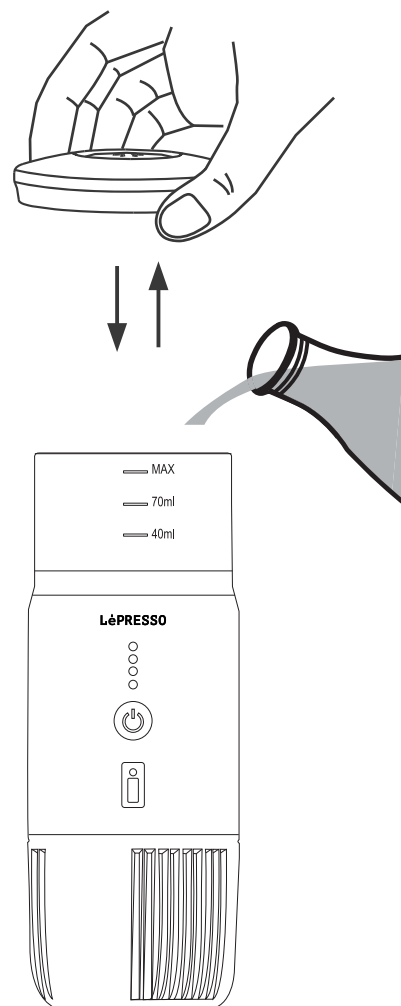

Remove the upper lid, pour water into the water tank, and then replace the lid.

6.

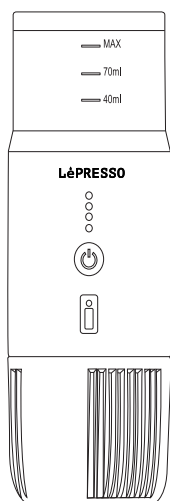

Press the button to start operating:

[1] Cold water: Hold the button for 5 seconds to start heating. The indicators will flash while heating. After 4-3 minutes, the heating will be complete, and the machine will automatically start extracting coffee.

[2] Hot water: Press the button twice to start extraction.

Note:

- a. Using preheated hot water will save time and battery power.
- b. The finer the coffee grounds, the more crema will be extracted.

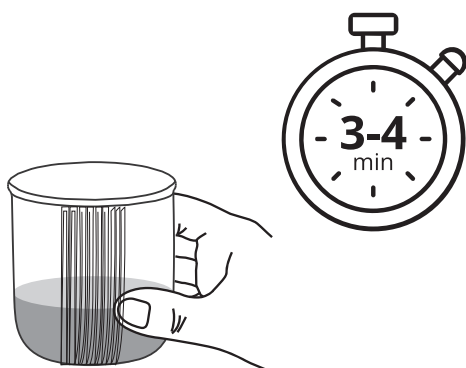

Reminder: The surface of capsules, such as Nespresso, may fail to perforate due to:

1. Insufficient pressure when inserting the capsule.
2. The portafilter not being screwed on tightly.
3. The capsule adapter not being properly installed.

Fully Charged:

Cold Water: With 50ml of cold water, you can make up to 5 cups of hot espresso.

Boiled Water: With preheated hot boiled water, you can make over 200 cups with a fully charged machine.

[B] Ground Coffee

1.

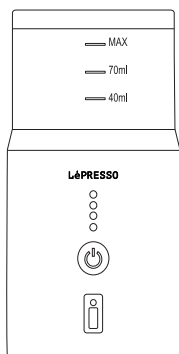

2.

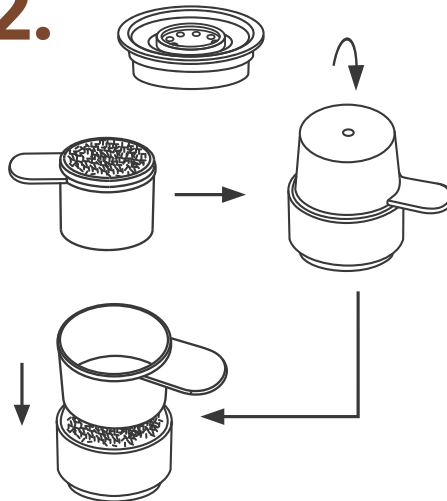

Tamped ground coffee.

3.

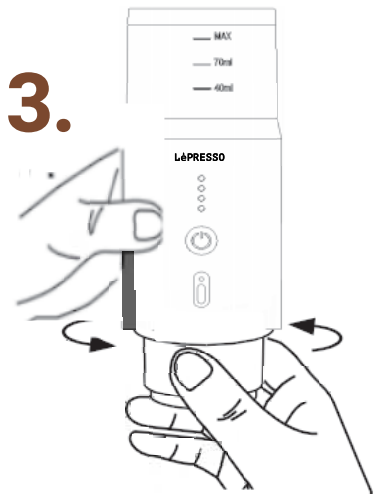

4.

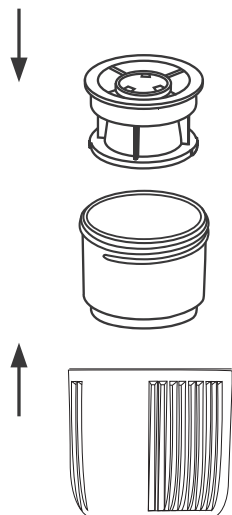
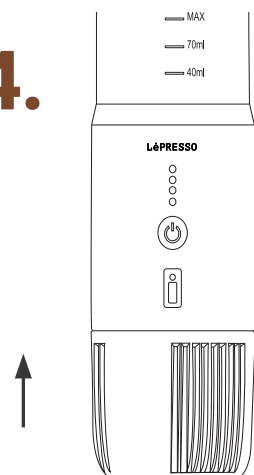

Disassemble the lower parts.

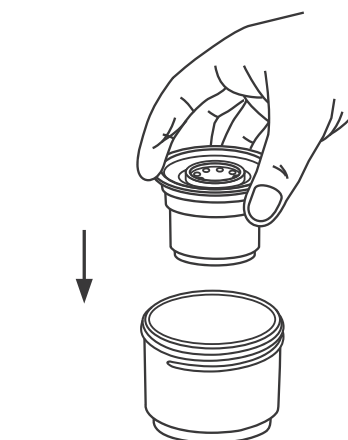

Place ground coffee into the filter basket and load it into the portafilter.

Tighten the portafilter onto the body, then place the coffee cup beneath it. Note: Ensure the portafilter is screwed on tightly to avoid brewing failure.

Tips

- 1.** If the grounds filter basket or capsule adapter are not properly installed, the machine will lose its airtightness, resulting in water remaining in the portafilter during extraction. Additionally, too fine ground coffee may clog the filter basket and leave water in the portafilter.
- 2.** The following issues may prolong extraction time or prevent the machine from automatically stopping extraction. In such cases, please press the power button once to turn the machine off manually:
 - Ground coffee is too fine.
 - Too much ground coffee in the filter basket.
 - Use of hard-surfaced capsules.
- 3.** If the machine has not been used for an extended period, the battery may be too low, and the charging light may not flash immediately when connected. Please be patient and charge for a while.
- 4.** The heating element or NTC may have been damaged during shipment, preventing the machine from heating water or causing temperature detection failure. If either issue occurs, please contact us for a replacement machine.

Product Features

- 1.** This is one of the smallest and lightest espresso machines on the market, offering full functionality in a portable design.
- 2.** Optimized battery management maximizes energy efficiency while minimizing space. The machine features a double-layer heat insulation design and is constructed from durable stainless steel.
- 3.** The machine adheres to the standards set by the European Coffee Brewing Center (ECBC). It precisely controls temperature, pressure, and speed to produce coffee with rich crema and a fantastic aroma.
- 4.** The built-in lithium battery allows for a simple and convenient coffee-

making experience. Start brewing with just a slight press of a button.

5. Compatible with both ground coffee and coffee capsules (Nespresso, L'OR, Jacobs, Illy, Lavazza, Kimbo, etc.), offering versatile brewing options.

6. Whether indoors, in the car, or outdoors, this coffee maker satisfies your coffee cravings whenever you need it.

7. The USB Type-C connector enables convenient charging, making this machine the perfect travel companion.

Cleaning and Maintenance

1. Before your first use, wipe the product to remove any dirt or dust accumulated during shipping.

2. Prior to use, run cold water through the device to clean its inner parts. There is no need to load the portafilter. Pour cold water into the water tank and double-click the power button to start. Failing to do so may result in coffee not dispensing correctly.

3. DO NOT submerge the main body in water or wash it under direct flowing water. Other detachable parts can be washed with water. Refer to page 1 for details.

4. Clean the machine after each use. Ensure it is fully clean and dry before storing.

5. Store the product in a cool, dry environment to maintain its longevity.

Disposal

This product must not be disposed of as unsorted household waste. It is important to separate such waste for proper treatment and recycling, in compliance with local waste management regulations.

Warranty

Products that you buy directly from our **LePresso** website or shop come with a 24-month warranty.

The 24-month warranty applies to products purchased directly from our **LePresso** website or store. If **LePresso** products are bought from any of our verified retailers, then the product is eligible for only a 12-month warranty. To extend your product's warranty, visit our website [**https://www.lepresso.com/warranty**](https://www.lepresso.com/warranty) and fill in your details in the provided form along with an uploaded picture of the product to process your request. Once approved, you will receive a confirmation email of the extended product warranty. Upload the required information within 48 hours of purchase to be eligible for a 24-month warranty period.

For more info, please check:

[**https://www.lepresso.com/warranty**](https://www.lepresso.com/warranty)

Contact Us

If you have any questions or concerns about our Shipping and Returns Policy, please contact us at: [**info@lepresso.com**](mailto:info@lepresso.com)

Website: [**https://www.lepresso.com/**](https://www.lepresso.com/)

Instagram: [**lepresso_official**](#)