



Green Lion

Smart Air Fryer with TFT Touch Screen and 6.5L Capacity

SKU: GN1800WIRFYBK

Model No: G-FR64

Table of Contents

Safety Precautions	2
Precaution	3
Schematic View	4
Interface Guide	5
Icon Guide	6
Instructions for Use	6
Turn On/Off WIFI	7
Menu Mode Guide	7
Reference Cooking Table	8
Specifications	9
WIFI Technical Data	9
Automatic Shutdown Feature	9
Troubleshooting	10
App Connection	11
Disposal	11
Warranty	12
Contact Us	12

Safety Precautions

A. Power Supply Requirement

Before use, ensure that the power socket specification is 220 to 240V, 50-60Hz. Do not use the same power socket for other electrical products simultaneously. Overloading the socket can lead to excessive current, posing a risk of danger.

B. Before First Use

1. Carefully read this instruction manual.
2. Do not use the air fryer basket if it is improperly inserted, damaged, or cracked.
3. To prevent the risk of suffocation in children, handle the plastic packaging of the machine properly.
4. Wipe the inside of the air fryer with a soft, wet sponge and dry it thoroughly before use.
5. For the first use, it is essential to operate the air fryer at 200°C for 30 minutes to eliminate any odors. The presence of slight white smoke or odor during this process is normal and results from the heating of internal components and the burning off of protective oils inside appliance.

C. Warning

1. Ensure that the plug is connected to a socket with a ground cable and avoid using an extension socket.
2. Confirm that the main power voltage matches the voltage labeled on the product.
3. Maintain adequate space around the product; do not place any objects on top of the air fryer and keep objects at least 30 cm away from the product.
4. Do not use a damaged basket. If the basket is damaged, please contact customer support.
5. If the power supply cord is damaged, it must be replaced by a qualified

person from customer support to avoid a hazard.

6. The appliance will heat up during use. Avoid touching the heating unit within the product.

7.  This symbol indicates that the surface of this component becomes hot during and after use. Do not touch it.

8. Do not operate the appliance with wet hands or while barefoot.

Precaution

1. If the appliance does not function properly, unplug it immediately and contact customer support.

2. Always unplug the appliance when not in use. Do not unplug by pulling on the power cord.

3. This appliance is not intended for use by persons (including children) with reduced physical, sensory, or mental capabilities, or those lacking experience and knowledge, unless they are under the supervision of a person responsible for their safety. Children should not touch or play with the appliance.

4. Children aged 8 years and older and persons with reduced physical, sensory, or mental capabilities or lacking experience and knowledge may use this appliance if they have been supervised or instructed on how to use it safely and understand the associated hazards.

5. Children should not perform cleaning and maintenance tasks without supervision.

6. Do not use a knife or other metal utensils to remove food residue from the heating pipe, as this could damage the pipe or cause electric shock.

7. Use insulated gloves or clamps to flip food during baking or to dislodge food after baking, as the air fryer pan and food are at high temperatures to avoid burns.

8. Do not block the air inlet and outlet to prevent the risk of fire.



9. After each cooking process, the appliance's surface, basket, and interior wall are hot. Allow the appliance to cool completely before cleaning to avoid burns.

- 10. Always monitor the food during operation and do not leave the applianceunattended.
- 11. The product may emit a slight rhythmic sound during operation, which is normal and results from the temperature control device.
- 12. Do not move the air fryer while it is in use.
- 13. This appliance is intended for household use only.
- 14. This appliance should not be operated by an external timer or separate remote-control system.
- 15. Keep away from children, infants, and pets. Children should not play with the appliance. Only children over the age of 8 and under supervision may perform cleaning and maintenance tasks. Ensure that the appliance and its cord are kept out of reach of children under 8 years old.

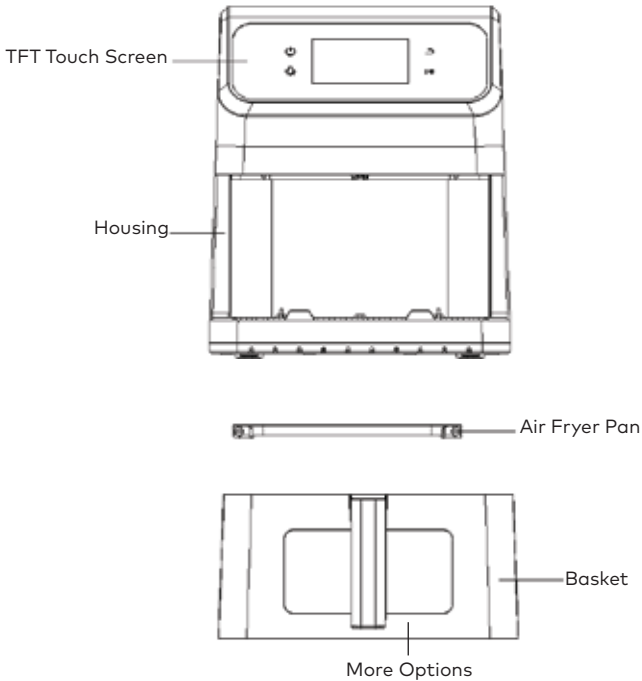
Schematic View



Interface Guide

Operation Panel	 <p>Recipe Home Page Auto Program Settings</p> <p>On/Off</p> <p>Light</p> <p>Back</p> <p>Start/Pause</p>
Recipe Interface	 <p>Recipe Catalogue</p> <p>Sort by A-Z</p> <p>Initial of the Recipe</p> <p>More Options</p>
Automatic Program Interface	 <p>Home</p> <p>Current Program</p> <p>Lock</p>
Operating Interface	 <p>Back</p> <p>Temperature Icon</p> <p>Time Icon</p> <p>Operating Program</p> <p>Increase Time/Temperature</p> <p>Start/Pause</p> <p>Decrease Time/Temperature</p>

				
Time Over	Flipping Reminder	Ingredients	Recipe Steps	Accessory

Instructions for Use

1. Before use, clean all accessories with warm water, wipe the interior with a soft cloth, and ensure everything is dried thoroughly.
2. Check the air inlet and outlet to make sure they are unblocked and unobstructed before turning on the appliance.
3. Place the desired food onto the air fryer pan, then carefully insert it into the empty basket.

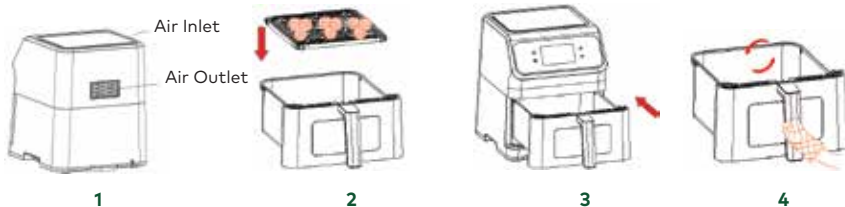

4. Push the basket containing food into the air fryer.
5. Halfway through the cooking time, it is recommended to pull out the basket and flip the food to ensure even cooking.
6. The basket will be very hot at the end of cooking. Do not attempt to remove the food immediately; allow it to cool for 5 minutes.
7. After use, promptly clean the empty basket and air fryer pan to prevent odors during the next use.
8. Do not place any objects on top of the appliance, as this can obstruct heat dissipation and pose a risk. Also, avoid pouring oil or any liquid into the basket during operation.

9. Never immerse the appliance in water or any other liquids.



5



6



7



8

Warning: Do not touch the surface of the appliance during operation to avoid the risk of burns!

Turn On/Off WIFI

To toggle the WIFI on or off, start by clicking the home page icon. Locate the settings icon in the upper right corner and click it. Then, navigate to and enter the WIFI interface where you will find the option to set WIFI to on or off.

Menu Mode Guide

The table below provides recommended cooking times, temperatures, and portions for various types of food that can be air fried. If the portions exceed or fall below the recommendations, please adjust the cooking time appropriately to ensure optimal results.

Program	Temperature	Time	Flip Reminder
Air fryer DIY	180°C	15min	Yes
Bake	150°C	35min	Yes
Roast	200°C	10min	Yes
Broil	200°C	10min	Yes
Broil	200°C	10min	Yes
Keep warm	60°C	5min	--
Reheat	200°C	5min	--
Frozen	200°C	12min	Yes
Veggies	160°C	8min	Yes
Fries	190°C	25min	Yes
Seafood	180°C	8min	--
Steak	200°C	6min	Yes
Chicken	190°C	23min	Yes

Notes:

1. Certain menu programs feature a reminder to flip the food halfway through the cooking process. It is recommended to flip the food to ensure optimal baking results.
2. Ingredients that are not included in the default menu can be customized using the DIY program.
3. The "Frozen" setting is designed specifically for cooking frozen ingredients.

Reference Cooking Table

Mode	Ingredients	Temperature	Time	Weight	Flip Reminder
Bake	Cakes	150°C	35 to 40min	-	-
	Biscuits	170°C	12 to 15min	-	-
	Bread	140°C	14 to 16min	-	-
Roast	Pork chop (with bone)	200°C	16 to 18min	8 oz	Yes
	Hamburger	200°C	10 to 15min	6 oz	-
	Mutton chop	200°C	20 to 30min	1 lb	Yes
Broil	Sausage	200°C	8 to 12min	10 oz	Yes
	Fish	180°C	8 to 12min	5 oz	Yes
	Egg start	190°C	8 to 12min	12 oz	-
Frozen	Frozen shrimp	190°C	6 to 10min	1 lb	Yes
	French fries	190°C	15 to 20min	1 lb	Yes
	Chicken nuggets	190°C	8 to 12min	8 oz	Yes
	Pizza rolls	190°C	15 to 18min	8 oz	Yes
Veggie	Eggplant	200°C	8 to 15min	8 oz/1 lb	-
	Mushrooms	200°C	8 to 15min	12 oz	Yes
	Corns	200°C	10 to 15min	1 lb	-
	Red bell Peppers	200°C	25 to 30min	2 pieces	Yes
Fries	French fries (fresh potato with thin slices)	195°C	20 to 25min	12 oz	Yes
	French fries (fresh potato with thick slices)	195°C	25 to 30min	12 oz	Yes
	French fries	195°C	14 to 20min	12 oz	Yes
	Whole Sweet potato	195°C	40 to 45min	1 lb	Yes
Seafood	Scallops	200°C	5 to 8min	1 lb	-
	Shrimp	190°C	6 to 8min	1 lb	Yes

Steak	Steak	200°C	7 to 9min	1 lb	Medium Rare
			8 to 10min		Medium
			9 to 12min		Well Done
Chicken	Chicken wings	195°C	15 to 20min	1 lb	Yes
	Chicken legs	195°C	25 to 30min	1 lb	Yes

Specifications

Model No.	G-FR64
Material	PP, SS
Rated Power	1800W
Rated Voltage	220-240V
Rated Frequency	50-60Hz
Capacity	6.5L
Temperature	60-200°C
Frying Time	0-60 min
Noise Level	65 dB
Power Cord	UK Plug 1m
Product Weight	5.1 kg
Product Dimensions	300*340*390 mm

WIFI Technical Data

Frequency	2412 to 2472MHz
Max Transmitted Power (with Antenna Gain)	≤20dBm
Modulation Mode	OFDM, CCK
Antenna Gain	1.5dBi

Automatic Shutdown Feature

When the product program finishes or if no operation is performed, the device will automatically enter a shutdown state after 10 minutes. In this state, the power consumption is less than 0.5 watts.

Troubleshooting

Please refer to the table below for common issues. Follow the instructions provided to address these issues. If the problem persists or the cause is unclear, contact a service center for assistance. For your safety, do not attempt to disassemble or repair the device yourself.

Problem	Solution
Dark smoke is emitting from the air fryer.	Immediately unplug the air fryer if dark smoke appears, as this indicates that food is burning or there is a circuit problem. Remove the basket to check. If the cause is not burnt food, contact a service center.
The air fryer emits a plastic smell when operating at high temperatures.	The air fryer may emit a plastic smell from the manufacturing process. To resolve this issue refer to (Safety Precautions) section>(B. Before First Use)>item number 5, to eliminate the plastic smell. If the smell persists, contact a service center.
The screen is bright, but the program cannot start.	a. The signal switch was not activated. b. Ensure the basket is securely placed in the unit.
The food remains under-cooked.	a. If the food is too thick, divide it into smaller batches. b. Increase the cooking time.
After plugging into the power supply, the screen is not bright.	a. Check for a power failure to ensure the air fryer is plugged into a functional outlet. b. If there is an internal component failure, contact a service center.
The E 1 error is displayed.	Attention: The air fryer's top NTC does not function normally.
The E 2 error is displayed.	The PCB does not function normally.
The E 3 error is displayed.	Warning: The air fryer's overheat protection has activated. Please use it after it cools down.
The E 5 error is displayed.	Warning: Ensure the air fryer bowl is properly placed.

App Connection

1. Download the Tuya app, available for both Android and iOS devices, from Google Play or the App Store, or use the provided QR code.
 2. The app allows you to control the device remotely via your home network. Ensure you have a stable WiFi connection to your router and the Tuya app installed.
- Note:** To ensure safety, it is advisable to disconnect the device from the power supply when not at home to prevent any unintended activation.

Control with 'Tuya Smart' app:



App Store



Google Play

Disposal

This product must not be disposed of as unsorted household waste. It is important to separate such waste for proper treatment and recycling, in compliance with local waste management regulations.

Warranty

Products that you buy directly from our **Green Lion** website or shop come with a 24-month warranty.

When you buy **Green Lion** products from any of our approved sellers, you only get a 12-month warranty. If you want to extend this warranty, go to our website at [**https://www.greenlion.net/warranty**](https://www.greenlion.net/warranty) and fill out the form with your information. Don't forget to upload a picture of the product too. After we've checked and accepted your request, we'll send you an email to confirm that your product's warranty has been extended.

For more info, please check:
[**https://www.greenlion.net/warranty**](https://www.greenlion.net/warranty)

Contact Us

If you have any questions about this Privacy Policy, please contact us at:

Website: [**https://www.greenlion.net/**](https://www.greenlion.net/)

Sales: [**sales@greenlion.net**](mailto:sales@greenlion.net)

Service Support: [**Support@greenlion.net**](mailto:Support@greenlion.net)

Telegram: [**@greenlion_global**](https://t.me/greenlion_global)

Instagram: [**@greenlion_global**](https://www.instagram.com/greenlion_global)