



Powerology

16000mAh Jumpstart Power Bank

SKU: PPBCHA29

Table of Contents

| | |
|-----------------------------|----|
| Overview | 2 |
| Product Diagram | 2 |
| Display Instructions | 3 |
| Charging Instructions | 3 |
| Jump Start Instructions | 4 |
| Charging Phone or Tablet | 5 |
| 12V Power Supply Connection | 6 |
| LED Flash Light | 6 |
| Specifications | 6 |
| FAQ | 7 |
| Troubleshooting | 8 |
| Material Content Table | 8 |
| Warning | 8 |
| Disposal | 10 |
| Warranty | 11 |
| Contact Us | 11 |

Overview

Thank you for purchasing the Powerology Jumpstart Power Bank. This 16000mAh power bank provides a 1200A peak current, capable of jump-starting your car and charging various devices with its PD 18W output. Before using the product, please carefully read this User Manual to ensure correct usage and keep it secure for future reference.

Product Diagram

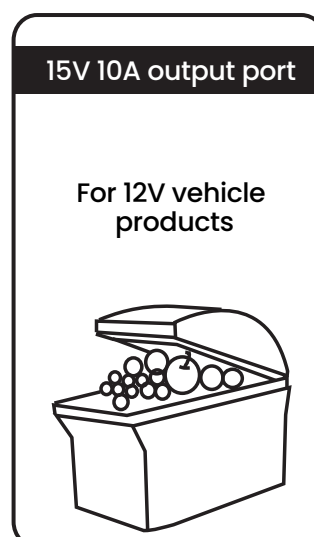
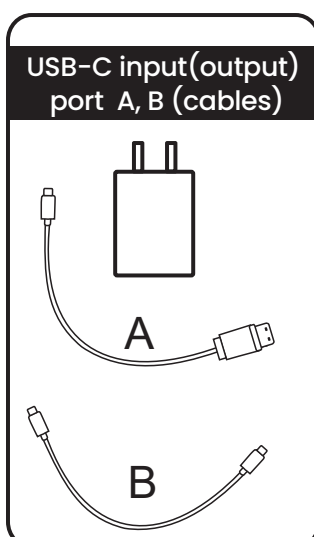
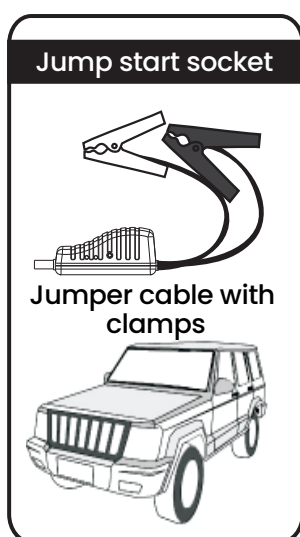
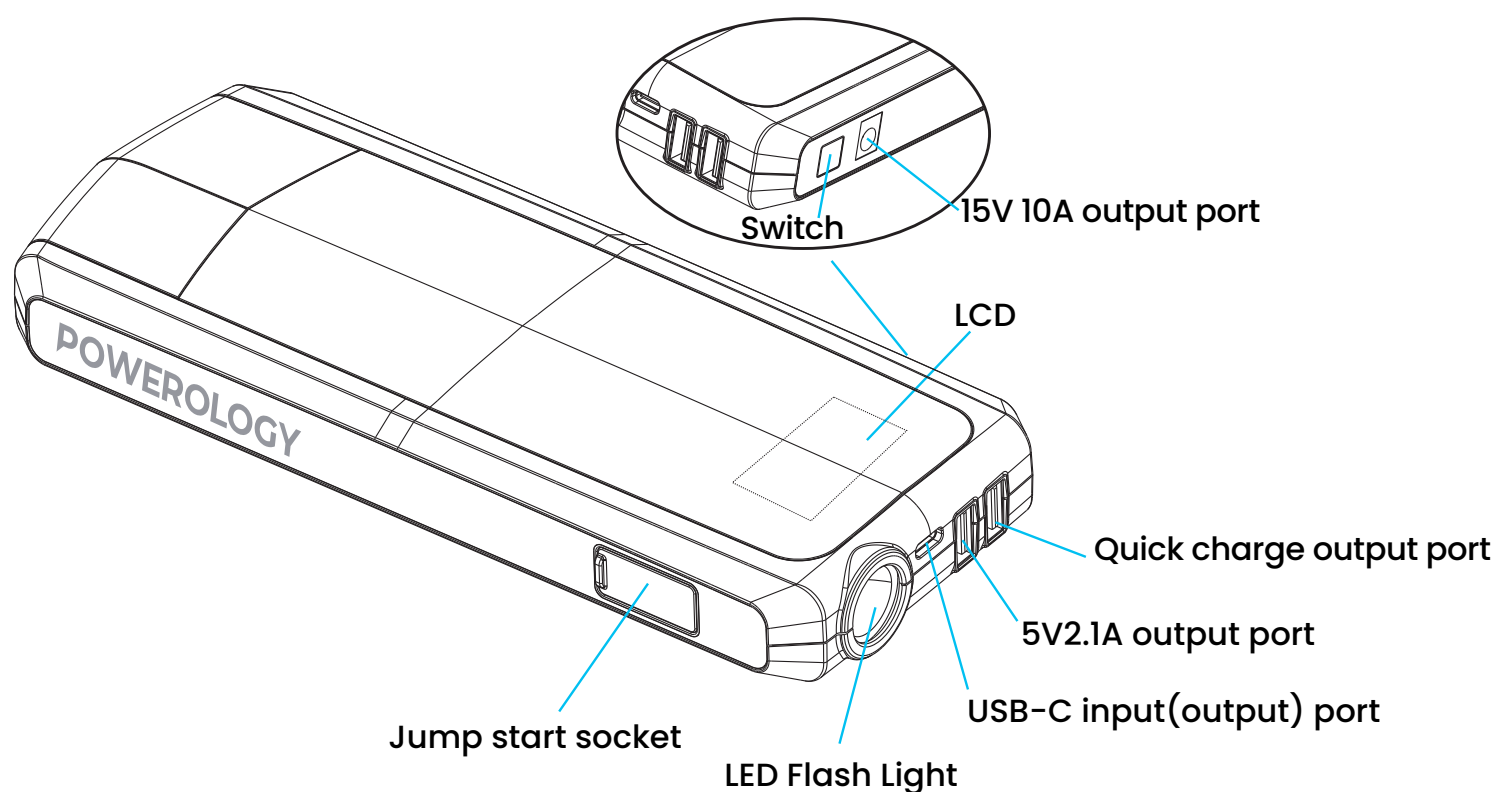

Display Instructions

1. To check the battery level, press the ON/OFF switch button. The display will show the current battery percentage (XX%), indicating the remaining power. When the display shows "100 %", it means the battery is fully charged.

Note: If the display shows "TYPE-C IN", the power bank is currently charging.



2. When the screen shows "TYPE-C/5V/15V/Quick Charge + OUT", it indicates that the power bank is providing output through these functions.

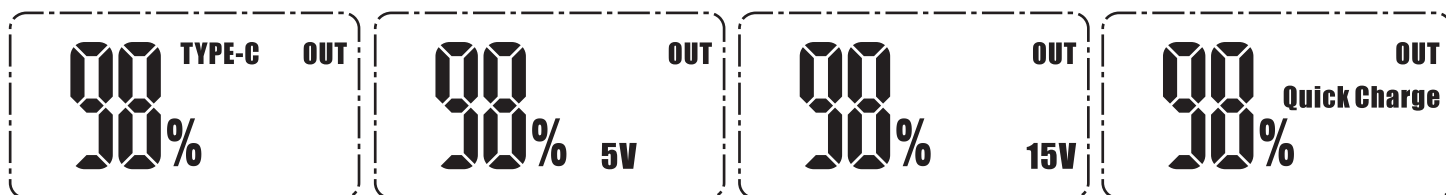

Charging Instructions

1. Plug the home adapter into a universal socket.

2. Connect the USB-C input port of the power bank to the other end of the home adapter.

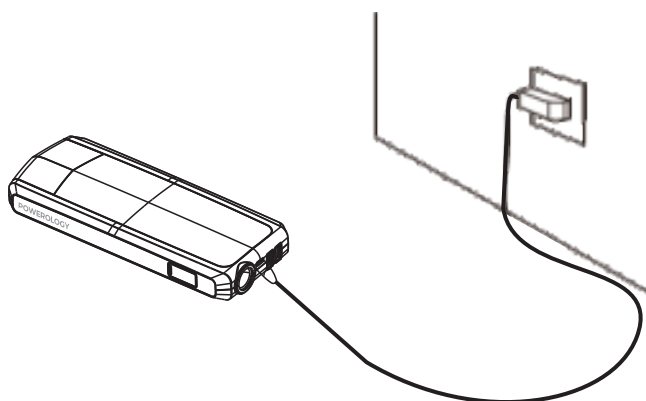

Jump Start Instructions

1. Connect the blue plug securely into the host and ensure that the Cable Indicator is turned off.
2. Attach the red clamp to the positive (+) battery terminal and the black clamp to the negative (-) battery terminal.
3. Follow the instructions provided by the Cable Indicator to operate the device.

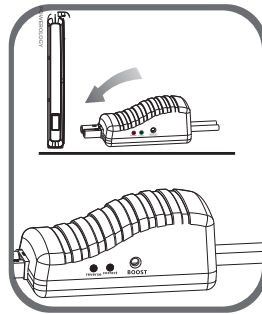

Green Light On

This indicates that the connection is correct and the circuit is functioning properly. You can now start the engine to jump-start the vehicle.

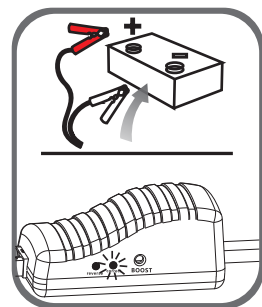

Green Light Blinking

This means the vehicle's battery is low. Press the "BOOST" button, wait for the green light to turn solid, then start the engine within 30 seconds.

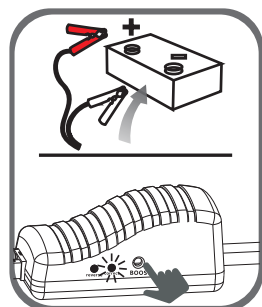

Red Light with Buzzing

This indicates an incorrect connection. The buzzer will sound to alert you. Correct the clamps as per step 2 above and wait for the green light to turn on before starting the engine.

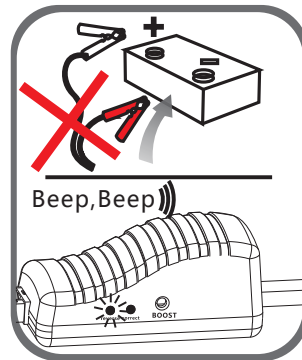

No Lights, No Buzzing

This suggests that the vehicle's battery may be damaged. After ensuring the clamps are connected properly, press the "BOOST" button, wait for the green light to appear, then start the engine within 30 seconds.

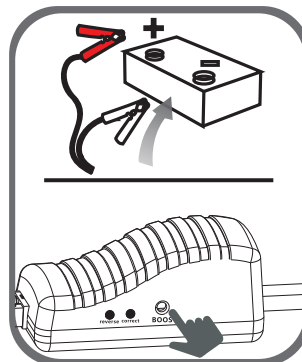

4. Start the vehicle.

5. Once the vehicle is started, disconnect the jumper cables from the vehicle battery and keep the engine running.

Charging Phone or Tablet

1. Connect the switch cable to the USB-C output port.

2. Select the appropriate connector and connect it to your mobile phone or tablet.

3. Press the switch button to begin charging. The device will automatically recognize the connected electronic product and adjust the charging parameters accordingly.

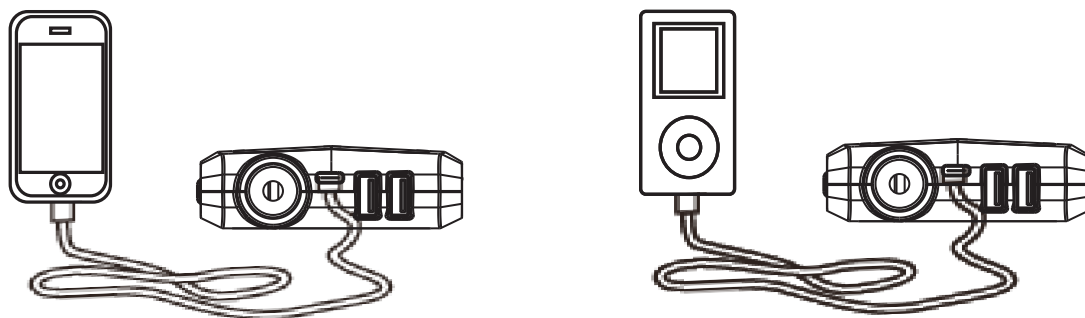

12V Power Supply Connection

- 1.** Connect the optional switch cable to the output port.
- 2.** Attach the other end of the switch cable to your 12V vehicle product or 12V electronics.
- 3.** Press the switch button to activate the power supply.

LED Flash Light

- 1.** Press and hold the switch for 3 seconds to activate the LED flashlight.
- 2.** There are four LED light modes: Normal, Strobe, SOS, and Off. The mode changes with each press of the switch.

Specifications

| | |
|-----------------------|----------------------|
| Battery Capacity | 16000mAh 59.2Wh |
| Start Current | 500A |
| Peak Current | 1200A |
| Operating Temperature | -20°C ~ 60°C |
| USB-A Output | 18W Quick Charge 3.0 |

| | |
|--------------|------------------------|
| USB-C Output | 18W Power Delivery |
| USB-C Input | 18W Power Delivery |
| Jumpstart | 6L Petrol, 3.5L Diesel |
| Dimension | 28 x 88 x 222mm |
| Weight | 595g |

FAQ

Q. How do I turn off the appliance?

A. The appliance will automatically power off once no load is detected, or after charging is complete.

Q. How long does it take to fully charge the product?

A. It takes approximately 3 hours to fully charge the product via the USB-C input port.

Q. How many times can this appliance charge my cell phone?

A. The number of charges depends on your phone's battery capacity. For example, it can fully charge an iPhone 6 up to 7 times.

Q. How many times can this appliance jump-start a 3.0L vehicle with a full battery?

A. It can jump-start a 3.0L vehicle approximately 35 times when fully charged.

Q. What is the expected lifespan of the product?

A. The product typically lasts between 3 to 5 years under normal usage conditions.

Q. How long can the battery last while still jump-starting the car after a full charge?

A. The battery can last 6 to 12 months, but we recommend recharging it every 3 months for optimal performance.

Troubleshooting

Problem: No response when pressing the switch button.

Possible Cause: Low voltage protection of product has been activated.

Solution: Plug the adapter into the USB-C input port to activate the device.

Material Content Table

| Toxic and Harmful Substances | | | | | |
|------------------------------|----|----|--------|-----|------|
| Pb | Hg | Cd | Cr(Vi) | PBB | PBDE |
| O | O | O | O | O | O |

Note:

'O' indicates that the hazardous substance content in all homogeneous materials is below the Maximum Concentration Value (MCV) limit specified in the Standard 95/2002/EC (RoHS).

12V Power Supply Connection

1. Please read the instruction manual carefully before using this unit.
2. Do not use the product in place of a vehicle battery.
3. This product is not a toy. Do not let children play with it.
4. To reduce the risk of injury, close supervision is necessary when the product is used near children.
5. This product is designed for 12V vehicles only. It is hazardous to use it for other types of vehicles.

- 6.** Do not use any attachments that are not recommended or sold by the power pack manufacturer. Improper use could result in fire, electric shock, or injury.
- 7.** Never connect the two clamps together.
- 8.** Before use, ensure that there is no corrosion or foreign matter at the interface. Connect the main unit to the battery terminal securely to avoid poor connections.
- 9.** After successfully starting the car, disconnect the product from the car battery within 30 seconds to prevent damage.
- 10.** Do not attempt to jump-start the vehicle more than three times consecutively. Allow a two-minute interval between each start attempt to avoid overheating.
- 11.** Do not use the jumper cable to charge other equipment.
- 12.** Do not store the product in locations where the temperature may exceed 60°C.
- 13.** Charge the product only at ambient temperatures between 0°C and 45°C.
- 14.** Do not expose the product to rain or water.
- 15.** Avoid exposing the product to extreme heat or fire.
- 16.** Do not operate the product in explosive atmospheres, such as in the presence of flammable liquids, gases, or dust.
- 17.** Ensure that someone is within earshot or can assist you when working with batteries.
- 18.** Remove personal metal items such as rings, bracelets, and necklaces when using the product.
- 19.** To avoid damage to the plug and cord, always pull the plug rather than the cord when disconnecting the power pack.
- 20.** Do not use a battery pack or appliance that is damaged or modified. Damaged or modified batteries may behave unpredictably, leading to fire, explosion, or injury.
- 21.** Only use the charger provided with this unit or one that meets the same standards as the host input port.

- 22.** After jump-starting the car, do not charge this unit immediately.
- 23.** Do not use the unit to jump-start a vehicle while the internal battery is charging.
- 24.** Under extreme conditions, the battery may leak. If liquid is noticed coming from the product, do not handle with bare hands. In case of skin contact, wash with soap and water immediately. If the liquid comes into contact with eyes, rinse with cold running water for at least 10 minutes and seek medical attention immediately.
- 25.** This product contains a lithium-based battery. Dispose of the product according to local regulations at the end of its life cycle.

Disposal

This product must not be disposed of as unsorted household waste. It is important to separate such waste for proper treatment and recycling, in compliance with local waste management regulations.



Warranty

Products that you buy directly from our **Powerology** website or shop come with a 24-month warranty.

The 24-month warranty applies to products purchased directly from our **Powerology** website or store. If **Powerology** products are bought from any of our verified retailers, then the product is eligible for only a 12-month warranty. To extend your product's warranty, visit our website **powerology.me/warranty** and fill in your details in the provided form along with an uploaded picture of the product to process your request. Once approved, you will receive a confirmation email of the extended product warranty. Upload the required information within 48 hours of purchase to be eligible for a 24-month warranty period.

For more info, please check:
powerology.me/warranty

Contact Us

If you have any questions about this Privacy Policy, please contact us at: **hey@powerology.me**

Website: **powerology.me**

Instagram: **powerology_official**

Facebook: **powerology.ME**