

PORODO
LIFESTYLE



Porodo Lifestyle
Nano Portable Electric Pump

SKU: PD-LFST040

Table of Contents

Schematic View	2
Nozzle Component Guide	2
Indicator Guide	3
Instructions for Use	4
Specifications	4
Warning	5
Troubleshooting	5
Warranty	6
Contact Us	6

Schematic View

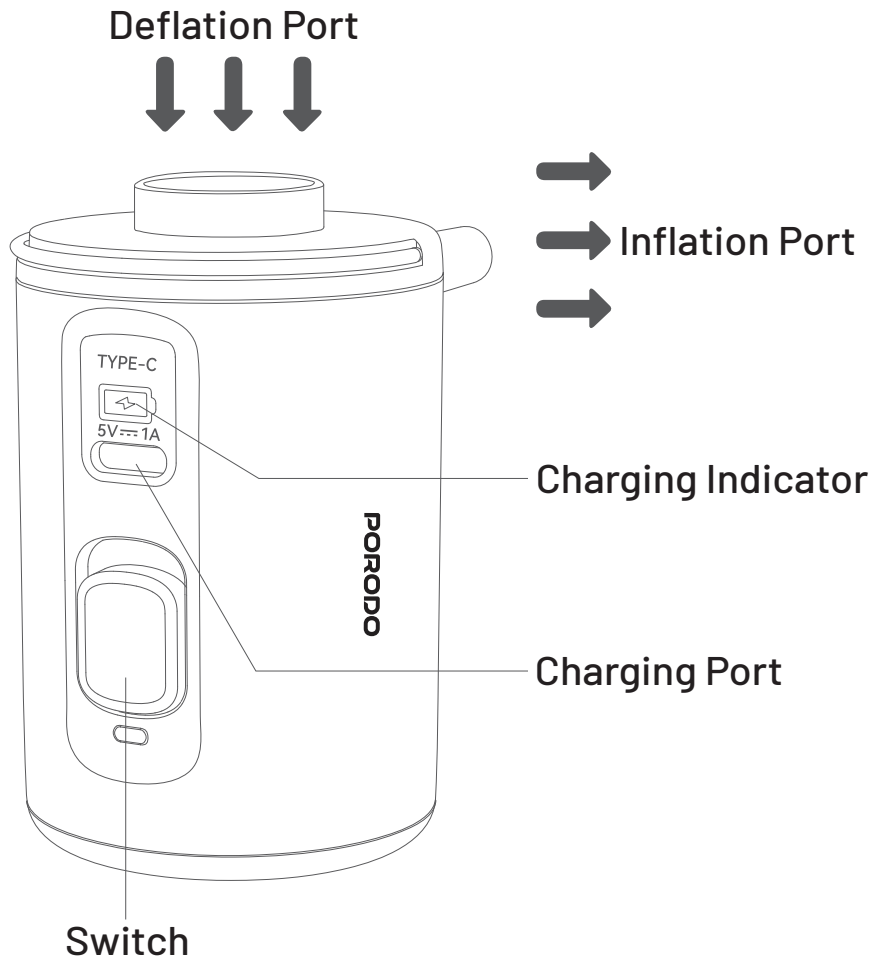

Nozzle Component Guide

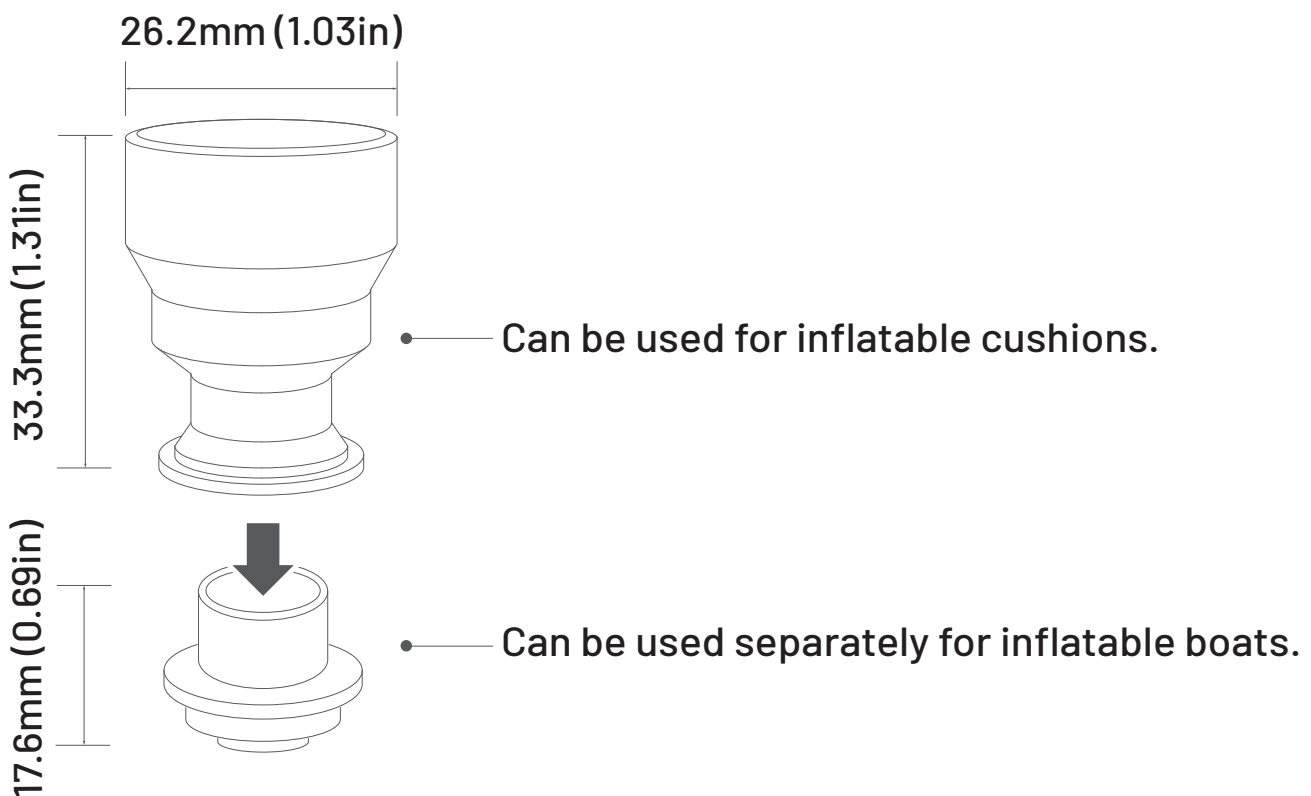

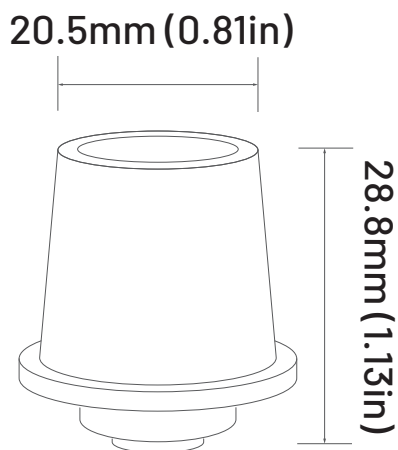

For inflatable beds and boats

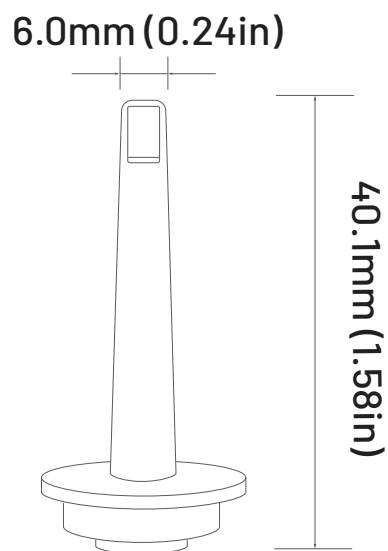

For swim rings and inflatable toys

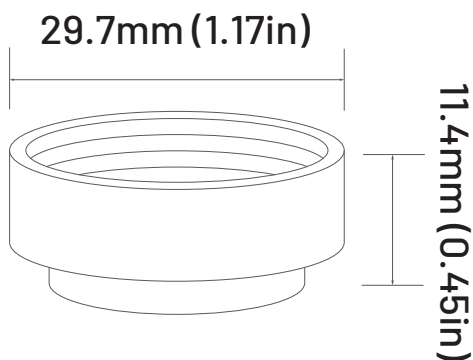

for vacuum storage bags

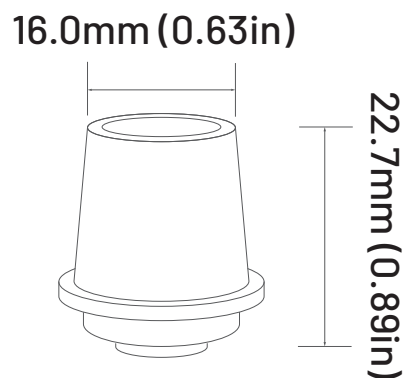

for inflatable beds and boats

Indicator Guide

Red Indicator Light: The device is operational and indicates a battery level from 0% to 99%.

Green Indicator Light: The device is fully charged.

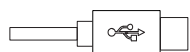
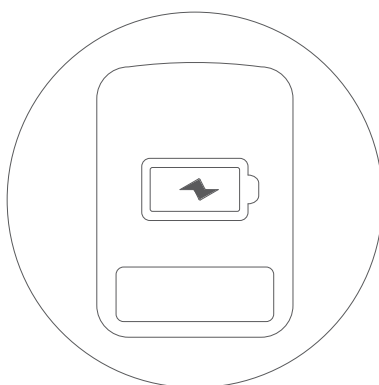

0% to 99%

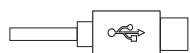

100%



Instructions for Use

[A] Inflation Mode

- 1. Select the nozzle that best fits the inflation port of your product.
- 2. Attach the selected nozzle securely to the inflation port of the item.
- 3. Slide the switch to the "on" position to begin inflating.

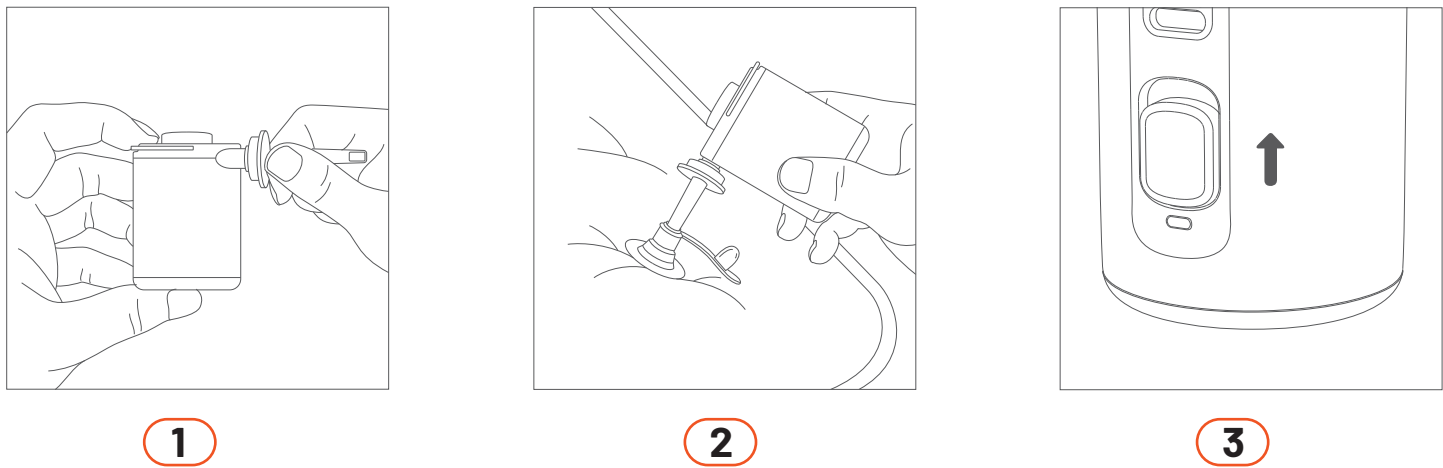

[B] Deflation Mode

- 1. Select the nozzle that fits the deflation port of your product.
- 2. Attach the selected nozzle to the deflation port securely.
- 3. Activate the device by sliding the switch upwards to start the deflation process.

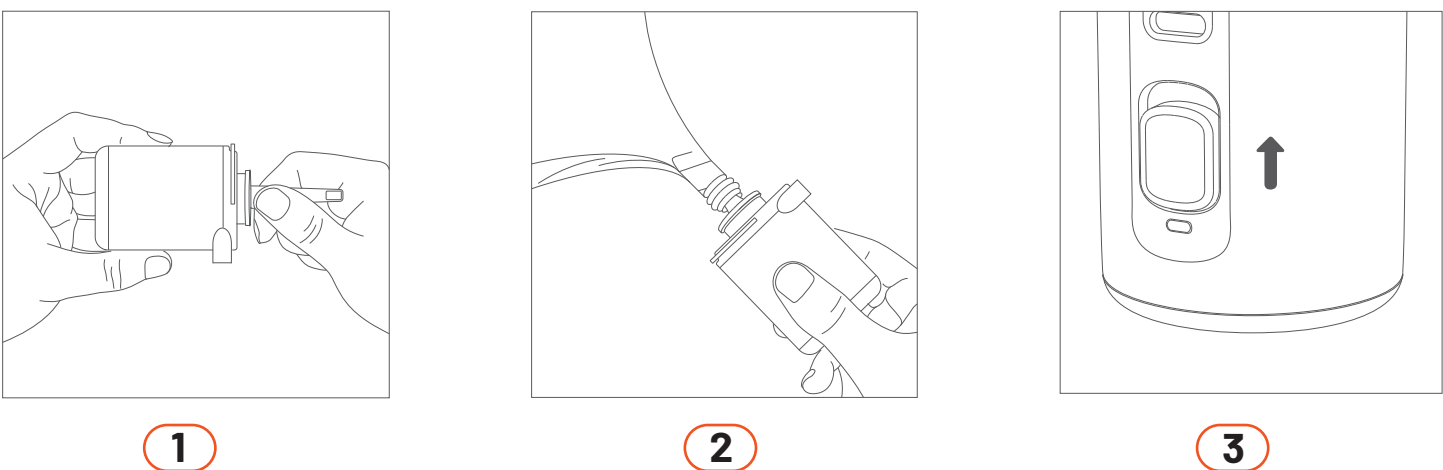

Specifications

Battery Capacity	800mAh
Power	6.3W
Input	5V/1A
Recharge Time	2 Hours
Working Time	25mins

Pressure	>3.5kPa(0.5PSI)
Flow Speed	180L/min
Function	Inflate & Deflate
Accessories	Air nozzles valve ×5, USB cable×1, Pouch×1
Product Weight	67g
Product size	47×45×72mm

Warning

1. Do not operate continuously for more than 10 minutes.
2. Avoid immersing the device in water.
3. Keep the air inlet and outlet clean at all times.
4. Do not insert fingers into the inflation or deflation ports.
5. Avoid looking directly into the inflation and deflation ports while the device is in use.
6. Children under the age of 12 should only use this product under adult supervision.
7. Inspect the product for any abnormalities before use. do not use if any issues are detected.

Troubleshooting

In case the device malfunctioned or the was non-operational, proceed as follows:

1. Connect the charger to verify if the battery is charged.
2. Check for water or other liquids on the pump surface.
3. Ensure the fan blades are not stuck or obstructed by foreign objects.
4. Press the switch repeatedly to test if the product starts.

Warranty

Products that you buy directly from our **Porodo** website or shop come with a 24-month warranty.

When you buy **Porodo** products from any of our approved sellers, you only get a 12-month warranty. If you want to extend this warranty, go to our website at **porodo.net/warranty** and fill out the form with your information. Don't forget to upload a picture of the product too. After we've checked and accepted your request, we'll send you an email to confirm that your product's warranty has been extended.

For more info, please check:
porodo.net/warranty

Contact Us

If you have any questions about this Privacy Policy, please contact us at:
info@porodo.net

Website: **porodo.net**

Service Support: **support@porodo.net**

Instagram: **porodo**