

**PORODO**  
LIFESTYLE



**Porodo Lifestyle**  
**Iron and Steamer**  
with Vertical and Horizontal Board

SKU: PD-LFST020

# Table of Contents

Safety Precautions	2
Warning	3
Features	3
Product Overview	4
Specifications	5
Indicator/Button Guide	5
Safety Pressure Relief Valve	7
Pre-heating and Standby	7
Assembly	8
Installing the Main Body	8
Operating Guide	9
Using the Clothing Clip	12
Maintenance and Cleaning Notes	13
Maintenance Precautions	14
Disposal	14
Troubleshooting	14
Warranty	16
Contact Us	16

## Safety Precautions

Thank you for choosing the Porodo Lifestyle Iron and Steamer. Before using the steamer, please carefully read the operating manual, which provides important safety guidelines.

- 1.** Please use the standard supply voltage (AC240-220V, 50-60Hz). Using the incorrect voltage may damage the steamer and void the warranty.
- 2.** Do not share a power supply with any other high-power electrical appliance.
- 3.** To avoid the risk of electric shock, do not leave the steamer, power plug, or power line in water or any other liquid.
- 4.** The steamer must be supervised throughout its use and should not be operated without supervision.
- 5.** Before use, fill the water tank. Note the water level changes during use.
- 6.** Do not place the steam hose flat on the ground or bend the hose. If the power line is damaged, do not use the steamer.
- 7.** Always keep the steam hose and nozzle above waist level to ensure smooth spraying of steam, prevent damage, and avoid inserting any objects into the steam hose or the opening.
- 8.** Do not cut or attempt to extend the steam hose or the power line.
- 9.** Avoid making direct contact between the nozzle and any surface or the power line while it is in use.
- 10.** Be cautious with steam sprayed from the nozzle. Do not direct steam towards any person or animal, and do not use the steamer if it is damaged.
- 11.** Do not use the steamer flat or upside down as it may cause hot water to spill.
- 12.** Before emptying the water tank and the water reservoir, turn off the steamer and allow it to cool for at least 30 minutes.
- 13.** Before refilling or draining water, and when cleaning or if not using the steamer, ensure it is turned off and unplugged.
- 14.** This appliance is for indoor use only.
- 15.** Ensure that the steam is directed away from flammable materials and chemicals.
- 16.** Do not fill the water tank with hot water or corrosive detergents. It is recommended to use soft or distilled water.

**17.** Only use parts supplied by the original manufacturer for this steamer. Parts from non-original manufacturers may cause fire, electric shock, or damage to the steamer.

**18.** It is not recommended for anyone with diminished physical, sensory, or cognitive abilities (including children) to use the steamer without clear instructions from a responsible adult.

**19.** Do not use an extension cord with the steamer. If an extension cord is necessary, ensure it has a capacity of at least 15A and do not share it with other home appliances to avoid overheating or electrical failures.

**20.** Always handle the extension cord carefully to prevent accidental disconnection.

**21.** The steamer features automatic steam exhaust vents on the bottom of the main body. Exercise caution during use to avoid exposure to steam.

**22.** Periodically clean the heater of the steamer to remove any buildup of calcium carbonate and salt particles on the heating element. Ensure the steamer is unplugged before cleaning.

**Warning:** Do not fill the water tank with perfume, descaling agents, ironing enhancements, or other chemicals, as these are incompatible with the product.

## **Warning**

**1.** In order to avoid the electric shock or other hazards, please shut down the steamer when it is not used and cleaned.

**2.** If the product cannot work normally or if there is any damage, leakage, etc., such as dropping or damage to the ironing head, the power line of an internal part, the connector, etc., it must be replaced by the authorized professionals.

**3.** If the power cord is damaged, it must be replaced by the authorized professionals. to avoid any hazard.

## **Features**

**1.** Features a versatile handle that rotates to accommodate a variety of garment steaming needs efficiently.

**2.** The ceramic soleplate ensures smooth gliding and even heat distribution, reducing the risk of fabric damage.

**3.** Offers continuous steam with a convenient refill-anytime system for uninterrupted ironing.

4. Employs a secondary steam pressurization system for deeper fabric penetration and better wrinkle removal.
5. Dual-functionality allows for both dry and steam ironing in flat or vertical orientations to suit different ironing needs.
6. Includes a protective jacket that can be detached for easier cleaning and maintenance.
7. Comes equipped with a clip hanger specifically designed for easily ironing trousers.
8. Integrates a built-in pump for continuous steaming and features a multi-level temperature control with a display ranging from 80°C to 200°C.
9. The adjustable board and dual-telescopic rods enhance customization for user comfort and better garment handling.
10. The steamer head can rotate up to 90 degrees, making it lighter and more agile than traditional steam irons for quick and efficient ironing.
11. Offers high versatility and convenience, allowing you to easily steam curtains, clothes, and other fabrics anywhere you need.

## Product Overview

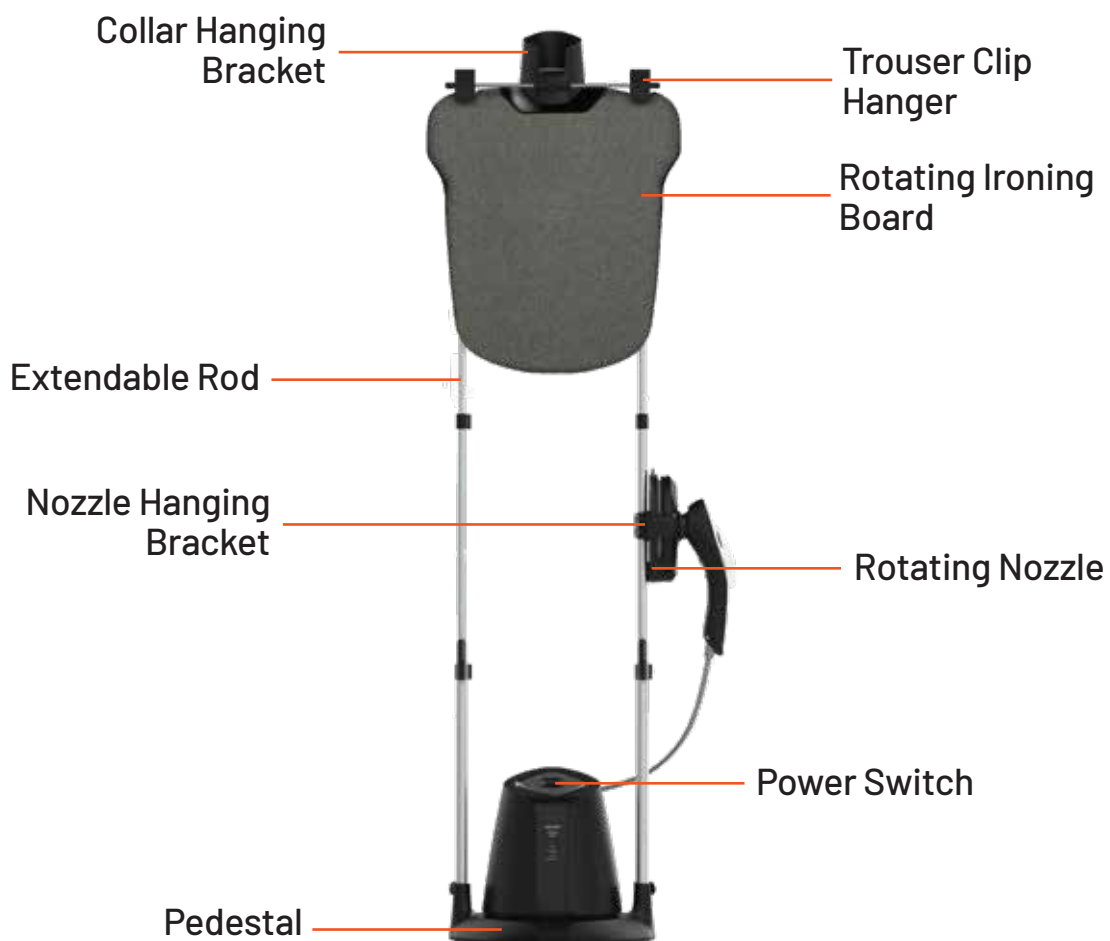

# Specifications

Rated Voltage	220-240V
Rated Frequency	50/60Hz
Rated Power	2500W
Tank Capacity	1200ML
Steam Output	40±5g/min
Temperature Levels	80°C, 100°C, 120°C, 140°C,160°C,180°C, 200°C
Power Cord	UK 3-Pin Plug
Net Weight	8.2 Kg
Product Dimension	430×360×1600mm
Accessories	Trouser Hanger Clip, Gloves
Electric Protection	Class I

# Indicator/Button Guide

## Display Guide

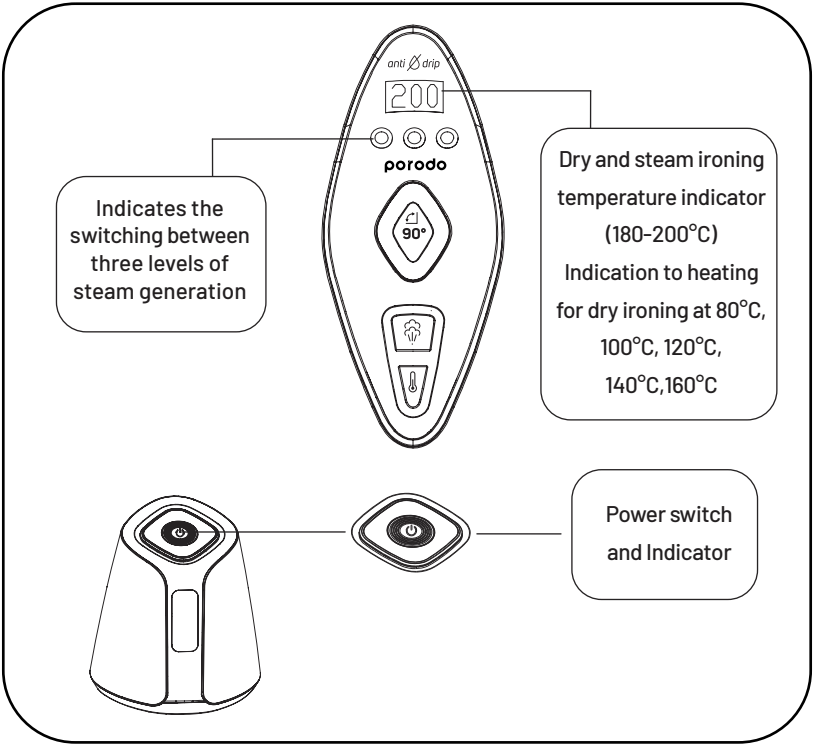

## Functional Buttons on Handle



## Knob of Nozzle

Knob of Nozzle Before use, adjust the nozzle to set your ironing needs. The nozzle panel can be rotated 90 degrees to the left by pressing the knob.

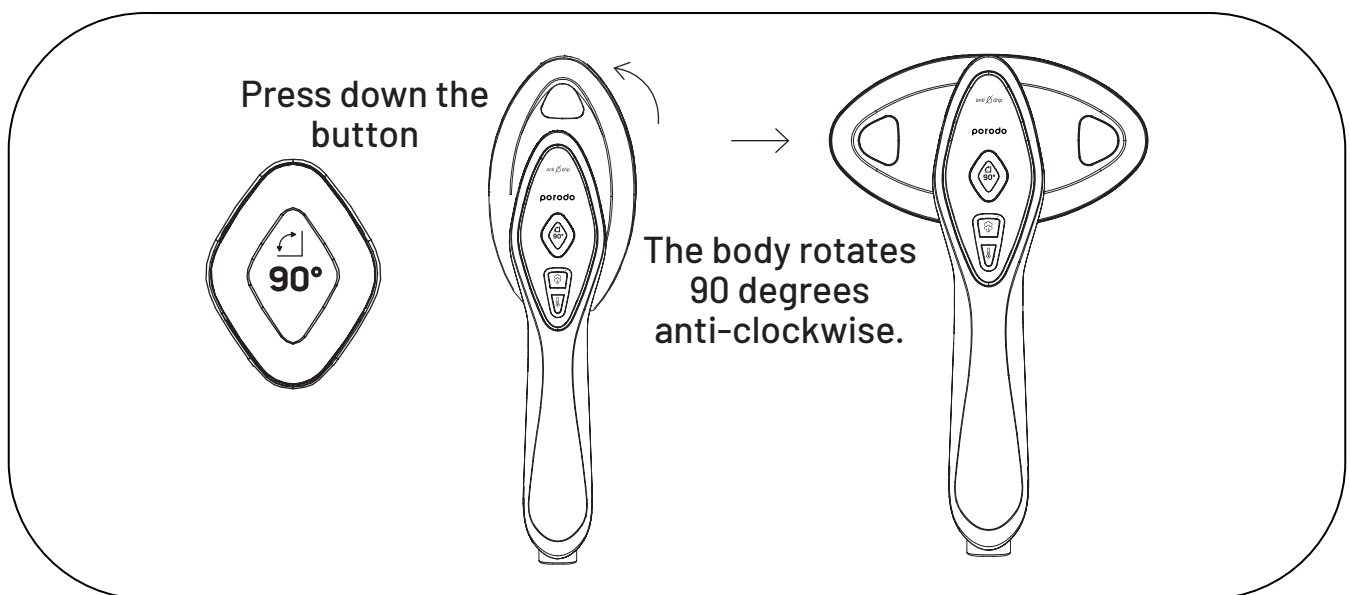

## Warning

1. Do not adjust the nozzle angle if the bottom surface of the nozzle has not cooled to room temperature to prevent burns from high heat.
2. Avoid adjusting the angle while the device is powered or immediately after use to prevent burns from the high temperature.

## Safety Pressure Relief Valve

When steam pressure in the heating body exceeds safe limits, the safety pressure relief device located at the bottom of the main body will automatically release the pressure. When operating the product, be cautious of the high-temperature steam to avoid burns.

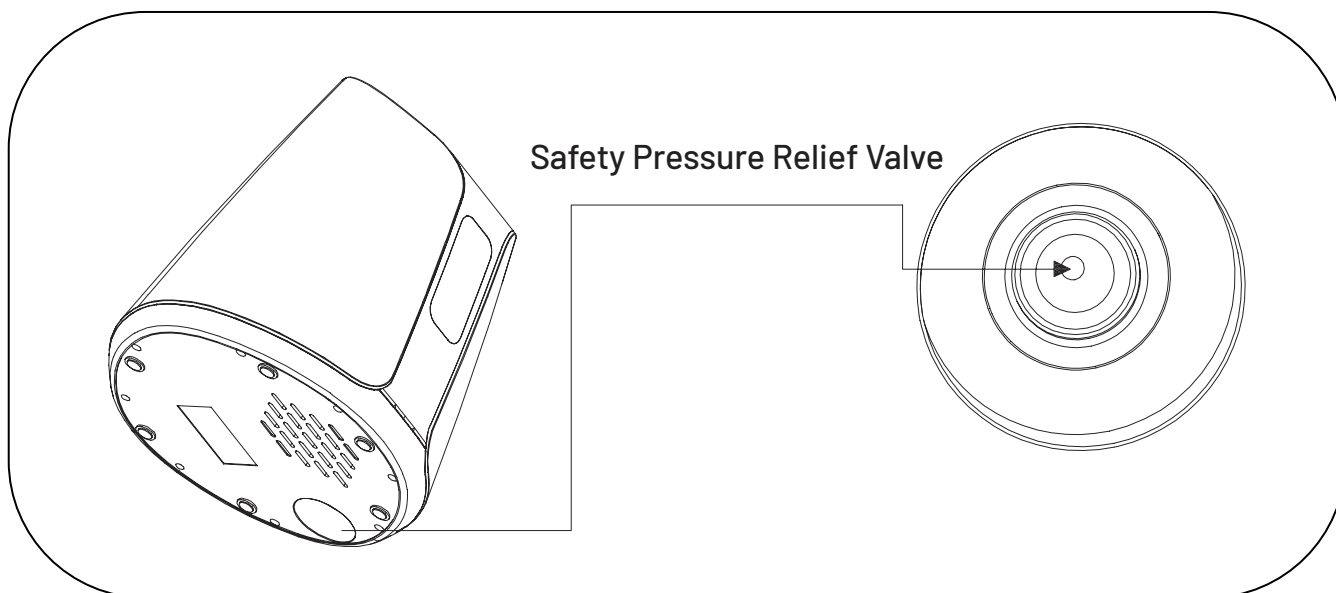

## Pre-heating and Standby

**A.** Turn on the power to initiate preheating:

**A.1** First gear reaches operational temperature in approximately 15 seconds.

**A.2** Seventh gear reaches operational temperature in approximately 40 seconds.

**B.** After the preheating phase completes in about 40 seconds, press the steam switch to transition into the steam ironing mode.

**C.** The machine will automatically power off after being on for 30 minutes to ensure safety and energy efficiency.

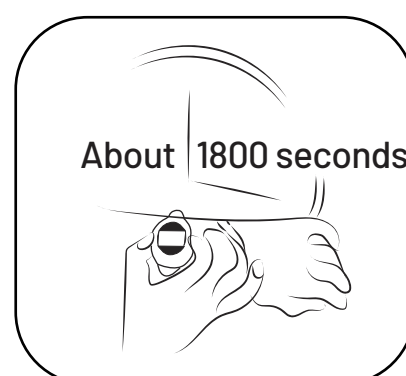
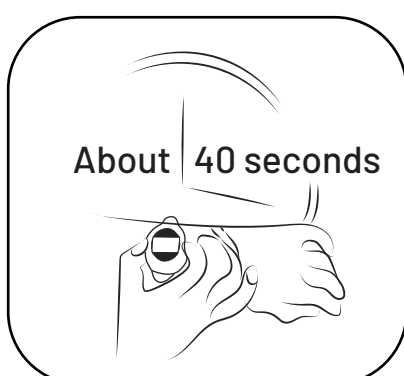
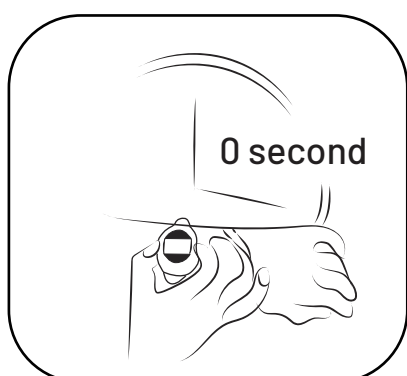



## Assembly

**Step 1:** Release the movable buckles located at both ends of the base and insert the two extendable rods, ensuring that the rods and the buckles on the base are aligned in the same direction.

**Step 2:** Extend the aluminum rods to the desired height and then tighten the buckles to secure them in place.

**Step 3:** Insert the collar hanging bracket into the top of the ironing board.

**Step 4:** Release the movable buckles on both sides of the ironing plate, then position it along the top of the extendable rods and secure the buckles.

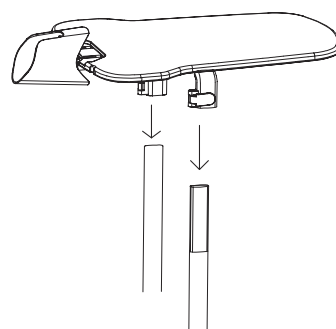
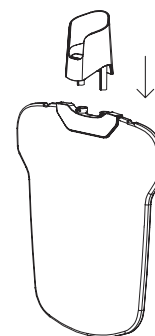
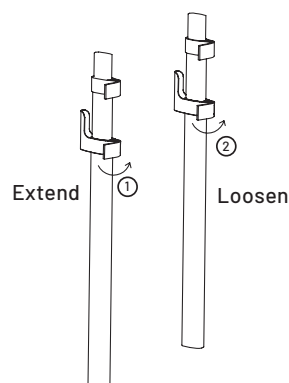
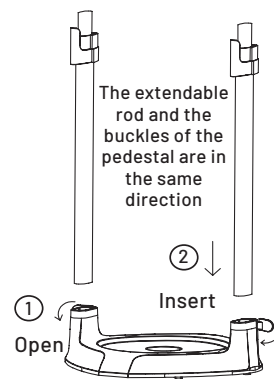

## Installing the Main Body

Attach the flat ironing board to the rotary nozzle.

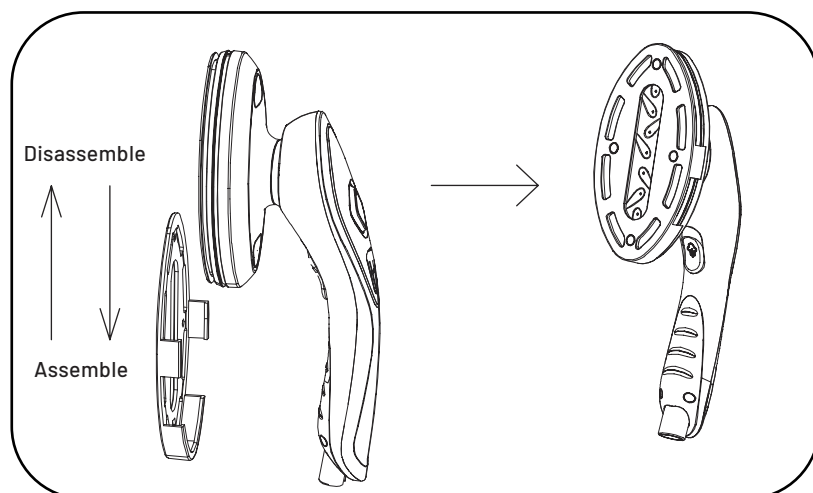

Extend the rods, adjust to the desired height, secure the buckle, and insert the rotary nozzle into the nozzle hanging bracket.

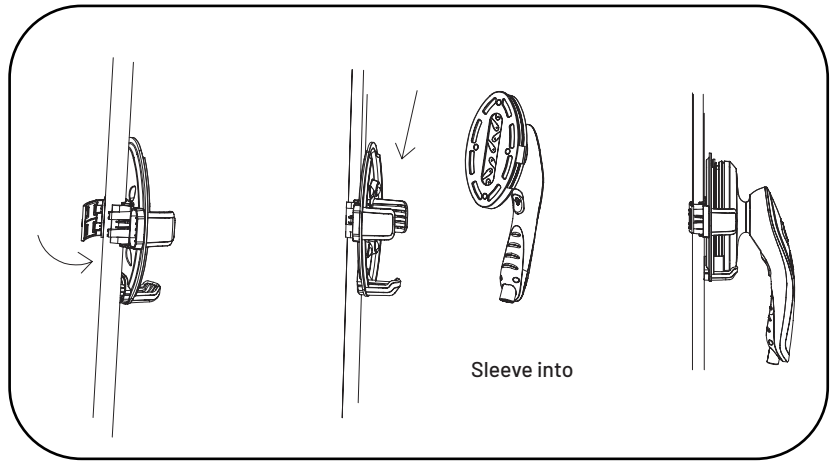

Position the main body; this completes the installation.

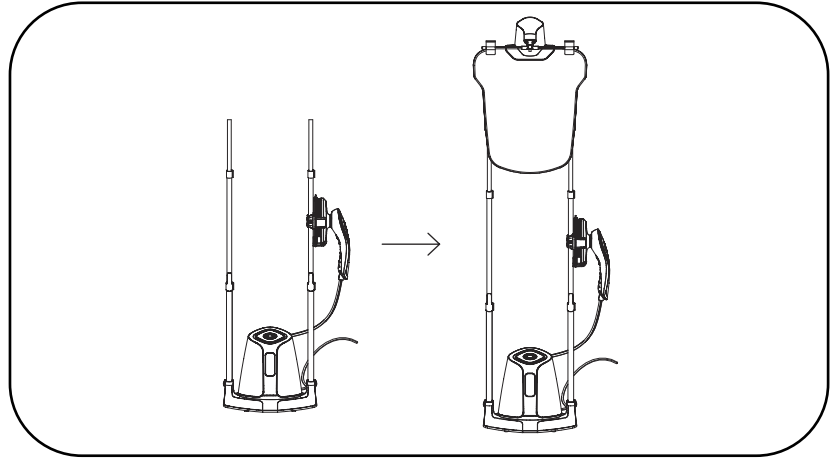

## Operating Guide

### **A.** Filling the Water Tank

Open the water filling plug, fill approximately 1.2L of water into the water tank, and securely close the plug of the water tank.

**Tip:** For optimal performance and extended service life, please use purified water.

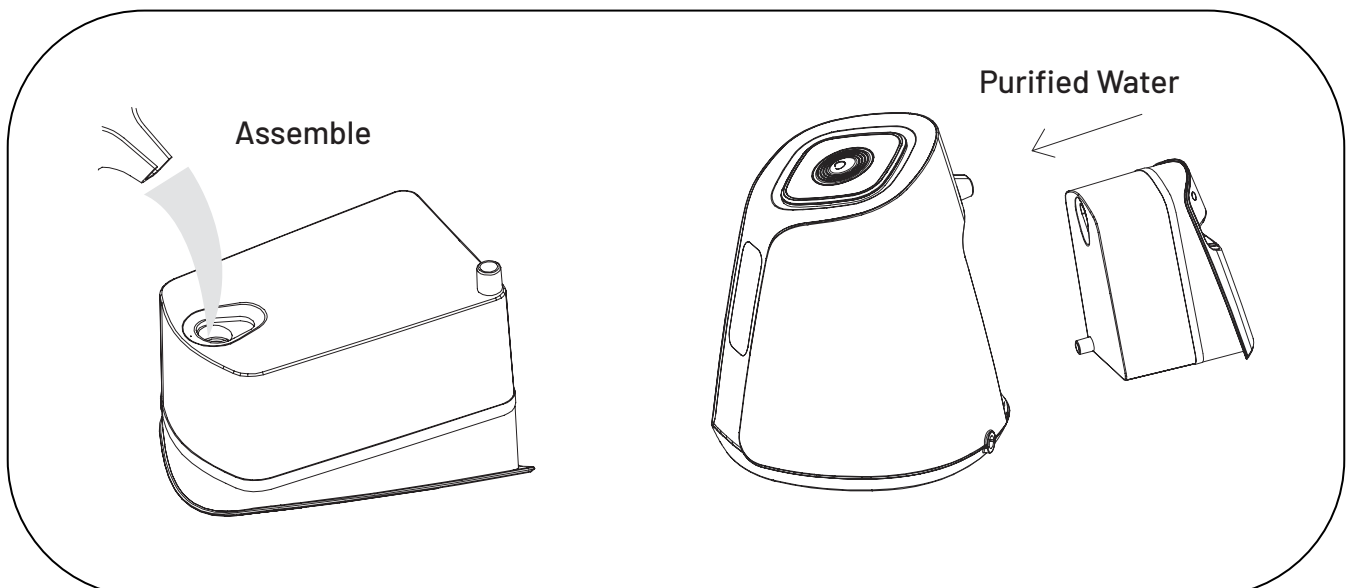

## B. Powering the Device

1. Turn on the power supply; the main body emits a buzzing "beep."
2. Hold the power switch on the main body for about one second. It emits a "beep" indicating the steamer is activated, and the power Indicator will illuminate.
3. Once powered, the lowest temperature level indicator flashes, signaling the start of the pre-heating process, which remains active until pre-heating completes.
4. Adjust the steam and temperature settings according to your ironing needs. These controls can be set as desired to achieve the required settings.

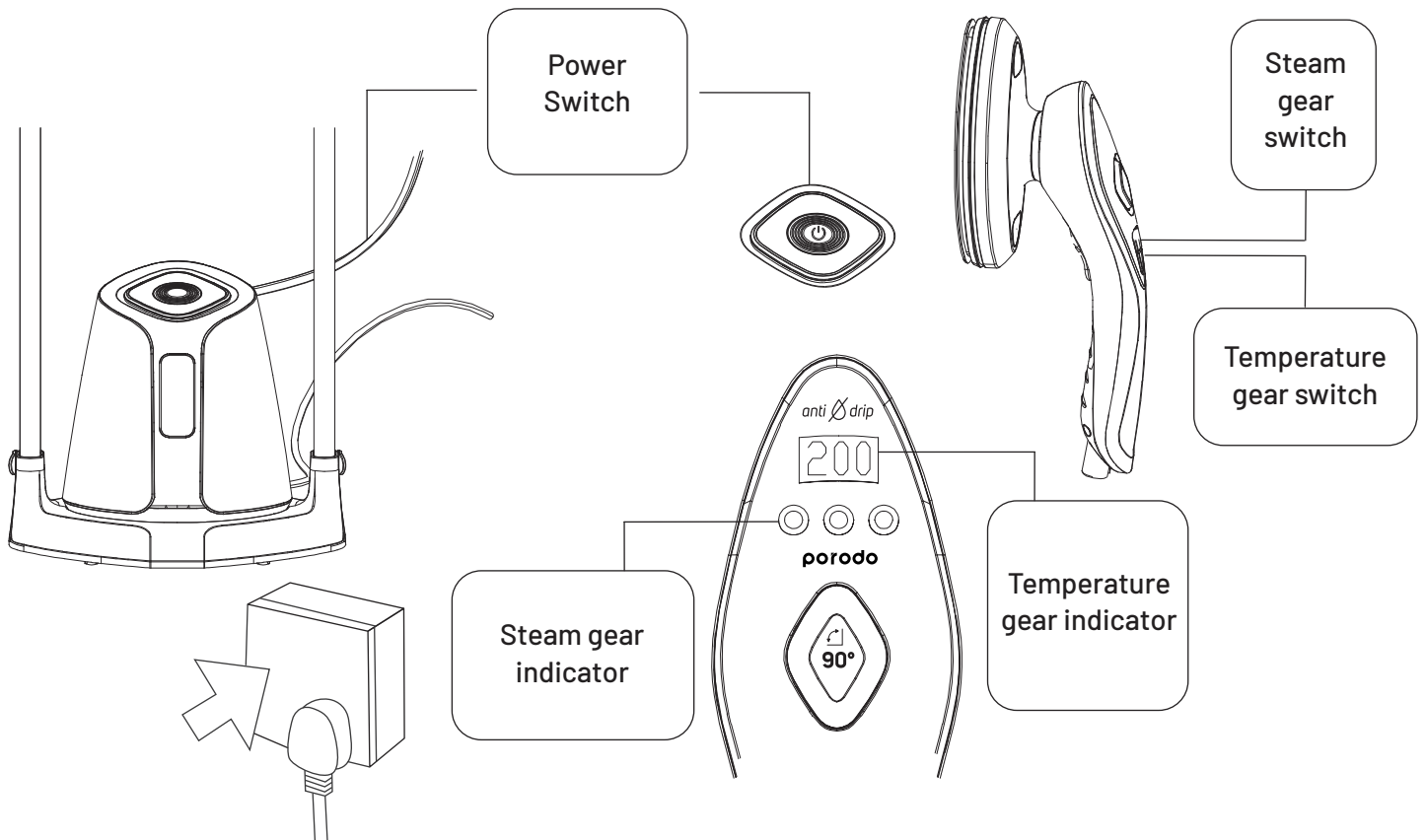

## C. Adjusting the Ironing Board

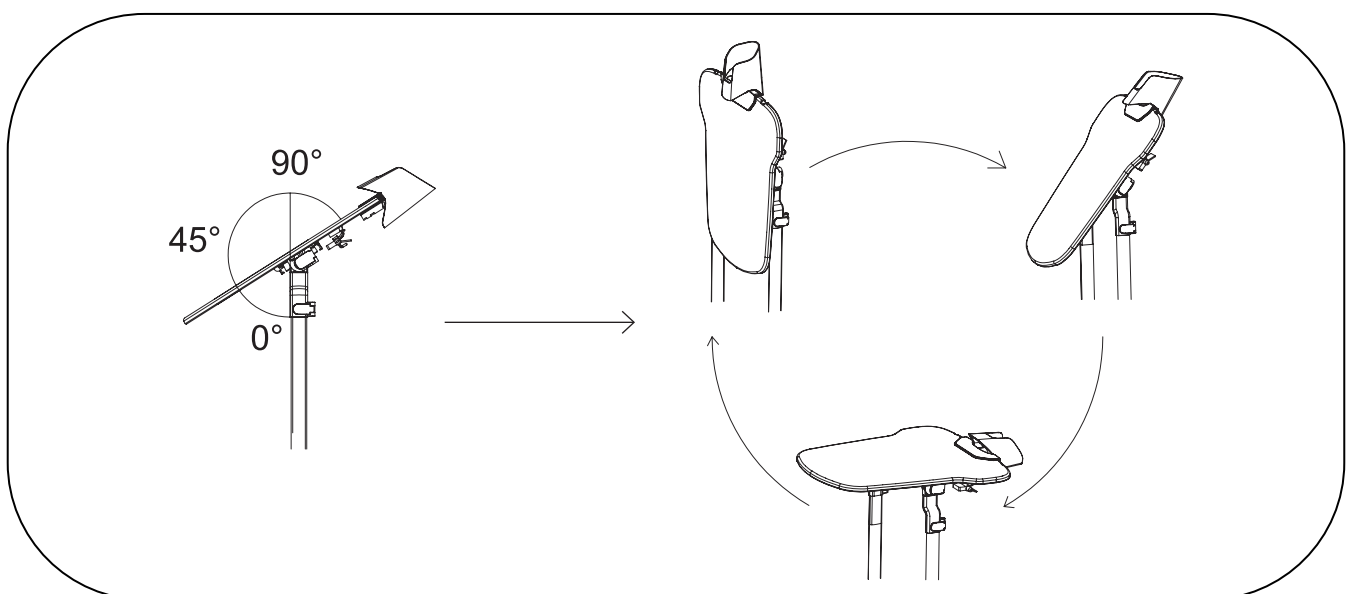

## D. Ironing the Clothes

### D.1 Steam Ironing of Clothes (Rotate the nozzle to 90 degrees)

Set the temperature to 200°C or 180°C as the steam ironing function is not available at other settings. Users can adjust the steam gear as needed. When the temperature indicator light stops flashing, press the steam button to start ironing. During the process, stretch the garment with one hand while holding the steamer with the other. Make sure the steam vents closely contact the garment, moving from top to bottom.

**Note:** For thicker garments, multiple passes may be necessary.





### D.2 Ironing of Clothes

Choose the appropriate temperature based on the fabric type. Lay the garment flat on the ironing board and gently smooth out wrinkles by hand before ironing. For areas with creases, carefully stretch the fabric while ironing to ensure a smooth finish. Begin ironing from smaller sections and gradually move to larger areas to prevent additional wrinkles. Always iron according to the fabric type and follow the temperature guidelines on the care label.

**Note:** If necessary, place a cloth or towel between the iron and the garment to protect delicate fabrics.

### D.3 Clothes Ironing Reference

This section will provide additional tips and guidelines tailored to specific fabric types, helping users achieve optimal results with their ironing.

Temperature	Clothing Fabric and Type	Symbol
High Temperature 200-180°C	Cotton, linen and short fiber	
Medium Temperature 160-140°C	Silk, wool, nylon, long rayon and copper rayon	
Low Temperature 120-80°C	Propylene, propylene, polyurethane and polypropylene.	
-	If no ironing is indicated on the clothing care label, please strictly follow.	

**Note:** To prevent scorching both the clothing and the ironing board, do not leave the nozzle in the same position for more than 30 seconds. When not in use, please return the ironing head to its holder.

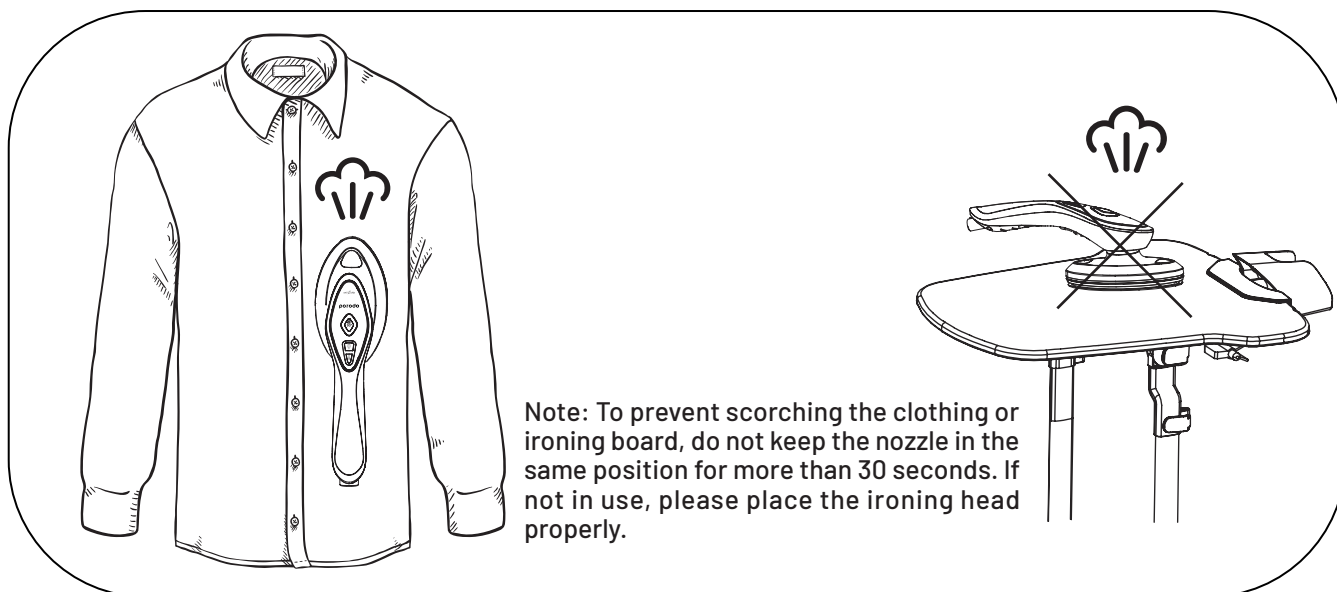

## Using the Clothing Clip

When ironing clothes in a hanging position, attach the clothing clip to the collar hanging bracket, adjust the clips on both sides based on the size of the clothing to be ironed, and then proceed with ironing.

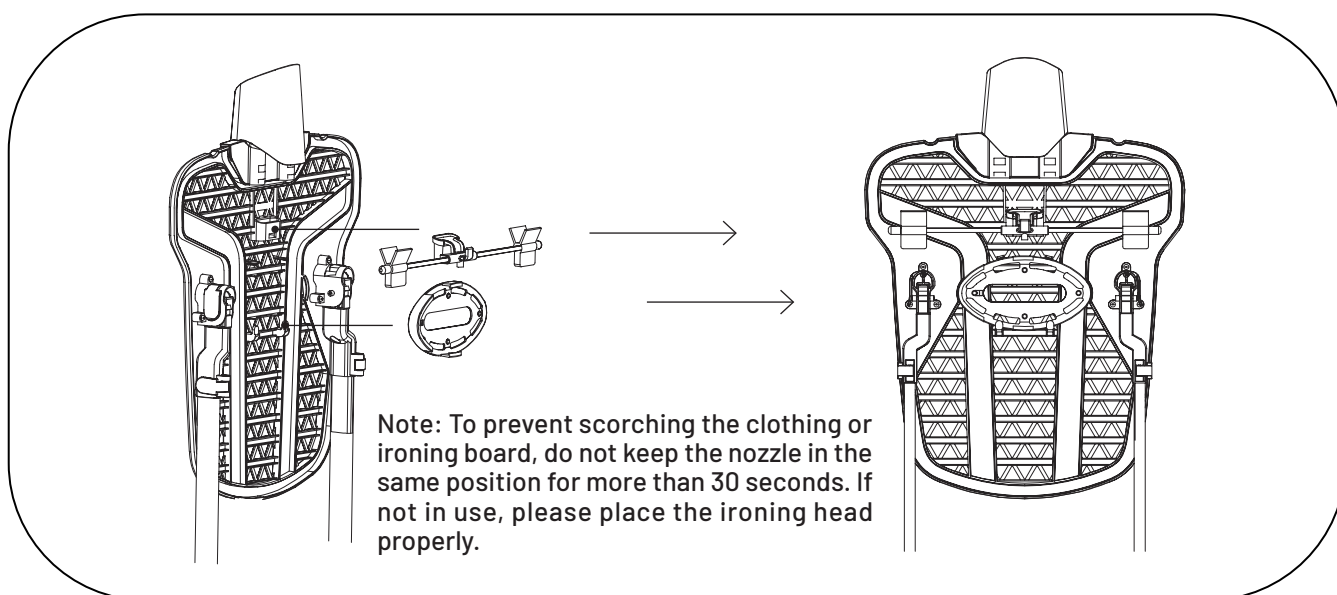

## Maintenance and Cleaning Note

### A. Shutdown and cooling

Press the power switch of the main body for 1 second, the main body emits a buzzing sound of “beep,” then the steamer shuts down, the power indicator lamp turns OFF. Pull out the power plug and wait for at least 30 minutes until the steamer cools down.

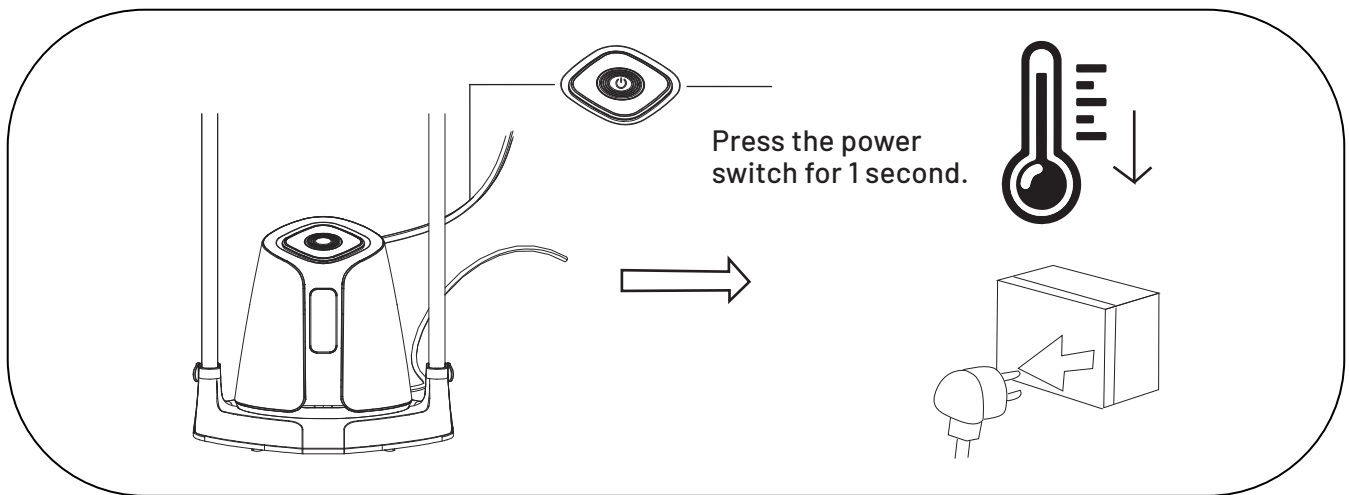

### B. Descaling

It is common for scale to accumulate in the steam chamber of the heater after prolonged use of tap water. To reduce scale, it is recommended to use filtered water, mineral water, or distilled water, and to carry out scale removal treatment at least twice per year.

**Note:** If using purified water is not feasible, scale can be reduced by following these steps at least once per month:

1. Ensure the power is unplugged from the product, and the product is completely cooled.
2. Fill vinegar and water in the proportion of 1:2 into the water tank.
3. After the product is electrified and heating is complete, turn on the steam switch to continuously spray steam for 5 minutes. Then turn off the steam switch and replenish fresh water if the water in the tank dries up.
4. Empty the mixed water remaining in the water tank. Use fresh water to clean the vinegar remaining in the tank until there is no smell of vinegar.
5. Fill with clean water and reuse after 1 hour.

### C. Adjusting the Rods

Remove the water tank, empty the water, and adjust the extendable rods for storage.

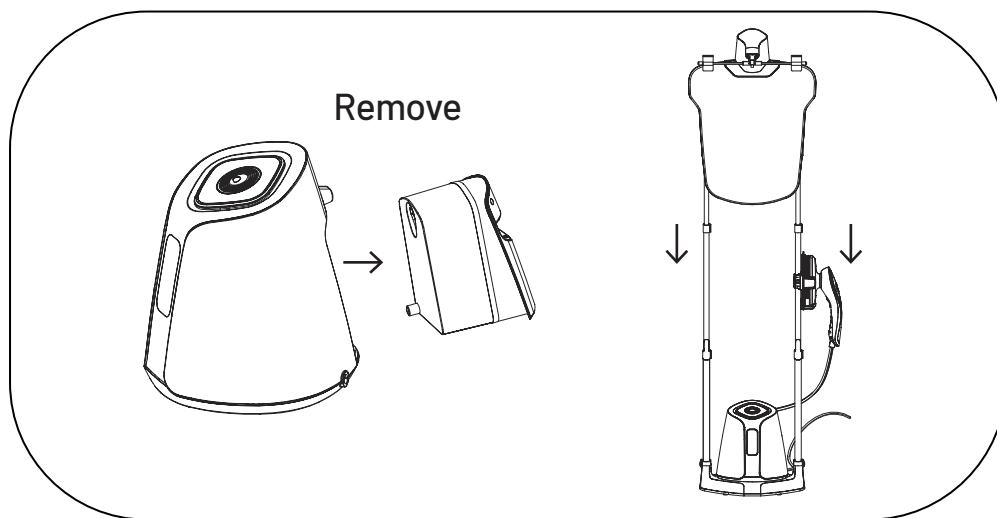

## Maintenance Precautions

1. Remove the steam brush from the steam head and clean it with a damp cloth.
2. Avoid using rough or abrasive detergents or solvents.
3. Do not immerse the steamer in water or any other liquid.
4. Prevent the appliance from falling, throwing, or bending.
5. Do not attempt to disassemble or dismantle the appliance.
6. Empty the water tank after each use.
7. Do not store the appliance in a damp location.
8. Keep the appliance away from heat sources and direct sunlight.
9. Ensure the steam outlet is clean and free of scale or blockages.
10. It is recommended to store the steamer upright in a flat position.

## Disposal



Dispose of the appliance at an officially designated recycling center to support environmental protection.

## Troubleshooting

1. It does not heat.

### Solutions:

- 1.1 Ensure the plug is correctly connected.
- 1.2 Check the power supply and turn it on.

**2.** It has little steam, or it does not generate steam.

**Solutions:**

**2.1** Verify that the water tank is installed correctly.

**2.2** Ensure the water tank is filled with appropriate water.

**2.3** If there is scale or waste in the water tank, clean it before use.

**3.** Water leaks from the tank.

**Solutions:**

**3.1** Make sure the water level does not exceed the tank's maximum capacity.

**3.2** Confirm that the water tank's inlet is securely closed.

**3.3** Refer to the operating manual and always keep the steamer in an upright position.

**4.** There is an obvious buzz or the sound of pumping when the steamer works.

**Solutions:**

**4.1** Check the water level; if the tank is empty, please refill it.

**5.** Avoid discoloration of metal accessories on clothes.

**Solutions:**

**5.1** Do not apply steam directly onto metal accessories.

**5.2** Exercise caution when using steam near any metal accessories.

**6.** There is a smell of cloth scorching.

**Solutions:**

**6.1** Ensure the steamer is set to the correct temperature as indicated on the clothing's care label.

**7.** White powder is present when steam is sprayed.

**Solutions:**

**7.1** This occurrence is not due to minerals in the water and is not abnormal. If it deposits on clothing, gently scrub and flip the fabric to clean.



## **Warranty**

Products that you buy directly from our **Porodo** website or shop come with a 24-month warranty.

When you buy **Porodo** products from any of our approved sellers, you only get a 12-month warranty. If you want to extend this warranty, go to our website at **porodo.net/warranty** and fill out the form with your information. Don't forget to upload a picture of the product too. After we've checked and accepted your request, we'll send you an email to confirm that your product's warranty has been extended.

For more info, please check:  
**porodo.net/warranty**

## **Contact Us**

If you have any questions about this Privacy Policy, please contact us at:  
**info@porodo.net**

Website: **porodo.net**

Service Support: **support@porodo.net**

Instagram: **porodo**