

LèPRESSO



LePresso

**FROTHMATE Milk Frother
with Interchangeable Whisks**

SKU: LPCFFM0014

Table of Contents

Features	2
Schematic View	2
Assembly	3
Instructions for Use	4
Cleaning and Maintenance	5
Safety Precautions	5
Troubleshooting	6
Specifications	7
Warranty	8
Contact Us	8

Features

1. This device is perfectly designed to whip cream and eggs efficiently, delivering consistently smooth results.
2. It effortlessly handles the mixing of various batters and sauces, ensuring a lump-free consistency.
3. The milk frother excels in frothing thick milk, creating rich and creamy textures ideal for beverages.
4. Offers three adjustable speed levels to accommodate different frothing or mixing needs.
5. Engineered for rapid frothing, this feature allows you to achieve desired foam consistency in less time.
6. Equipped with a high-speed motor reaching up to 6500 RPM, ensuring quick and efficient performance.

Schematic View

1. USB-C Charging Port

2. Power Button

Note: Press the power button twice to start working.

3. Working Indicator

4. Host

5. Spring Head

6. Balloon Head

7. U Head

8. USB-C Charging Cable

9. SUS-304 Stander

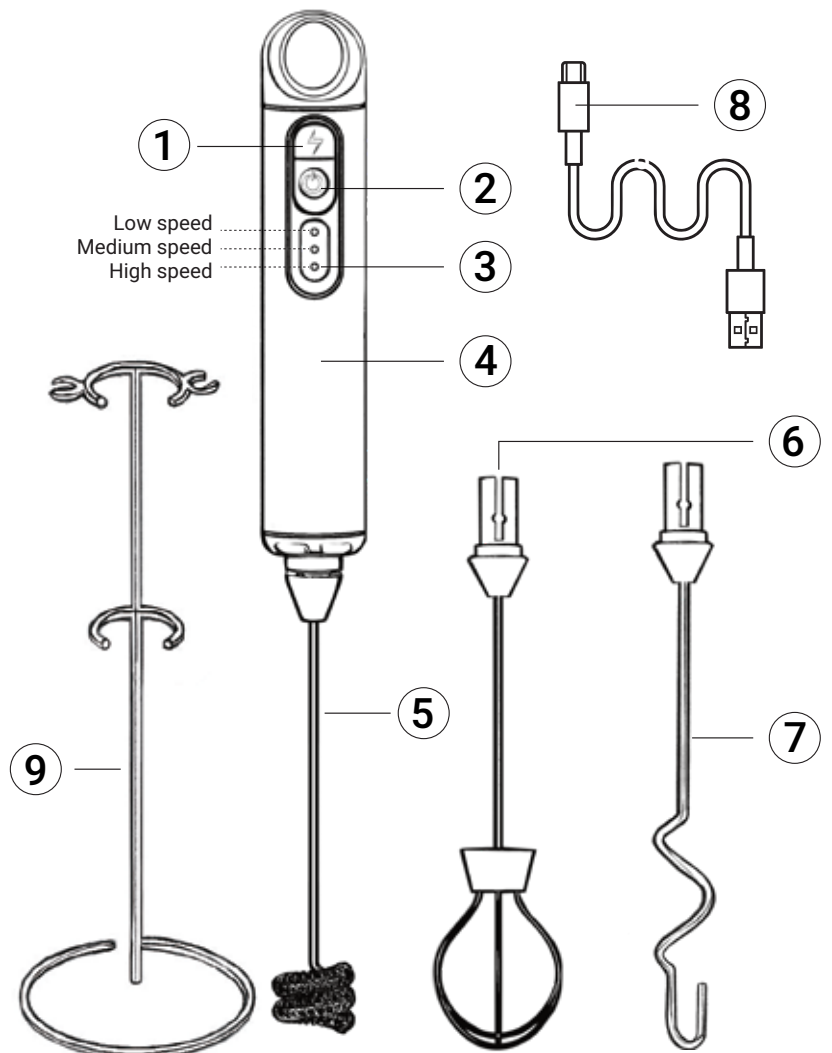

Assembly

1. Firmly press down on the whisk to secure it into the host unit.

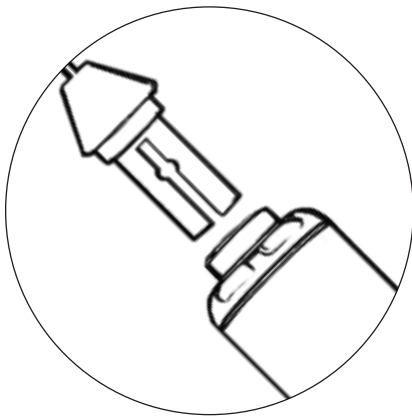
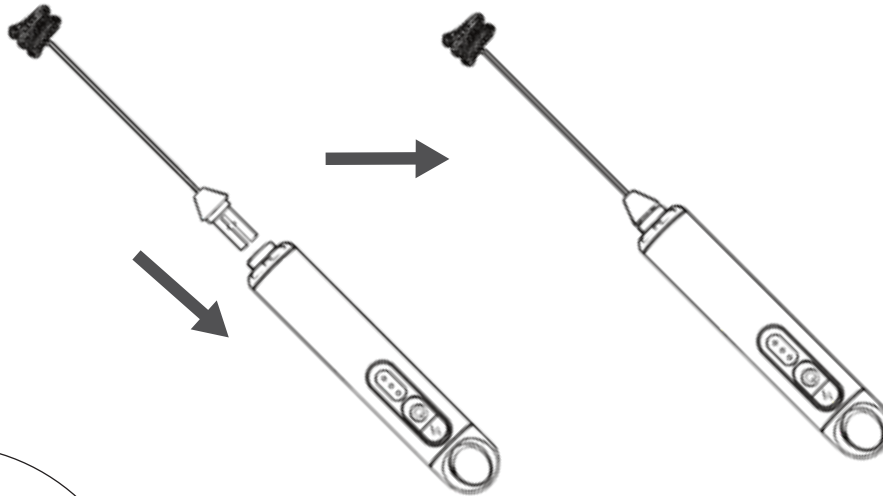

Gently press the components together until they securely connect.

Warning: For your safety, confirm that the whisk is securely attached before operating the device.

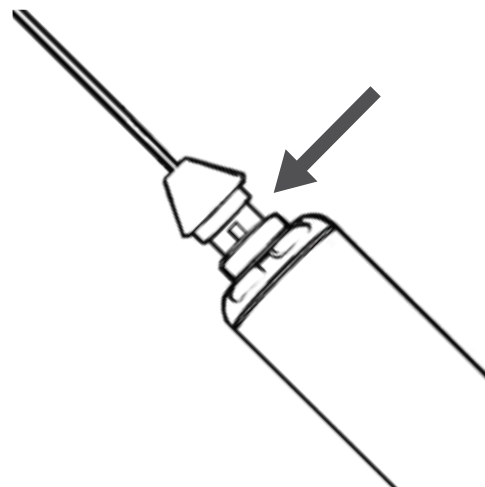
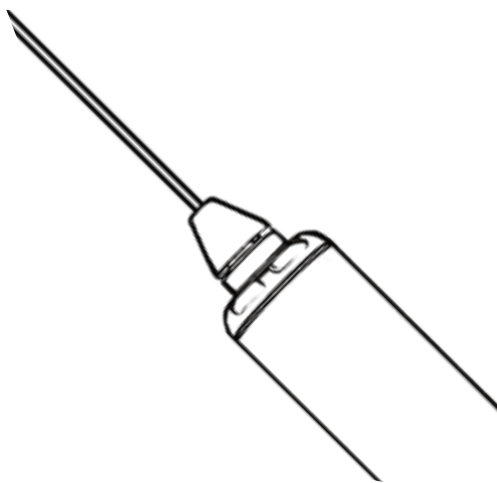

2. To detach the whisk, firmly grip and pull it out securely.

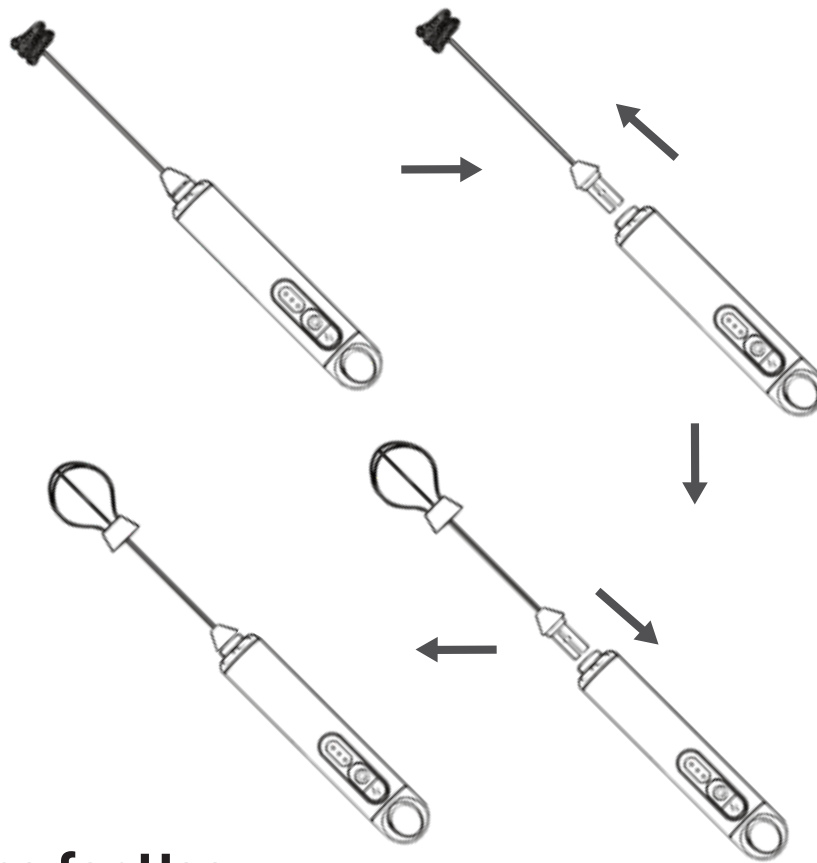

Instructions for Use

Power On	Double-click the power button.
Adjusting Operation Level	Press the power button once.
Power Off	Press and hold the power button.

1. Fill the container with 1/3 to 1/4 of either hot (100 - 140°F) or cold (33 - 41°F) milk, or any other liquid of your choice.

2. Tilt the container slightly, submerge the whisk below the surface of the milk, then double press the power button to start. Move the whisk slowly in a circular motion for 30-45 seconds to create rich, creamy foam.

3. To change speed settings, press the power button twice to activate the frother, then press once to cycle through the three speed options. A red light indicates a low battery level.
4. The frother will automatically shut off after 400 seconds of use. To stop immediately, press and hold the power button.
5. A flashing red light indicates low battery. While charging, a red light signifies charging is in progress and a green light confirms the battery is fully charged.

Cleaning and Maintenance

1. The main unit is not waterproof. Avoid immersing or exposing it to water during any cleaning processes.
2. Submerge the whisk part in hot or warm water and briefly operate the frother to help clean it.
3. After cleaning, remove the whisk from the water, detach it from the main unit, and let it dry completely.

Warning: Ensure no part of the main unit gets wet during cleaning.

4. Wipe the main unit with a dry cloth to remove any dust or spills.
5. After drying, wipe the whisk with a dry cloth and reattach it to the main unit.

Note: For best results, clean the whisk immediately after use to prevent residue buildup, which can be difficult to remove once dried.

Safety Precautions

1. Never allow children to use this device without adult supervision.
2. Do not place your hands near the blending mechanisms while the device is in operation.
3. The frother is not dishwasher safe.
4. Operate your frother only for its intended use to prevent damage.

- 5.** Do not charge the frother when it is wet. Always use the high-quality USB-C charging cable provided.
- 6.** Avoid touching the spinning whisk or the bottom of the cup during use.
- 7.** Do not immerse the main unit in water or expose it to moisture.
- 8.** The device is not waterproof. Always detach the whisk and dry it separately after cleaning.
- 9.** Keep your hair away from the whisk when the device is operating to prevent entanglement.
- 10.** Do not disassemble the device yourself. Repairs should only be carried out by qualified personnel.
- 11.** Never touch the whisk while it is spinning; contact with the rapidly moving whisk can result in serious injury.
- 12.** Never position the device near flammable materials, gas stoves, or electric heaters.
- 13.** Do not operate the device continuously for more than two minutes at a time.
- 14.** Avoid dropping or striking the device to prevent damage.
- 15.** This device is designed for liquid use only and should not be used to process solid foods.
- 16.** Ensure supervision when charging the device, particularly in vehicles.

Troubleshooting

Whisk Not Spinning	Ensure the battery is fully charged.
No Foam	Confirm that you are using either whole milk or barista-style milk designed for frothing. Check that the whisk is fully submerged and in complete contact with the milk.

Specifications

Material	ABS+304 SUS
Working Voltage	3.7V
Battery Capacity	1500mAh
Charging Voltage	5V/1A
Motor Speed	6500rpm
Charging Time	1.5 hours
Speed Adjustment	3 Speeds Available
Unit Weight	160g
Working Time	6 Minutes/Cycle



Warranty

Products that you buy directly from our **LePresso** website or shop come with a 24-month warranty.

The 24-month warranty applies to products purchased directly from our **LePresso** website or store. If **LePresso** products are bought from any of our verified retailers, then the product is eligible for only a 12-month warranty. To extend your product's warranty, visit our website <https://www.lepresso.com/warranty> and fill in your details in the provided form along with an uploaded picture of the product to process your request. Once approved, you will receive a confirmation email of the extended product warranty. Upload the required information within 48 hours of purchase to be eligible for a 24-month warranty period.

For more info, please check:
<https://www.lepresso.com/warranty>

Contact Us

If you have any questions or concerns about our Shipping and Returns Policy, please contact us at: info@lepresso.com

Website: <https://www.lepresso.com/>

Instagram: [lepresso_official](https://www.instagram.com/lepresso_official)