

LèPRESSO



LePresso

**Cold Brew Machine for
Ice Coffee and Tea**

SKU: LPCFFM0005-BK

Table of Contents

Features	2
Safety Precautions	2
Electrical Safety Notes	4
Schematic View	5
Before First Use	5
Instructions for Use	6
Cleaning and Maintenance	6
Descaling	7
Tips	8
Specifications	8
Warnings	9
Warranty	10
Contact Us	10

Features

- 1. Easily start the brewing process with just a single adjustment, offering convenience and efficiency.**
- 2. Enhances safety by automatically turning off the machine when not in use.**
- 3. Accommodates a significant amount of coffee or tea, allowing for larger brews.**
- 4. Durable and reusable filter that can be easily cleaned and used multiple times.**
- 5. Allows customization of the beverage strength to suit personal taste preferences.**

Safety Precautions

When using this electrical appliance, adhere to the following basic safety precautions:

- 1. Read all instructions before use.**
- 2. Ensure your outlet's voltage matches the voltage specified on the appliance's label.**
- 3. To mitigate the risk of fire, electric shock, or injury, never immerse the cord, plug, or the appliance itself in water or any other liquid.**
- 4. Always supervise the appliance when used near children.**
- 5. Disconnect the appliance from the electrical outlet when not in use and before cleaning. Allow it to cool down before attaching or removing parts and before cleaning.**
- 6. Do not operate the appliance if it has a damaged cord or plug, or if it has malfunctioned, or been damaged in any way. Send the appliance to an authorized service center for assessment, repair, or adjustment.**

- 7.** Using attachments not recommended by the manufacturer may cause hazards.
- 8.** Avoid using the appliance outdoors.
- 9.** Ensure the cord does not hang over the edge of a table or counter, or touch any hot surface.
- 10.** Do not place the appliance near or on a hot gas burner, electric burner, or inside a heated oven.
- 11.** Use the appliance only for its intended purpose as described in this manual.
- 12.** Avoid cleaning the appliance's container with abrasive materials like steel wool pads.
- 13.** To turn the appliance off, adjust any controls to the "Off" position and then remove the plug from the wall outlet. Always grasp the plug directly; never yank on the cord.
- 14.** There is a risk of scalding if the cover is removed during brewing. Avoid touching any steam emitted by the appliance.
- 15.** Certain parts of the appliance can become very hot during use. Handle only the knobs or handles provided.
- 16.** Do not place a hot carafe on either hot or cold surfaces immediately after brewing.
- 17.** Do not use the appliance if the carafe is cracked or the handle is loose, as it may lead to breakage or injury. Always handle the carafe with care as it is delicate.
- 18.** Ensure the appliance has water in it before turning it on to prevent damage.
- 19.** This appliance can be operated by individuals with reduced physical, sensory, or mental capabilities if they have received appropriate supervision or instruction concerning safe appliance use.
- 20.** Close supervision is necessary when this appliance is used by or near children.

- 21.** Do not attempt to repair the appliance yourself. No parts inside are user-serviceable. Repairs should only be carried out by authorized service personnel.
- 22.** The container provided with this appliance is specifically designed for use with this model only and should not be used on a stove top or any other heat source.
- 23.** The appliance must not be immersed in water or any other liquids.
- 24.** This coffee maker is designed for household and similar applications, such as use in farm houses, staff kitchen areas, offices, and other working environments. It is also suitable for use in hotels, motels, and other residential-type environments, including bed and breakfast establishments.

Electrical Safety Notes

- 1.** Before connecting the device, verify that the electrical input requirements match those of your power outlet.
- 2.** This appliance is equipped with a polarized plug to reduce the risk of electric shock.
- 3.** This plug is designed to fit into a polarized outlet only one way. If the plug does not fit fully into the outlet, reverse the plug. If it still does not fit, contact a qualified electrician.
- 4.** Do not attempt to modify the plug in any way.
- 5.** A short power-supply cord is provided to reduce the risks associated with becoming entangled in or tripping over a longer cord.
- 6.** Longer detachable power-supply cords or extension cords could be used if safety measures are considered. In this scenario note the following:
 - 6.1** The marked electrical rating of the detachable power-supply cord or extension cord should be at least as great as the electrical rating of the appliance.
 - 6.2** If the appliance is of the grounded type, the extension cord should be a grounding-type 3-wire cord.

- 6.3** The longer cord should be arranged so that it will not drape over the countertop or tabletop where it can be pulled on by children or tripped over.
- 7.** These instructions are vital for the safe operation and maintenance of your appliance. Always ensure adherence to prevent accidents and improve the lifespan of your device.

Schematic View

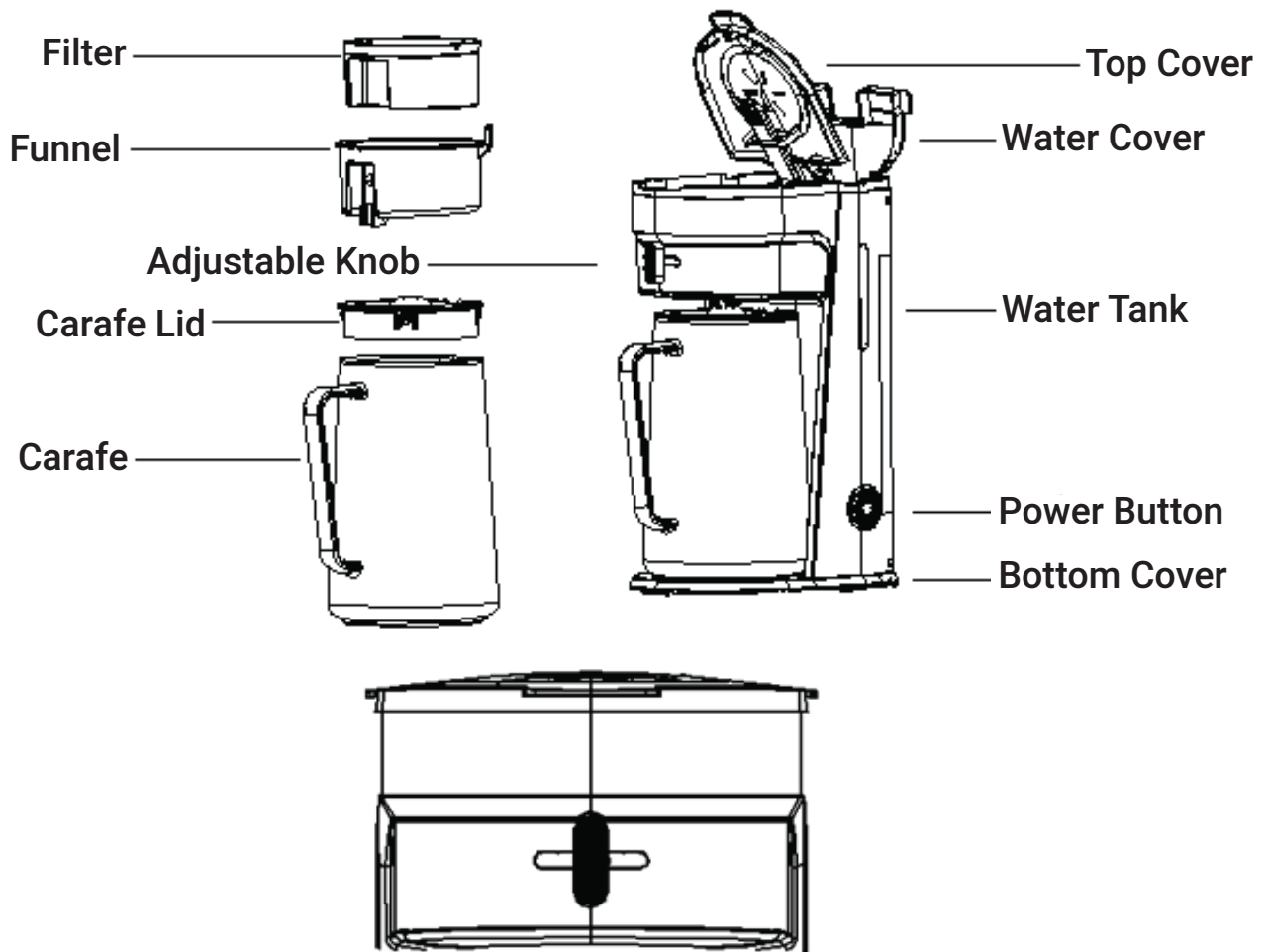

Increase the concentration gradually by moving the key from left to right.

Before First Use

- 1.** Before the first use, ensure all accessories are included and the unit is undamaged.
- 2.** Fill the water tank to the MAX level and brew plain water several times without adding coffee or tea, then discard the water.
- 3.** Thoroughly clean and dry all detachable parts.

Instructions for Use

1. Open the water tank lid and fill it with potable water. Ensure the water does not surpass the MAX level as indicated on the tank.
2. Place the funnel into its support ensuring correct assembly to avoid hindering the tank lid's closure. Insert the filter into the funnel.
3. Add the appropriate amount of coffee or tea into the filter, then securely close the water tank lid.
4. To prepare iced beverages, add ice to the glass carafe but do not exceed the MAX level marked on the water tank.
5. If brewing hot coffee or tea, avoid adding ice into the carafe. Instead, place the carafe onto its holder.
6. Connect the power cord to an outlet. If desired, adjust the beverage strength using the left and right turns of the strength knob.
7. Press the "On/Off" button to start. A blue light will indicate the machine is operational.
8. Brewing can be paused at any moment by pressing the "On/Off" button and resumed by pressing it again.
9. You may remove the carafe at any time to pour a drink; the machine will automatically stop dispensing but should not exceed 30 seconds.
10. Once brewing completes, the machine will shut off automatically, and the "On/Off" indicator will turn off.
11. For optimal taste, it is advisable to consume iced coffee or tea immediately after brewing.
12. Always turn the appliance off and disconnect it from the power source when not in use.

Cleaning and Maintenance

1. After each use, clean all detachable parts with hot soapy water.
2. To remove any stains or marks, gently wipe the exterior surface of the unit with a soft, damp cloth.
3. If water droplets accumulate in the funnel and drip onto the base during

- brewing, wipe the affected area with a clean, dry cloth to prevent dripping.
4. Clean the glass carafe holder with a damp cloth. Avoid using abrasive cleaners as they can damage the surface.
 5. After cleaning, reassemble all parts and store the appliance for future use.
 6. **Cleaning Surfaces in Contact with Food:** To maintain hygiene and prevent contamination, clean all surfaces that come into contact with food or liquids, such as the water reservoir, brewing chamber, and carafe, after each use. Use a soft cloth or sponge with warm water and mild detergent.
 7. Do not immerse the appliance in water or any other liquid to prevent electrical components from being damaged.
 8. Avoid abrasive cleaners or scouring pads, which could scratch or damage the surfaces.
 9. For a more thorough cleaning, refer to the detailed instructions in the manual. Regular cleaning will help ensure optimal performance and prevent contamination.
 10. Children should not clean the appliance without supervision. Ensure that the appliance is cleaned only by responsible adults.

Warning

- [1] Always unplug the appliance before cleaning to prevent electrical shock.
- [2] Never immerse the cord, plug, or appliance in water or any other liquid.

Descaling

To ensure efficient operation of your coffee maker, it's important to periodically remove mineral deposits caused by water. Depending on the water quality in your area and frequency of use, follow these steps:

1. Mix water and a descaling solution in a 4:1 ratio, up to the maximum level marked on the water tank. You can use citric acid. Mix 3 parts of citric acid per 100 parts of water (3:100).
2. Place the glass carafe properly onto its holder.
3. Ensure that the funnel and filter are securely in place.
4. Turn on the appliance to start the descaling process. Allow the solution to brew through the system.

5. After brewing a cup of the solution, turn off the coffee maker and let the solution sit in the appliance for 15 minutes.
6. Repeat the brewing process to flush out more mineral deposits.
7. After completing the descaling, empty the water tank.
8. Run fresh water through the system at least three times to thoroughly rinse any remaining descaling solution from the coffee maker.

Tips

1. Maintaining a clean coffee maker is crucial for preparing exceptional iced coffee or tea. Follow the cleaning instructions in the "Cleaning and Maintenance" section regularly.
2. Always use fresh, cold water to fill the coffee maker.
3. Keep unused coffee powder in a cool, dry place. Once opened, seal it tightly and store it in the refrigerator to preserve its freshness.
4. For the best flavor, purchase whole coffee beans and grind them just before brewing.
5. Avoid reusing coffee powder, as this significantly reduces the flavor. Also, reheating coffee is not advised because coffee is most flavorful immediately after it is brewed.
6. Clean your coffee maker if you notice over-extraction or oiliness. Over-extraction pulls excessive oil from the coffee, evident from small oil droplets on the surface of brewed coffee. This is more likely with heavily roasted coffees.
7. For tea, always use fresh tea leaves to ensure the best flavor.

Specifications

Rated Voltage	220-240V
Rated Frequency	50-60Hz
Rated Power	750W
Power Plug	UK 3-Pin Plug
Water Tank Capacity	0.9L
Pitcher Capacity	2.5L
Product Net Weight	1.81kg
Product Dimension	275×167×348mm

Warnings

- 1. Warning of Potential Injury:** Misuse of the ice coffee maker, such as improper assembly, overfilling the water reservoir, or using the appliance for purposes other than its intended use, may result in injury or damage. Always follow the operating instructions carefully.
- 2.** Do not operate the appliance with any parts removed or improperly assembled.
- 3.** Keep body parts away from moving parts, and avoid contact with hot or cold surfaces during operation.
- 4.** Always turn off and unplug the appliance before cleaning, assembling, or disassembling.
- 5.** Keep out of reach of children, and ensure that the appliance is used only by responsible adults or under supervision.
- 6. Residual Heat Warning:** The surface of the heating element or other hot parts remains hot even after the appliance is turned off. Allow sufficient cooling time before touching any parts that are in contact with the heating element to avoid burns or injury.
- 7.** To minimize the risk of burns, handle with care after use and allow it to cool completely before cleaning or handling.
- 8. Do Not Immerse in Water:**
- 9.** To avoid damage to the electrical components, do not immerse the appliance in water. Clean the appliance with a damp cloth and mild detergent, ensuring that no water enters the electrical sections.
- 10. Do Not Place in a Cabinet While in Use:**
- 11.** Never place the ice coffee maker in a closed cabinet or enclosed space while it is in operation. Ensure that the appliance has adequate ventilation during use to prevent overheating and ensure safe operation.

Warranty

Products that you buy directly from our **LePresso** website or shop come with a 24-month warranty.

The 24-month warranty applies to products purchased directly from our **LePresso** website or store. If **LePresso** products are bought from any of our verified retailers, then the product is eligible for only a 12-month warranty. To extend your product's warranty, visit our website **<https://www.lepresso.com/warranty>** and fill in your details in the provided form along with an uploaded picture of the product to process your request. Once approved, you will receive a confirmation email of the extended product warranty. Upload the required information within 48 hours of purchase to be eligible for a 24-month warranty period.

For more info, please check:

<https://www.lepresso.com/warranty>

Contact Us

If you have any questions or concerns about our Shipping and Returns Policy, please contact us at: **info@lepresso.com**

Website: **<https://www.lepresso.com/>**

Instagram: **[lepresso_official](#)**