

LèPRESSO



LePresso

**Portable Espresso Machine
with Heating and Temperature Gauge**

SKU: LPCFFM0001

Table of Contents

Features	2
Safety Precautions	2
Charging and Indicator	4
Troubleshooting Guide	5
Schematic View	5
Specifications	6
Instructions for Use	6
A. Using Coffee Capsules	7
B. Using Ground Coffee	9
Additional Tips	10
Cleaning and Maintenance	11
Warranty	12
Contact Us	12

Features

1. This espresso machine is among the smallest and lightest on the market, designed for full functionality and easy portability.
2. Featuring an advanced battery management system that maximizes energy efficiency and minimizes space usage. The machine is built with a double-layer heat insulation structure and crafted from durable stainless steel.
3. Adheres to standards set by the European Coffee Brewing Center (ECBC), ensuring controlled temperature, pressure, and brewing time for coffee with exceptional crema and aroma.
4. Equipped with a built-in lithium battery for ease of use, the coffee maker can be operated with just the touch of a button.
5. Compatible with both coffee grounds and capsules.
6. Initiate heating with cold or warm water, then extract at 93°C for hot espresso.
7. Utilize preheated water for immediate extraction, significantly increasing the number of possible brews.
8. Suitable for use indoors, in vehicles, or outdoors—perfect for satisfying coffee cravings anytime, anywhere.
9. The machine can be charged using a USB Type-C connector, providing convenience and portability, making it an ideal travel companion.

Safety Precautions

1. This product is designed for personal use only.
2. After unpacking, verify that the product and all accessories are complete and undamaged.
3. Before first use, run cold water through the device to clean its internal components. It is not necessary to install the portafilter for this operation;

simply fill the water tank with cold water and press the power button to start.

4. Keep packaging materials and accessories out of reach of children to prevent potential hazards.

5. Ensure the product is not left unattended while charging, especially in a vehicle, to avoid risks associated with improper charging.

6. Store the product in a cool environment away from direct sunlight to preserve its integrity and functionality.

7. This appliance is not safe for cleaning in dishwashers or heating in microwaves, and must not be placed on a gas burner, electric burner, or inside an oven.

8. Use only purified water to ensure the best performance and flavor of your coffee.

9. Always fill the water tank before use. Do not operate the heating function without water, and never fill water above the maximum indicated level to prevent damage to the machine.

10. If using the heating function continuously, allow a cooling period of 5-10 minutes between cycles to prevent the machine from overheating.

11. Do not open the water chamber lid during heating to avoid the risk of injury from boiling water.

12. Ensure the portafilter is tightly secured before use to avoid puncturing the coffee capsule and to prevent water leakage.

13. Be cautious when handling the machine and consuming coffee immediately after brewing, as the beverage will be very hot.

14. Handle the portafilter and capsule adapter with care immediately after use due to high temperatures.

15. Do not immerse the espresso machine in water. Clean the exterior with a damp cloth and hand wash the coffee cup, portafilter, capsule adapter, ground coffee filter basket, and cover separately.

16. Use only parts recommended by the manufacturer. Employing unauthorized or unapproved parts may lead to damage and is not advisable.

Charging and Indicator

A. Charging

1. The machine will not operate while charging. Please ensure it is fully charged before use.
2. Always use the charging cable provided with the device. If the machine does not charge, try another Type-C cable, as the original may be damaged.
3. Be aware that low-quality adapters and cables can extend charging times or prevent the machine from charging properly.
4. If the battery indicator shows only 25 % after delivery (1 light bar), this may be due to a dislodged voltage detection line. Contact authorized service professionals for a replacement if this occurs.
5. Use a Type-C adapter for charging.

Important Notice: It is crucial to use high-quality adapters and charging cables. Poor-quality accessories can significantly extend charging times and may even prevent the device from charging properly, potentially causing damage.

B. Battery Indicator Lights

1. The LED light bar shows both the battery power level and water temperature status.
2. Battery levels are indicated as follows:
* 1 light: 25 % | * 2 lights: 50 % | * 3 lights: 75 % | * 4 lights: 100 %.
3. LED lights will flash to show the current battery level. All four lights will remain on when the battery is fully charged.

C. Operation During Charging

1. The device can heat water and extract coffee if the battery level is above 2 bars.
2. If the battery level is at 1 bar, the device may be unable to heat.

3. Press the power button once to check the battery status. If the lights flash five times, the battery is too low for operation. Please charge the device fully before use.

Troubleshooting Guide

Condition	Indicator Status	Solution
Low Battery	The lights flash 5 times	Please operate after fully charged
Battery Overheating Protection	The lights and machine will be turned off automatically	Please use the machine after 5 minutes
Boil-Dry Protection	The middle two lights flash 5 times	Please pour water into the water tank before using the heating function

Schematic View

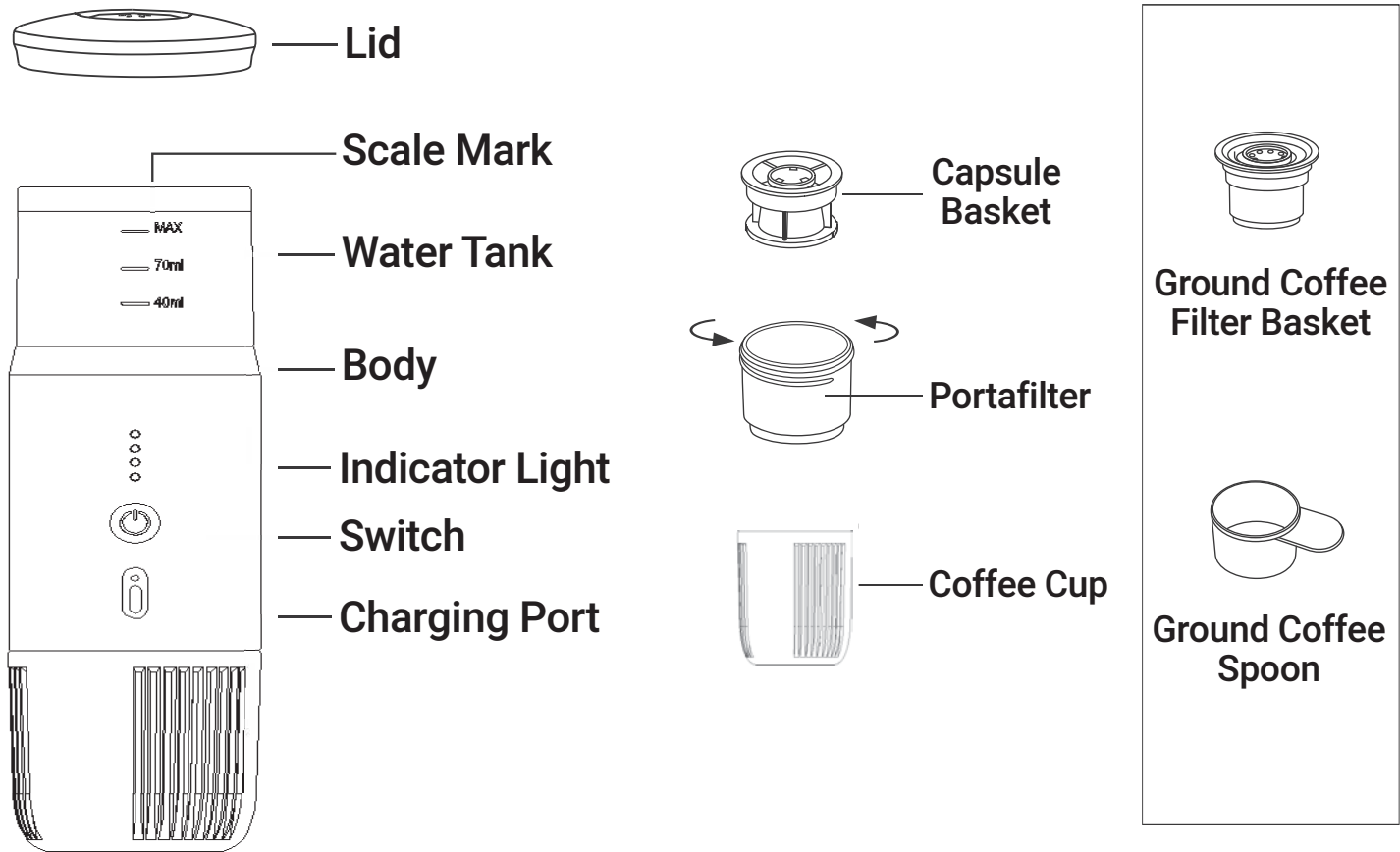

Caution: Always select the appropriate accessories for your coffee machine.

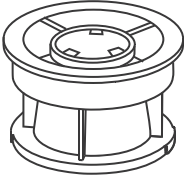
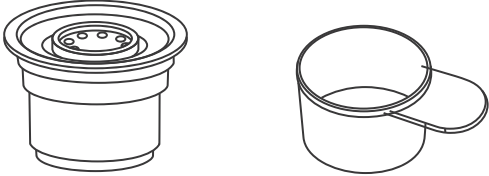
<div>Capsule Adapter</div> <div></div> <div>Compatible with various capsule coffee brands.</div>	<div>Ground Coffee Filter Basket</div> <div></div> <div>Suitable for loading ground coffee in quantities ranging from 5 to 8 grams.</div>
---	---

Specifications

Battery Capacity	2500mAh ×3
Input	5V/3A
Charging Port	Type-C
Power Output	135W
Battery Life	Up to 200 Single-Espresso (Pre-heated Water), Up to 5 Single-Espresso (Cold or Room Temperature Water)
Extraction Pressure	15 Bar
Water Tank Capacity	80 ml
Product Material	Food Grade Stainless Steel
Product Net Weight	706g
Compatibility	Coffee Capsule and Powder

Instructions for Use

This device is a portable electric espresso machine. It allows for the extraction of both ground coffee and coffee capsules. To ensure optimal performance, please adhere to the following instructions.

► A. Using Coffee Capsules

Before starting, ensure the battery is fully charged. The device's battery status can be verified by the LED indicators.

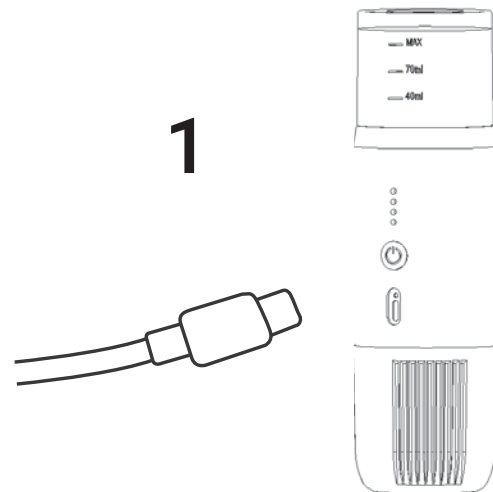

During charging, the LED lights will flash. Once fully charged, all LED lights will remain lit for one minute, then turn off.

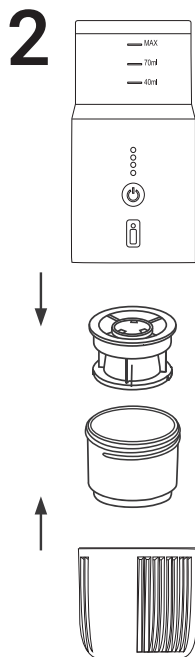

Disassemble the lower parts of the machine to prepare for capsule insertion.

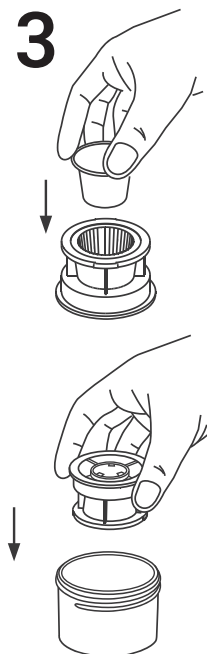

Place a coffee capsule into the capsule adapter. Press firmly to secure the capsule within the portafilter.

4

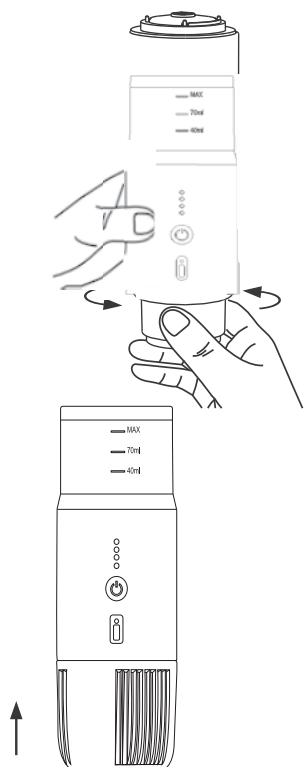

Attach the portafilter tightly to the main body of the machine. Ensure it is securely fastened to avoid any brewing issues. Place the coffee cup under the spout.

5

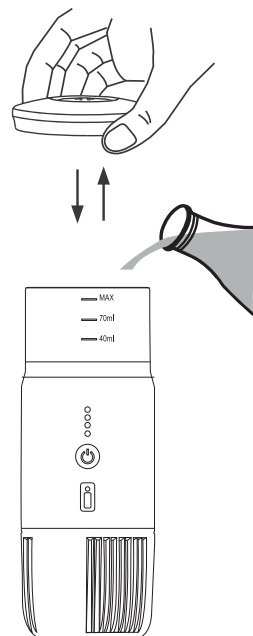

Remove the upper lid of the water tank, pour water up to the required level, and securely replace the lid.

[1] For Cold Water Use: Press and hold the button for 5 seconds to initiate the heating process. The LED indicators will blink during this time. Heating takes approximately 4-3 minutes after which the machine will automatically begin extracting coffee.

[2] For Hot Water Use: Simply press the button twice to start extraction immediately. Using preheated water can conserve battery power and reduce heating time.

6

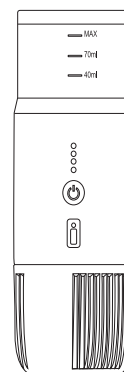

Additional Tips

1. Using preheated or boiled water will save time and battery life.

2. Finer coffee grounds are recommended for a richer extraction and more cream.

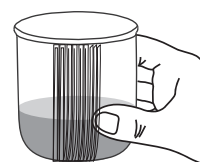

Important Reminders

1. Ensure Nespresso capsules are firmly pressed into the adapter, and verify that the portafilter and capsule adapter are securely tightened to prevent operational failures.
2. Occasionally, the voltage detection line might disconnect during shipping, showing only a 25% battery level persistently. If this occurs, please reach out to our support team for a machine replacement.

► B. Using Ground Coffee

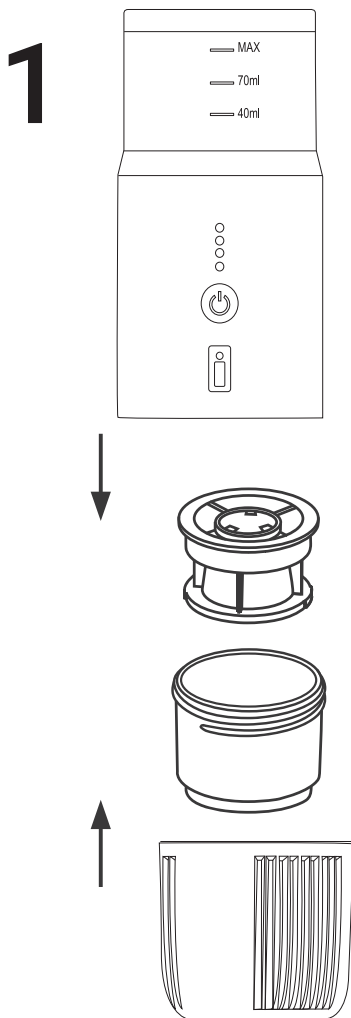

Disassemble the lower parts of the espresso machine to access the filter basket and portafilter.

2

Add ground coffee to the filter basket. Ensure the coffee is evenly distributed and compacted to achieve optimal extraction.

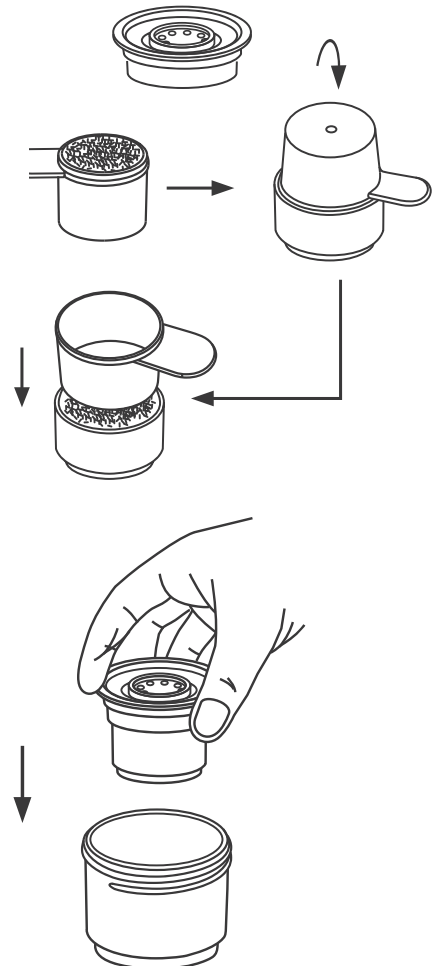

Place the filled filter basket into the portafilter. Ensure it is correctly aligned.



- [1]** Attach the portafilter to the machine's main body. Ensure it is tightly screwed on. Otherwise, the brewing process may not proceed correctly.
- [2]** Place a coffee cup. Turn on the machine to begin the coffee extraction process.

Additional Tips

1. Ensure the ground coffee filter basket or capsule adapter is properly installed. Incorrect installation can lead to loss of airtightness, resulting in water retention in the portafilter during extraction. Additionally, overly fine coffee grounds can clog the filter basket.
2. The following issues can prolong extraction time or prevent the machine from stopping automatically:
 - [a]** Overly fine ground coffee.
 - [b]** Excessive coffee in the filter basket.
 - [c]** Using hard-surfaced capsules.If any of these occur, manually stop the machine by pressing the power button.
3. If the machine has not been used for an extended period, the battery may be too low, causing delayed response when starting to charge. Allow the battery to charge for a while before use.
4. Damage during shipment or delivery may affect the heating element

or the NTC sensor, impairing the machine's ability to heat water. If temperature detection fails, the machine may not heat properly.

5. if any issues with heating or temperature detection are suspected, please contact the professional service centers.

Cleaning and Maintenance

- 1.** Before first use, wipe the product to remove any dust or dirt that may have accumulated during shipping.
- 2.** Use cold water to flush the device's internal components before each use to ensure optimal performance. Fill the water tank with cold water and press the power button twice to initiate the cleaning cycle. It is not necessary to install the portafilter for this process.
- 3.** Do not submerge the main body of the machine in water or expose it to direct flowing water to prevent damage. Other removable parts can be cleaned with water; refer to the detailed instructions on page 1 of this manual.
- 4.** Clean the machine thoroughly after each use to maintain its condition and ensure longevity. Confirm that it is completely dry before storing.
- 5.** Store the espresso machine in a cool and dry environment to prevent moisture damage and extend its lifespan.

Warranty

Products that you buy directly from our **LePresso** website or shop come with a 24-month warranty.

The 24-month warranty applies to products purchased directly from our **LePresso** website or store. If **LePresso** products are bought from any of our verified retailers, then the product is eligible for only a 12-month warranty. To extend your product's warranty, visit our website **<https://www.lepresso.com/warranty>** and fill in your details in the provided form along with an uploaded picture of the product to process your request. Once approved, you will receive a confirmation email of the extended product warranty. Upload the required information within 48 hours of purchase to be eligible for a 24-month warranty period.

For more info, please check:

<https://www.lepresso.com/warranty>

Contact Us

If you have any questions or concerns about our Shipping and Returns Policy, please contact us at: **info@lepresso.com**

Website: **<https://www.lepresso.com/>**

Instagram: **[lepresso_official](#)**