

PORODO
LIFESTYLE



Porodo Lifestyle
MINI MIST FAN Desktop Air Cooler
with LED Display and Knob Control

SKU: PDF853WH

Table of Contents

Product Overview	2
Specifications	2
Schematic View	3
Package Contents	4
Operation Guide	5
LED Display	6
Battery Usage Guidelines	6
Water Tank Maintenance Guide	7
Safety Precautions	8
Disposal	9
Warranty	9
Contact Us	9

Product Overview

The Porodo Mini Mist Fan Desktop Air Cooler is a compact and efficient cooling solution designed to deliver personalized comfort. It features dynamic airflow control with five adjustable fan speeds, making it ideal for various cooling preferences. The air cooler also features an instant cooling mist function, providing a refreshing mist on demand with two spray modes, powered by a generous 250ml water tank. For ease of use, it features a smart LED display, enabling users to view the real-time battery percentage at a glance. The unit also has a convenient LED night light, adding to its functionality and enhancing the ambiance. Whether you need a quick cool-down or a peaceful night’s rest, the Porodo Mini Mist Fan is the perfect desktop companion for your cooling needs.

Specifications

Input	5V/1.5A
Tank Capacity	250mL
Battery Capacity	2000mAh
Rated Power	7.4W
Working Time	1.5-7 Hours
Charging Time	2H
Charging Interface	Type-C

Product Weight	600g
Product Size	113 x 157 x 187mm
Model Number	PDF853

Schematic View

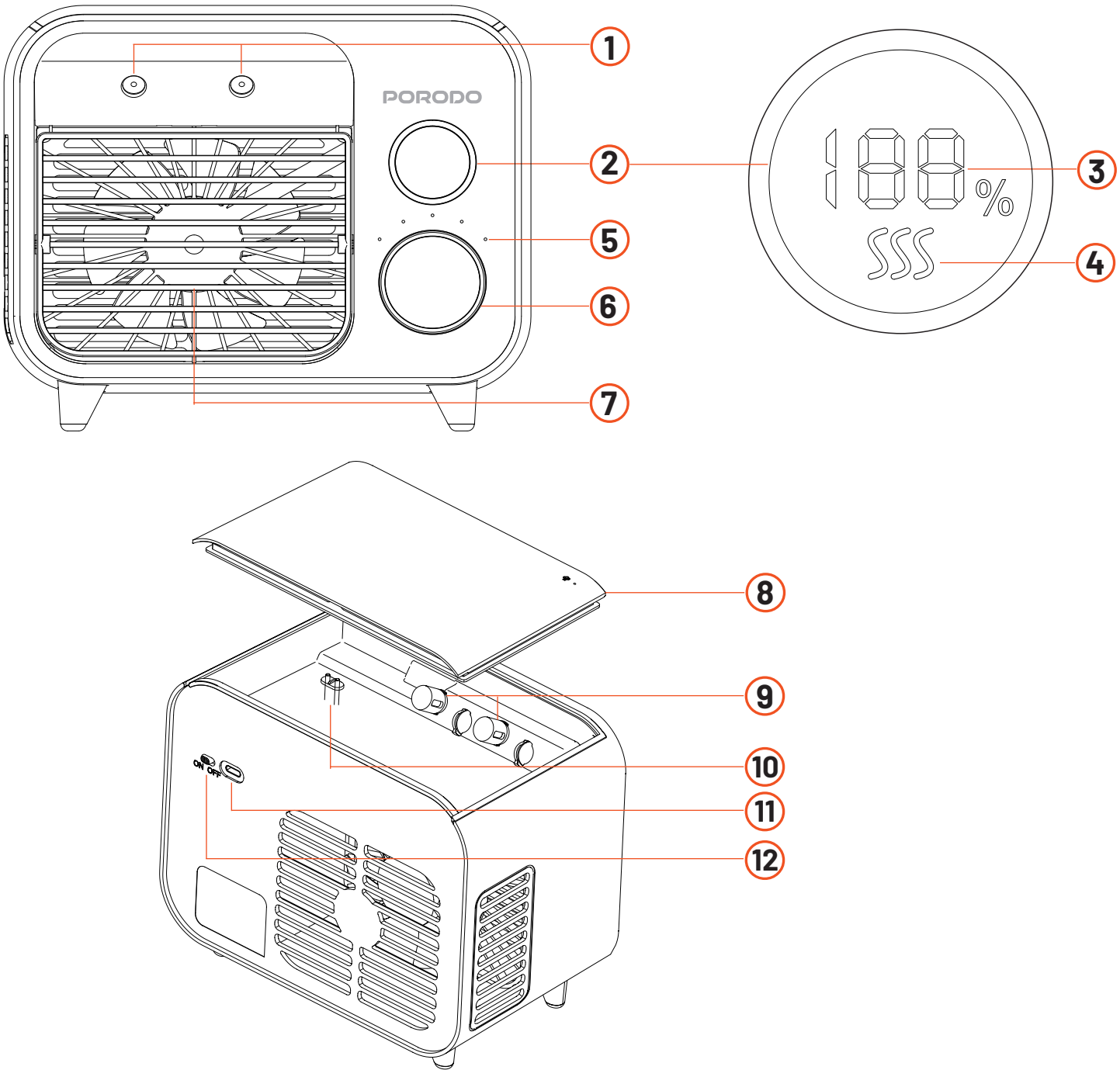

- 1. Vaporizing Atomizer:** The component responsible for vaporizing the liquid or substance inside, creating the mist or vapor.
- 2. Digital LED Display:** A visual interface showing key information such as settings, battery life, or operational status, using light-emitting diodes.
- 3. Battery Indicator:** Indicates the remaining battery charge to ensure proper usage and timely recharging.
- 4. Spray & Water Shortage Indicator:** Displays the status of the spray function and alerts when the water level is low.
- 5. Gear Mode Indicator:** Displays the current gear or mode setting of the device, helping the user track the performance or functionality selected.
- 6. Knob Button:** A mechanism used to control various settings or power levels on the device.
- 7. Adjustable Fence:** A movable part that allows the user to adjust the distance or positioning of the device's working area for better precision.
- 8. Secure Water Tank Cover:** A protective lid for the water tank, ensuring no leakage and maintaining proper water storage within the device.
- 9. Liquid Flow Tube:** The conduit through which liquid or vapor flows, often connecting the atomizer to other parts of the device.
- 10. Precision Measurement Probe:** A sensor or tool used to measure or detect specific parameters like temperature, pressure, or moisture.
- 11. USB Type-C Charging Port:** A modern, reversible charging port used to power the device, compatible with USB Type-C cables.
- 12. Main Power Switch:** A control button that turns the device off, ensuring it stops operation when needed.

Package Contents

- 1. Fan Humidifier:** A compact fan humidifier designed to provide optimal air circulation and moisture for improved comfort.
- 2. Type-C Cable:** A high-quality Type-C cable for charging and connecting the device.

3. Qualified Certificate: A certificate ensuring that the product meets all necessary quality standards for safe and effective use.

Operation Guide

1. Fan Function:

- a.** Activation: Press the knob button once to turn on the fan at the first speed setting.
- b.** Speed Adjustment: Turn the knob clockwise to increase the fan speed, which will adjust from the first speed to the fifth speed. Turning the knob counterclockwise will decrease the fan speed, from the fifth speed down to the first.
- c.** Turning Off: Press the knob button again to turn off the fan, regardless of the current speed setting.

2. Spray Function:

- a.** Activation: Long-press the knob button to activate the spray function.
- b.** Deactivation: Long-press the knob button a second time to turn off the spray function. Note: This function only works when the fan is already running.

3. Night Light Function:

- a.** Activation: Double-click the knob button to turn on the LED night light (warm white).
- b.** Deactivation: Double-click the knob button a second time to turn off the LED night light.

4. Water Shortage Protection:

If the water level in the tank drops below the water level probe, indicating a shortage of water, all spray modes will automatically turn off to prevent damage.

5. Type-C Charging Port:

The Type-C charging port on the fan allows you to recharge the fan using a Type-C cable.

6. Power Off Switch:

When the power-off switch is set to the "ON" position, the fan is powered on. When set to the "OFF" position, the fan is powered off.

LED Display

- 1. Fan Speed Display:** When the fan is turned on to the first speed setting, a single white LED light will illuminate. As the fan speed increases, the corresponding LED light will turn on, reflecting the selected speed. If the fan speed is adjusted downward, the corresponding LED light will turn off accordingly.
- 2. Spray Indicator:** Once the spray function is activated, the spray symbol on the display will remain illuminated, indicating that the spray is in operation.
- 3. Power Display:** The power display will show the current charge level as a percentage, ranging from %0 to %100. As the product is being charged or used, the display will dynamically update. Once fully charged, the display will show 100%.
- 4. Water Shortage Warning:** If the water level in the tank falls below the designated minimum level, indicated by the water level sensor, the display will blink three times to alert you. Following this, the spray function will automatically turn off to prevent operation without sufficient water.

Battery Usage Guidelines

- 1. Usage Time Per Speed Setting:**
 - a. 1st Fan Speed with Spray Function:** Provides up to 2.5 hours of usage.
 - b. 2nd Fan Speed with Spray Function:** Provides up to 2 hours of usage.
 - c. 3rd Fan Speed with Spray Function:** Provides up to 1.6 hours of usage.
 - d. 4th Fan Speed with Spray Function:** Provides up to 1.4 hours of usage.
 - e. 5th Fan Speed with Spray Function:** Provides up to 1 hour of usage.

The fan can also be used independently, but the spray function will not be active.

2. Initial Charging:

Please ensure the product is charged for at least 3 hours before initial use to ensure optimal battery performance.

3. Charging Frequency:

It is recommended to charge the product at least once every 3 months, even when not in use, to prevent battery damage and ensure it remains functional.

4. Long-Term Storage:

When storing the product for an extended period, ensure it is kept in a low-humidity environment and at room temperature. This will help prevent potential damage to the product due to environmental factors.

Water Tank Maintenance Guide

1. Remove the Water Tank Cover: Open the water tank compartment by lifting the cover down to access the water tank.

2. Add Water to the Water Tank: Pour the required amount of water into the water tank. Ensure it is filled to the recommended level.

3. Install the Water Tank Cover: Securely close the water tank compartment by placing the cover back in position.

4. Activate the Product: The unit will begin to operate after pressing the rotary button.

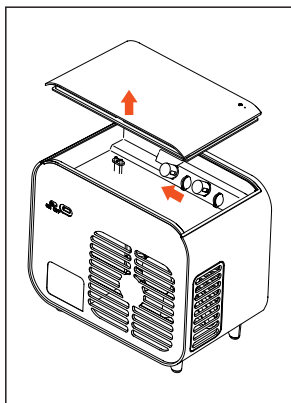

1

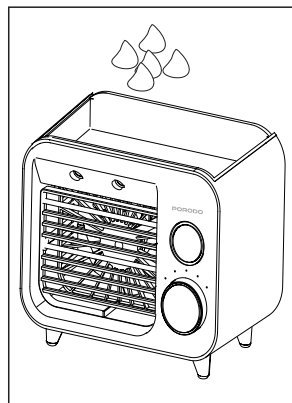

2

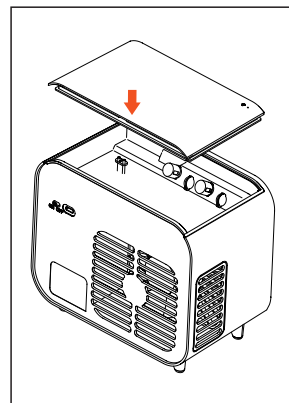

3

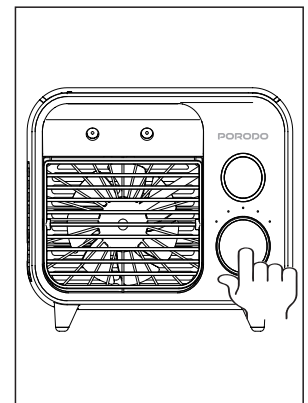

4

Safety Precautions

1. Ensure that the product is filled with water before use. The humidifying function cannot be used when the tank is empty.
2. Do not add essential oils, perfumes, or any chemical or medicinal substances to the water, as these could block the atomizer plate.
3. The product is equipped with a water level detection system that prevents it from spraying when the tank is empty. Please fill the tank up to the maximum water level line before use and activate the spray function.
4. Avoid washing the product directly with water, especially in a manner that involves spraying or splashing, when performing cleaning. When cleaning, avoid directly spraying water into the device. Use a damp cloth to wipe the surface and gently clean the water tank.
5. The product should not be used by children under the age of 6 without adult supervision.
6. If the product has not been used for 1-2 days, clean the water tank thoroughly and refill it with water before use.
7. Do not soak the cotton filter in water for extended periods if the humidifier has not been in use, as this may result in unpleasant odors.
8. Always plug the fan into a properly grounded socket. Do not use damaged cords or plugs.
9. When adjusting the knob control, ensure your hands are dry to avoid electrical hazards.
10. Never leave the device running unattended for long periods, especially when placed near flammable materials.
11. Place the air cooler on a flat, stable surface to prevent tipping or spilling. Keep it away from the edges to avoid accidents.
12. Never puncture or attempt to repair the unit yourself. Do not disassemble any internal components, as this may cause damage or void the warranty. If the fan is damaged or malfunctioning, contact an authorized service center for repairs. Attempting to repair or open the device could result in electrical hazards, leakage, or other safety risks.

Disposal

This product must not be disposed of as unsorted household waste. It is important to separate such waste for proper treatment and recycling, in compliance with local waste management regulations.

Warranty

Products that you buy directly from our **Porodo** website or shop come with a 24-month warranty.

When you buy **Porodo** products from any of our approved sellers, you only get a 12-month warranty. If you want to extend this warranty, go to our website at **porodo.net/warranty** and fill out the form with your information. Don't forget to upload a picture of the product too. After we've checked and accepted your request, we'll send you an email to confirm that your product's warranty has been extended.

For more info, please check:
porodo.net/warranty

Contact Us

If you have any questions about this Privacy Policy, please contact us at:
info@porodo.net

Website: **porodo.net**

Service Support: **support@porodo.net**

Instagram: **[porodo](https://www.instagram.com/porodo)**