

porodo



Porodo Lifestyle

2-In-1 Blender

with Insulated Hot and Cold Mug

PD-2N1BIM-WH

| | |
|--|---|
| Attention..... | 2 |
| Product Overview..... | 3 |
| Patented Straight Mouth Design..... | 4 |
| Features..... | 5 |
| Instructions for Use..... | 5 |
| Schematic View..... | 7 |
| Specifications..... | 7 |
| Safety and Environmental Protection..... | 8 |
| Cleaning and Maintenance..... | 8 |
| Troubleshooting..... | 9 |
| Warranty..... | 9 |
| Contact Us..... | 9 |

Thank you very much for your purchase. Before using the product, please carefully read this User Manual to guarantee correct usage and keep it secure for future reference. The cup is designed to extract every bit of nutrition from your fruit, allowing you to savor delicious and nutritious juice daily. Leveraging innovative technology, this cup enables you to extract more healthy juice and clean the product within one minute effortlessly. Its fully integrated design occupies minimal space and ensures an enhanced juicing experience.

Attention

- 1.** This product is powered by a DC motor using a lithium battery. For charging, you may use any smart phone USB charger. However, for optimal performance, we recommend using the USB power cord provided by our company. Ensure the product is fully charged for 2 hours or more before initial use. Prior to use, clean and dry all parts that will come into contact with food.
- 2.** The product should only be turned on after ensuring that it is closed and the blending blade has come to a complete stop.
- 3.** To clean the product, ensure that it is switched off and the silica gel cover at the charging port is securely in place. Do not immerse the motor unit in water to avoid damage to the electronic components.
- 4.** To maintain the integrity of the electronic components, avoid operating the juice function more than 5 times in quick succession. This helps prevent overheating and prolongs the product's lifespan.
- 5.** This product features an overload protection mechanism. Should the blending blade become obstructed by oversized food materials, the unit will power down automatically for safety, indicated by the red light remaining illuminated for 5 seconds. To resume operation, remove the obstructing food materials from the blade.
- 6.** It is important not to sterilize any components of the product with hot water or in a microwave oven, especially at temperatures exceeding 60°C, to prevent deformation and damage.
- 7.** Avoid placing the main components of the product in a dishwasher or any cleaning equipment where water could penetrate the motor unit.
- 8.** Refrain from using steel brush, abrasive cleaners, or corrosive liquids when cleaning the product to prevent damage.

9. This device is specifically designed as a juice machine and is not intended for mincing meat, grinding nuts, or processing bean products.
10. Never invert the product or attempt to operate it when the straw is inserted. Ensure the silicone seal at the charging port is secure before use.
11. If the product is not being monitored, always disconnect it from the power source prior to assembling, disassembling, or cleaning. Moreover, this product is not suitable for use by children without supervision.
12. Exercise caution when removing the mixing blade to prevent injury and damage to the mechanism.
13. Always ensure the power switch is off and the device is disconnected from the power source before replacing any accessories or coming into contact with any moving parts.
14. This product is intended solely for domestic use. Misuse of this product for professional or semi-professional purposes, or failure to operate it in accordance with the instructions provided in the user manual, will void the warranty. Speedfrog Technology will not assume any liability for losses resulting from such actions.

Product Overview

Equipped with a double vacuum stainless steel liner, this versatile device serves as both an efficient thermos and a convenient juice machine.

The temperature graph illustrates a consistent decrease over a 6-hour period, indicating sustained thermal retention capabilities (Figure 1). Additionally, the temperature chart shows stable cold temperature maintenance, dipping below freezing, over a 7-hour duration (Figure 2).

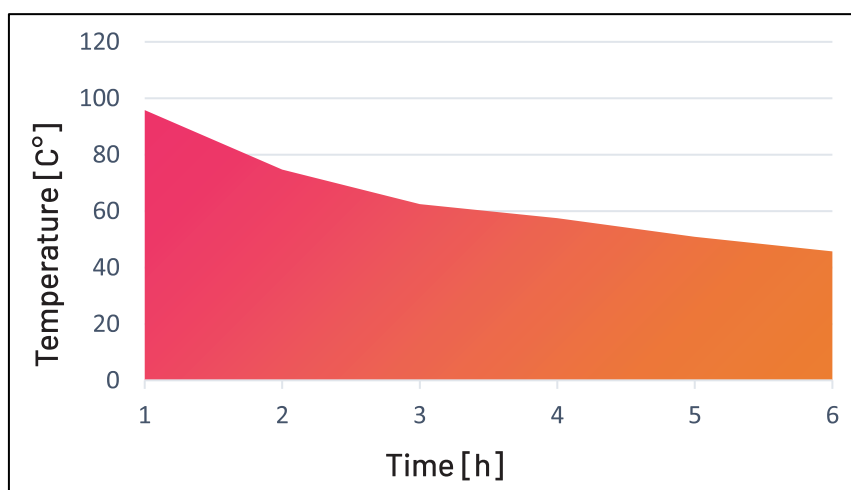

Figure 1. Insulation effect test

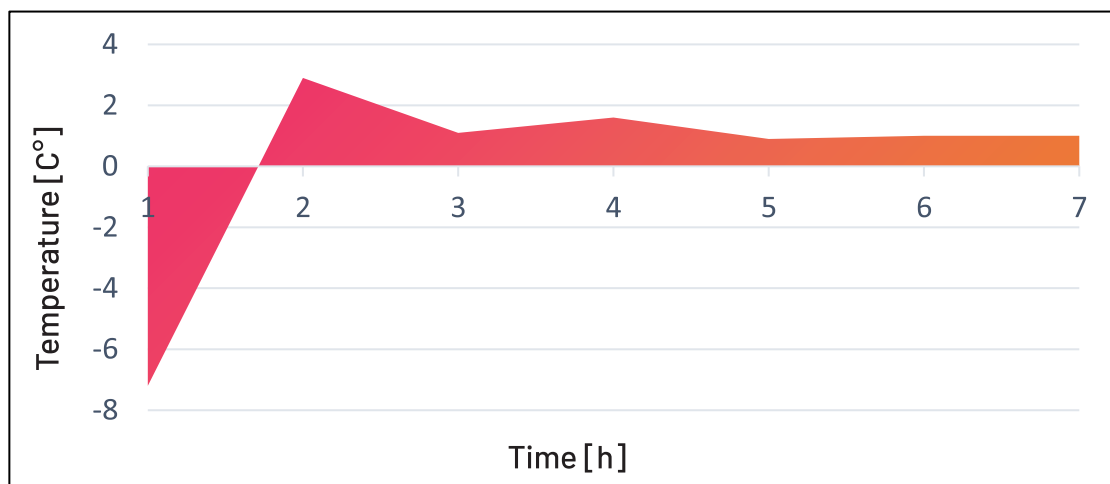

Figure 2. Cold retention effect test

This product features a liner made from food-grade, premium material that offers excellent corrosion resistance and high-temperature tolerance, ensuring safer and more reliable use. The inner liner is constructed from 316 stainless steel, while the outer liner is made from 304 stainless steel, combining durability with food safety standards.



Inside: 316 stainless steel

Outside: 304 stainless steel

Patented Straight Mouth Design

Upon finishing your juice, simply remove the lid for easy drinking, or you may choose to insert a straw. This design eliminates the need to tilt your head back to drink.

- A. Cup Sleeve:** Crafted from modified PP for enhanced temperature resistance.
- B. Inner Liner:** Constructed with an interior of 316 stainless steel and an exterior of 304 stainless steel, featuring double vacuum insulation.
- C. Lids:** Equipped with plastic straight drink lids for convenience.



Features

1. Boasts a 350ml capacity, suitable for a variety of beverages and smoothies.
2. Equipped with two high-power 1500mAh batteries for extended use and efficiency.
3. Features a high-powered 55W motor, capable of handling even the toughest blending tasks.
4. Comes with a waterproof Type-C charger, ensuring durability and compatibility with modern charging standards.
5. The double-layer vacuum stainless steel cup provides insulation and durability, with the inner cup crafted from 316 stainless steel and the outer cup from 304 stainless steel, known for its quality and food safety.
6. Designed to keep beverages warm or cool for about 6 hours, thanks to the double vacuum stainless steel liner. It effectively functions as both a thermos for hot and cold drinks and a versatile juice machine.
7. Constructed with food-grade materials that offer preferred corrosion resistance and high-temperature resilience, resulting in a more secure and worry-free use.
8. Features a direct drink design for convenience and ease of use.
9. Includes the option to drink with a straw, providing an alternative method for consumption that is both hygienic and practical.
10. The net weight of the blender is a mere 0.58 kg, making it portable and easy to carry.

Instructions for Use

- a. Charge the device fully before the first use and clean all parts that will come into contact with food. Notice the flashing light when the device is in operation.

b. Prepare the fruit by washing it and cutting it into small pieces (approximately 1.5 cm x 1.5 cm). Be sure to remove any seeds, hard materials, thick skin, or shells.

c. Load the fruit into the cup, ensuring it does not exceed %60 of the cup's maximum capacity. Then, add water up to the maximum fill line. When the main engine is securely attached to the cup and the light flashes, it indicates that the engine is properly locked in place.

Note: The combined volume of fruit and water should not exceed the maximum indicated level on the cup to prevent spillage.

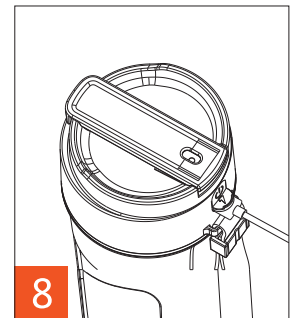
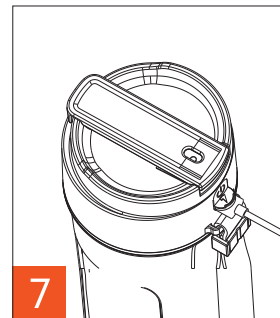
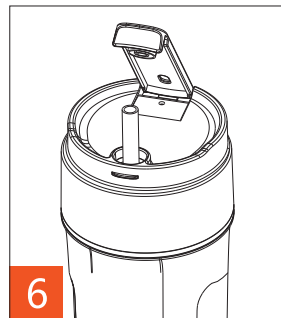
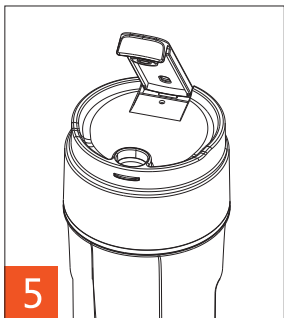
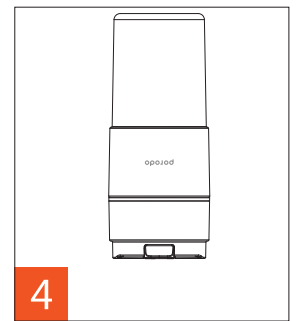
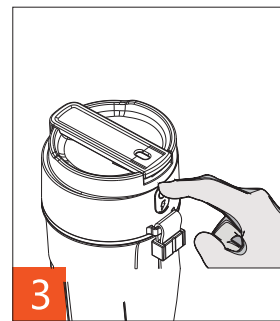
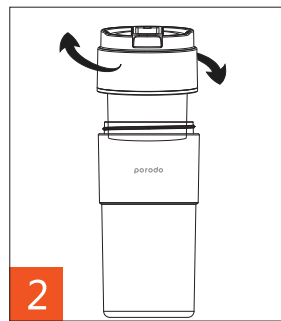
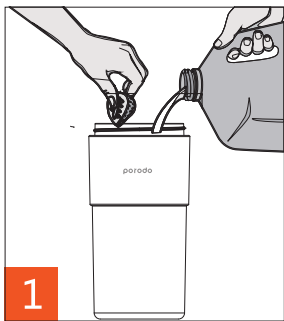

1. Add Ingredients: Place your ingredients into the blender cup.

2. Assemble Main Engine: Attach the main engine to the cup.

3. Power On: Double-click the start button to turn on the unit.

4. Invert Device: Turn the product upside down to blend.

5. Drink Directly: You can drink straight from the cup.

6. Use Straw: Insert a straw for direct drinking if preferred.

7. Low Battery Indicator: A flashing red light indicates low battery.

8. Charged Indicator: A bright, constant white light signifies the unit is fully charged.

Schematic View

- 1. The flip cover
- 2. Host
- 3. Motor bracket
- 4. Handle rope
- 5. Sealing ring of main engine
- 6. Mixing blade
- 7. Stainless steel vacuum mug
- 8. Vacuum lid

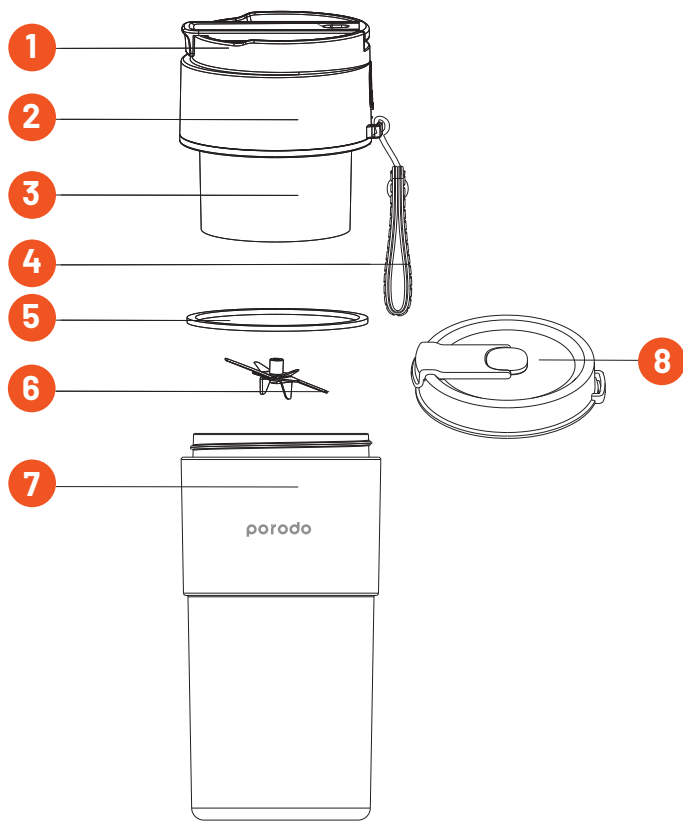

Specifications

| | |
|----------------------|---------------------------------|
| Product Name | Porodo Lifestyle 2 in 1 Blender |
| SKU | PD-2N1BIM-WH |
| Mixing Capacity | 350ml |
| Size | 92×86×209mm |
| Net Weight | 0.58kg |
| Battery | 1500mAh *2 |
| Voltage | DC 7.4V |
| Charging Voltage | DC 5V |
| Charging Current | 1A |
| Power | 55W |
| Charging Port | USB Type-C |
| Charging Time | 3.5h |
| RPM | 18000 |
| Over-load Protection | Supported |

Safety and Environmental Protection

1. To open the host unit, please ensure the power is off and use the appropriate professional tools. Be mindful of the blades and wear protective gloves during the operation to prevent injury.

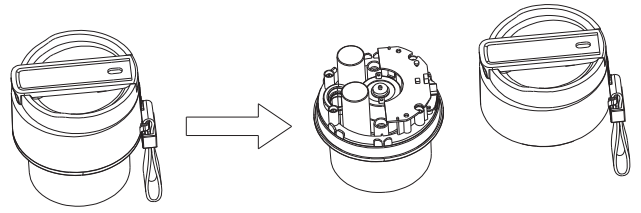

2. When disposing of a used battery, remove it carefully and place the spent battery in the appropriate waste disposal unit designated for batteries to be handled by professional waste management personnel.

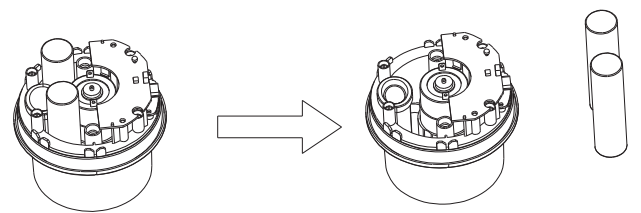

3. Kindly adhere to local recycling regulations and ensure that discarded electrical appliances are placed in the designated recycling bin.



Cleaning and Maintenance

- 1.** Do not place the motor base under running water. Clean the exterior with a damp cloth.
- 2.** Do not place the motor base in the dishwasher.
- 3.** Rinse the removable parts under running water. Use a cleaning brush for thorough cleaning.

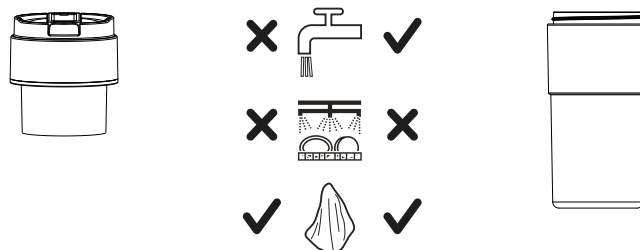

Troubleshooting

| Issue | Cause | Solution |
|--|--|---|
| Unable to start or the device stops with red light flashing. | Insufficient electricity. | Please ensure the device is charged promptly. |
| The device shuts down during use and the red light remains on for 5 seconds. | The motor is locked due to jammed ingredients | Clear any blockage by removing the stuck ingredients and then restart the device. |
| Water leakage is observed | The silicone gel ring is not correctly positioned, or the cup body is not securely fastened. | Adjust the silicone rubber ring to its proper place and ensure the main engine is tightly secured to the cup. |

Warranty

Products that you buy directly from our **Porodo** website or shop come with a 24-month warranty.

When you buy **Porodo** products from any of our approved sellers, you only get a 12-month warranty. If you want to extend this warranty, go to our website at **porodo.net/warranty** and fill out the form with your information. Don't forget to upload a picture of the product too. After we've checked and accepted your request, we'll send you an email to confirm that your product's warranty has been extended.

For more info, please check:
porodo.net/warranty

Contact Us

If you have any questions about this Privacy Policy, please contact us at:
info@porodo.net

Website: **porodo.net**

Service Support: **support@porodo.net**

Instagram: **[porodo](https://www.instagram.com/porodo)**