

LèPRESSO



LePresso

QUICKBREW Mini Espresso Maker

SKU: LPRJCM02SL

Table of Contents

Preface	2
Precautions	2
Specifications	4
Operation Instructions	5
Error Code Guide	6
Maintenance	6
Troubleshooting	7
Disposal	8
Warranty	9
Contact Us	9

Preface





Thank you for choosing our product. Please read this manual thoroughly before use to ensure proper operation and to fully enjoy its exceptional performance. We're confident it will bring convenience and comfort to your daily life. Keep this manual for future reference.

Precautions

To ensure the safe use of this product and prevent harm or damage, please observe the following safety precautions. Failure to follow safety warnings and improper use may result in accidents.

Caution: This product is not intended for use by unattended children or individuals who cannot express themselves clearly.

Icon Guide

	Prohibition: Items associated with hazards
	Warning: Items associated with minor injuries or losses
	Items that may cause serious harm or injuries.
	Items that may result in minor injuries or damages.



- ⊘ This product is for household use only. It should not be used for commercial purposes.
- ⊘ This product is not suitable for children or individuals who cannot express themselves clearly.
- ⊘ Limit continuous use to no more than 20 minutes.
- ⊘ Do not move the product while in operation to prevent accidental injuries.
- ⊘ The power cord and adapter should not be hung on sharp objects or attached to movable items.
- ⊘ Do not place this product on sloped or unstable surfaces. Ensure the product remains horizontal during use, especially in vehicles.
- ⌚ Before using the coffee maker, verify that the power cord is intact and properly connected to the socket.
- ⌚ Always ensure the power is turned off before cleaning or disassembling the product.
- ⚠ Only use attachments or fittings that are provided with the product to prevent fire hazards and personal injury.
- ⚠ Never leave the product unattended while in use.
- ⚠ If the machine is wet, ensure it is thoroughly dried with a cloth before use.
- ⚠ The product is designed for heating water only. Do not use it to heat any other liquids or solids.
- ⚠ Do not exceed 150ml of water when making coffee.
- ⚠ The coffee maker's cup may release high-temperature steam. Please exercise caution when using it.
- ⚠ Although the machine can keep the coffee warm, it is not suitable for use as a travel coffee mug.
- ⚠ When the coffee maker is in dry-boiling protection mode, allow the machine to cool for 5 minutes before using it again.

- ⚠ We recommend using the coffee maker between 14°F and 104°F.
- ⚠ Exercise extra caution when using the coffee maker while driving, especially on bumpy roads, as it may cause the coffee maker to tip over.
- ⚠ After long-term use, scale may form at the bottom of the boiling cup, resembling rust. This is caused by water (not pure water). Please clean it using citric acid.
- ⚠ Do not rinse the boiling cup directly with water or immerse it in water.
- ⚠ This product is not suitable for children or individuals who cannot express themselves clearly.
- ⚠ Do not use or store the coffee maker in the following locations:
Areas with high temperature and humidity, Areas near water, Areas near fireworks, and Locations with strong electromagnetic fields.

Specifications

Model	LPRJCM02SL
Rated Voltage	12V/220V
Rated Power	100W/180W
Capacity	130-150mL
Brewing Time	5-8 Minutes
Material	304 Stainless Steel
Product Size	75 x 75 x220mm
Product Weight	716g

Operation Instructions

1. When the power is on, you will hear a "beep" sound, and the digital panel will display "--" with the switch light flashing. This indicates that the machine is in standby mode.
2. Press the button()to start making coffee. The digital panel will display the current temperature. Press the button()again to stop the machine, and the panel will show "--.".
3. The coffee machine operates automatically. When it stops, it will emit 3 "beep" sounds, signaling that the coffee is ready. The brewing time is approximately 10-5 minutes.
4. Fill the heating cup with cold water (figure 1). Note that the water should not exceed the maximum scale.
5. Place the funnel into the heating cup and fill it with ground coffee (do not tamp), as shown in figure 2.
6. Screw the upper cup back on and connect to the power, as shown in figure 3.
7. Press the button()to start brewing coffee. After 10-5 minutes, the coffee will be ready, as shown in figure 4.

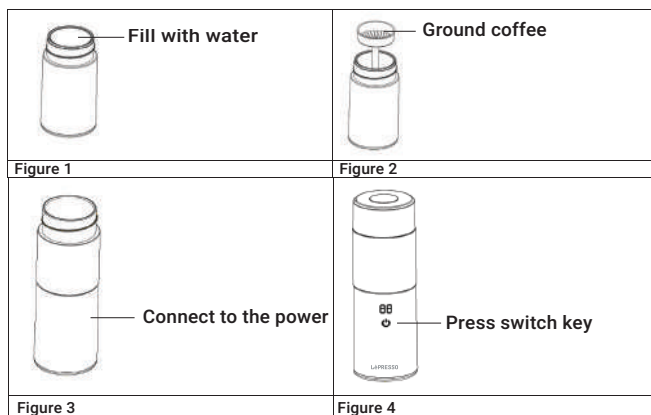

Error Code Guide

If you use the coffee machine incorrectly, the digital panel will display error codes.

Error Code: E0

Possible cause: Dry-boiling protection

Solution: The boiling cup is lacking water. Please unplug the power cord and add some water.

Error Code: E1

Possible cause: The input power voltage is low

Solution: Use suitable input power.

Error Code: E2

Possible cause: The input power voltage is high

Solution: Use suitable input power.

Error Code: EE

Possible cause: Temperature sensor fault

Solution: Please contact a service center.

Maintenance

- 1.** Before cleaning and maintaining the product, ensure the power is turned off. Do not rinse the boiling cup directly with water or immerse it in water. Use a soft, damp cloth to clean the surface of the boiling cup.
- 2.** The upper cup and lid can be washed with running water or in a dishwasher.
- 3.** After extended use, scale may form at the bottom of the boiling cup. Clean it with an acid solution using the following steps:

- 3.1** Fill the boiling cup with vinegar or citric acid (about 3/1 of the cup).
- 3.2** Let it sit for 2 to 3 hours, then clean with a soft brush.
- 3.3** Follow this cleaning method regularly, depending on usage.

Troubleshooting

Problem: Power on but not working

Reason: Fuse failure (car power cord)

Solution: Replace the broken fuse with a new one.

Problem: Power on but not working

Reason: The power cable is broken

Solution: Use a new power cable or contact a service center.

Problem: Make less coffee

Reason: Over-tamping the ground coffee

Solution: Do not tamp the ground coffee.

Problem: Make less coffee

Reason: The coffee maker leaks

Solution: Tighten the upper cup and the boiling cup.

Problem: Make less coffee

Reason: The sealing ring is broken

Solution: Replace the sealing ring.

Problem: Coffee maker leaks

Reason: The upper cup and boiling cup didn't screw well

Solution: Tighten the upper cup and the boiling cup.

Problem: Coffee maker leaks

Reason: Too much water added

Solution: Do not exceed 150ml of water.

Disposal

This product must not be disposed of as unsorted household waste. It is important to separate such waste for proper treatment and recycling, in compliance with local waste management regulations.



Warranty

Products that you buy directly from our **LePresso** website or shop come with a 24-month warranty.

The 24-month warranty applies to products purchased directly from our **LePresso** website or store. If **LePresso** products are bought from any of our verified retailers, then the product is eligible for only a 12-month warranty. To extend your product's warranty, visit our website <https://www.lepresso.com/warranty> and fill in your details in the provided form along with an uploaded picture of the product to process your request. Once approved, you will receive a confirmation email of the extended product warranty. Upload the required information within 48 hours of purchase to be eligible for a 24-month warranty period.

For more info, please check:

<https://www.lepresso.com/warranty>

Contact Us

If you have any questions or concerns about our Shipping and Returns Policy, please contact us at: info@lepresso.com

Website: <https://www.lepresso.com/>

Instagram: [lepresso_official](#)