



Green Lion

INSTANT ICE MATE Ice Maker

SKU: GNICEC7MKEGY

Model No: GXC7

Table of Contents

Important Safety Instructions	2
Product Overview	3
Instructions for Use	5
Troubleshooting	7
Specifications	8
Disposal	8
Warranty	9
Contact Us	9

Thank you for purchasing this product. To ensure optimal use and safety, please read this manual carefully before using the appliance and keep it for future reference.

Important Safety Instructions

1. Only use drinkable water, such as purified water, in the appliance. Avoid using tap water for extended periods. Cola, sugary water, and tea should never be used to make ice.
2. Always follow basic safety precautions when operating electrical components to reduce the risk of fire, electric shock, and injury. Be sure to read the entire user manual thoroughly before using any electrical components.
3. The appliance is suitable for use by children aged 8 years and older, as well as individuals with reduced physical, sensory, or mental abilities, provided they are supervised or given proper instructions regarding safe usage. Children should not play with the appliance, and cleaning or maintenance should never be performed by children without adult supervision.
4. This appliance is designed for indoor use only. Do not use it outdoors, and ensure it is protected from rain. The ice maker should be placed in a well-ventilated area, away from walls or other obstacles. It should not be exposed to direct sunlight, and there should be at least a 300mm clearance around the unit to allow for proper heat dissipation.
5. The refrigeration system contains high-pressure refrigerants. Take special care during installation and handling, and ensure that installation and maintenance are carried out by professionals or the manufacturer. Dispose of scrap materials through the designated recycling channels.
6. The ice maker contains flammable insulation materials. Keep the appliance away from open flames and sources of fire. Dispose of any scrap materials in accordance with proper recycling procedures.

7. Before using the ice maker for the first time, thoroughly clean the appliance. However, avoid submerging the appliance directly in water when cleaning.

8. If the appliance will not be used for an extended period, drain the water from the tank, dry it thoroughly, and store the appliance in a dry, well-ventilated space.

Product Overview

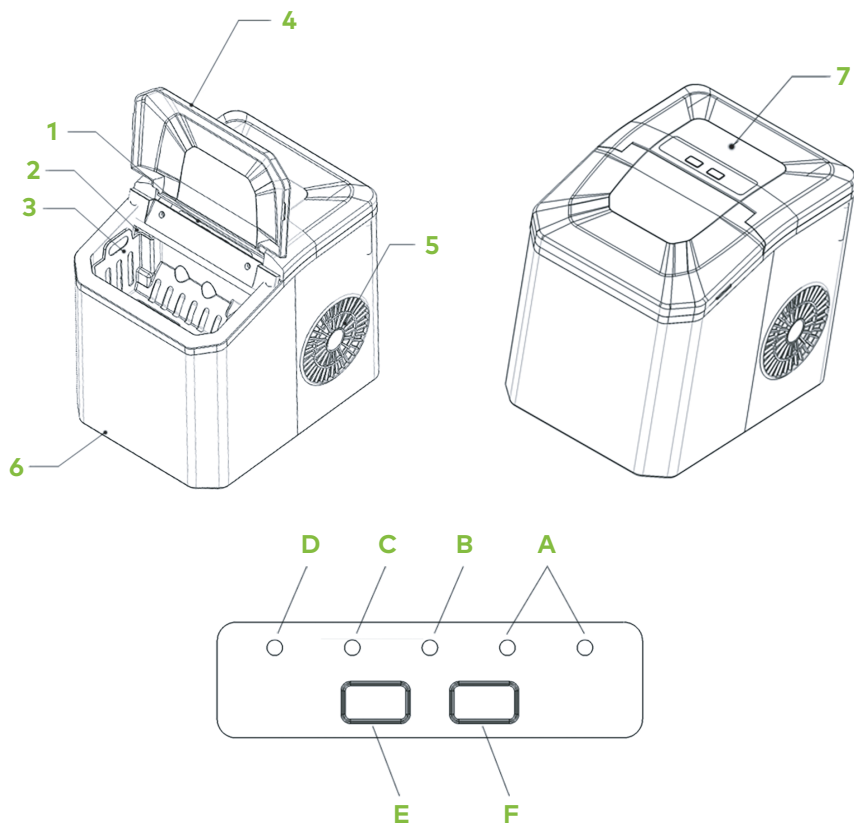

- 1. Pushing Ice Board:** Used to help remove ice from the machine.
- 2. Infrared Ice Full Sensor:** When the ice in the storage reaches a level detectable by infrared radiation, the display panel will show a "Full" indication, and the corresponding light will turn on.
- 3. Ice Basket:** Designed for storing and transporting ice cubes.
- 4. Upper Cover:** Features a transparent mirror window, allowing easy visibility of the internal ice volume.
- 5. Air Outlet:** Both sides of the appliance feature fan vents for proper airflow. Ensure there is a minimum clearance of 300mm from any surrounding objects for optimal ventilation.
- 6. Drain Plug:** Located at the bottom of the machine, this plug allows you to drain water from the tank. Simply pull it down to release the water.
- 7. Control Panel**
 - A. Ice Size Selection:** Choose between small or large ice cubes.
 - B. Power Indicator:** Displays the status of the appliance.
 - C. Ice Full Indicator:** Shows when the ice storage is full.
 - D. Water Shortage Indicator:** Alerts you when the water tank needs refilling.
 - E. Power On/Off Button:** Used to turn the appliance on or off.
 - F. Ice Size Function Selection Button:** Allows you to select the desired ice size.

Main Product

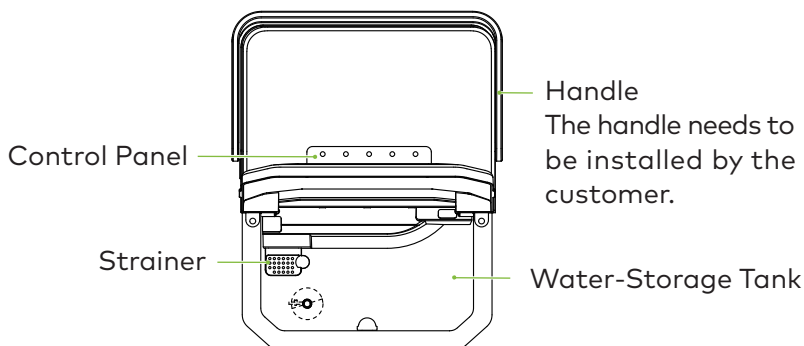

[Handle Installation]

Align the handle with the mounting holes on the ice maker and rotate it to secure the handle in place.

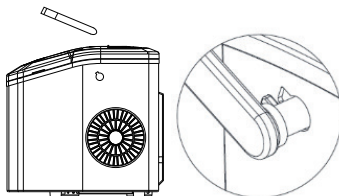

[Ice Basket Installation]

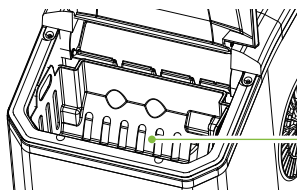

Ensure that the supplied ice basket is installed correctly before use.

Ice Basket

Accessories



● Ice Scraper

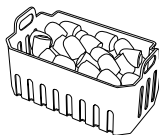

● Ice Basket

Instructions for Use

1. Open the upper cover, remove the ice basket, and fill the water tank with water, ensuring that you do not exceed the maximum water level. Once filled, replace the ice basket, close the upper cover, and press the "on/off" button on the control panel to power on the machine and begin ice production.

2. Once the machine is on, press the "Select" button on the control panel to choose between large or small ice cubes. Each ice-making cycle typically lasts between 8 and 10 minutes, depending on the size of the ice being produced and the ambient temperature. Both the water and

room temperature can affect the size of the ice cubes.

3. In standby mode, press and hold the "on/off" button for 3 seconds. The "Ice Full" and power lights will flash alternately, indicating that the automatic cleaning function has been activated.

4. The cleaning process lasts for 20 minutes. To stop the cleaning process prematurely, press the "on/off" button for 1 second. Once the cleaning is complete, the power light will flash. Afterward, drain the water through the bottom drain plug and press the "on/off" button to switch to other modes.

Note: Ensure that there is sufficient water in the water tank during the cleaning process.

5. Additional Features

5.1 When the "Ice Full" light is illuminated, the ice-making function will automatically stop. To resume, ensure that the ice cubes are positioned below the infrared detection sensor.

5.2 When the "Water Shortage" light appears, refill the water tank, then press the "on/off" button again to resume operation.

Suggestion: It is recommended to use the automatic cleaning function once every 1-2 days and replace the water to maintain optimal performance.



Problem	Possible Cause	Solution
The "ADD WATER" light is on.	Lack of water.	Refill the water and restart the machine.
	The filter in the water cabinet is jammed.	Clean the cabinet.
The "ICE FULL" light is on.	Too much ice.	Remove some ice.
	The sensor is affected by strong sunlight.	Place the machine in a location without direct sunlight.
The "ICE FULL" light is flashing.	The ice shovel board is jammed.	Remove the jammed ice.
Ice is stuck.	The ice-making cycle is too long.	Stop the machine. After the ice melts, restart the machine.
	The water temperature is too low.	It is better to use water at 8-32°C.
Ice making goes well, but no ice is produced.	The ambient temperature is too high.	Use the machine in environments under 32°C.
	The water temperature is too high.	Add some cold water.
	The cooling system is jammed.	Contact the service center.

Specifications

Model No.	GXC7
Material	Stainless Steel + PP
Rated Voltage	230V
Rated Frequency	50Hz
Rated Power	130W
Rated Current	0.8A
Water Tank	1.3L
Ice Basket	0.5 kg
Climate Type	SN/N/ST/T
Ice Type	Bullet Ice
Ice Output	9 pcs/8-10 min
Ice Production	10 kg/24H
Refrigerant	R600a/20g
Power Plug	BS Plug 1.2m
Product Weight	6.36 kg
Product Dimensions	225*294*285 mm

Disposal

This product must not be disposed of as unsorted household waste. It is important to separate such waste for proper treatment and recycling, in compliance with local waste management regulations.

Warranty

Products that you buy directly from our **Green Lion** website or shop come with a 24-month warranty.

When you buy **Green Lion** products from any of our approved sellers, you only get a 12-month warranty. If you want to extend this warranty, go to our website at **<https://www.greenlion.net/warranty>** and fill out the form with your information. Don't forget to upload a picture of the product too. After we've checked and accepted your request, we'll send you an email to confirm that your product's warranty has been extended.

For more info, please check:

<https://www.greenlion.net/warranty>

Contact Us

If you have any questions about this Privacy Policy, please contact us at:

Website: **<https://www.greenlion.net/>**

Sales: **sales@greenlion.net**

Service Support: **Support@greenlion.net**

Telegram: **[@greenlion_global](https://t.me/greenlion_global)**

Instagram: **[@greenlion_global](https://www.instagram.com/greenlion_global)**