

porodo



**Porodo**

**Lifestyle Protein Shaker**

550ml 2000mAh

SKU: PD-LFPSKR

# Table of Contents

Features.....	2
Package Contents.....	2
Power Base Components.....	2
Instructions for Use.....	3
Storage Method.....	3
Instructions for Stirring.....	3
Cleaning Instructions.....	4
Performance Details.....	4
Troubleshooting.....	5
Precautions.....	6
Specifications.....	7
Food Exposure Standards.....	7
Warranty.....	8
Contact Us.....	8

## Features

1. Delivers high rotations per minute up to 7500RPM for a smoother, lump-free texture in beverages, quickly and efficiently.
2. Incorporates a Type-C charging port for rapid and efficient battery charging.
3. Utilizes food-safe and high-grade materials designed for durability and longevity.

## Package Contents

1. Bottle Lid (Including the lid of drinking spout) ×1
2. Bottle Body (Including 1 piece stirring propeller) ×1
3. Handle Rope ×1
4. Detachable Power Base ×1
5. USB Type-C Cable ×1
6. Adapter ×1

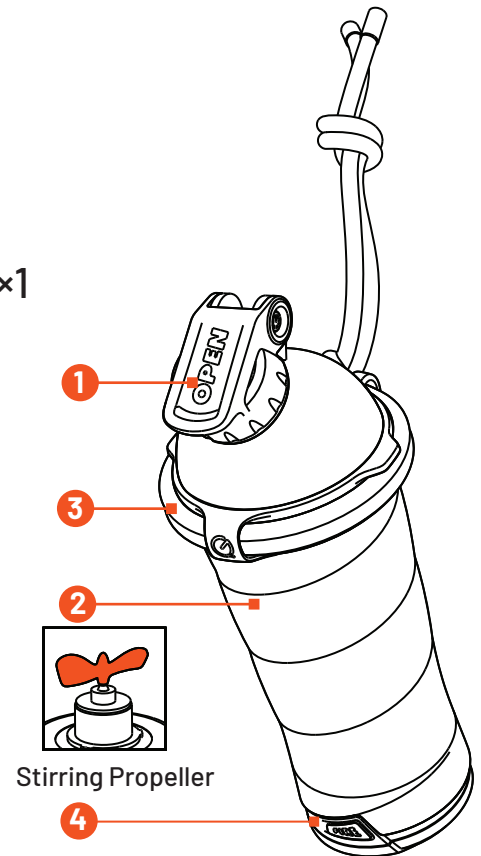

## Power Base Components

### a. FIRE – Start Button

1. Tap the FIRE button to begin a single operation for 60 seconds.
2. Double-tap this button to initiate a clean cycle for 60 seconds.
3. Press and hold the FIRE button to check the battery level.

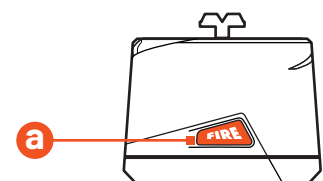

### b. Intelligent Dynamic Mood Lights

1. Colors change to reflect mood lighting.
2. Displays working status and battery charge level.

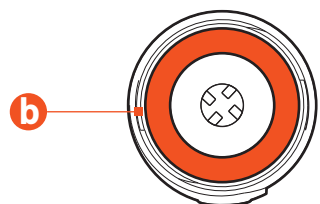

### c. USB-C Charging Port

Supports bidirectional charging at 5V/2A.

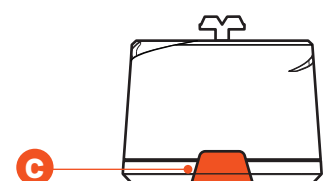

## Instructions for Use

### **A. Start-up**

1. Press the FIRE button once to commence stirring.
2. Double-press the FIRE button to initiate cleaning.

### **B. Stop**

1. When stirring or cleaning, the device will halt automatically after 60 seconds.
2. To manually stop the operating device, press the FIRE button during activity.

### **C. Mood Lights**

The apex of the power base is outfitted with a complete circle of integrated light rings in purple.

### **D. Battery Level Display**

1. When the product stops working, long-press the FIRE button to view the battery level.
2. A full circle of white light at the top of the base indicates the battery level in six equal parts.
3. A slow flashing red light indicates low battery or no power.

### **E. Charging**

1. During charging, the entire circle of blue light flashes slowly.
2. The blue light remains steady when the product is fully charged.

## Storage Method

Ensure the product is clean and dry before storing it in a dry, well-ventilated area away from direct sunlight.

## Instructions for Stirring

1. Pour your desired liquid into the bottle. The recommended liquid volume is 250 to 500 ml (9oz~18.5oz)



2. Add protein powder or other powders to the liquid in the shaker bottle. The recommended maximum amount is 90g/3.2oz.
3. Turn on the stirrer: Press the FIRE button to activate the stirring function, allowing it to stir for a full 60 seconds.
4. Once stirring is complete, tighten the lid before enjoying your drink.

## **Cleaning Instructions**

### **A. Cleaning the Bottle**

1. Use a neutral detergent or clean water to wash the shaker bottle.
2. Fill the shaker bottle with water.
3. Double-press the FIRE button to activate the stirring function.
4. The stirring propeller will rotate forward and backward three times, each time for 20 seconds, to thoroughly clean the bottle.

### **B. Power Base**

1. Detaching the Base: Hold the bottle with your left hand and the base with your right hand, then rotate the base to the left to remove it.
2. Be cautious when detaching the base to avoid dislodging the gear and silicone located at the top, as it may impact its performance.
3. Ensure the gears remain dry after cleaning to maintain optimal stirring efficiency.
4. Reattach the base securely to the bottom of the bottle until it clicks into place, ensuring its functionality isn't compromised.
5. In the event of accidental submersion in water, dry the surface of the base first, then use a blow dryer to dry the interior. Under normal circumstances, the motor will continue to operate.

## **Performance Details**

1. Battery life depends largely on usage frequency. With a stirring duration of 60 seconds twice a day, a fully charged battery can last approximately two weeks.
2. Charging is facilitated via USB Type-C cable, with a maximum charging current of 5V/2A.
3. A complete recharge from empty battery status takes approximately 2 hours.
4. For safety reasons, refrain from operating the motor while charging.

5. The LED mood light will flash red when the battery is low, indicating the need for recharging.
6. Parameters for reverse charging electronic devices: maximum current 2A, maximum power 10W.
7. This product is designed for swiftly mixing powder and water and is not suitable for stirring solid and hard material like ice cubes.

## Troubleshooting

If you encounter any operational issues while using the product, please refer to the following troubleshooting steps. If resolving the issue proves difficult or if the product continues to underperform, disconnect the power supply immediately. It's recommended to seek assistance from professional technicians for repairs. Please refrain from attempting to disassemble or reassemble the product on your own.

Problem	Possible Cause
Stirring malfunction	<ol style="list-style-type: none"><li>a. Battery is charging.</li><li>b. Low power level.</li><li>c. Improper assembly of base and cup body.</li><li>d. Adding powder before liquid results in powder sedimentation which hinders the stirrer rotation.</li></ol>
Weak stirring power	<ol style="list-style-type: none"><li>a. Low power level.</li><li>b. Shake forcefully.</li><li>c. Improper assembly of base and cup body.</li><li>d. Adding powder before liquid results in powder sedimentation which hinders the stirrer rotation.</li></ol>
Inability to assemble base and cup	<ol style="list-style-type: none"><li>a. Foreign object lodged in the snap groove.</li><li>b. Misalignment of the snap groove.</li></ol>

## Precautions

- 1.** This product is only suitable for stirring of brewing nutritional products and other brewing beverages, please do not use for other purposes.
- 2.** Do not heat this bottle in a high-temperature environment such as microwave oven or disinfection cabinet. Do not freeze this product.
- 3.** Do not filled with dry ice, carbonated drinks and other liquids that are prone to high pressure. Do not filled with corrosive liquids such as strong acid and alkali to avoid corrosion of the container.
- 4.** Do not leave dairy products or baby food etc. in the bottle for a long time.
- 5.** Please avoid contact with this product by infants and young children to avoid damage or liquid spillage.
- 6.** If it is filled with hot drinks, please do not drink it directly to avoid scalds.
- 7.** Avoid striking the bottle, base, and other components to prevent deformation, damage, or impairment of functionality.
- 8.** Refrain from prolonged submersion of the bottle in liquid to prevent malfunction.
- 9.** Do not utilize metal cloths, steel wool, or similar abrasive cleaning tools on this product, as they may cause scratches and mar its appearance.
- 10.** Ensure the shaker bottle is turned off before cleaning.
- 11.** The base should not be washed with water, soaked, or placed in a dishwasher.
- 12.** Remove the base before cleaning the bottle body to prevent any risk of short circuiting.
- 13.** Avoid using steel wool, abrasive cleaners, or corrosive substances such as gasoline, alcohol, or acetone on this product.

## Specifications

Product capacity	550mL/18.5oz
Motor speed	7500 ± 10 % rpm
Product size	267.7x116x104.5mm
Rated power	11W
Battery capacity	2000mAh
Product weight	439g
Duration of use	About 2 weeks (Stir 2 times a day)
Charging power	5V/2A
Body material	ABS+PP+Tritan+Silicone
Charging time	2 hours
Execution standards	GB4806.6-2016, GB4806.11-2016
Reverse charging	5V/2A

## Food Exposure Standards

Component Name	Material	Execution standards
Plastics	ABS+PP+Tritan	GB4806.6-2016
Water sealing ring	Silicone	GB4806.11-2016

## **Warranty**

Products that you buy directly from our **Porodo** website or shop come with a 24-month warranty.

When you buy **Porodo** products from any of our approved sellers, you only get a 12-month warranty. If you want to extend this warranty, go to our website at **<https://porodo.net/warranty>** and fill out the form with your information. Don't forget to upload a picture of the product too. After we've checked and accepted your request, we'll send you an email to confirm that your product's warranty has been extended.

For more info, please check:

**<https://www.porodo.net/warranty>**

## **Contact Us**

If you have any questions about this Privacy Policy, please contact us at:

**[info@porodo.net](mailto:info@porodo.net)**

Website: **[porodo.net](https://porodo.net)**

Service Support: **[support@porodo.net](mailto:support@porodo.net)**

Instagram: **[porodo](https://www.instagram.com/porodo)**