

porodo



Porodo

LifeStyle Foldable Foot Massager

SKU: PD-LFFMG-GY

Table of Contents

Features.....	2
Safety Instructions.....	2
Operating Environment Safety.....	3
Warning.....	4
Important Notes.....	4
Usage Guidelines.....	5
Product Components.....	7
Product Maintenance.....	7
Troubleshooting.....	8
Specifications.....	9
Warranty.....	9
Contact Us.....	9

Thank you for selecting the Porodo LifeStyle Foldable Foot Massager. We strongly advise that you thoroughly read the user manual before employing this device. It is essential to pay attention to the safety precautions detailed within to ensure the correct operation and usage of this appliance. The manual provides you with instructions that are both secure and efficacious. For future reference, please retain these guidelines.

Features

1. Complete 360° envelopment with airbag massage technology.
2. Shiatsu kneading paired with advanced high-frequency foot oscillation technology.
3. 45° heated compression using carbon fiber elements for consistent, safe warmth.
4. Variable three-speed intensity control offering four distinct massage programs.
5. Detachable and machine-washable cloth cover for easy maintenance.

Safety Instructions

1. For the safe and proper usage of this product, it is imperative that you meticulously review the instruction manual prior to operation.
2. Individuals, including minors, with disabilities or mental health conditions, or those lacking the requisite experience and understanding, should refrain from using this product unless supervised or directed by a caretaker.
3. This product is not intended for playful use; parental vigilance is advised to prevent children from treating it as a toy.
4. Embedded within this product is a heating element. Please be aware that its surface can become extremely hot. Individuals who are sensitive to heat should exercise extreme caution.
5. In the event of any visible damage or wear to the power cord, it is essential to contact the manufacturer or a professional repair service for a replacement.
6. To avoid potential damage, keep the appliance away from sharp implements. Should any damage to the cloth cover or product be observed, cease usage immediately and return it to the distributor or a maintenance facility for servicing or replacement.

- 7.** Always disconnect this appliance from the power source post-use and before initiating any cleaning procedures.
- 8.** Avoid covering the appliance during use to prevent excessive heating that could result in appliance malfunction or damage.
- 9.** Discontinue use immediately if you experience any unusual discomfort while using the massager.
- 10.** Should any malfunctions arise, promptly contact the service center for examination and necessary repairs.
- 11.** Refrain from using parts or components that have not been approved by our manufacturer.
- 12.** Do not insert any objects into the slots of this product.
- 13.** Do not operate this appliance with damp or wet hands to prevent the risk of electric shock.
- 14.** Ensure that the control panel is kept dry and not exposed to any liquids.
- 15.** To safely disconnect, first cease all appliance functions and then remove the plug from the electrical outlet.
- 16.** This product is not designed for self-diagnosis or as a substitute for medical treatment. For medical conditions, consult a healthcare professional.

Operating Environment Safety

- 1.** Avoid operating this product in moisture-rich environments such as bathrooms or areas in close proximity to water to avert malfunctions that could result in personal injuries.
- 2.** Refrain from using this product in temperatures exceeding 40°C, as well as near electric heaters or stoves.
- 3.** Do not utilize the appliance in conditions where the temperature falls below 5°C, to prevent the lubricant from thickening, which may cause significant wear and reduce the lifespan of the unit.
- 4.** This appliance is not designed for outdoor use or for exposure to direct sunlight, as such conditions could damage its exterior finish.
- 5.** If the massager is transported from a cool to a warm setting, moisture may condense on the internal metal components, disrupting function or causing damage. It is recommended to allow the massager to cool down in a room at normal temperature for one hour before activation.

Warning

1. Individuals currently undergoing medical treatment or experiencing general illnesses should seek medical advice before using this product.
2. Those with a diagnosis of hypertension, heart disease, cerebral arteriosclerosis, or cerebral thrombosis are advised to consult their healthcare provider prior to use.
3. Consultation with a physician is recommended for individuals diagnosed with malignant tumors.
4. Women who are pregnant or menstruating should discuss the use of this product with their doctor.
5. Persons suffering from osteoporosis should seek medical counsel before utilizing this appliance.
6. Individuals with a pacemaker or other implanted medical devices should consult with their healthcare practitioner before use.
7. Those experiencing any form of acute illness should consult a doctor before using this product.

Important Notes

1. Avoid falling asleep while operating this appliance.
2. Refrain from using this appliance if under the influence of alcohol or if you are not in good health.
3. Limit the use of the massager to no more than 30 minutes at a time and refrain from heating your feet for over two hours in a single session.
4. Do not use the appliance if its cloth cover shows signs of wear.
5. For best results and to prevent adverse reactions, do not use this appliance within one hour before or after consuming a meal.
6. If the massager is transferred from a cool environment to one that is warmer, condensation may form on the internal components, potentially affecting operation or causing motor damage. To prevent this, it is advised to let the massager adjust to a normal room temperature for one hour before turning it on.

Usage Guidelines

1. Operating Buttons



Power Button:

Activate the massager by pressing the power button on the control panel once. The device will commence operation automatically.



Heating Button:

Toggle the heating function on or off by pressing the heating button.



Intensity Button:

Select the desired air wave for massage by pressing the intensity button. The indicator light will cycle through blue, blue-red, and red to indicate different intensity levels (weak, medium, or strong). To deactivate this feature, press and hold the intensity button for 1 second.



Foot Fitness Button:

Initiate or discontinue the foot massage function by pressing the foot fitness button. Pressing and holding the button for 1 second switches the device to the soft air wave massage mode.



Vibration Button:

Utilize the vibration button to choose the preferred vibration intensity for your massage. The indicator will display sequential flashes of blue, red, and blue-red to denote various vibration strengths (weak, medium, or strong). Holding the vibration button for 1 second will deactivate this feature.



Calf Massage Button:

Engage the calf massage by pressing the calf massage button, which activates or halts the leg massage function. Pressing and holding this button for 1 second stops the massage and changes the mode to a soft air wave massage.

Note: This function is inactive when the flip cover is closed.

2. Instructions for Use

1. Position the massager on a clean and level surface, ensuring the foot cloth cover is secure.

2. Connect the power cord to a 220V-60/50HZ electrical outlet. The Power Button will illuminate, signaling that the device is on standby. You may then sit comfortably behind the massager and slide your feet into the foot cloth cover.

Note: Do not operate the massager while standing.

3. The product's flip can be opened or closed according to your preference. With the flip closed, it is possible to massage your feet; when open, both feet and calves can be massaged concurrently.

4. The operation panel on the upper screen is inaccessible when the flip cover is closed, and conversely, the panel on the lower screen cannot be used when the flip is open.

5. To adjust the flip cover while the massager is in use, first press the Power button to pause operation. You can then proceed to open or close the flip.

6. To reactivate the massager, press the Power Button again or wait until the pre-set timer expires, after which the massager will revert to standby mode with the power indicator active.

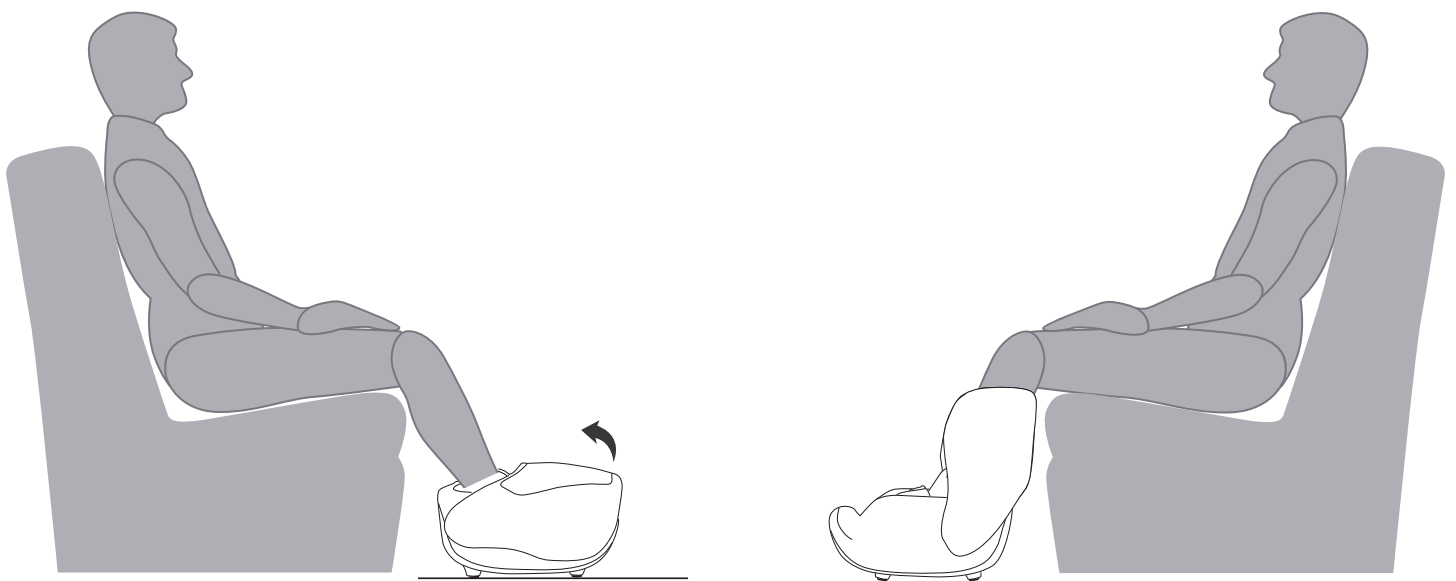

Product Components

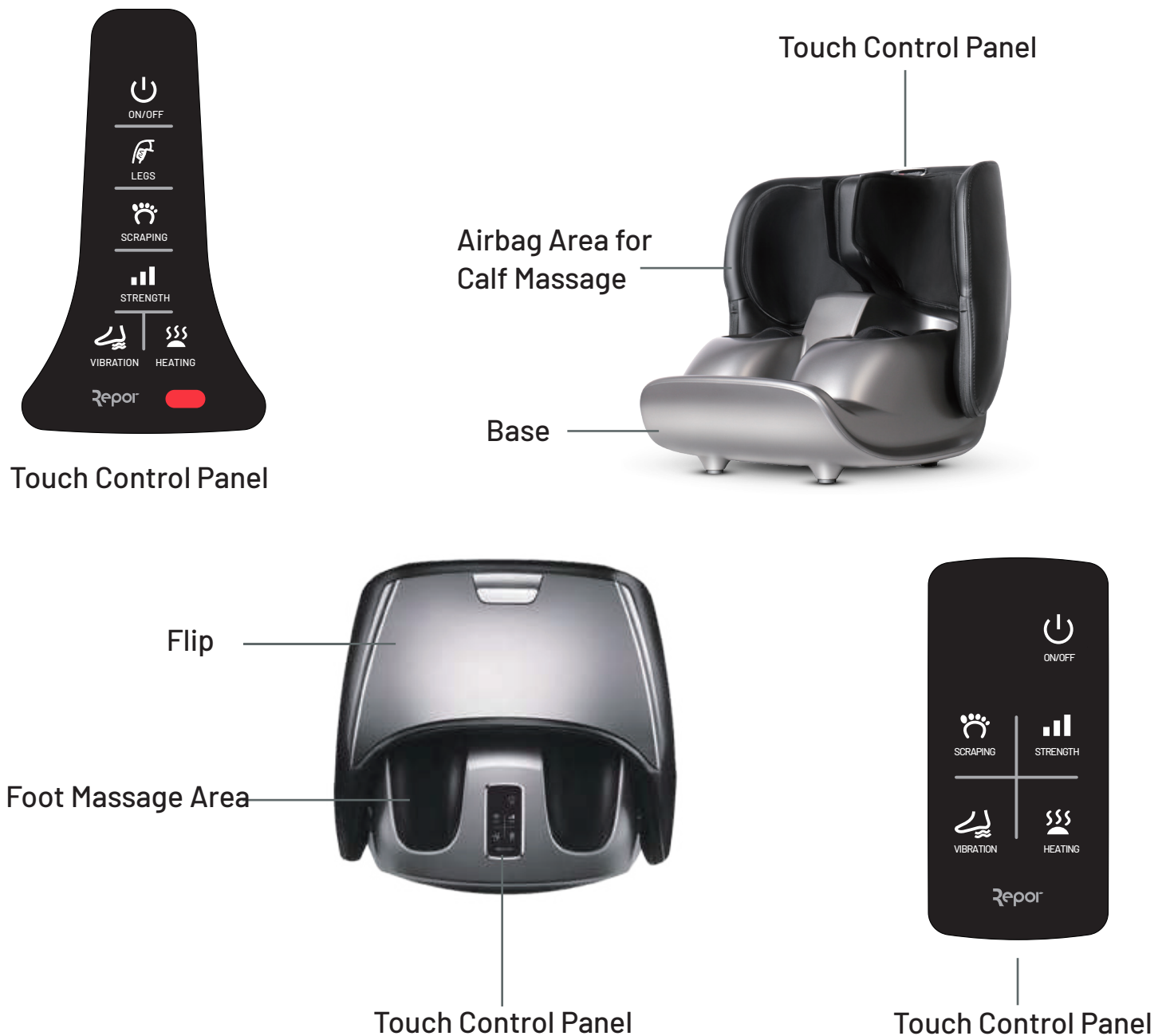

Product Maintenance

A. Storage

1. When not in operation, store the product in its original packaging and situate the box in a location that is dry, well-ventilated, and cool.
2. Refrain from bending or twisting the power cord.
3. It is important not to use the power cord as a means to suspend or hang the massager.
4. To prevent marring the appliance's surface, keep it distant from any sharp instruments.

5. Avoid placing the appliance in areas exposed to direct sunlight or high temperatures for extended periods.

B. Cleaning

1. Before cleaning, ensure the power is disconnected and the plug is removed.
2. Avoid using corrosive cleaners like benzene or thinner on this product.

C. Maintenance

1. Keep the appliance clean and store it away from high humidity areas.
2. When not in use for extended periods, consider using a dust cover to shield the product from dust accumulation.



This device is equipped with an integrated over-heat protection feature. If the temperature surpasses the safe threshold, the device will halt operation automatically. Prior to use, disconnect the appliance and allow it to cool naturally.

Troubleshooting

Please read the following guidelines and solutions if the device encounters an issue. If the problem persists, kindly visit the service center or entrusted technician for thorough inspection and repair

Problem	Possible Cause	Solution
The machine doesn't work.	1. The machine is not connected to a power supply. 2. The power button is not pressed.	1. Ensure the power supply is plugged in properly or verify its connection. 2. Initiate by pressing the Power Button.
The operation was ceased, abruptly.	1. Power failure. 2. The massager was operational for more than 15 minutes. 3. The device's temperature is high and heat-protection mode is enabled. 4. The massage ball was subjected to high pressure and is stuck.	1. Confirm that the device connected to power supply. 2. Re-initiate by pressing the Power Button. 3. Restart the product once it has cooled down. 4. Relieve pressure on the machine by easing tension in your feet.

Specifications

Product	Foldable Foot Massager
SKU	PD-LFFMG-GY
Net Weight	11.5kg
Rated Voltage	24V  3A
Rated Power	55W
Operation Duration	30min

Warranty

Products that you buy directly from our **Porodo** website or shop come with a 24-month warranty.

When you buy **Porodo** products from any of our approved sellers, you only get a 12-month warranty. If you want to extend this warranty, go to our website at **<https://porodo.net/warranty>** and fill out the form with your information. Don't forget to upload a picture of the product too. After we've checked and accepted your request, we'll send you an email to confirm that your product's warranty has been extended.

For more info, please check:

<https://www.porodo.net/warranty>

Contact Us

If you have any questions about this Privacy Policy, please contact us at:

info@porodo.net

Website: **porodo.net**

Service Support: **support@porodo.net**

Instagram: **[porodo](https://www.instagram.com/porodo)**