



Green Lion Gear Fit Smart Watch

SKU: GNGEARFTSW

Model No: GL-SWA52

Table of Contents

Downloading	2
Connecting the Watch	2
Important Notes	2
Watch Charging & Activation	3
Watch Operation Instructions	3
Watch Feature	4
Push Notification Setup	5
Avoid Wearing in Hot Baths	6
Warning	6
Specifications	7
Disposal	8
Warranty	8
Contact Us	8

Downloading

Downloading the App

Scan the QR code below to download and install the LaxasFit App.



Connecting the Watch

1. Open the App and set up your profile
2. Go to the Device tab and tap Add Device
3. Select your watch from the list of scanned devices
4. Binding completed

Important Notes

1. Ensure your phone's wireless connection is turned on.
2. On the watch, go to Settings → About and display its MAC address.
3. The first time you link the watch, allow the wireless-permission prompt in the App. If you've reset the watch to factory settings, simply repeat the above steps to reconnect.
4. If the watch remains powered on for more than 120 seconds without connecting, its wireless will turn off automatically. To reconnect, on the watch go to Settings → Watch, toggle Wireless off and on, then repeat the binding steps above.

Watch Charging & Activation

1. Before first use, the watch must be charged and activated:
2. Attach the wireless charging suction cup to the back of the watch, ensuring the magnetic connectors align.
3. Plug the charger into a USB power source rated 5 V, 1 A or lower.
4. The watch will begin charging automatically once connected.

Watch Operation Instructions

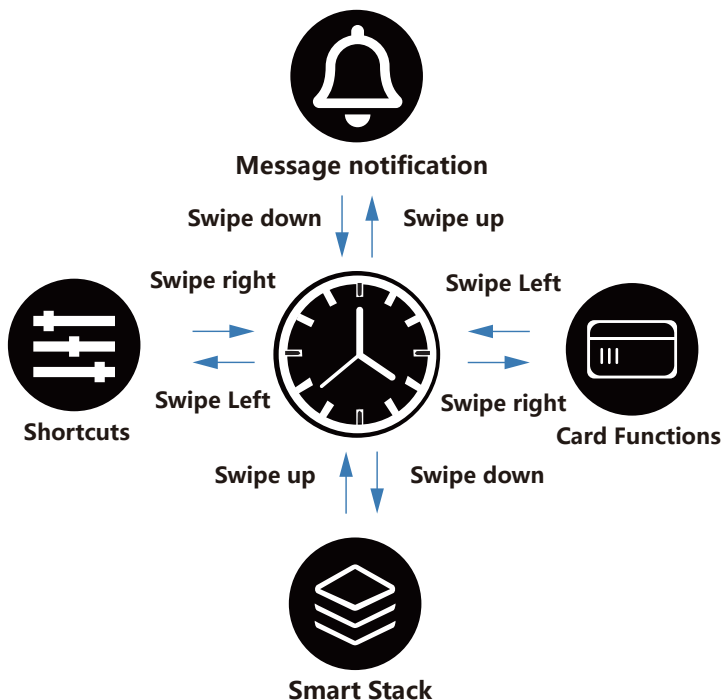

Watch Feature



Wireless Call

Open the App, link the watch's wireless connection, and sync your phone to make, answer, or reject calls directly on the watch.



Message Reminder

Enable notification access on your phone to receive all messages and social-media alerts on the watch.



Sports Mode

Choose from exercise modes—running, jumping rope, cycling, climbing—and begin real-time data tracking.



Exercise Record

Automatically log and review all your workout data.



Pedometer

Counts your daily steps, resets at 00:00, and syncs with the App for history and insights.



Sleep Monitor

Activate Sleep Monitor to track and analyze the quality of your rest each night.

Additional Features



Remote Shutter

Once the watch is connected to your phone, open the camera shutter mode in the App. Tap the on-screen shutter or shake the watch to take photos, which are saved automatically to your phone.



Music Player Control

After pairing, use the watch to play, pause, skip, or adjust volume on your phone's music player.



Find Mobile Phone

When watch and phone are paired, tap the Find Phone icon (magnifying glass) on the watch and hold to make your phone ring.



Weather

View today's and tomorrow's weather forecasts on the watch. Weather data syncs when connected to the App; it will not update if disconnected for an extended period.



Stopwatch

Open the Stopwatch page, tap Start to begin timing, then tap Stop to end.



Alarm

Set up to eight alarms on the App or the watch. Alarms display an icon and vibrate the watch at the scheduled time.



Sedentary Reminder

Configure a reminder interval on the App; when the time elapses, the watch vibrates and shows a reminder message.



Always-On Display

Enable this feature to keep the time visible on screen after it normally turns off.



Watch Face Style

Choose and apply different UI styles directly from the watch.



About

View the watch's MAC address, wireless connection name, and firmware version.



Brightness

Adjust screen brightness and backlight timeout settings.



Settings

Toggle vibration on or off and adjust volume levels.



Language

After pairing with the App, choose your preferred language on either the App or the watch; the setting syncs automatically.



Push Notification Setup

Phone Settings:

Make sure the message push on/off is turned on in your mobile phone.

Make sure the message can be displayed in the notification bar of your phone. The device information depends on whether the information can be read in the notification bar of the phone. If there are no notifications on the phone, the device will not be able to receive push messages. (You need

to find the notification settings in your phone to turn on/off the multimedia message alerts.)

Turn on the accessibility settings of your device. (You will need to find the accessibility settings in your phone settings and turn on the accessibility settings for your device.)

Phone Settings (Repeated):

Make sure the message push on/off is turned on for your phone.

Make sure the message can be displayed in the notification bar of your phone. (You need to find the notification setting in your phone and turn on/off the multimedia message alert.)

Avoid Wearing in Hot Baths

The temperature of the bath water is relatively high, and a lot of water vapor will be generated, and the water vapor is in the gas phase, and its molecular radius is small. It's easy to penetrate through the gap of the device case. When the temperature drops it will condense into liquid water droplets again, which will easily cause a short circuit inside and damage the circuit board, and then damage the whole device.

Warning

Note: This equipment has been tested and found to comply with the limits for a Class B digital device, pursuant to part 15 of the FCC Rules. These limits are designed to provide reasonable protection against harmful interference in a residential installation. This equipment generates, uses, and can radiate radio frequency energy and, if not installed and used in accordance with the instructions, may cause harmful interference to radio communications.

However, there is no guarantee that interference will not occur in a particular installation. If this equipment does cause harmful interference to radio or television reception, which can be determined by turning the equipment off and on, the user is encouraged to try to correct the interference by one or more of the following measures:

- Reorient or relocate the receiving antenna.
- Increase the separation between the equipment and receiver.
- Connect the equipment into an outlet on a circuit different from that to which the receiver is connected.
- Consult the dealer or an experienced radio/TV technician for help.

Important: Changes or modifications not expressly approved by the manufacturer responsible for compliance could void the user's authority to operate the equipment. The device has been evaluated to meet general RF exposure requirements. The device can be used in portable exposure conditions without restriction.

Specifications

Model No.	GL-SWA52
Case Material	Zinc Alloy
Strap Material	Silicone
Battery	200mAh
Display	1.52" TFT IPS
Resolution	240*240
Brightness	500 nits
Bluetooth	V5.3
Storage	125Kb SRAM 16Mb ROM
Charging Type	Magnetic
Charging Time	2-3 Hrs
Usage Time	3-5 Days
Standby Time	15 Days
Waterproof	IP65
Product Weight	42 g
Product Dimensions	13*49.3*54.7 mm



Disposal

This product must not be disposed of as unsorted household waste. It is important to separate such waste for proper treatment and recycling, in compliance with local waste management regulations.

Warranty

Products that you buy directly from our **Green Lion** website or shop come with a 24-month warranty.

When you buy **Green Lion** products from any of our approved sellers, you only get a 12-month warranty. If you want to extend this warranty, go to our website at <https://www.greenlion.net/warranty> and fill out the form with your information. Don't forget to upload a picture of the product too. After we've checked and accepted your request, we'll send you an email to confirm that your product's warranty has been extended.

For more info, please check:
<https://www.greenlion.net/warranty>

Contact Us

If you have any questions about this Privacy Policy, please contact us at:

Website: <https://www.greenlion.net/>

Sales: sales@greenlion.net

Service Support: Support@greenlion.net

Telegram: [@greenlion_global](https://www.instagram.com/greenlion_global)

Instagram: [@greenlion_global](https://www.instagram.com/greenlion_global)