

porodo



Gaming 27"

FHD/240Hz Monitor

—— SKU: PDX546 ——

Table of Content

Safety Guidelines	2
1. Product Description	3
2. Installation and Connection.....	3
2.1 Installing the Monitor.....	3
2.2 Instructions for Base Installation.....	4
2.3 Signal Cable Connection.....	5
2.4 Audio Output.....	5
3. Operation of Display.....	6
4. Specification.....	6
5. Troubleshooting.....	7
Warranty.....	8
Contact Us.....	8

Safety Guidelines

Before using this product, ensure you have read and understood all the instructions carefully.

1. To clean the LCD, always power off and unplug the display. Do NOT use liquid detergents or spraying cleaning agents. Clean the LCD with a soft wet cloth and specialized LCD cleaners.

2. Avoid risking personal injury by NOT using accessories that are not approved by the manufacturer.

3. When disconnecting the power cord of the monitor or power adapter be careful to hold the plug. Do NOT pull the cord wire to unplug the device.

4. Do NOT place the monitor near sinks, washing machines, pools, or in areas where it could be exposed to water, other liquids, and moisture.

5. Ensure the display's ventilation openings are NOT blocked. Keep the air outlets away from fabric, paper, or any other material that could obstruct airflow.

6. The ventilation slots at the base and top of the shell ensure reliable performance and prevent overheating. Do NOT obstruct these openings or place the display on soft surfaces like beds or sofas, near heat sources, or in direct sunlight.

7. Only use the power source indicated on the nameplate of the display. If uncertain about power source compatibility, contact us.

8. High voltage risks are present when the display casing is opened. Do NOT attempt to repair the device. If service is required, it should only be performed by qualified personnel.

If you encounter the following problems, unplug the device and power adapter and contact the maintenance staff:

8.1 The power cable cord/plug is damaged or worn away.

8.2 The display has dropped or the casing is broken.

8.3 The display does not function, normally.

9. Place the monitor in a cool, dry area with good ventilation.

1. Product Description

Before installation, ensure the packing case includes the following items:

- 1.1 One LCD (base included)
- 1.2 One power cord, one AC adapter, one cable
- 1.3 One user manual

Note: The accessories may vary depending on the type of packaging and are subject to change.

2. Installation and Connection

2.1 Installing the Monitor

1. Place the monitor close to an AC power socket.
2. Use an appropriate wall-mounted bracket or base as recommended to ensure the safety of the user.
3. Install the monitor on a stable and level surface to avoid potential injury.
4. Please contact professional staff to install the monitor on the wall, stably and securely.
5. Avoid locations prone to mechanical vibrations.
6. Keep the machine away from areas where insects are likely to enter.
7. Do not place opposite to air-conditioners to prevent damage to the electrical board.
8. Ensure the machine is not subjected to strong electromagnetic fields to prevent damage and interference of magnetic field with the functionality of the monitor.

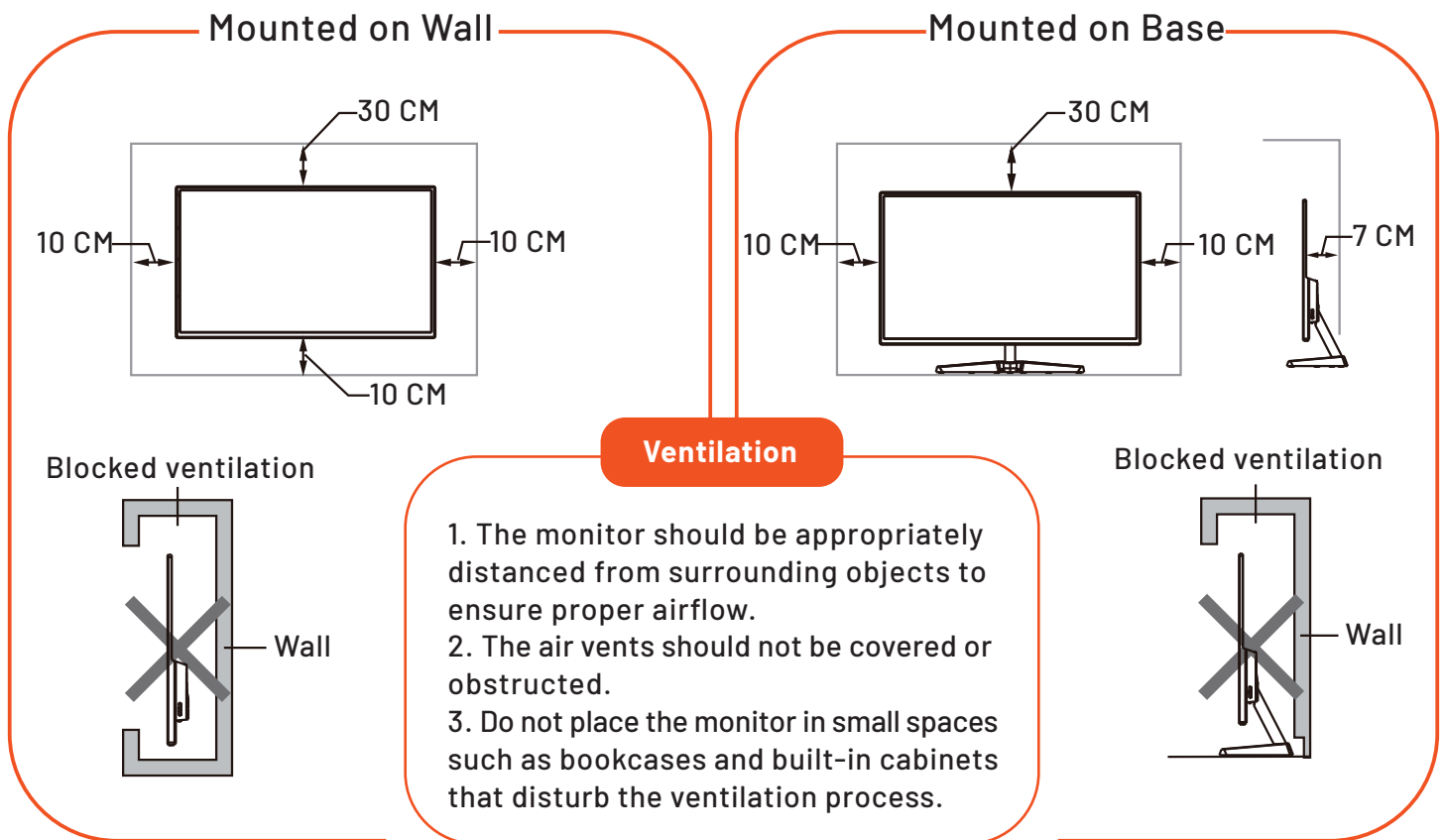

2.2 Instructions for Base Installation

Installing the base

1. Secure the base to the support structure using the provided M4*16 screws.
2. Pivot the base towards the back of the unit, aligning it with the arrow-marked holes.
3. Firmly rotate the entire base assembly clockwise to lock it into place.

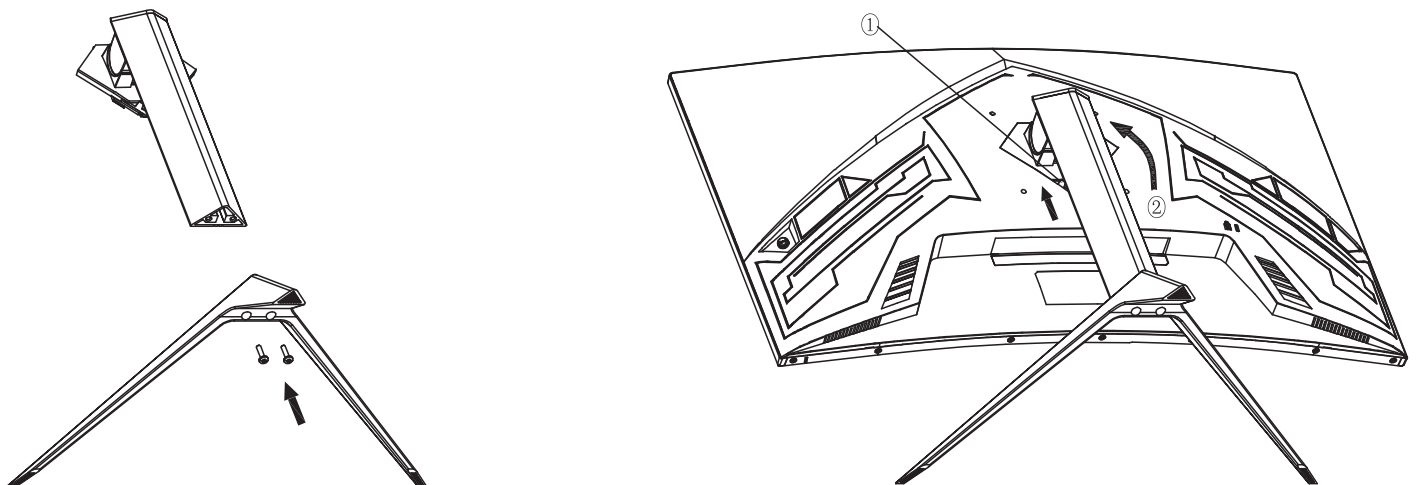

Removing the base

1. Activate the release mechanism by pushing up the slider located near the base's VESA cover.
2. Disengage the base by rotating it counterclockwise and upward.
3. Gently tilt the base following the direction indicated by the arrow to detach it from the unit.

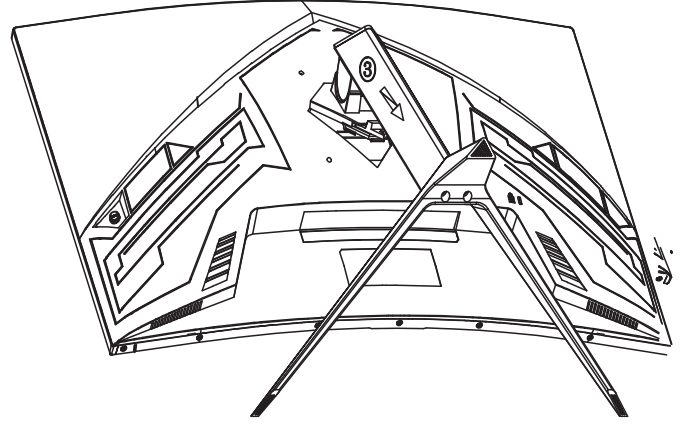
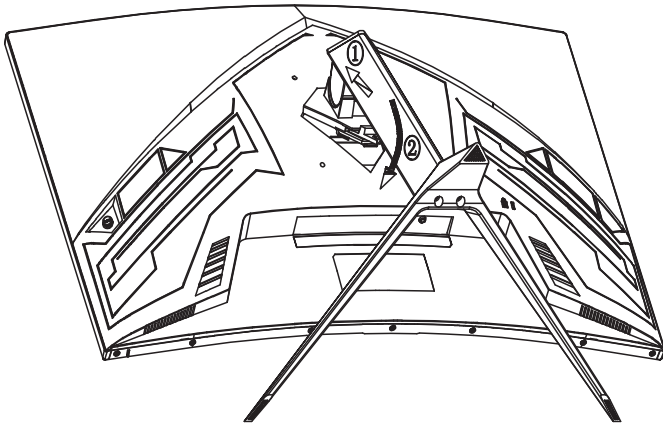

Installation Tips

1. Lay the monitor face down on the original protective material included in the packaging to prevent damage to the screen to safely remove the base.
2. Press the designated release button to detach the base for bases with a quick assembly/disassembly feature.

2.3 Signal Cable Connection

Connect the signal cable to the output interfaces, such as VGA, HDMI, or DP, on your PC, then connect the opposite end of the cable to the corresponding signal input port on the monitor.

2.4 Audio Output

The device supports audio output through headphones.

3. Operation of Display

If the PC's video signal frequency surpasses the display's acceptable range, the horizontal and vertical synchronization signals will automatically deactivate to safeguard the display. You must adjust the PC's output frequency to a compatible range to ensure the display functions correctly.

4. Specification

Panel Size	27"
Resolution	1080×1920px @ 240 Hz
Power Input	19V = 4.5A
Power Consumption	≤54W
Standby Consumption	≤0.5W
Operating altitude	≤5000 m
Storage temperature	-10°C to +60°C
Operating temperature	0°C to +40°C
Operating humidity	20 % to 85 %
Storage humidity	10 % to 90 %

5. Troubleshooting

Problem	Solution
1. Power indicator is OFF/ Screen is OFF	Ensure the display and socket are correctly connected and check if the display is in shutdown mode.
2. The image is blurry, over-large, over-small, etc.	Navigate to "Image Setting" and choose "Auto Image Adjust" to automatically fine-tune the display. (Applicable only for VGA signal input)
3. Image overly dark	Access "Brightness and Contrast" settings to modify the display's brightness and contrast levels.
4. Display overheating	Maintain a minimum clearance of 5cm around the display for adequate ventilation and refrain from placing items on the display.
5. Dark/light spots when powering ON	This uneven back light illumination is a typical initial occurrence due to temperature difference, rectifying itself after approximately 20 minutes as the display temperature stabilizes.
6. Image distortion, blinking, shaking	Review and adjust computer settings, ensuring the correct resolution and frequency are selected.
7. Noises when powering OFF	Audible noise during power-off is a standard result of the display discharging.

Warranty

Products that you buy directly from our **Porodo** website or shop come with a 24-month warranty.

When you buy **Porodo** products from any of our approved sellers, you only get a 12-month warranty. If you want to extend this warranty, go to our website at **<https://porodo.net/warranty>** and fill out the form with your information.

Don't forget to upload a picture of the product too. After we've checked and accepted your request, we'll send you an email to confirm that your product's warranty has been extended.

For more info, please check:

porodo.net/warranty

Contact Us

If you have any questions about this Privacy Policy, please contact us at: **info@porodo.net**

Website: **porodo.net**

Service Support: **support@porodo.net**

Instagram: **[porodo](https://www.instagram.com/porodo)**